

# V-RIB

## RESIDENTIAL ROOFING

### DETAILS:

### REV: DATE:

VRRR0	Cover Sheet	1	May 2025
VRRR1	Ridge Flashing Detail	1	May 2025
VRRR2	Barge Wall Detail	1	May 2025
VRRR3	Barge Soffit Detail	1	May 2025
VRRR4	Raking Barge Flashing Detail	1	May 2025
VRRR5	Sawtooth Wall Detail	1	May 2025
VRRR6	Sawtooth Soffit Detail	1	May 2025
VRRR7	Parapet Apron Detail	1	May 2025
VRRR8	Apron Parallel Detail	1	May 2025
VRRR9	Apron Parallel Two Piece Detail	1	May 2025
VRRR10	Apron Transverse Detail	1	May 2025
VRRR11	Apron Transverse Two Piece Detail	1	May 2025
VRRR12	Change of Pitch Detail	1	May 2025
VRRR13	Mansard Detail	1	May 2025
VRRR14	Valley Detail	1	May 2025
VRRR15	Internal Gutter Detail	1	May 2025
VRRR16	Parallel Hidden Gutter Detail	1	May 2025
VRRR17	Parallel Hidden Gutter Two Piece Detail	1	May 2025
VRRR18	Eave Detail	1	May 2025
VRRR19	Pipe Penetration Direct Fix Detail	1	May 2025
VRRR20	Pipe Penetration Back Tray Detail	1	May 2025

**COVER DIMENSIONS AS PER E2/AS1**

	<b>SITUATION 1</b>	<b>SITUATION 2</b>	<b>SITUATION 3</b>
	Low, Medium & High Wind Zones where roof pitch $\geq 10^\circ$ (Excludes any soft edge or turn-down)	All roof pitches in Very High zone. Low, Medium & High Wind Zones where roof pitch $\leq 10^\circ$ (Excludes any soft edge or turn-down)	All roof pitches in Extra High wind zone (Excludes any soft edge or turn-down)
<b>X</b>	130mm MIN	200mm MIN	200mm MIN
<b>Y</b>	Cover at least two crests (turned-up edge to full crest height constitutes a crest)		
<b>Z</b>	50mm MIN	70mm MIN	90mm MIN

Ridge flashing to match roofing.  
Materials & Fixings as per Dimond Technical Data, E2/AS1 & MRM Code of Practice

Notched to suit roofing profile

Dimond V-Rib Trapezoidal roofing

Roof Underlay (shown dashed)

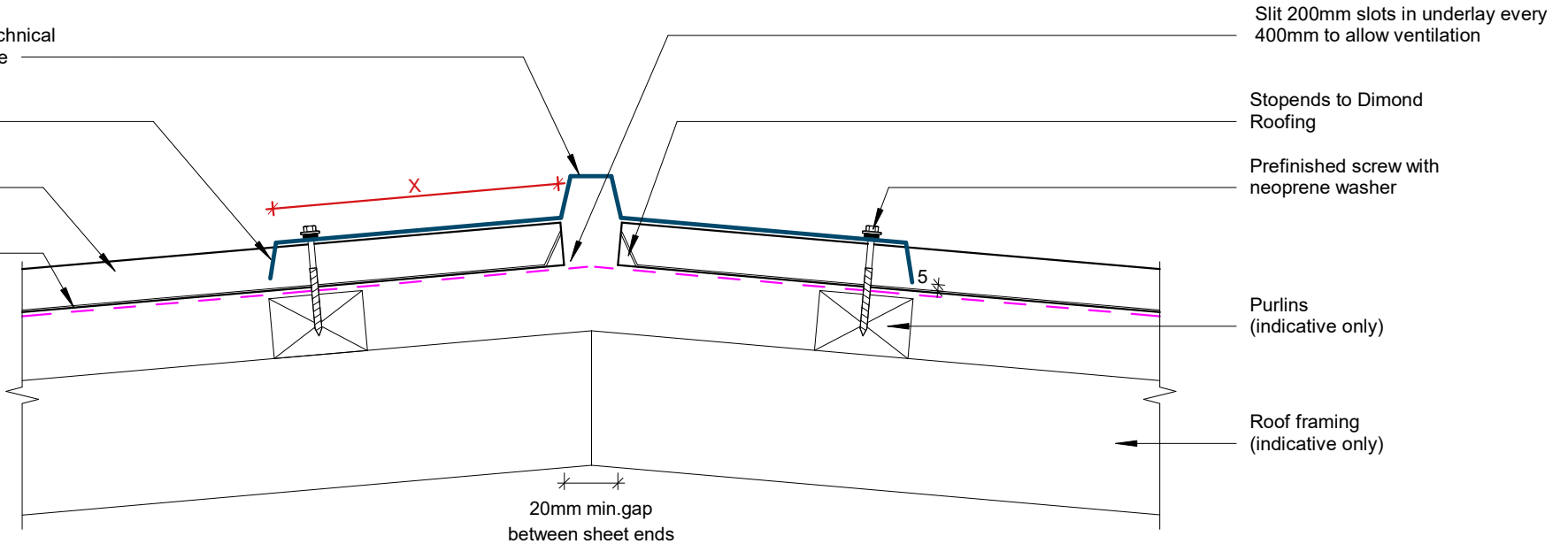

Slit 200mm slots in underlay every 400mm to allow ventilation

Stopends to Dimond Roofing

Prefinished screw with neoprene washer

Purlins (indicative only)

Roof framing (indicative only)

20mm min. gap between sheet ends

## Ridge Flashing Detail

COVER DIMENSIONS AS PER E2/AS1		
SITUATION 1	SITUATION 2	SITUATION 3
Low, Medium & High Wind Zones where roof pitch $\geq 10^\circ$ (Excludes any soft edge or turn-down)	All roof pitches in Very High zone. Low, Medium & High Wind Zones where roof pitch $\leq 10^\circ$ (Excludes any soft edge or turn-down)	All roof pitches in Extra High wind zone (Excludes any soft edge or turn-down)
<b>X</b> 130mm MIN	200mm MIN	200mm MIN
<b>Y</b> Cover at least two crests (turned-up edge to full crest height constitutes a crest)		
<b>Z</b> 50mm MIN	70mm MIN	90mm MIN

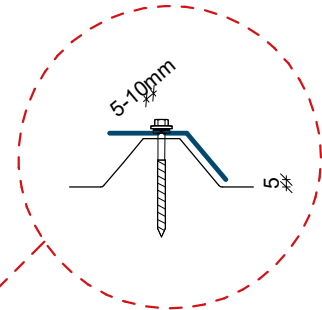

Barge flashing to match roofing.  
Materials & Fixings as per Dimond Technical Data, E2/AS1 & MRM Code of Practice

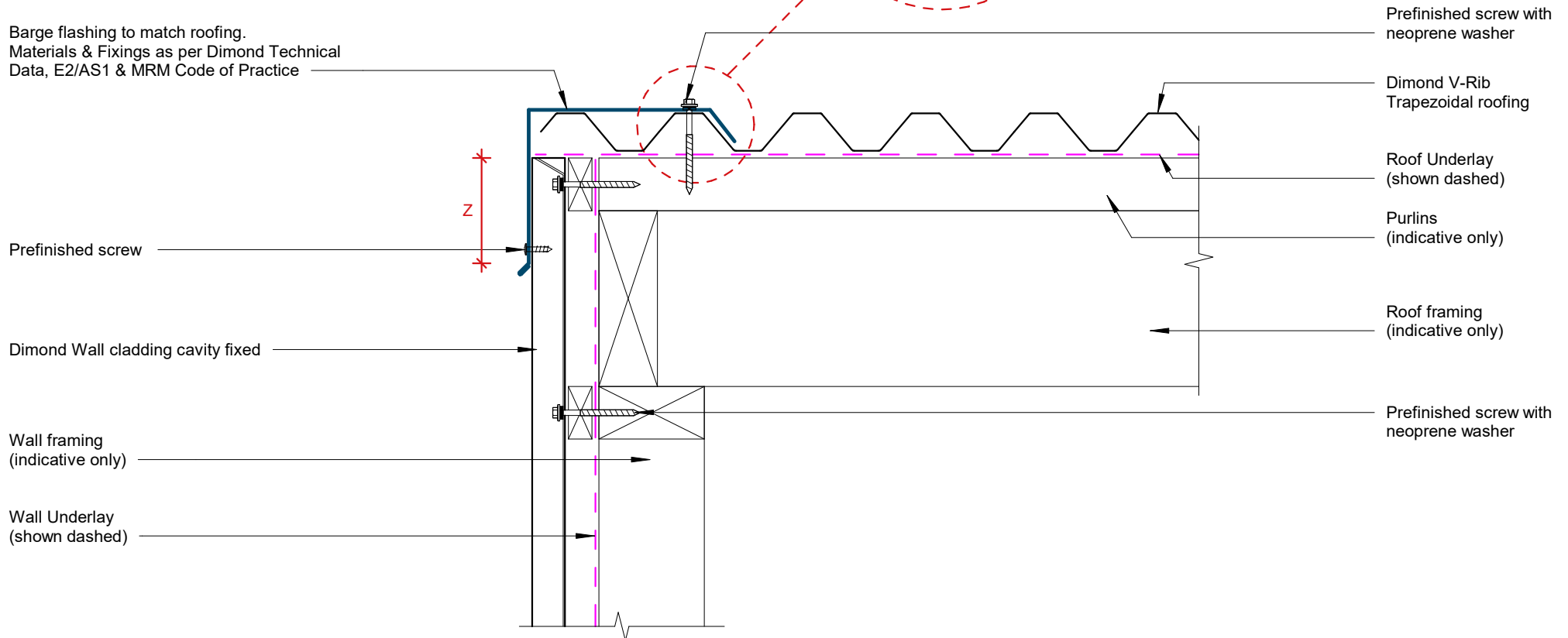

**GENERAL NOTE**

Cavity battens or timber framing that contain copper must be separated from steel cladding by a strip of wall or roof underlay or DPC.

# Barge Wall Detail

COVER DIMENSIONS AS PER E2/AS1		
SITUATION 1	SITUATION 2	SITUATION 3
Low, Medium & High Wind Zones where roof pitch $\geq 10^\circ$ (Excludes any soft edge or turn-down)	All roof pitches in Very High zone. Low, Medium & High Wind Zones where roof pitch $\leq 10^\circ$ (Excludes any soft edge or turn-down)	All roof pitches in Extra High wind zone (Excludes any soft edge or turn-down)
<b>X</b> 130mm MIN	200mm MIN	200mm MIN
<b>Y</b> Cover at least two crests (turned-up edge to full crest height constitutes a crest)		
<b>Z</b> 50mm MIN	70mm MIN	90mm MIN

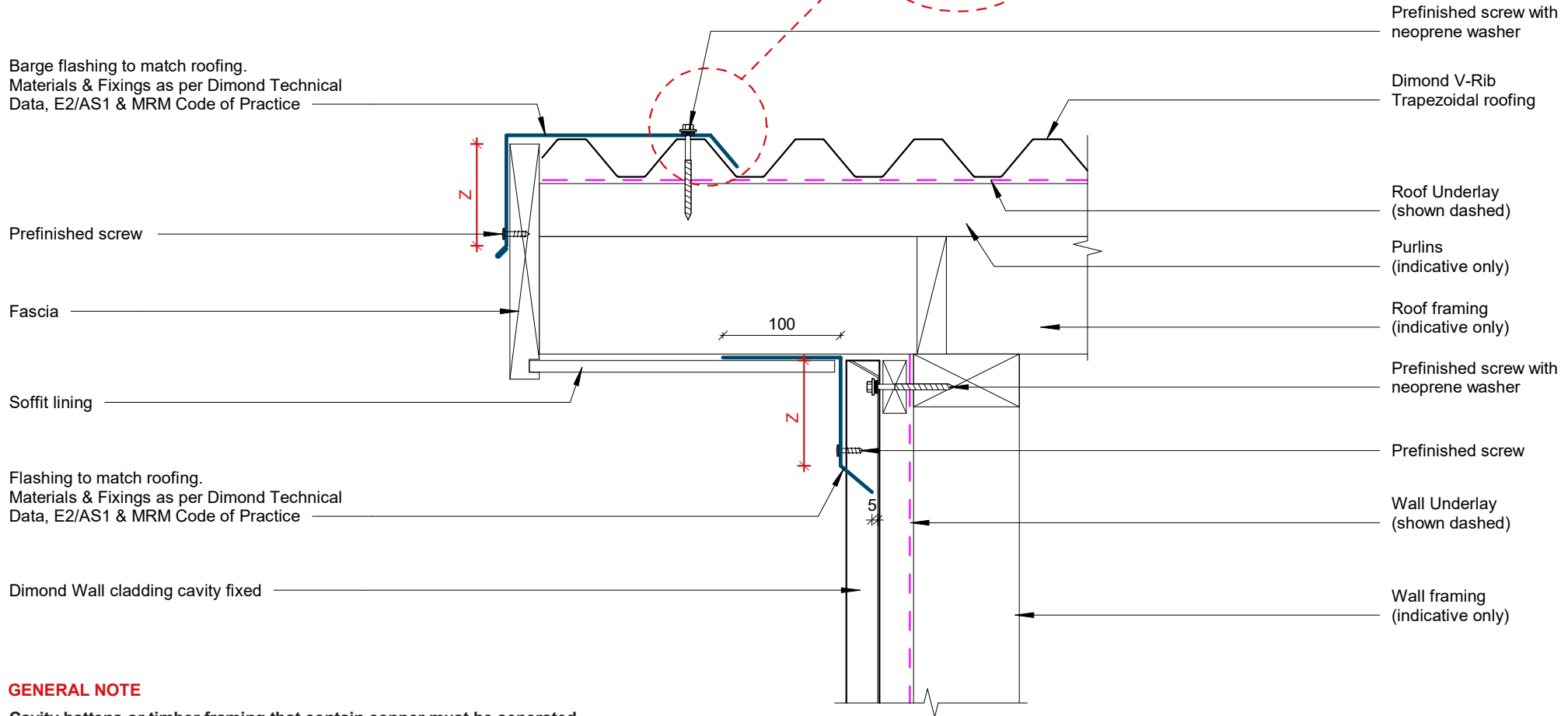
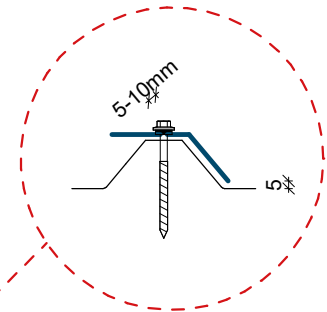

**GENERAL NOTE**

Cavity battens or timber framing that contain copper must be separated from steel cladding by a strip of wall or roof underlay or DPC.

# Barge Soffit Detail



©Dimond 2023, all rights reserved. The information and specifications contained in this document are proprietary to Dimond and may not be used other than for the purpose of designing or building a roof or roofing system solely using products supplied or approved by Dimond ("Permitted Purpose"). You may copy this document solely for the Permitted Purpose, but may not otherwise copy, publish, distribute or modify this document without Dimond's prior written consent. Dimond will not be liable for any use of this document or information and specifications contained in this document, other than for the Permitted Purpose

Rev: 1

V-Rib Residential Roofing

Date: May 2025 Scale: 1 : 5 Sheet: VRRR3

**COVER DIMENSIONS AS PER E2/AS1**

	<b>SITUATION 1</b>	<b>SITUATION 2</b>	<b>SITUATION 3</b>
	Low, Medium & High Wind Zones where roof pitch $\geq 10^\circ$ (Excludes any soft edge or turn-down)	All roof pitches in Very High zone. Low, Medium & High Wind Zones where roof pitch $\leq 10^\circ$ (Excludes any soft edge or turn-down)	All roof pitches in Extra High wind zone (Excludes any soft edge or turn-down)
<b>X</b>	130mm MIN	200mm MIN	200mm MIN
<b>Y</b>	Cover at least two crests (turned-up edge to full crest height constitutes a crest)		
<b>Z</b>	50mm MIN	70mm MIN	90mm MIN

Barge flashing to match roofing.  
Materials & Fixings as per Dimond Technical Data, E2/AS1 & MRM Code of Practice

Stopends to Dimond Roofing

Prefinished screw

Fascia

Soffit lining

Flashing to match roofing Materials & Fixings as per Dimond Technical Data, E2/AS1 & MRM Code of Practice

Dimond Wall cladding cavity fixed

**GENERAL NOTE**

Cavity battens or timber framing that contain copper must be separated from steel cladding by a strip of wall or roof underlay or DPC.

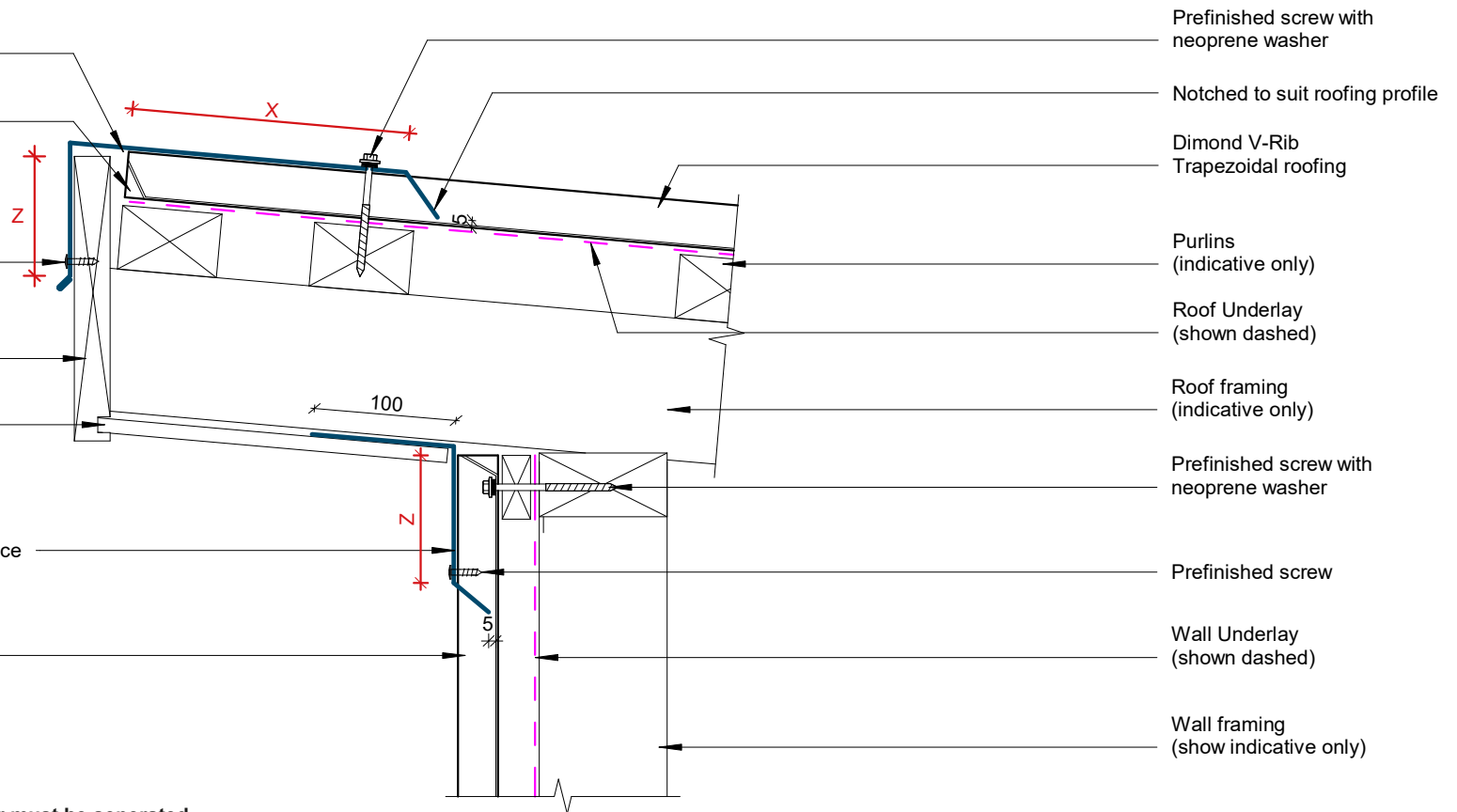

# Raking Barge Flashing Detail

COVER DIMENSIONS AS PER E2/AS1		
SITUATION 1	SITUATION 2	SITUATION 3
Low, Medium & High Wind Zones where roof pitch $\geq 10^\circ$ (Excludes any soft edge or turn-down)	All roof pitches in Very High zone. Low, Medium & High Wind Zones where roof pitch $\leq 10^\circ$ (Excludes any soft edge or turn-down)	All roof pitches in Extra High wind zone (Excludes any soft edge or turn-down)
<b>X</b> 130mm MIN	200mm MIN	200mm MIN
<b>Y</b> Cover at least two crests (turned-up edge to full crest height constitutes a crest)		
<b>Z</b> 50mm MIN	70mm MIN	90mm MIN

Stops ends to Dimond Roofing

Flashing to match roofing.  
Materials & Fixings as per Dimond Technical Data, E2/AS1 & MRM Code of Practice

Birds beak edge

Prefinished screw

Wall Underlay (shown dashed)

Prefinished screw with neoprene washer

Dimond Wall cladding cavity fixed

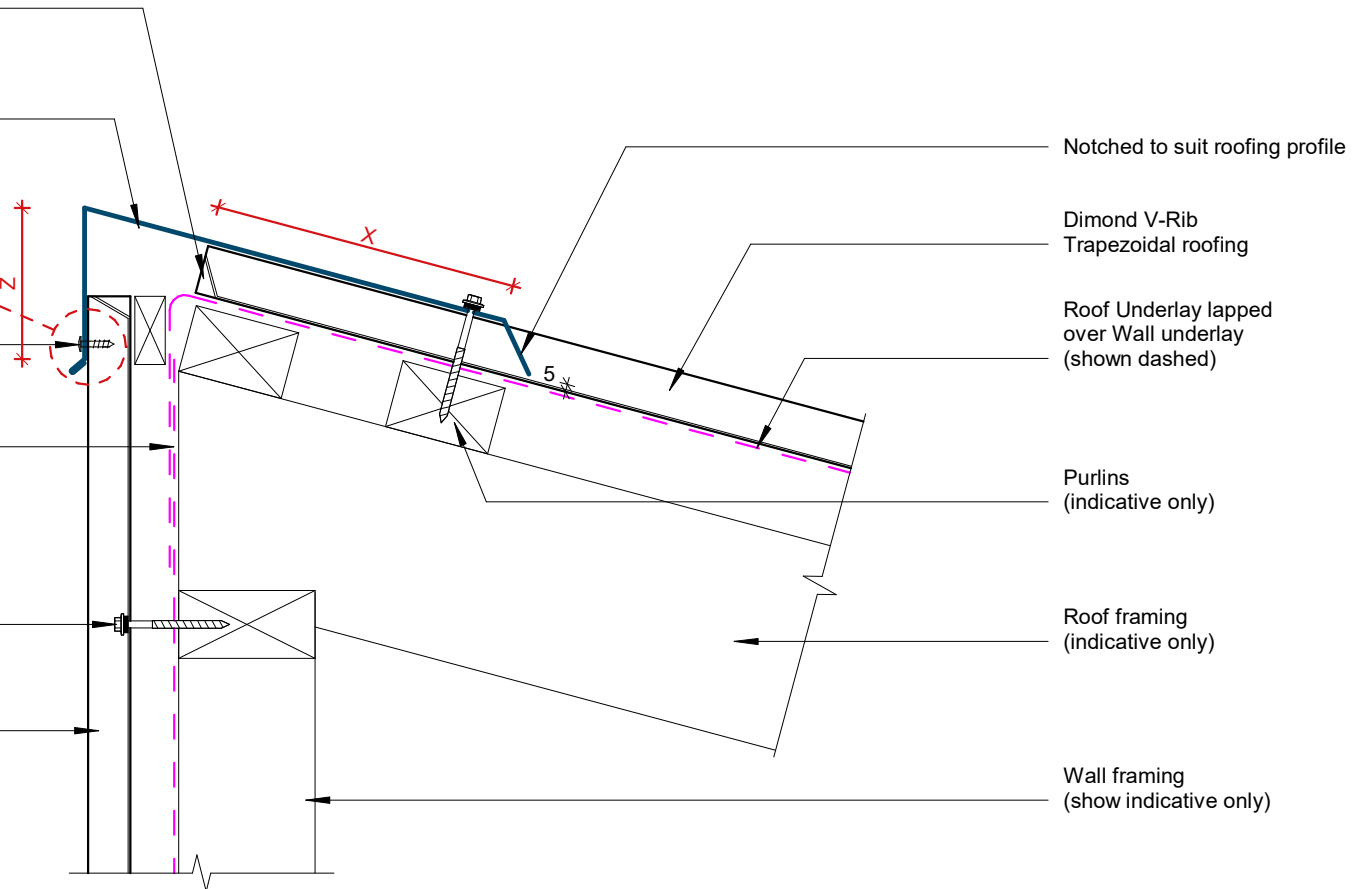
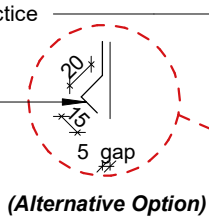

Notched to suit roofing profile

Dimond V-Rib Trapezoidal roofing

Roof Underlay lapped over Wall underlay (shown dashed)

Purlins (indicative only)

Roof framing (indicative only)

Wall framing (show indicative only)

**GENERAL NOTE**

Cavity battens or timber framing that contain copper must be separated from steel cladding by a strip of wall or roof underlay or DPC.

# Sawtooth Wall Detail

**COVER DIMENSIONS AS PER E2/AS1**

	<b>SITUATION 1</b>	<b>SITUATION 2</b>	<b>SITUATION 3</b>
	Low, Medium & High Wind Zones where roof pitch $\geq 10^\circ$ (Excludes any soft edge or turn-down)	All roof pitches in Very High zone. Low, Medium & High Wind Zones where roof pitch $\leq 10^\circ$ (Excludes any soft edge or turn-down)	All roof pitches in Extra High wind zone (Excludes any soft edge or turn-down)
<b>X</b>	130mm MIN	200mm MIN	200mm MIN
<b>Y</b>	Cover at least two crests (turned-up edge to full crest height constitutes a crest)		
<b>Z</b>	50mm MIN	70mm MIN	90mm MIN

Flashing to match roofing.  
Materials & Fixings as per Dimond Technical Data, E2/AS1 & MRM Code of Practice

Stoppers to Dimond Roofing

Birds beak edge

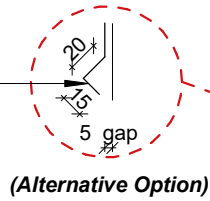

Prefinished screw

Fascia

Soffit lining

Prefinished screw with neoprene washer

Flashing to match roofing.  
Materials & Fixings as per Dimond Technical Data, E2/AS1 & MRM Code of Practice

Dimond Wall cladding cavity fixed

**GENERAL NOTE**

Cavity battens or timber framing that contain copper must be separated from steel cladding by a strip of wall or roof underlay or DPC.

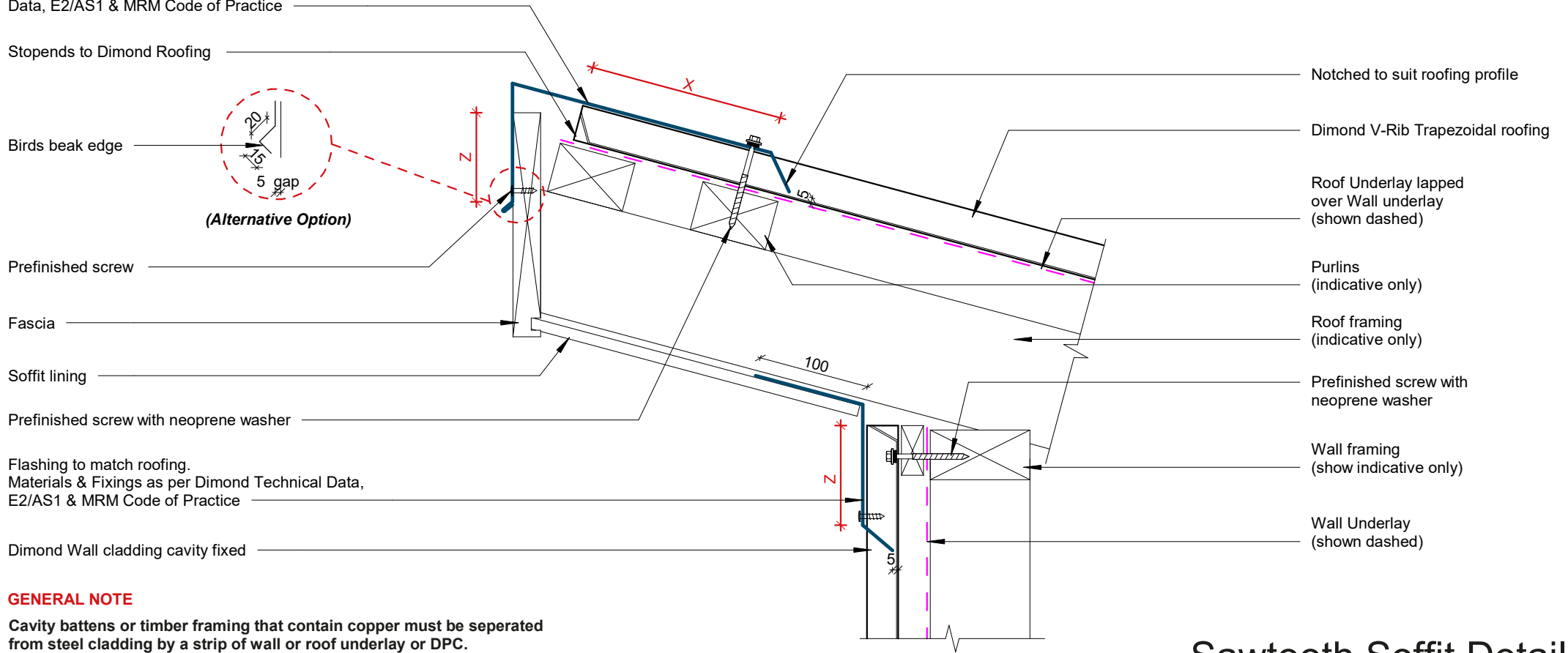

# Sawtooth Soffit Detail

Rev: 1

V-Rib Residential Roofing



©Dimond 2023, all rights reserved. The information and specifications contained in this document are proprietary to Dimond and may not be used other than for the purpose of designing or building a roof or roofing system solely using products supplied or approved by Dimond ("Permitted Purpose"). You may copy this document solely for the Permitted Purpose, but may not otherwise copy, publish, distribute or modify this document without Dimond's prior written consent. Dimond will not be liable for any use of this document or information and specifications contained in this document, other than for the Permitted Purpose

Date: May 2025 Scale: 1 : 5 Sheet: VRRR6

**COVER DIMENSIONS AS PER E2/AS1**

	<b>SITUATION 1</b>	<b>SITUATION 2</b>	<b>SITUATION 3</b>
	Low, Medium & High Wind Zones where roof pitch $\geq 10^\circ$ (Excludes any soft edge or turn-down)	All roof pitches in Very High zone. Low, Medium & High Wind Zones where roof pitch $\leq 10^\circ$ (Excludes any soft edge or turn-down)	All roof pitches in Extra High wind zone (Excludes any soft edge or turn-down)
<b>X</b>	130mm MIN	200mm MIN	200mm MIN
<b>Y</b>	Cover at least two crests (turned-up edge to full crest height constitutes a crest)		
<b>Z</b>	50mm MIN	70mm MIN	90mm MIN

Parapet cap flashing to match roofing.  
Materials & Fixings as per Dimond Technical Data, E2/AS1 & MRM Code of Practice

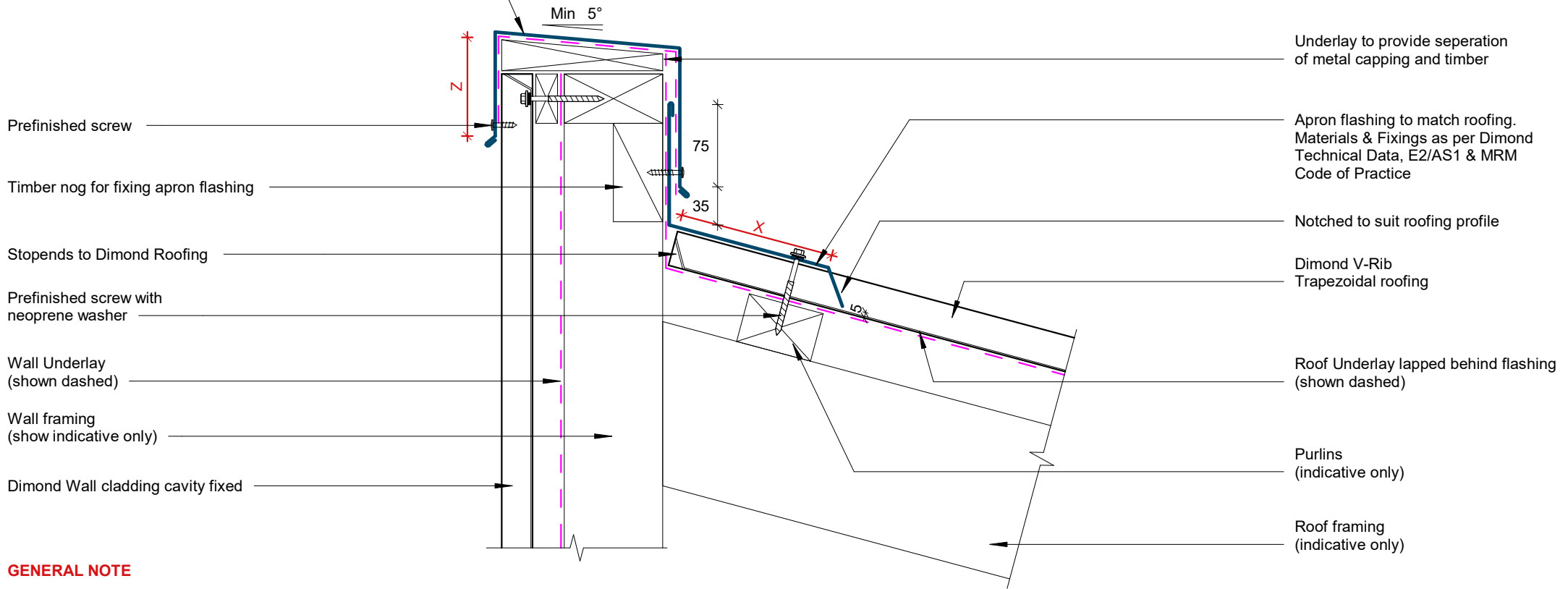

**GENERAL NOTE**

Cavity battens or timber framing that contain copper must be separated from steel cladding by a strip of wall or roof underlay or DPC.

# Parapet Apron Detail

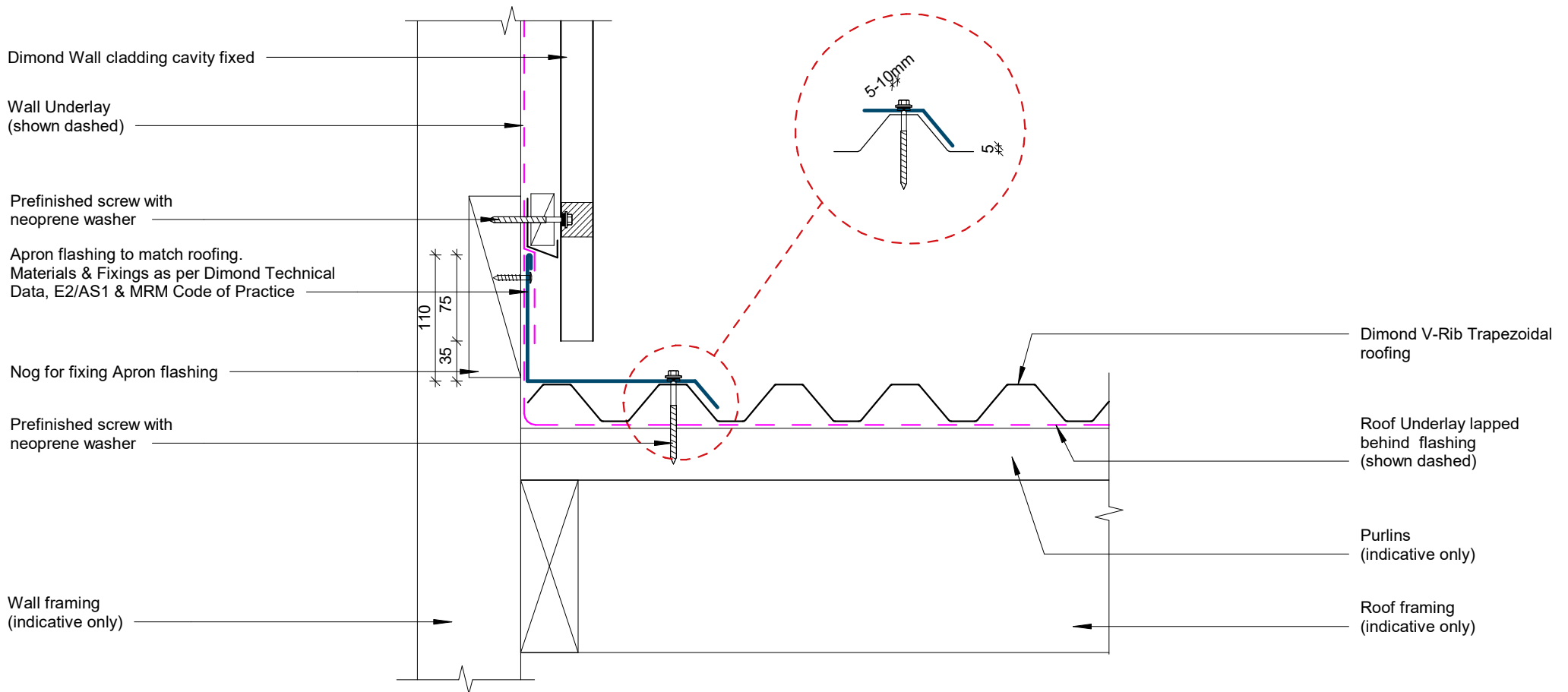

### GENERAL NOTE

Cavity battens or timber framing that contain copper must be separated from steel cladding by a strip of wall or roof underlay or DPC.

## Apron Parallel Detail

Rev: 1

V-Rib Residential Roofing

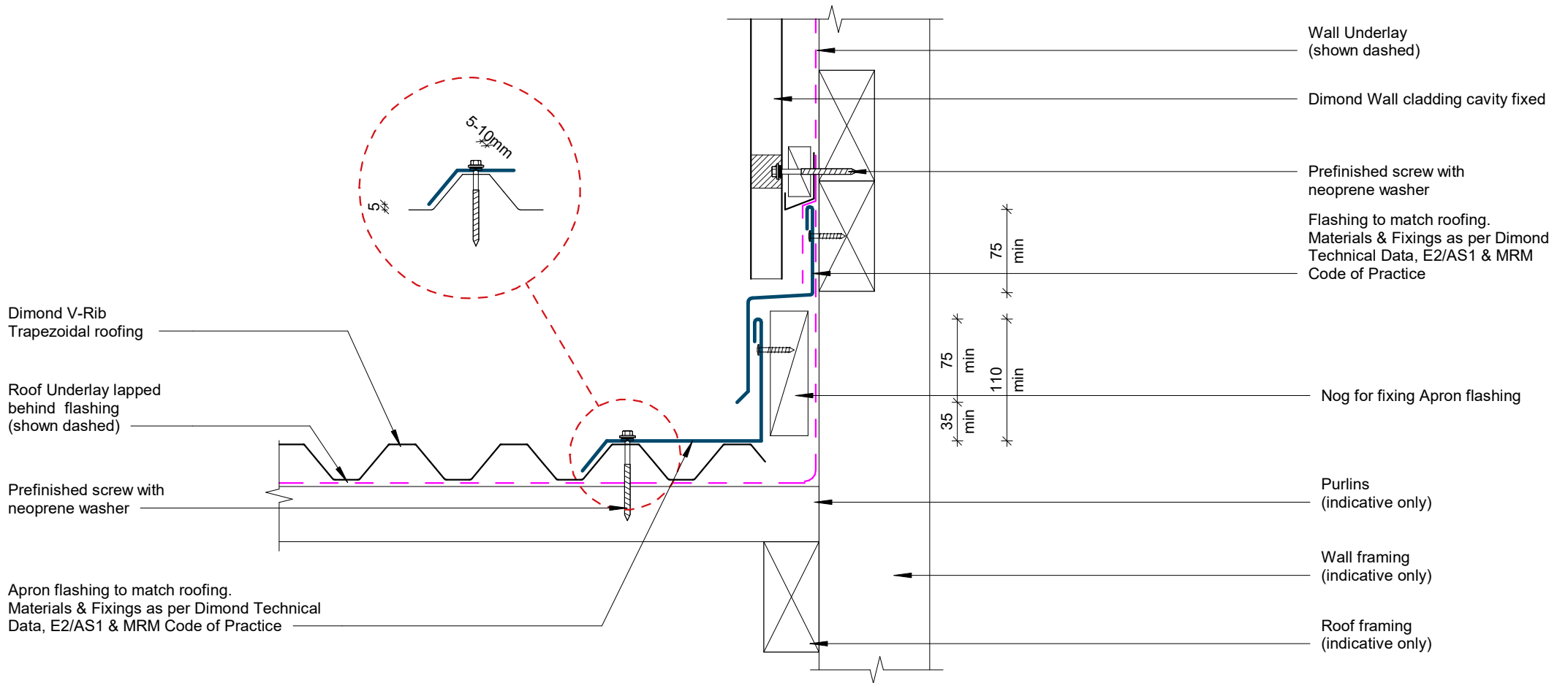

**GENERAL NOTE**

Cavity battens or timber framing that contain copper must be separated from steel cladding by a strip of wall or roof underlay or DPC.

# Apron Parallel Two Piece Detail



©Dimond 2023, all rights reserved. The information and specifications contained in this document are proprietary to Dimond and may not be used other than for the purpose of designing or building a roof or roofing system solely using products supplied or approved by Dimond ("Permitted Purpose"). You may copy this document solely for the Permitted Purpose, but may not otherwise copy, publish, distribute or modify this document without Dimond's prior written consent. Dimond will not be liable for any use of this document or information and specifications contained in this document, other than for the Permitted Purpose

Rev: 1

V-Rib Residential Roofing

Date: May 2025 Scale: 1 : 5 Sheet: VRRR9

**COVER DIMENSIONS AS PER E2/AS1**

	<b>SITUATION 1</b>	<b>SITUATION 2</b>	<b>SITUATION 3</b>
	Low, Medium & High Wind Zones where roof pitch $\geq 10^\circ$ (Excludes any soft edge or turn-down)	All roof pitches in Very High zone. Low, Medium & High Wind Zones where roof pitch $\leq 10^\circ$ (Excludes any soft edge or turn-down)	All roof pitches in Extra High wind zone (Excludes any soft edge or turn-down)
<b>X</b>	130mm MIN	200mm MIN	200mm MIN
<b>Y</b>	Cover at least two crests (turned-up edge to full crest height constitutes a crest)		
<b>Z</b>	50mm MIN	70mm MIN	90mm MIN

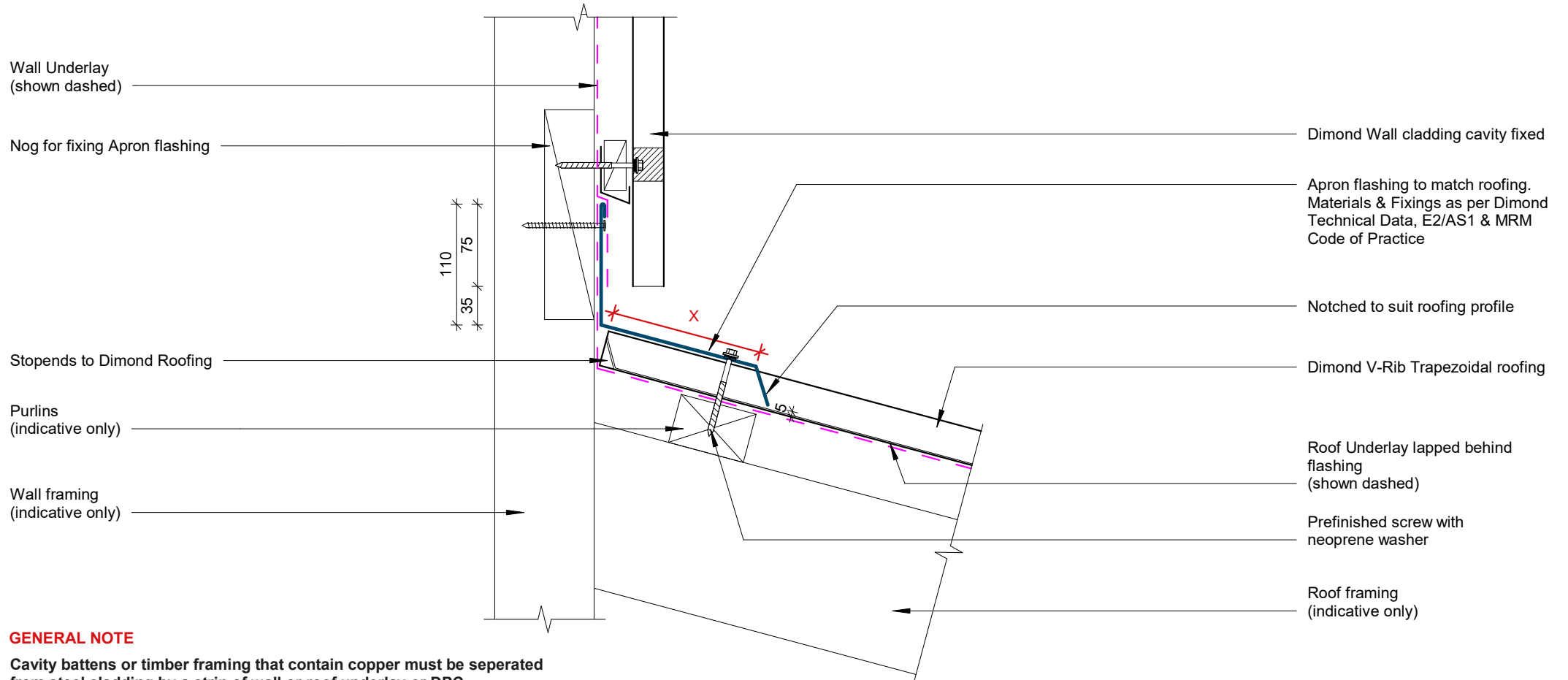

**GENERAL NOTE**

Cavity battens or timber framing that contain copper must be separated from steel cladding by a strip of wall or roof underlay or DPC.

# Apron Transverse Detail

Rev: 1

V-Rib Residential Roofing



©Dimond 2023, all rights reserved. The information and specifications contained in this document are proprietary to Dimond and may not be used other than for the purpose of designing or building a roof or roofing system solely using products supplied or approved by Dimond ("Permitted Purpose"). You may copy this document solely for the Permitted Purpose, but may not otherwise copy, publish, distribute or modify this document without Dimond's prior written consent. Dimond will not be liable for any use of this document or information and specifications contained in this document, other than for the Permitted Purpose

Date: May 2025 Scale: 1 : 5 Sheet: **VRRR10**

COVER DIMENSIONS AS PER E2/AS1		
SITUATION 1	SITUATION 2	SITUATION 3
Low, Medium & High Wind Zones where roof pitch $\geq 10^\circ$ (Excludes any soft edge or turn-down)	All roof pitches in Very High zone. Low, Medium & High Wind Zones where roof pitch $\leq 10^\circ$ (Excludes any soft edge or turn-down)	All roof pitches in Extra High wind zone (Excludes any soft edge or turn-down)
<b>X</b> 130mm MIN	200mm MIN	200mm MIN
<b>Y</b> Cover at least two crests (turned-up edge to full crest height constitutes a crest)		
<b>Z</b> 50mm MIN	70mm MIN	90mm MIN

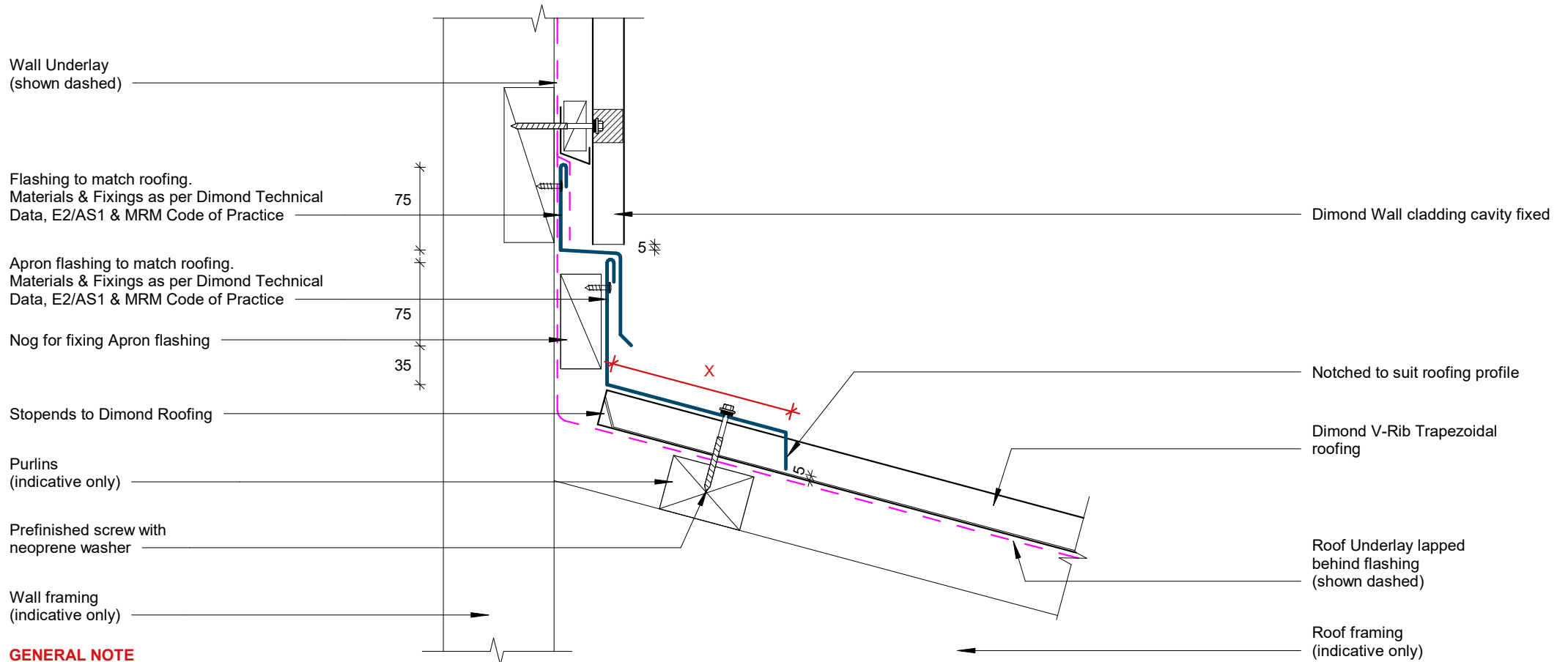

**GENERAL NOTE**

Cavity battens or timber framing that contain copper must be separated from steel cladding by a strip of wall or roof underlay or DPC.

## Apron Transverse Two Piece Detail

**COVER DIMENSIONS AS PER E2/AS1**

**SITUATION 1**

Low, Medium & High Wind Zones where roof pitch  $\geq 10^\circ$   
(Excludes any soft edge or turn-down)

**SITUATION 2**

All roof pitches in Very High zone.  
Low, Medium & High Wind Zones where roof pitch  $\leq 10^\circ$   
(Excludes any soft edge or turn-down)

<b>X</b>	130mm MIN	200mm MIN
<b>Y</b>	Cover at least two crests (turned-up edge to full crest height constitutes a crest)	
<b>Z</b>	50mm MIN	70mm MIN

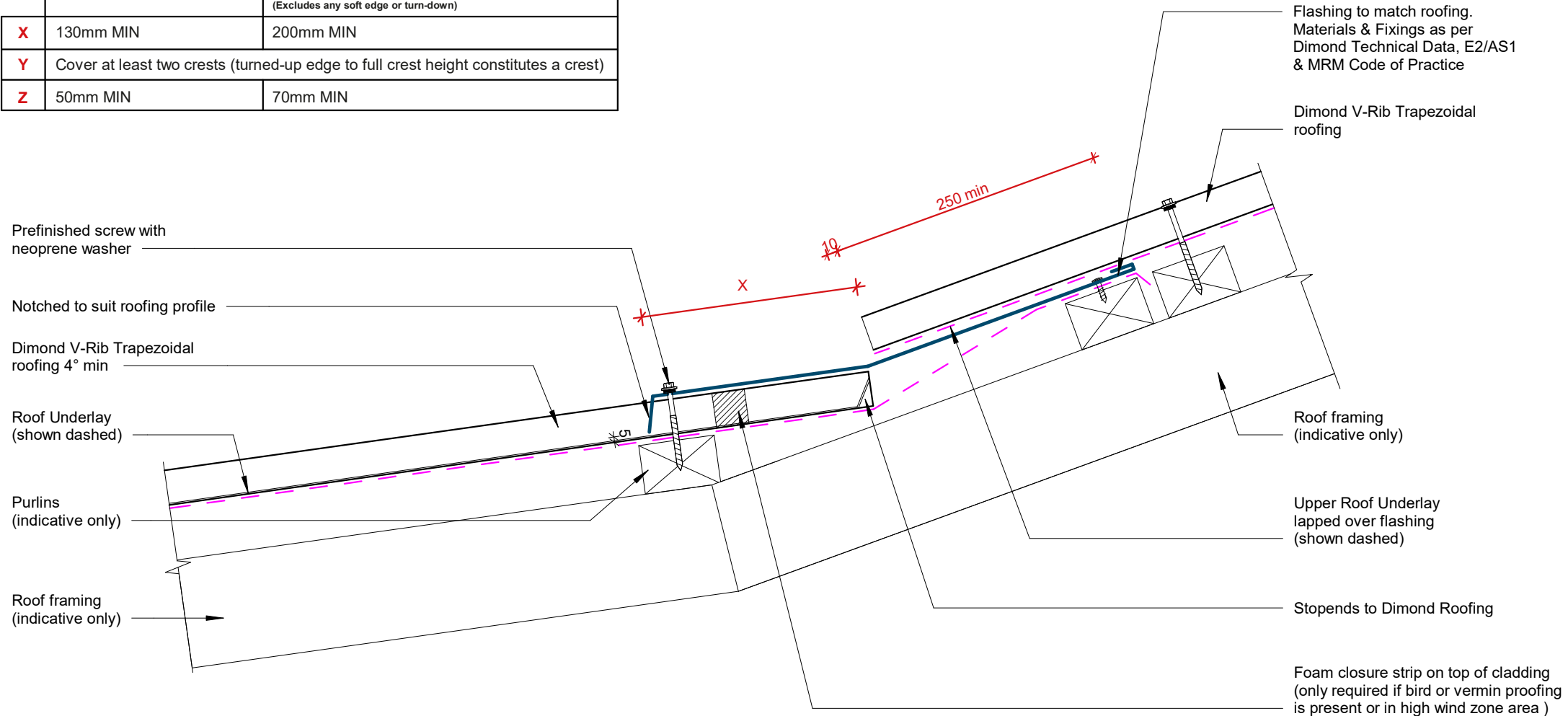

# Change of Pitch Detail



**(Alternative Option)**  
©Dimond 2023, all rights reserved. The information and specifications contained in this document are proprietary to Dimond and may not be used other than for the purpose of designing or building a roof or roofing system solely using products supplied or approved by Dimond ("Permitted Purpose"). You may copy this document solely for the Permitted Purpose, but may not otherwise copy, publish, distribute or modify this document without Dimond's prior written consent. Dimond will not be liable for any use of this document or information and specifications contained in this document, other than for the Permitted Purpose

Rev: 1

**V-Rib Residential Roofing**

Date: May 2025 Scale: 1 : 5 Sheet: **VRRR12**

COVER DIMENSIONS AS PER E2/AS1		
SITUATION 1	SITUATION 2	SITUATION 3
Low, Medium & High Wind Zones where roof pitch $\geq 10^\circ$ (Excludes any soft edge or turn-down)	All roof pitches in Very High zone. Low, Medium & High Wind Zones where roof pitch $\leq 10^\circ$ (Excludes any soft edge or turn-down)	All roof pitches in Extra High wind zone (Excludes any soft edge or turn-down)
<b>X</b> 130mm MIN	200mm MIN	200mm MIN
<b>Y</b> Cover at least two crests (turned-up edge to full crest height constitutes a crest)		
<b>Z</b> 50mm MIN	70mm MIN	90mm MIN

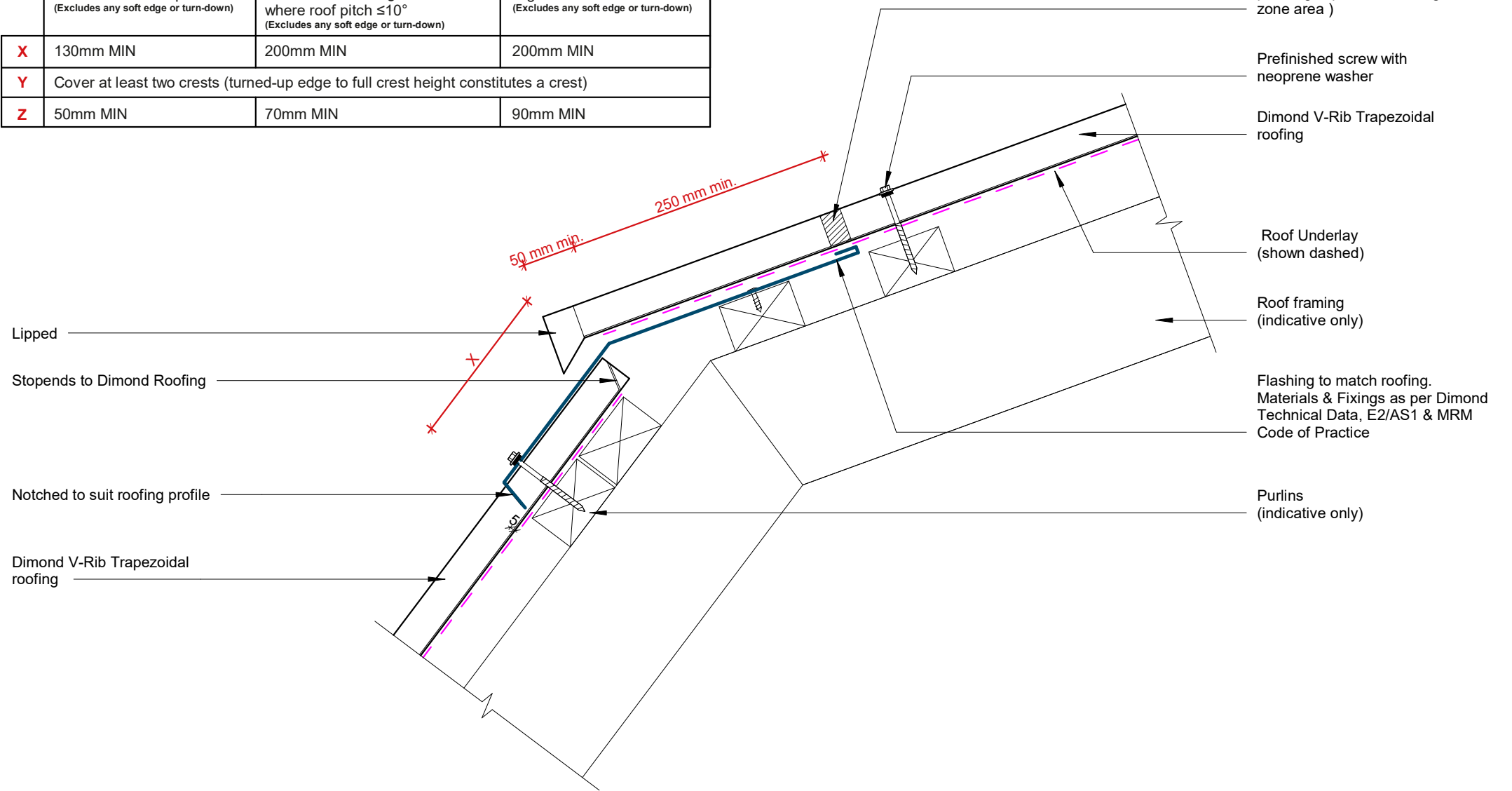

# Mansard Detail

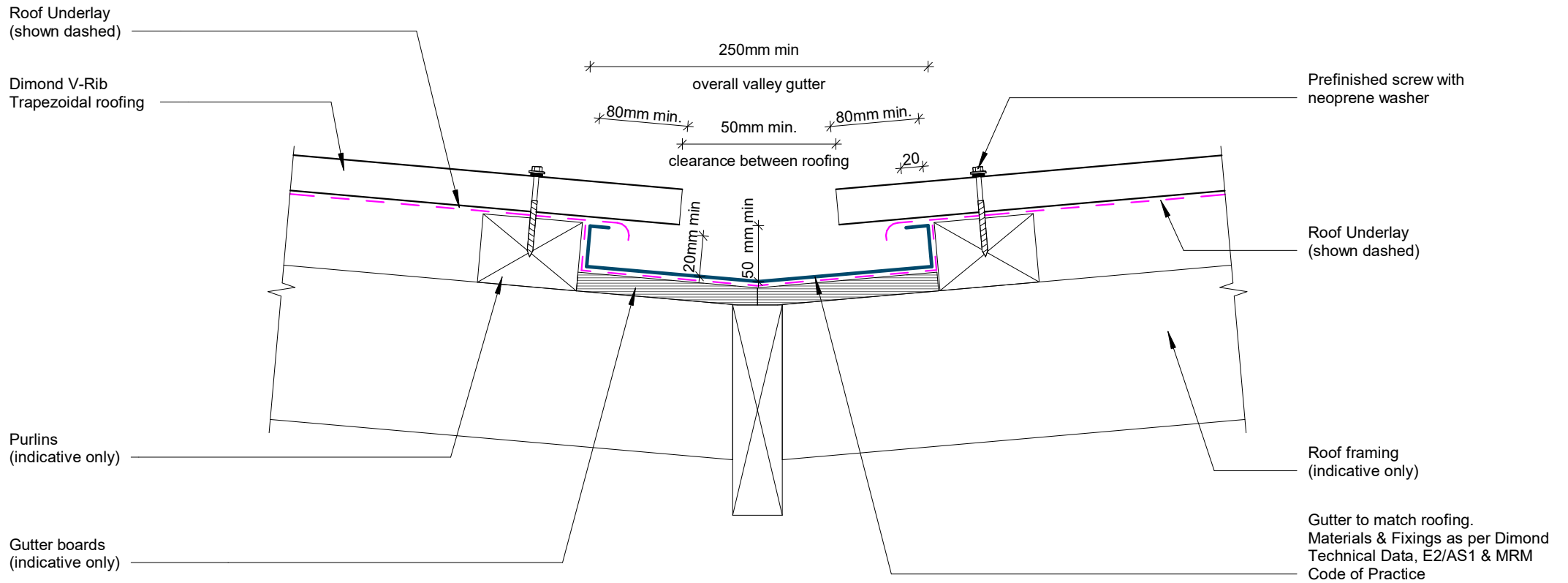

Refer to New Zealand metal roof manufacturers code of practice for design & minimum dimensions for valley gutter.

## Valley Detail

Gutter size to E2/AS1 or MRM Code of practice.  
Refer to New Zealand metal roof manufacturers code of practice for design & minimum dimensions.

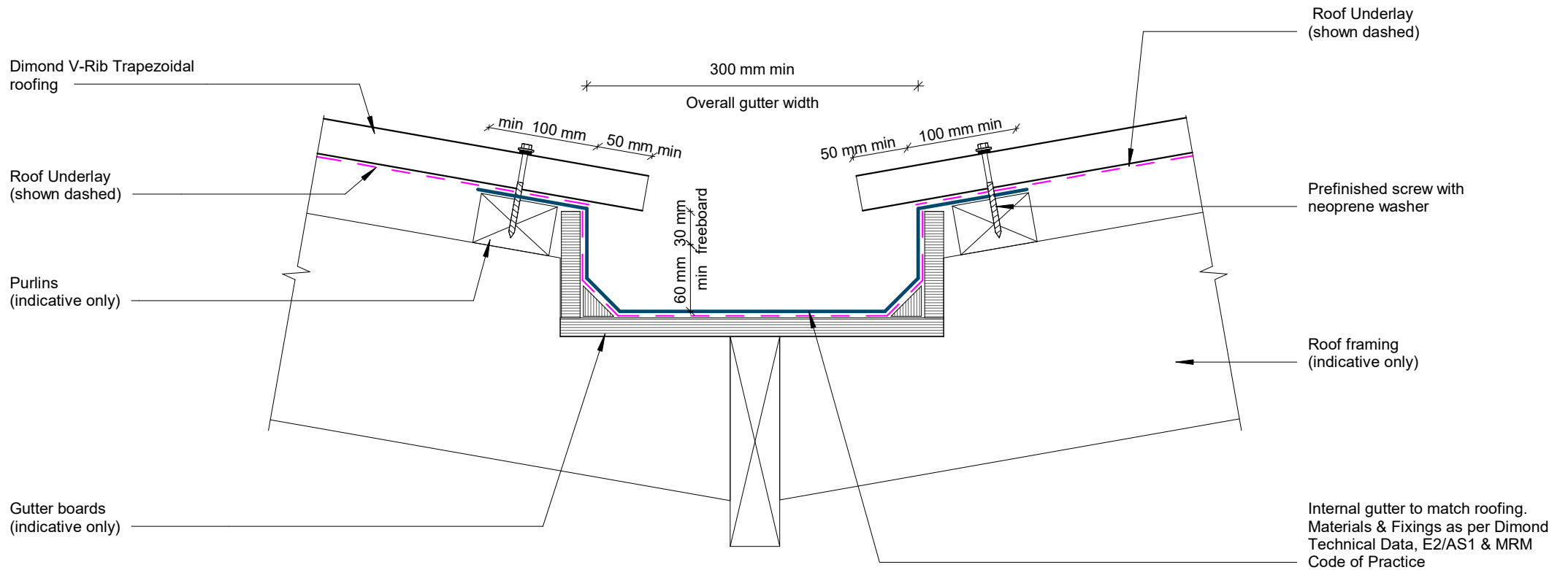

## Internal Gutter Detail

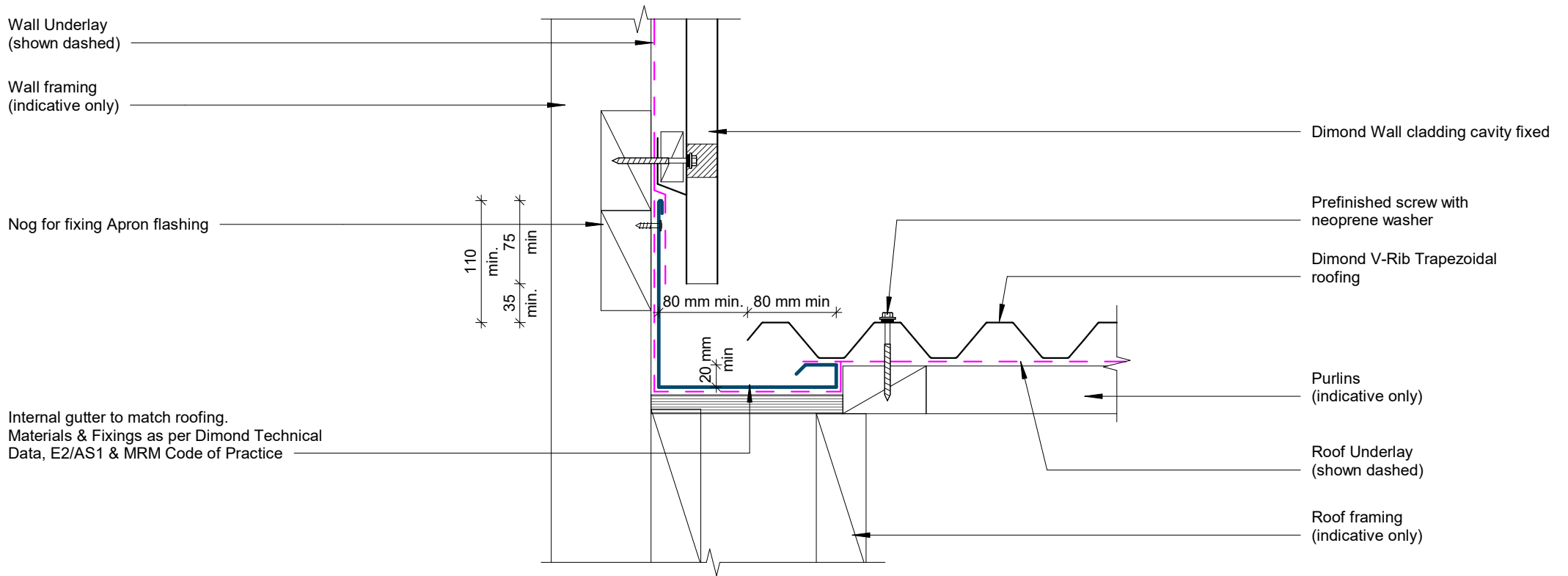

**GENERAL NOTE**

Cavity battens or timber framing that contain copper must be separated from steel cladding by a strip of wall or roof underlay or DPC.

# Parallel Hidden Gutter Detail

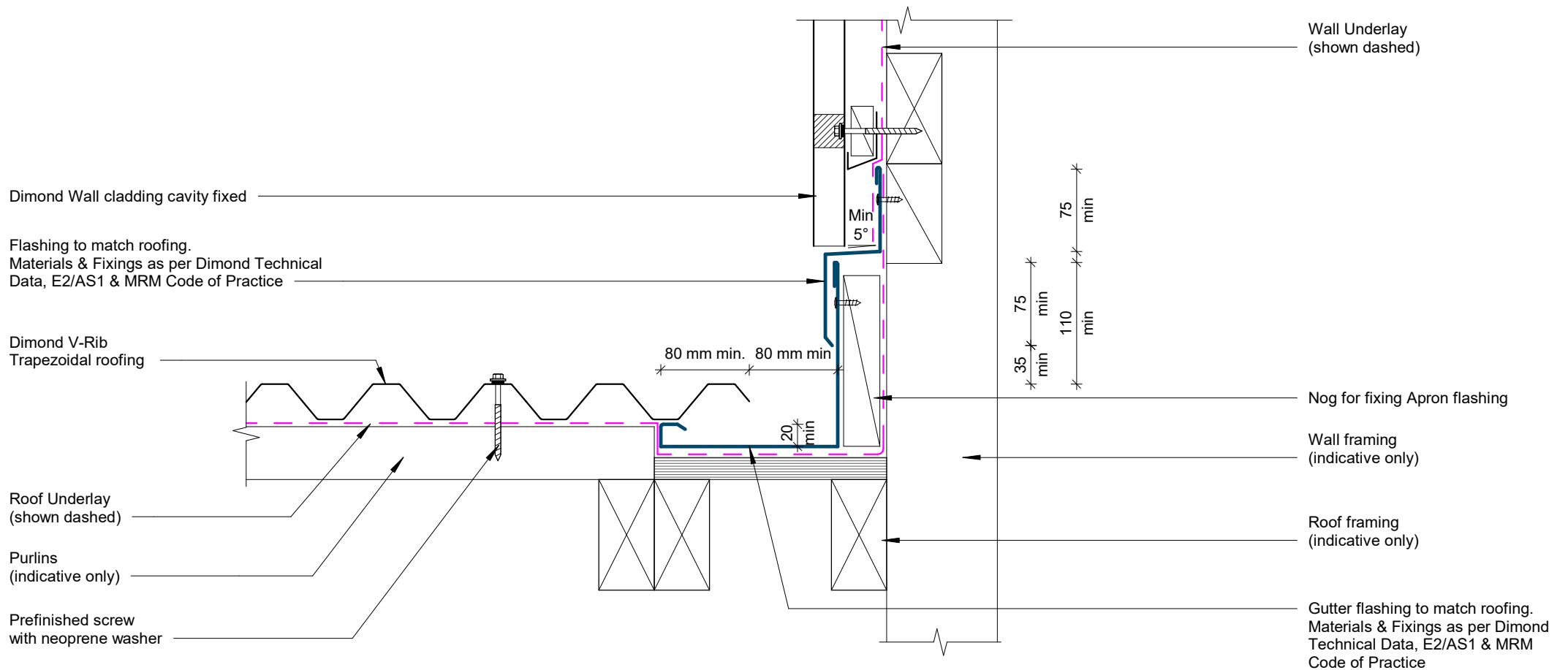

**GENERAL NOTE**

Cavity battens or timber framing that contain copper must be separated from steel cladding by a strip of wall or roof underlay or DPC.

## Parallel Hidden Gutter Two Piece Detail

COVER DIMENSIONS AS PER E2/AS1		
SITUATION 1	SITUATION 2	SITUATION 3
Low, Medium & High Wind Zones where roof pitch $\geq 10^\circ$ (Excludes any soft edge or turn-down)	All roof pitches in Very High zone. Low, Medium & High Wind Zones where roof pitch $\leq 10^\circ$ (Excludes any soft edge or turn-down)	All roof pitches in Extra High wind zone (Excludes any soft edge or turn-down)
<b>X</b> 130mm MIN	200mm MIN	200mm MIN
<b>Y</b> Cover at least two crests (turned-up edge to full crest height constitutes a crest)		
<b>Z</b> 50mm MIN	70mm MIN	90mm MIN

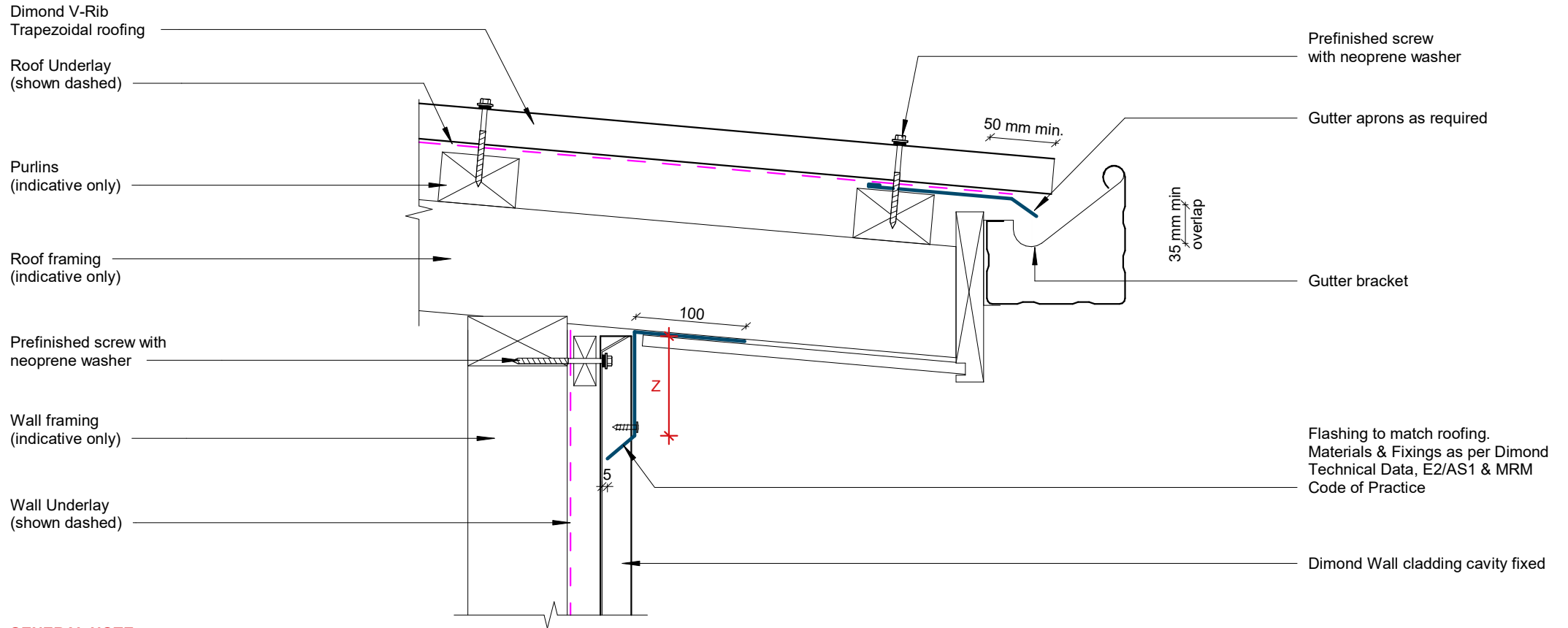

**GENERAL NOTE**

Cavity battens or timber framing that contain copper must be separated from steel cladding by a strip of wall or roof underlay or DPC.

# Eave Detail

**Note:**

Min 10° for pipe penetration direct fix boot flashing is applicable for when less than 50% blockage occurs.

When exceeding 50% blockage, refer to back tray boot flashing.

Refer MRM code of practice.

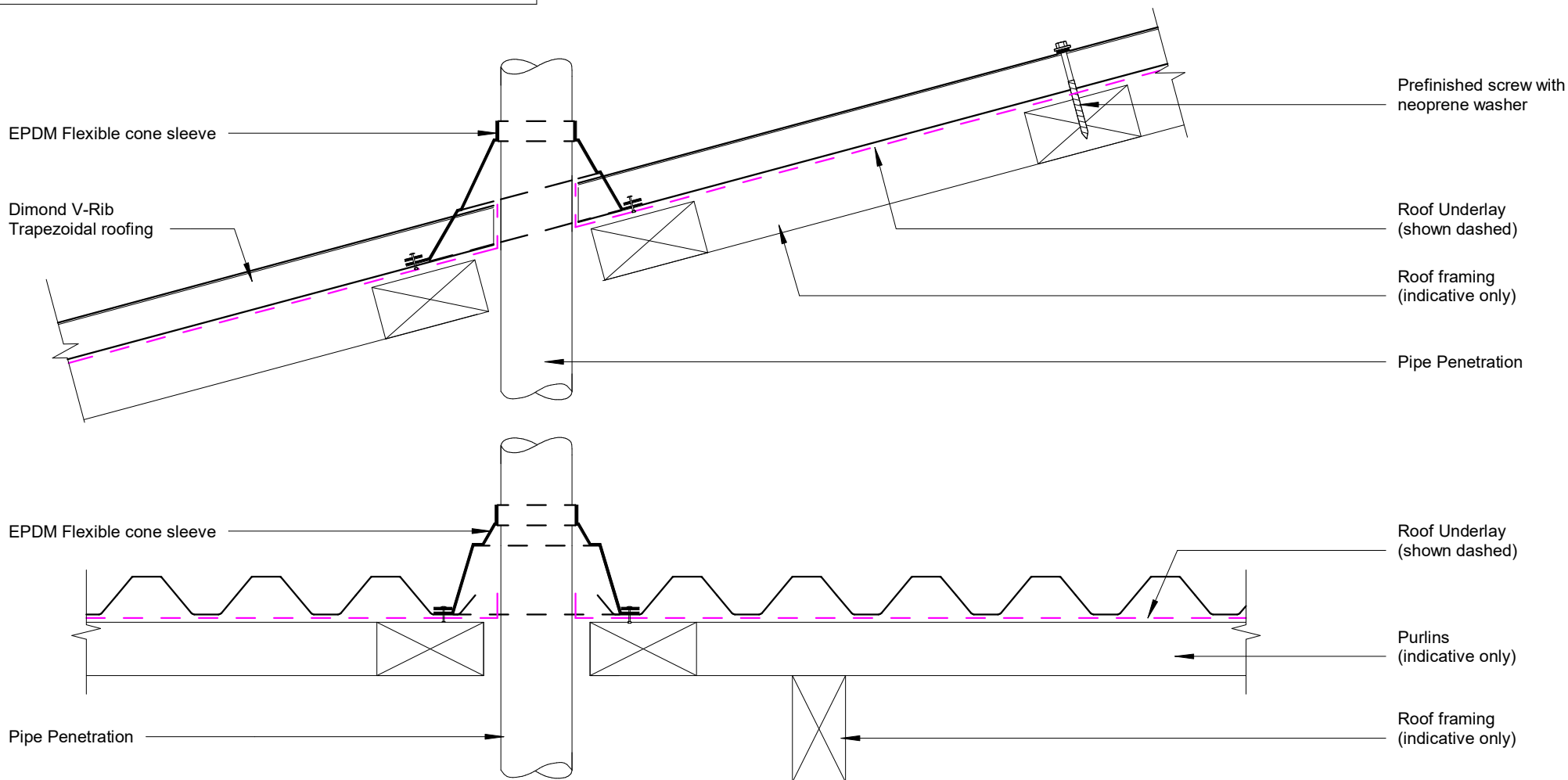

## Pipe Penetration Direct Fix Detail

**COVER DIMENSIONS AS PER E2/AS1**

	<b>SITUATION 1</b>	<b>SITUATION 2</b>	<b>SITUATION 3</b>
	Low, Medium & High Wind Zones where roof pitch $\geq 10^\circ$ (Excludes any soft edge or turn-down)	All roof pitches in Very High zone. Low, Medium & High Wind Zones where roof pitch $\leq 10^\circ$ (Excludes any soft edge or turn-down)	All roof pitches in Extra High wind zone (Excludes any soft edge or turn-down)
<b>X</b>	130mm MIN	200mm MIN	200mm MIN
<b>Y</b>	Cover at least two crests (turned-up edge to full crest height constitutes a crest)		
<b>Z</b>	50mm MIN	70mm MIN	90mm MIN

**Note:**  
Min 4° for pipe penetration with a boot flashing.  
Refer MRM code of practice

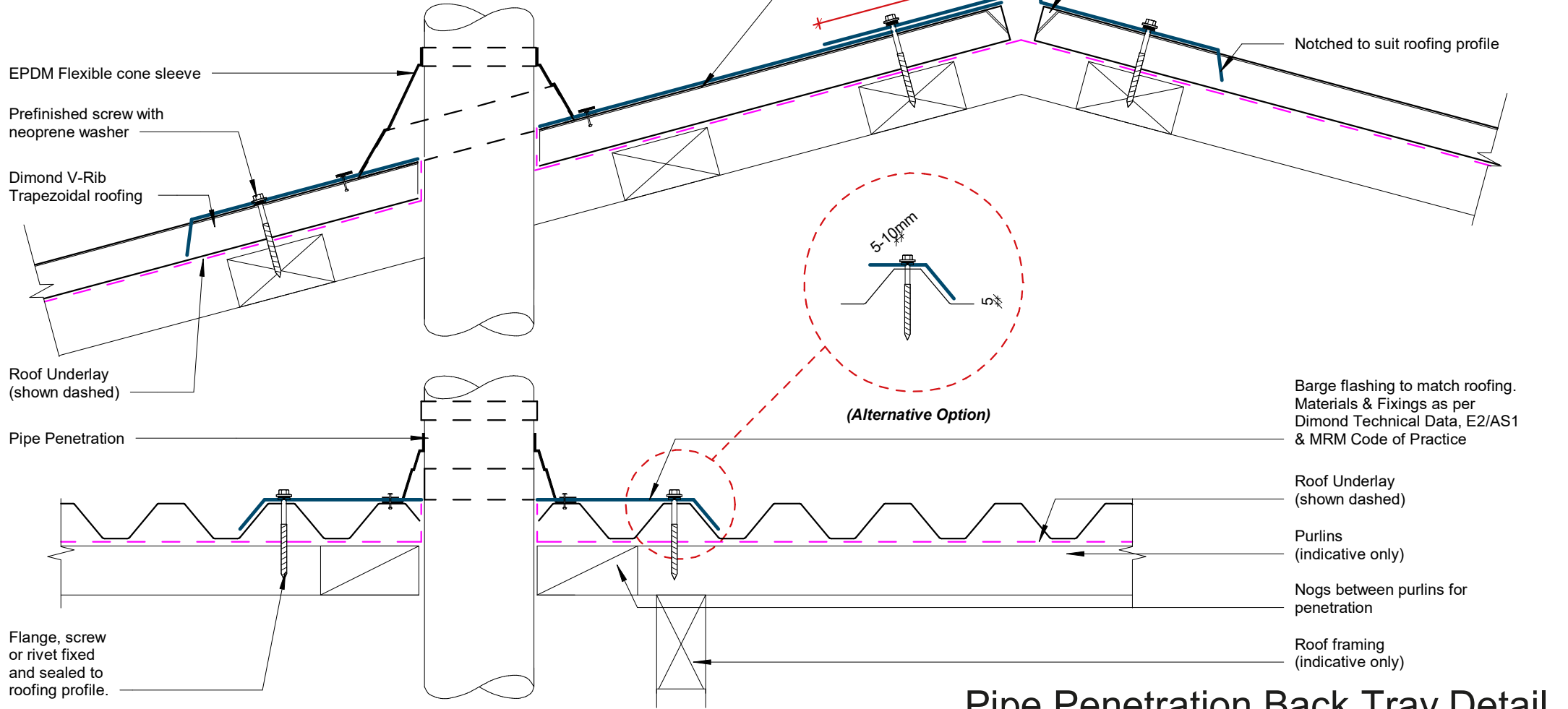

## Pipe Penetration Back Tray Detail