

# STYLELINE

## RESIDENTIAL ROOFING

### DETAILS:

### REV:

### DATE:

SRR00	Cover Sheet	1	May 2025
SRR01	Ridge Flashing Detail	1	May 2025
SRR02	Barge Wall Detail	1	May 2025
SRR03	Barge Soffit Detail	1	May 2025
SRR04	Raking Barge Flashing Detail	1	May 2025
SRR05	Sawtooth Wall Detail	1	May 2025
SRR06	Sawtooth Soffit Detail	1	May 2025
SRR07	Parapet Apron Detail	1	May 2025
SRR08	Apron Parallel Detail	1	May 2025
SRR09	Apron Parallel Two Piece Detail	1	May 2025
SRR10	Apron Transverse Detail	1	May 2025
SRR11	Apron Transverse Two Piece Detail	1	May 2025
SRR12	Change of Pitch Detail	1	May 2025
SRR13	Mansard Detail	1	May 2025
SRR14	Valley Detail	1	May 2025
SRR15	Internal Gutter Detail	1	May 2025
SRR16	Parallel Hidden Gutter Detail	1	May 2025
SRR17	Parallel Hidden Gutter Two Piece Detail	1	May 2025
SRR18	Eave Detail	1	May 2025
SRR19	Pipe Penetration Direct Fix Detail	1	May 2025
SRR20	Pipe Penetration Back Tray Detail	1	May 2025

**COVER DIMENSIONS AS PER E2/AS1**

	<b>SITUATION 1</b>	<b>SITUATION 2</b>	<b>SITUATION 3</b>
	Low, Medium & High Wind Zones where roof pitch $\geq 10^\circ$ (Excludes any soft edge or turn-down)	All roof pitches in Very High zone. Low, Medium & High Wind Zones where roof pitch $\leq 10^\circ$ (Excludes any soft edge or turn-down)	All roof pitches in Extra High wind zone (Excludes any soft edge or turn-down)
<b>X</b>	130 MIN	200 MIN	200 MIN
<b>Y</b>	Cover at least two crests (turned-up edge to full crest height constitutes a crest)		
<b>Z</b>	50mm MIN	70mm MIN	90 MIN

Ridge flashing to match roofing.  
Materials & Fixings as per Dimond Technical Data, E2/AS1 & MRM Code of Practice

Notched to suit roofing profile

Dimond Styleline Trapezoidal roofing

Roof Underlay (shown dashed)

Prefinished screw with neoprene washer

Soft edge dressed over ribs

*(Alternative Option)*

Slit 200 slots in underlay every 400 to allow ventilation

Stopends to Dimond Roofing

Prefinished screw with neoprene washer

Purlins (indicative only)

Roof framing (indicative only)

20 min. gap between sheet ends

# Ridge Flashing Detail

**COVER DIMENSIONS AS PER E2/AS1**

	<b>SITUATION 1</b>	<b>SITUATION 2</b>	<b>SITUATION 3</b>
	Low, Medium & High Wind Zones where roof pitch $\geq 10^\circ$ (Excludes any soft edge or turn-down)	All roof pitches in Very High zone. Low, Medium & High Wind Zones where roof pitch $\leq 10^\circ$ (Excludes any soft edge or turn-down)	All roof pitches in Extra High wind zone (Excludes any soft edge or turn-down)
<b>X</b>	130 MIN	200 MIN	200 MIN
<b>Y</b>	Cover at least two crests (turned-up edge to full crest height constitutes a crest)		
<b>Z</b>	50mm MIN	70mm MIN	90 MIN

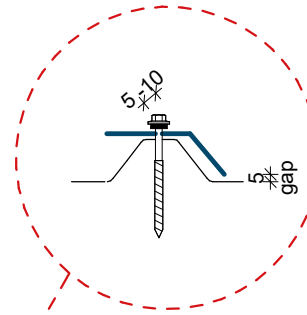

Barge flashing to match roofing.  
Materials & Fixings as per Dimond Technical Data, E2/AS1 & MRM Code of Practice

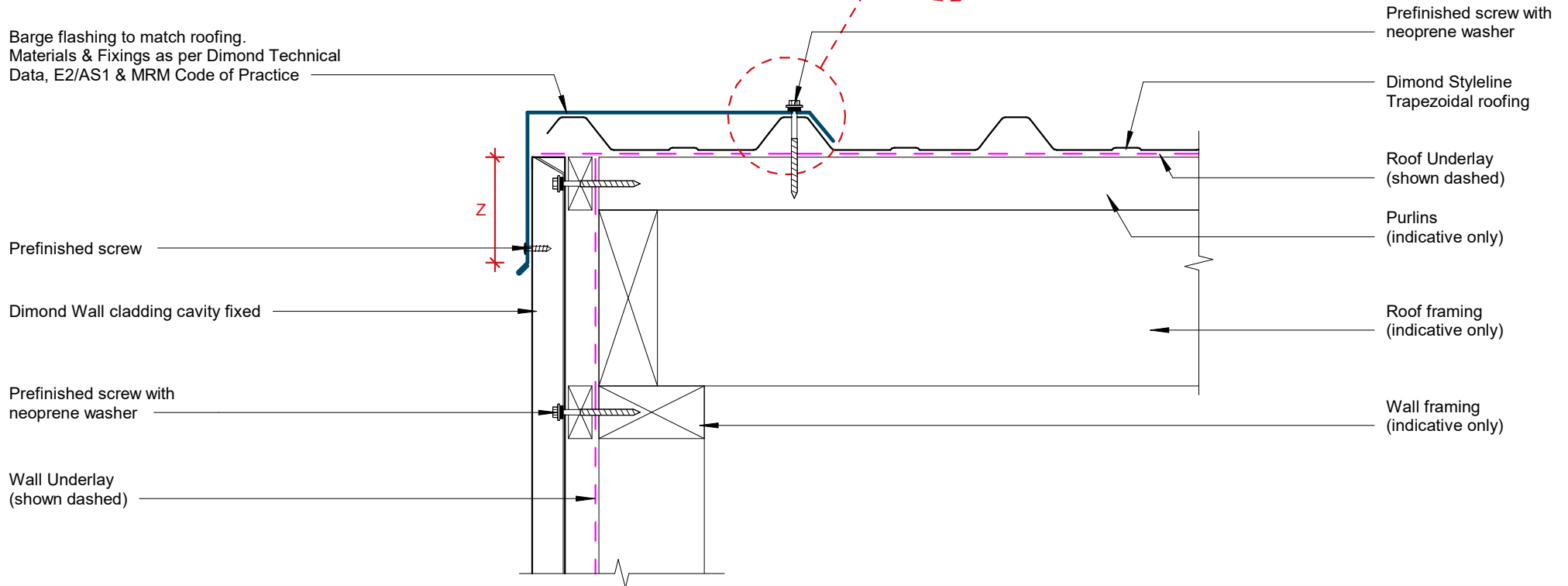

**GENERAL NOTE**

Cavity battens or timber framing that contain copper must be separated from steel cladding by a strip of wall or roof underlay or DPC.

# Barge Wall Detail

COVER DIMENSIONS AS PER E2/AS1		
SITUATION 1	SITUATION 2	SITUATION 3
Low, Medium & High Wind Zones where roof pitch $\geq 10^\circ$ (Excludes any soft edge or turn-down)	All roof pitches in Very High zone. Low, Medium & High Wind Zones where roof pitch $\leq 10^\circ$ (Excludes any soft edge or turn-down)	All roof pitches in Extra High wind zone (Excludes any soft edge or turn-down)
<b>X</b> 130 MIN	200 MIN	200 MIN
<b>Y</b> Cover at least two crests (turned-up edge to full crest height constitutes a crest)		
<b>Z</b> 50mm MIN	70mm MIN	90 MIN

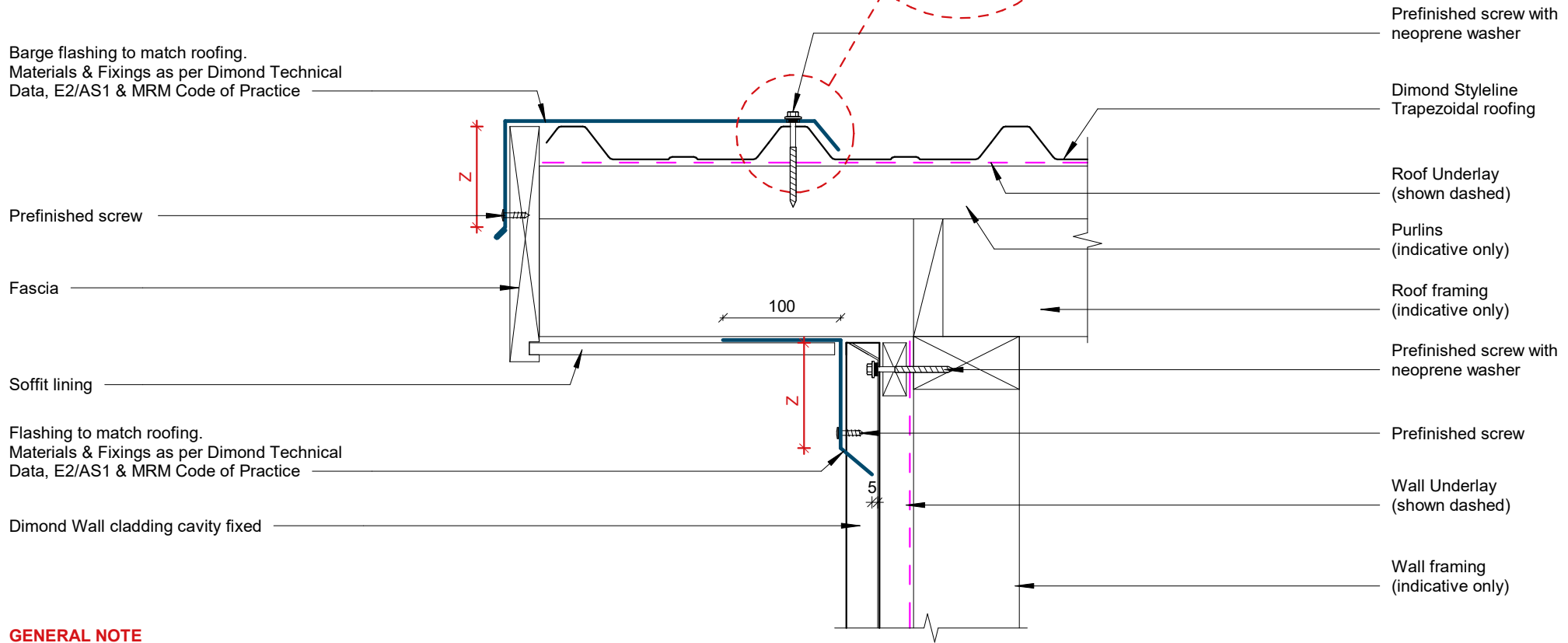
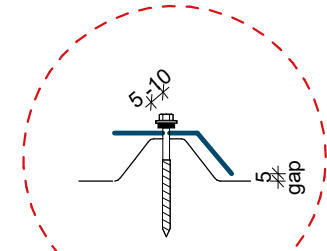

Barge flashing to match roofing.  
Materials & Fixings as per Dimond Technical Data, E2/AS1 & MRM Code of Practice

Prefinished screw

Fascia

Soffit lining

Flashing to match roofing.  
Materials & Fixings as per Dimond Technical Data, E2/AS1 & MRM Code of Practice

Dimond Wall cladding cavity fixed

Prefinished screw with neoprene washer

Dimond Styleline Trapezoidal roofing

Roof Underlay (shown dashed)

Purlins (indicative only)

Roof framing (indicative only)

Prefinished screw with neoprene washer

Prefinished screw

Wall Underlay (shown dashed)

Wall framing (indicative only)

**GENERAL NOTE**

Cavity battens or timber framing that contain copper must be separated from steel cladding by a strip of wall or roof underlay or DPC.

# Barge Soffit Detail



©Dimond 2023, all rights reserved. The information and specifications contained in this document are proprietary to Dimond and may not be used other than for the purpose of designing or building a roof or roofing system solely using products supplied or approved by Dimond ("Permitted Purpose"). You may copy this document solely for the Permitted Purpose, but may not otherwise copy, publish, distribute or modify this document without Dimond's prior written consent. Dimond will not be liable for any use of this document or information and specifications contained in this document, other than for the Permitted Purpose

Rev: 1 Styleline Residential Roofing

Date: May 2025 Scale: 1 : 5 Sheet: SRR03

**COVER DIMENSIONS AS PER E2/AS1**

	<b>SITUATION 1</b> Low, Medium & High Wind Zones where roof pitch $\geq 10^\circ$ (Excludes any soft edge or turn-down)	<b>SITUATION 2</b> All roof pitches in Very High zone. Low, Medium & High Wind Zones where roof pitch $\leq 10^\circ$ (Excludes any soft edge or turn-down)	<b>SITUATION 3</b> All roof pitches in Extra High wind zone (Excludes any soft edge or turn-down)
<b>X</b>	130 MIN	200 MIN	200 MIN
<b>Y</b>	Cover at least two crests (turned-up edge to full crest height constitutes a crest)		
<b>Z</b>	50mm MIN	70mm MIN	90 MIN

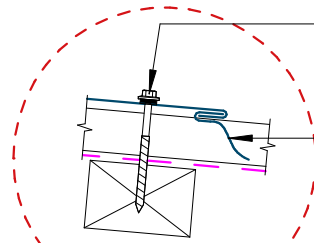

Barge flashing to match roofing.  
Materials & Fixings as per Dimond Technical Data, E2/AS1 & MRM Code of Practice

Stopends to Dimond Roofing

Prefinished screw

Fascia

Soffit lining

Flashing to match roofing Materials & Fixings as per Dimond Technical Data, E2/AS1 & MRM Code of Practice

Dimond Wall cladding cavity fixed

**GENERAL NOTE**

Cavity battens or timber framing that contain copper must be separated from steel cladding by a strip of wall or roof underlay or DPC.

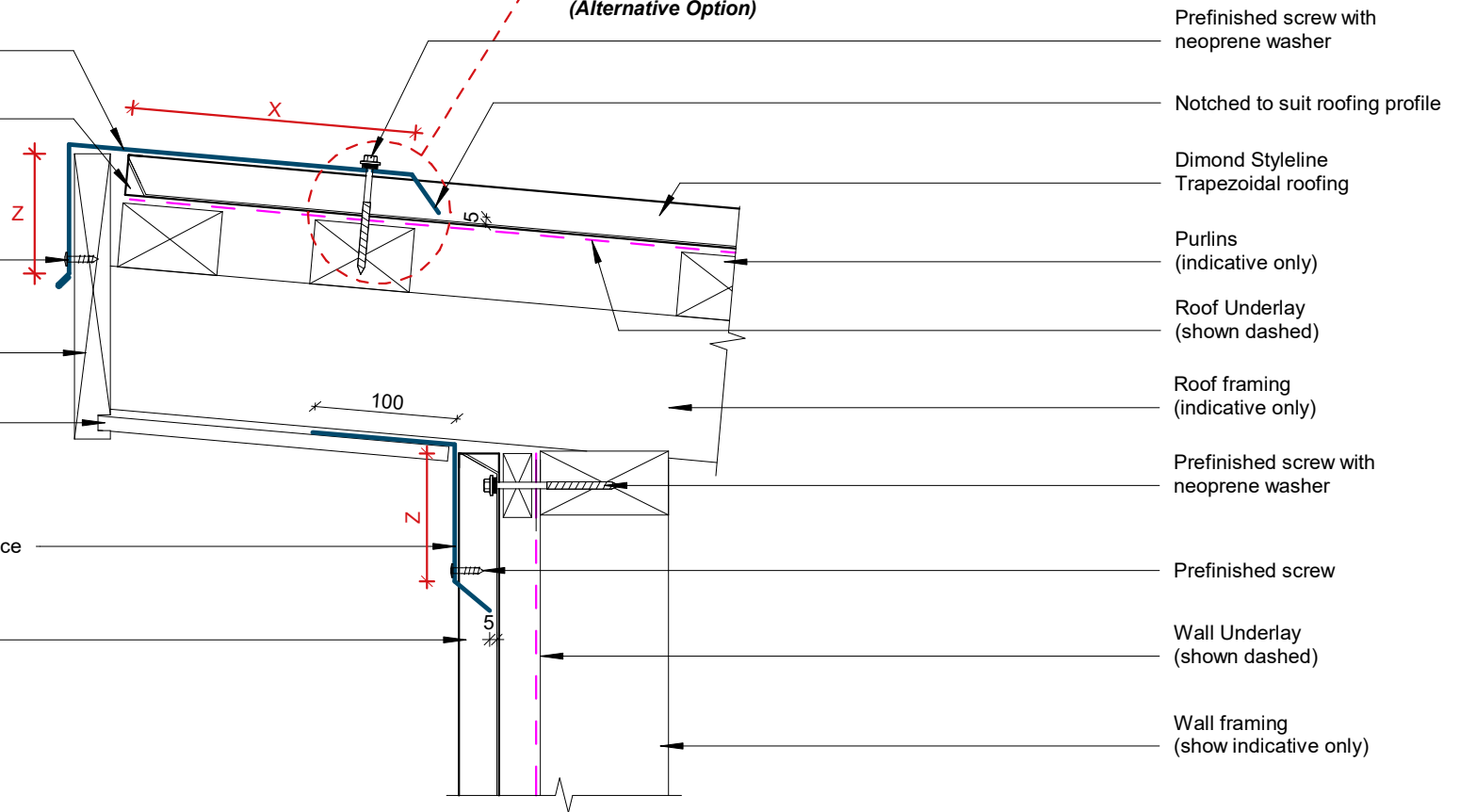

# Raking Barge Flashing Detail

Rev: 1

Styleline Residential Roofing



©Dimond 2023, all rights reserved. The information and specifications contained in this document are proprietary to Dimond and may not be used other than for the purpose of designing or building a roof or roofing system solely using products supplied or approved by Dimond ("Permitted Purpose"). You may copy this document solely for the Permitted Purpose, but may not otherwise copy, publish, distribute or modify this document without Dimond's prior written consent. Dimond will not be liable for any use of this document or information and specifications contained in this document, other than for the Permitted Purpose

Date: May 2025

Scale: 1 : 5

Sheet: SRR04

**COVER DIMENSIONS AS PER E2/AS1**

	<b>SITUATION 1</b>	<b>SITUATION 2</b>	<b>SITUATION 3</b>
	Low, Medium & High Wind Zones where roof pitch $\geq 10^\circ$ (Excludes any soft edge or turn-down)	All roof pitches in Very High zone. Low, Medium & High Wind Zones where roof pitch $\leq 10^\circ$ (Excludes any soft edge or turn-down)	All roof pitches in Extra High wind zone (Excludes any soft edge or turn-down)
<b>X</b>	130 MIN	200 MIN	200 MIN
<b>Y</b>	Cover at least two crests (turned-up edge to full crest height constitutes a crest)		
<b>Z</b>	50mm MIN	70mm MIN	90 MIN

Stopends to Dimond Roofing

Flashing to match roofing.  
Materials & Fixings as per Dimond Technical Data, E2/AS1 & MRM Code of Practice

Birds beak edge

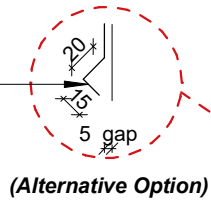

Prefinished screw

Wall Underlay (shown dashed)

Prefinished screw with neoprene washer

Dimond Wall cladding cavity fixed

**GENERAL NOTE**

Cavity battens or timber framing that contain copper must be separated from steel cladding by a strip of wall or roof underlay or DPC.

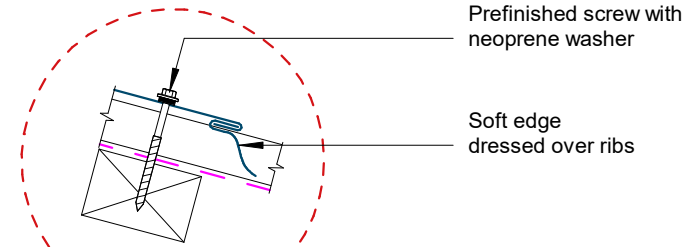

(Alternative Option)

Notched to suit roofing profile

Dimond Styleline Trapezoidal roofing

Roof Underlay lapped over Wall underlay (shown dashed)

Purlins (indicative only)

Roof framing (indicative only)

Wall framing (show indicative only)

# Sawtooth Wall Detail

COVER DIMENSIONS AS PER E2/AS1		
SITUATION 1	SITUATION 2	SITUATION 3
Low, Medium & High Wind Zones where roof pitch $\geq 10^\circ$ (Excludes any soft edge or turn-down)	All roof pitches in Very High zone. Low, Medium & High Wind Zones where roof pitch $\leq 10^\circ$ (Excludes any soft edge or turn-down)	All roof pitches in Extra High wind zone (Excludes any soft edge or turn-down)
<b>X</b> 130 MIN	200 MIN	200 MIN
<b>Y</b> Cover at least two crests (turned-up edge to full crest height constitutes a crest)		
<b>Z</b> 50mm MIN	70mm MIN	90 MIN

Flashing to match roofing.  
Materials & Fixings as per Dimond Technical Data, E2/AS1 & MRM Code of Practice

Stopends to Dimond Roofing

Birds beak edge

Prefinished screw

Fascia

Prefinished screw with neoprene washer

Soffit lining

Flashing to match roofing.  
Materials & Fixings as per Dimond Technical Data, E2/AS1 & MRM Code of Practice

**GENERAL NOTE**

Cavity battens or timber framing that contain copper must be separated from steel cladding by a strip of wall or roof underlay or DPC.

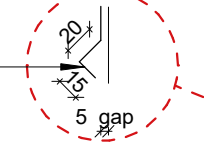

(Alternative Option)

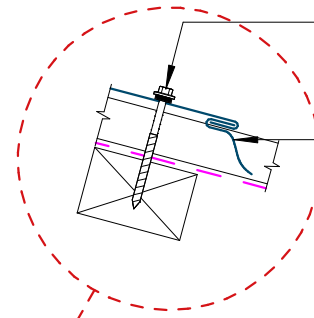

Prefinished screw with neoprene washer

Soft edge dressed over ribs

(Alternative Option)

Notched to suit roofing profile

Dimond Styleline Trapezoidal roofing

Roof Underlay lapped over Wall underlay (shown dashed)

Purlins (indicative only)

Roof framing (indicative only)

Prefinished screw with neoprene washer

Wall framing (shown indicative only)

Wall Underlay (shown dashed)

Dimond Wall cladding cavity fixed

# Sawtooth Soffit Detail

Rev: 1 Styleline Residential Roofing



©Dimond 2023, all rights reserved. The information and specifications contained in this document are proprietary to Dimond and may not be used other than for the purpose of designing or building a roof or roofing system solely using products supplied or approved by Dimond ("Permitted Purpose"). You may copy this document solely for the Permitted Purpose, but may not otherwise copy, publish, distribute or modify this document without Dimond's prior written consent. Dimond will not be liable for any use of this document or information and specifications contained in this document, other than for the Permitted Purpose

Date: May 2025 Scale: 1 : 5 Sheet: SRR06

COVER DIMENSIONS AS PER E2/AS1		
SITUATION 1	SITUATION 2	SITUATION 3
Low, Medium & High Wind Zones where roof pitch $\geq 10^\circ$ (Excludes any soft edge or turn-down)	All roof pitches in Very High zone. Low, Medium & High Wind Zones where roof pitch $\leq 10^\circ$ (Excludes any soft edge or turn-down)	All roof pitches in Extra High wind zone (Excludes any soft edge or turn-down)
<b>X</b> 130 MIN	200 MIN	200 MIN
<b>Y</b> Cover at least two crests (turned-up edge to full crest height constitutes a crest)		
<b>Z</b> 50mm MIN	70mm MIN	90 MIN

Parapet cap flashing to match roofing.  
Materials & Fixings as per Dimond Technical Data, E2/AS1 & MRM Code of Practice

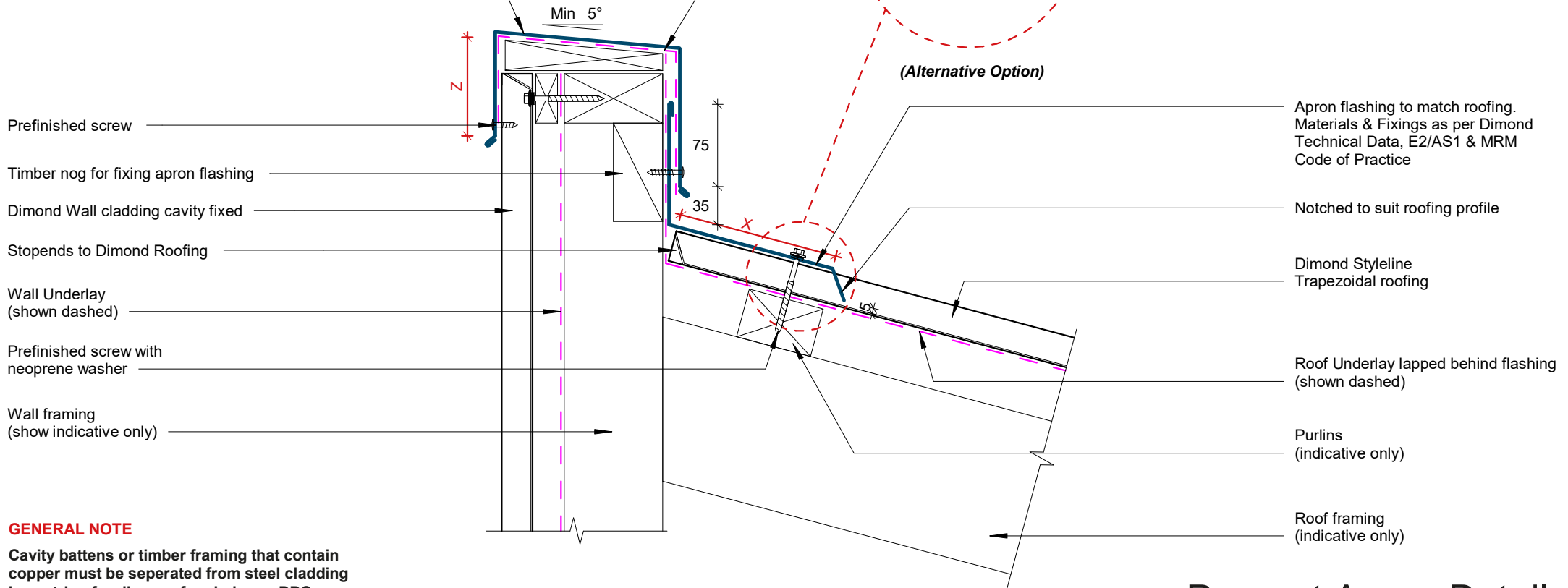

**GENERAL NOTE**

Cavity battens or timber framing that contain copper must be separated from steel cladding by a strip of wall or roof underlay or DPC.

# Parapet Apron Detail

Rev: 1 Styleline Residential Roofing



©Dimond 2023, all rights reserved. The information and specifications contained in this document are proprietary to Dimond and may not be used other than for the purpose of designing or building a roof or roofing system solely using products supplied or approved by Dimond ("Permitted Purpose"). You may copy this document solely for the Permitted Purpose, but may not otherwise copy, publish, distribute or modify this document without Dimond's prior written consent. Dimond will not be liable for any use of this document or information and specifications contained in this document, other than for the Permitted Purpose

Date: May 2025 Scale: 1 : 5 Sheet: SRR07

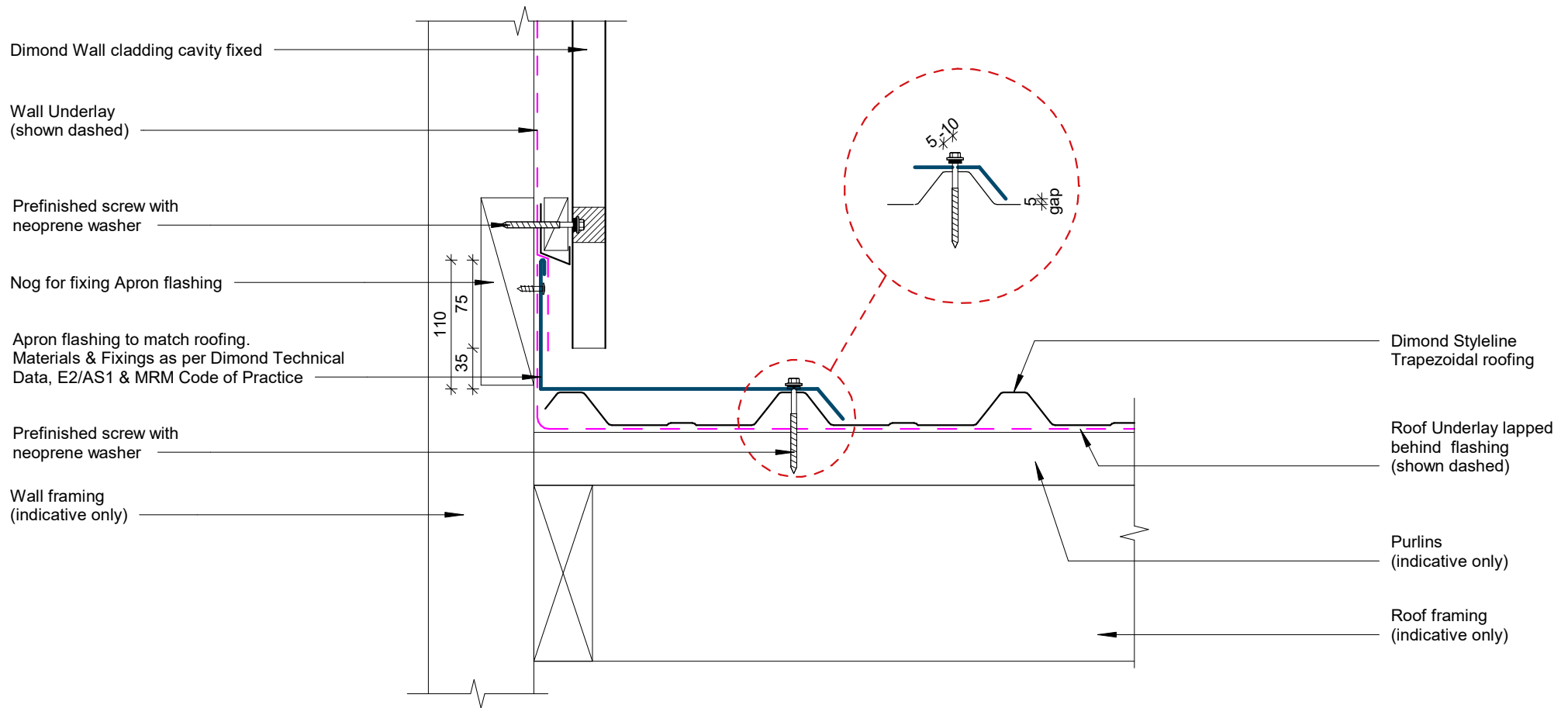

**GENERAL NOTE**

Cavity battens or timber framing that contain copper must be separated from steel cladding by a strip of wall or roof underlay or DPC.

# Apron Parallel Detail

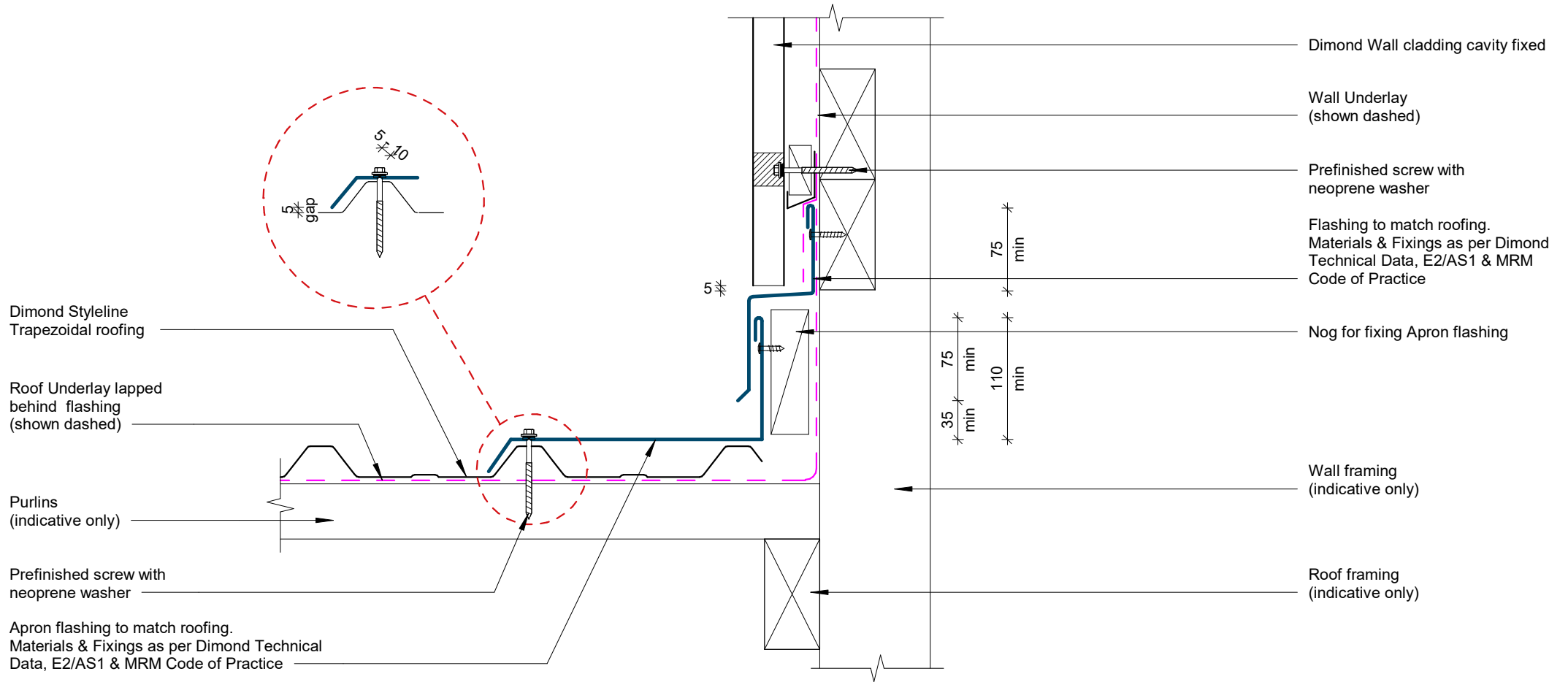

**GENERAL NOTE**

Cavity battens or timber framing that contain copper must be seperated from steel cladding by a strip of wall or roof underlay or DPC.

# Apron Parallel Two Piece Detail



©Dimond 2023, all rights reserved. The information and specifications contained in this document are proprietary to Dimond and may not be used other than for the purpose of designing or building a roof or roofing system solely using products supplied or approved by Dimond ("Permitted Purpose"). You may copy this document solely for the Permitted Purpose, but may not otherwise copy, publish, distribute or modify this document without Dimond's prior written consent. Dimond will not be liable for any use of this document or information and specifications contained in this document, other than for the Permitted Purpose

Rev: 1 **Styleline Residential Roofing**

Date: May 2025 Scale: 1 : 5 Sheet: **SRR09**

**COVER DIMENSIONS AS PER E2/AS1**

	<b>SITUATION 1</b>	<b>SITUATION 2</b>	<b>SITUATION 3</b>
	Low, Medium & High Wind Zones where roof pitch $\geq 10^\circ$ (Excludes any soft edge or turn-down)	All roof pitches in Very High zone. Low, Medium & High Wind Zones where roof pitch $\leq 10^\circ$ (Excludes any soft edge or turn-down)	All roof pitches in Extra High wind zone (Excludes any soft edge or turn-down)
<b>X</b>	130 MIN	200 MIN	200 MIN
<b>Y</b>	Cover at least two crests (turned-up edge to full crest height constitutes a crest)		
<b>Z</b>	50mm MIN	70mm MIN	90 MIN

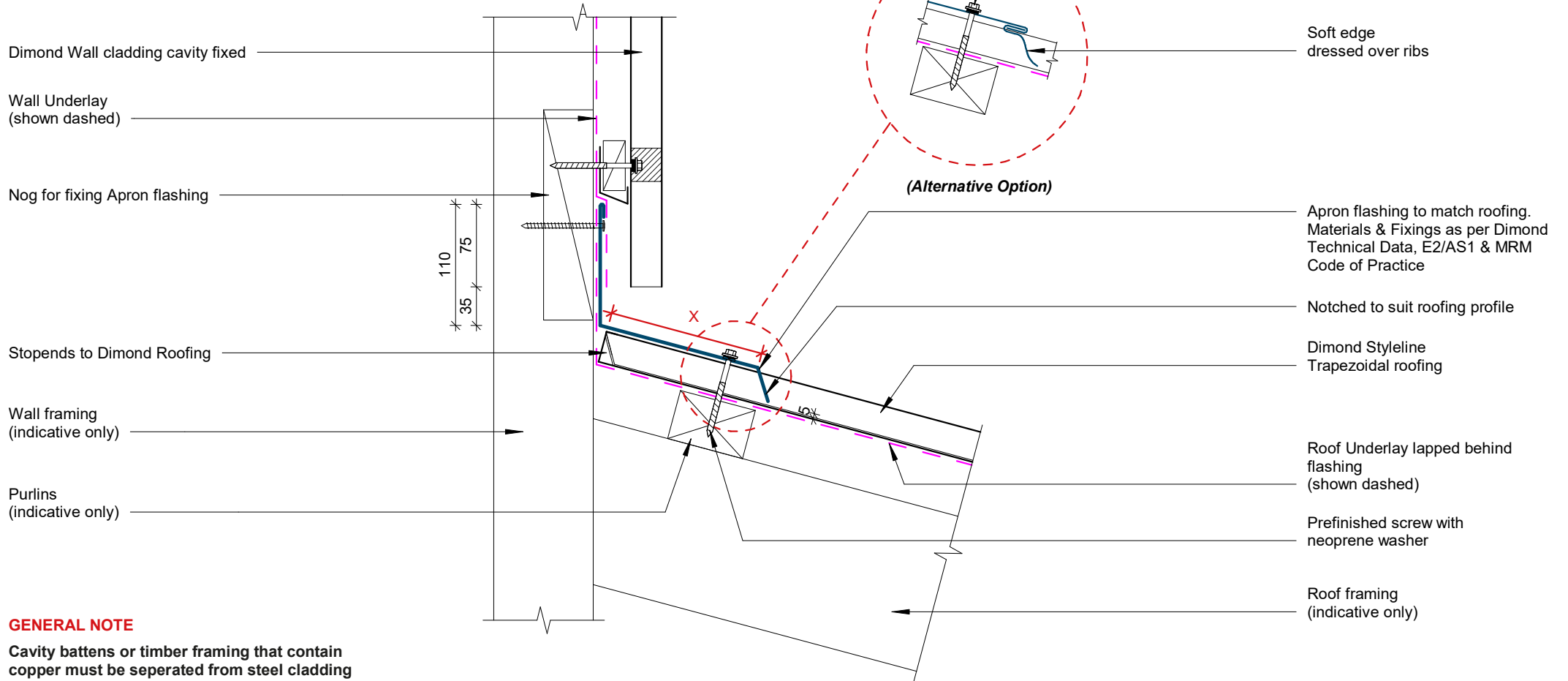

**GENERAL NOTE**

Cavity battens or timber framing that contain copper must be separated from steel cladding by a strip of wall or roof underlay or DPC.

# Apron Transverse Detail



©Dimond 2023, all rights reserved. The information and specifications contained in this document are proprietary to Dimond and may not be used other than for the purpose of designing or building a roof or roofing system solely using products supplied or approved by Dimond ("Permitted Purpose"). You may copy this document solely for the Permitted Purpose, but may not otherwise copy, publish, distribute or modify this document without Dimond's prior written consent. Dimond will not be liable for any use of this document or information and specifications contained in this document, other than for the Permitted Purpose

Rev: 1 **Styleline Residential Roofing**

Date: May 2025 Scale: 1 : 5 Sheet: **SRR10**

**COVER DIMENSIONS AS PER E2/AS1**

	<b>SITUATION 1</b> Low, Medium & High Wind Zones where roof pitch $\geq 10^\circ$ (Excludes any soft edge or turn-down)	<b>SITUATION 2</b> All roof pitches in Very High zone. Low, Medium & High Wind Zones where roof pitch $\leq 10^\circ$ (Excludes any soft edge or turn-down)	<b>SITUATION 3</b> All roof pitches in Extra High wind zone (Excludes any soft edge or turn-down)
<b>X</b>	130 MIN	200 MIN	200 MIN
<b>Y</b>	Cover at least two crests (turned-up edge to full crest height constitutes a crest)		
<b>Z</b>	50mm MIN	70mm MIN	90 MIN

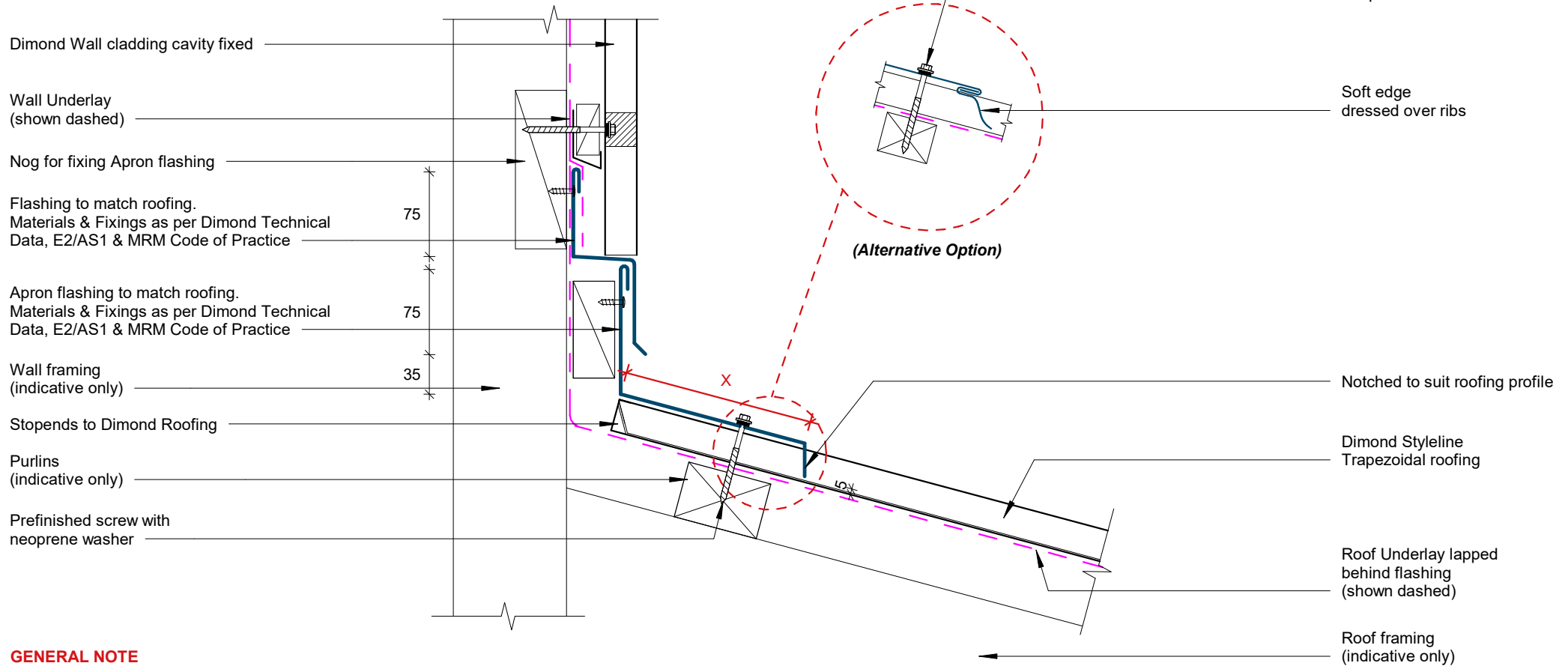

**GENERAL NOTE**

Cavity battens or timber framing that contain copper must be separated from steel cladding by a strip of wall or roof underlay or DPC.

**Apron Transverse Two Piece Detail**

**COVER DIMENSIONS AS PER E2/AS1**

**SITUATION 1**

Low, Medium & High Wind Zones where roof pitch  $\geq 10^\circ$   
(Excludes any soft edge or turn-down)

**SITUATION 2**

All roof pitches in Very High zone.  
Low, Medium & High Wind Zones where roof pitch  $\leq 10^\circ$   
(Excludes any soft edge or turn-down)

<b>X</b>	130mm MIN	200mm MIN
<b>Y</b>	Cover at least two crests (turned-up edge to full crest height constitutes a crest)	
<b>Z</b>	50mm MIN	70mm MIN

Prefinished screw with neoprene washer

Notched to suit roofing profile

Dimond Styleline Trapezoidal roofing 3° min

Roof Underlay (shown dashed)

Purlins (indicative only)

Roof framing (indicative only)

Soft edge dressed over ribs

Prefinished screw with neoprene washer

Flashing to match roofing. Materials & Fixings as per Dimond Technical Data, E2/AS1 & MRM Code of Practice

Dimond Styleline Trapezoidal roofing

Roof framing (indicative only)

Upper Roof Underlay lapped over flashing (shown dashed)

Stops to Dimond Roofing

Foam closure strip on top of cladding (only required if bird or vermin proofing is present or in high wind zone area)

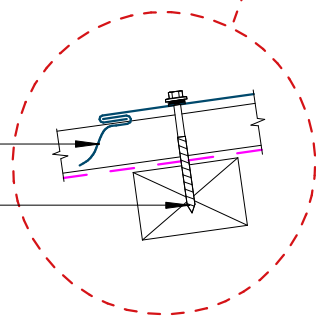

*(Alternative Option)*

# Change of Pitch Detail

Rev: 1 **Styleline Residential Roofing**



©Dimond 2023, all rights reserved. The information and specifications contained in this document are proprietary to Dimond and may not be used other than for the purpose of designing or building a roof or roofing system solely using products supplied or approved by Dimond ("Permitted Purpose"). You may copy this document solely for the Permitted Purpose, but may not otherwise copy, publish, distribute or modify this document without Dimond's prior written consent. Dimond will not be liable for any use of this document or information and specifications contained in this document, other than for the Permitted Purpose

Date: May 2025 Scale: 1 : 5 Sheet: **SRR12**

**COVER DIMENSIONS AS PER E2/AS1**

	<b>SITUATION 1</b> Low, Medium & High Wind Zones where roof pitch $\geq 10^\circ$ (Excludes any soft edge or turn-down)	<b>SITUATION 2</b> All roof pitches in Very High zone. Low, Medium & High Wind Zones where roof pitch $\leq 10^\circ$ (Excludes any soft edge or turn-down)	<b>SITUATION 3</b> All roof pitches in Extra High wind zone (Excludes any soft edge or turn-down)
<b>X</b>	130 MIN	200 MIN	200 MIN
<b>Y</b>	Cover at least two crests (turned-up edge to full crest height constitutes a crest)		
<b>Z</b>	50mm MIN	70mm MIN	90 MIN

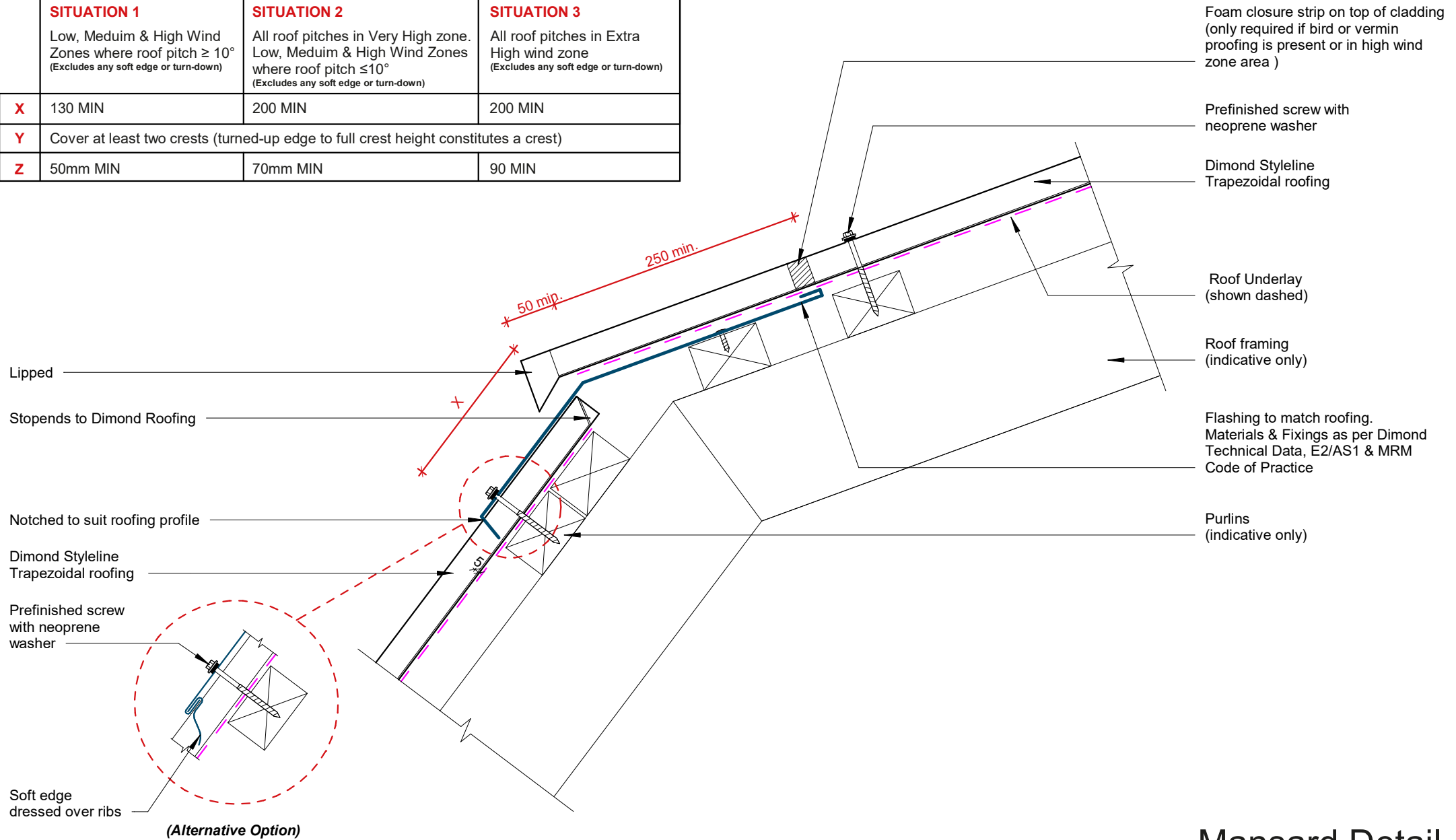

# Mansard Detail

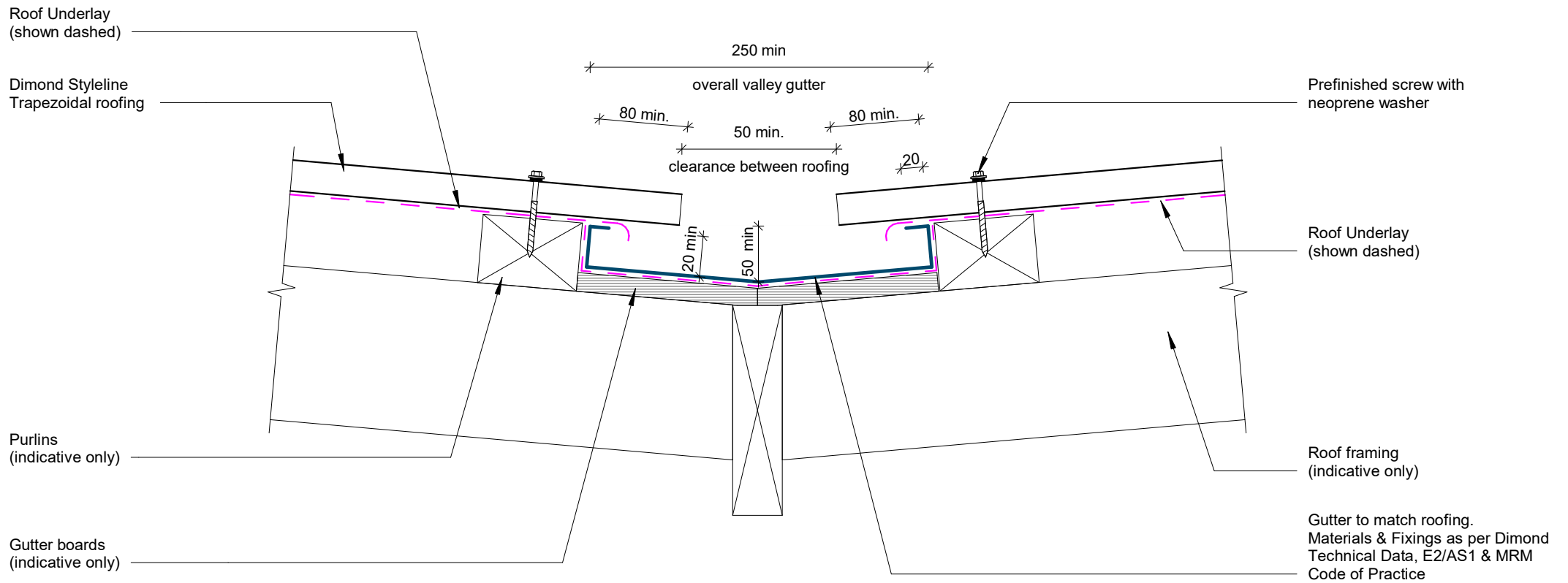

Refer to New Zealand metal roof manufacturers code of practice for design & minimum dimensions for valley gutter.

## Valley Detail

Gutter size to E2/AS1 or MRM Code of practice.  
Refer to New Zealand metal roof manufacturers code of practice for design & minimum dimensions.

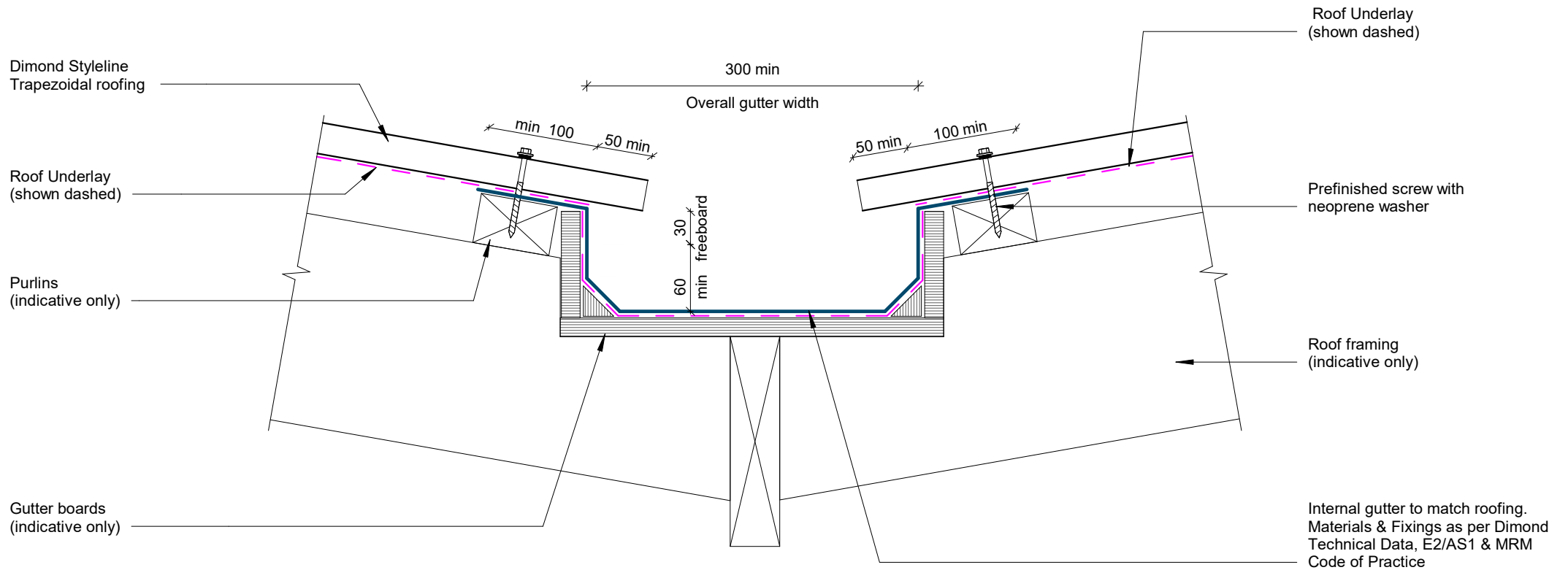

## Internal Gutter Detail

Rev: 1 Styleline Residential Roofing

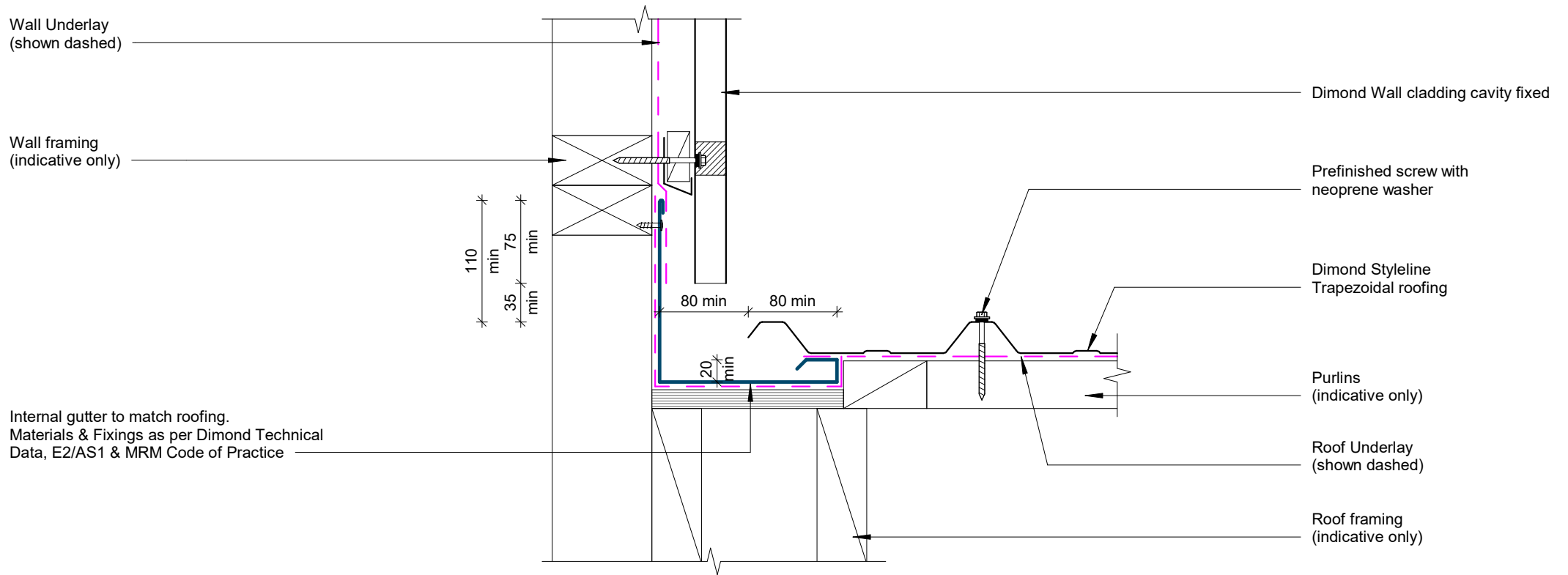

**GENERAL NOTE**

Cavity battens or timber framing that contain copper must be separated from steel cladding by a strip of wall or roof underlay or DPC.

# Parallel Hidden Gutter Detail

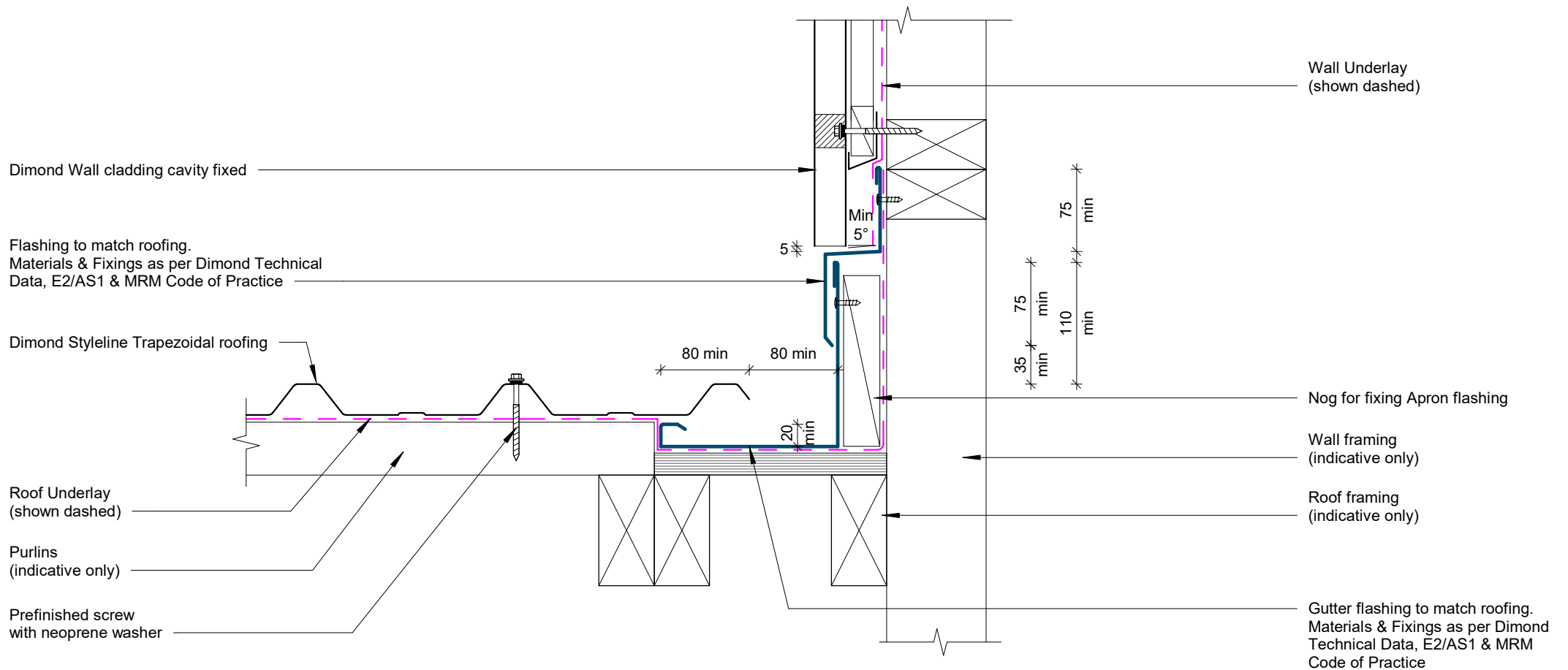

**GENERAL NOTE**

Cavity battens or timber framing that contain copper must be separated from steel cladding by a strip of wall or roof underlay or DPC.

## Parallel Hidden Gutter Two Piece Detail

COVER DIMENSIONS AS PER E2/AS1		
SITUATION 1	SITUATION 2	SITUATION 3
Low, Medium & High Wind Zones where roof pitch $\geq 10^\circ$ (Excludes any soft edge or turn-down)	All roof pitches in Very High zone. Low, Medium & High Wind Zones where roof pitch $\leq 10^\circ$ (Excludes any soft edge or turn-down)	All roof pitches in Extra High wind zone (Excludes any soft edge or turn-down)
<b>X</b> 130 MIN	200 MIN	200 MIN
<b>Y</b> Cover at least two crests (turned-up edge to full crest height constitutes a crest)		
<b>Z</b> 50mm MIN	70mm MIN	90 MIN

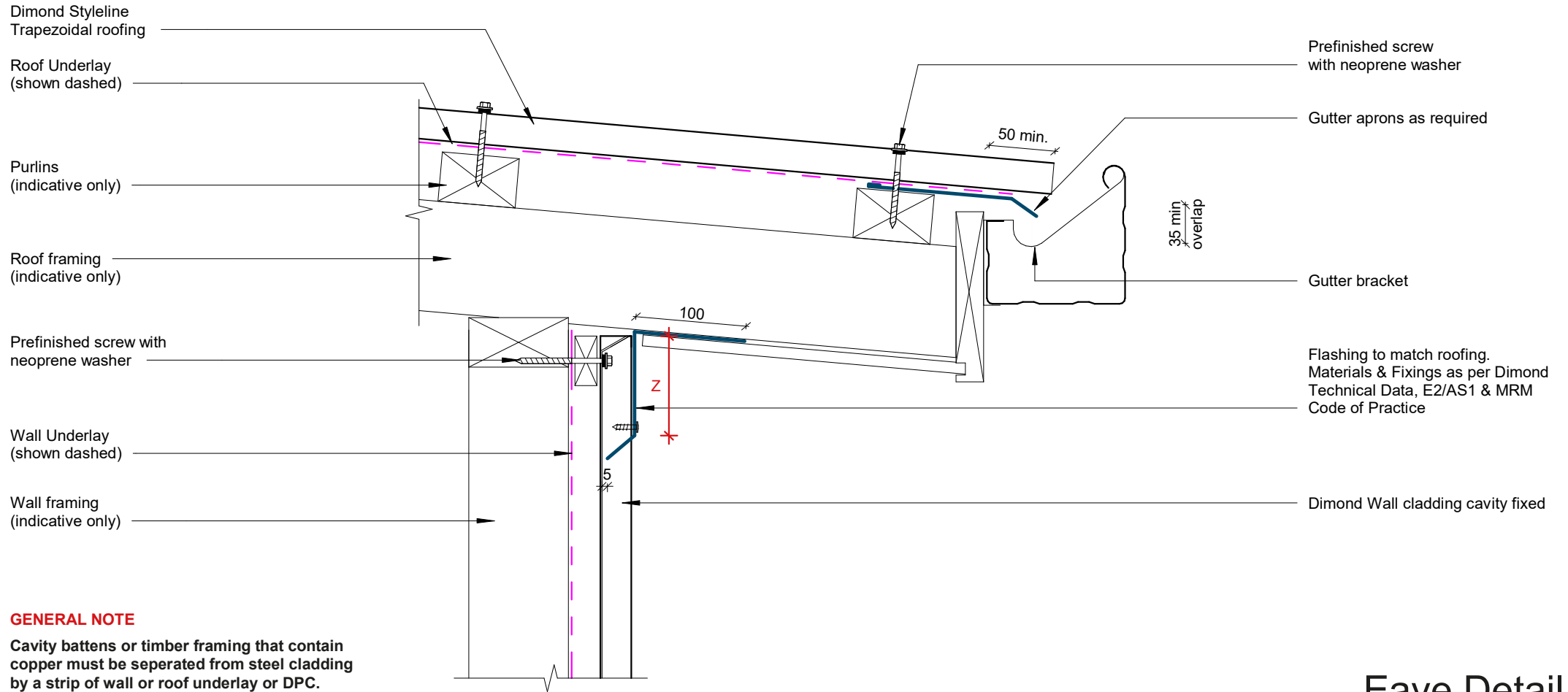

**GENERAL NOTE**

Cavity battens or timber framing that contain copper must be separated from steel cladding by a strip of wall or roof underlay or DPC.

# Eave Detail

**Note:**

Min 10° for pipe penetration direct fix boot flashing is applicable for when less than 50% blockage occurs.

When exceeding 50% blockage, refer to back tray boot flashing. Refer MRM code of practice.

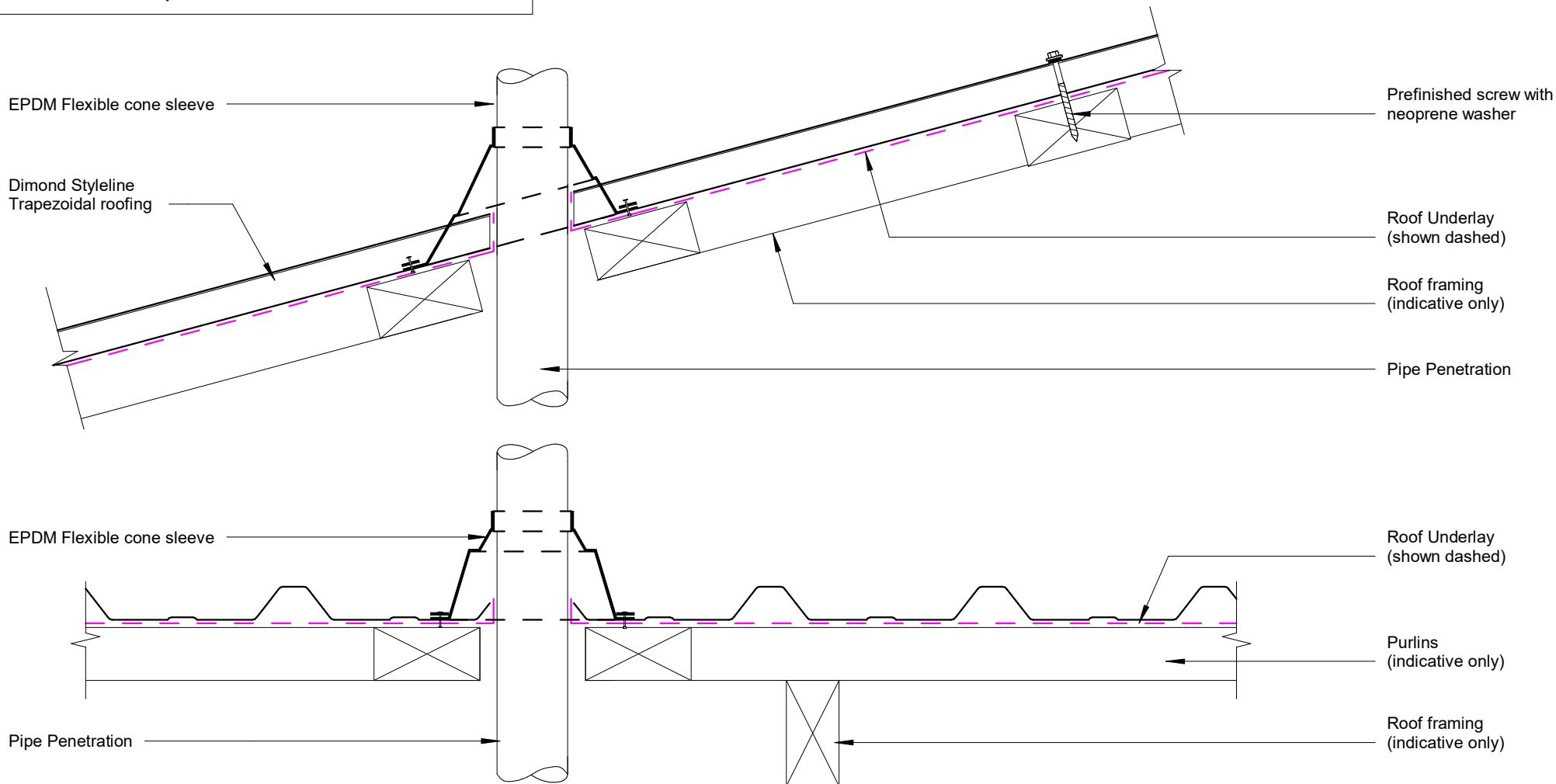

## Pipe Penetration Direct Fix Detail

**COVER DIMENSIONS AS PER E2/AS1**

	<b>SITUATION 1</b>	<b>SITUATION 2</b>	<b>SITUATION 3</b>
	Low, Medium & High Wind Zones where roof pitch $\geq 10^\circ$ (Excludes any soft edge or turn-down)	All roof pitches in Very High zone. Low, Medium & High Wind Zones where roof pitch $\leq 10^\circ$ (Excludes any soft edge or turn-down)	All roof pitches in Extra High wind zone (Excludes any soft edge or turn-down)
<b>X</b>	130 MIN	200 MIN	200 MIN
<b>Y</b>	Cover at least two crests (turned-up edge to full crest height constitutes a crest)		
<b>Z</b>	50mm MIN	70mm MIN	90 MIN

**Note:**  
Min 3° for pipe penetration with a boot flashing.  
Refer MRM code of practice

Back Tray to match roofing.  
Materials & Fixings as per Dimond Technical Data, E2/AS1 & MRM Code of Practice

Ridge flashing to match roofing.  
Materials & Fixings as per Dimond Technical Data, E2/AS1 & MRM Code of Practice

Stopends to Dimond Roofing

Notched to suit roofing profile

Prefinished screw with neoprene washer

Soft edge dressed over ribs

Barge flashing to match roofing.  
Materials & Fixings as per Dimond Technical Data, E2/AS1 & MRM Code of Practice

Roof Underlay (shown dashed)

Purlins (indicative only)

Nogs between purlins for penetration

Roof framing (indicative only)

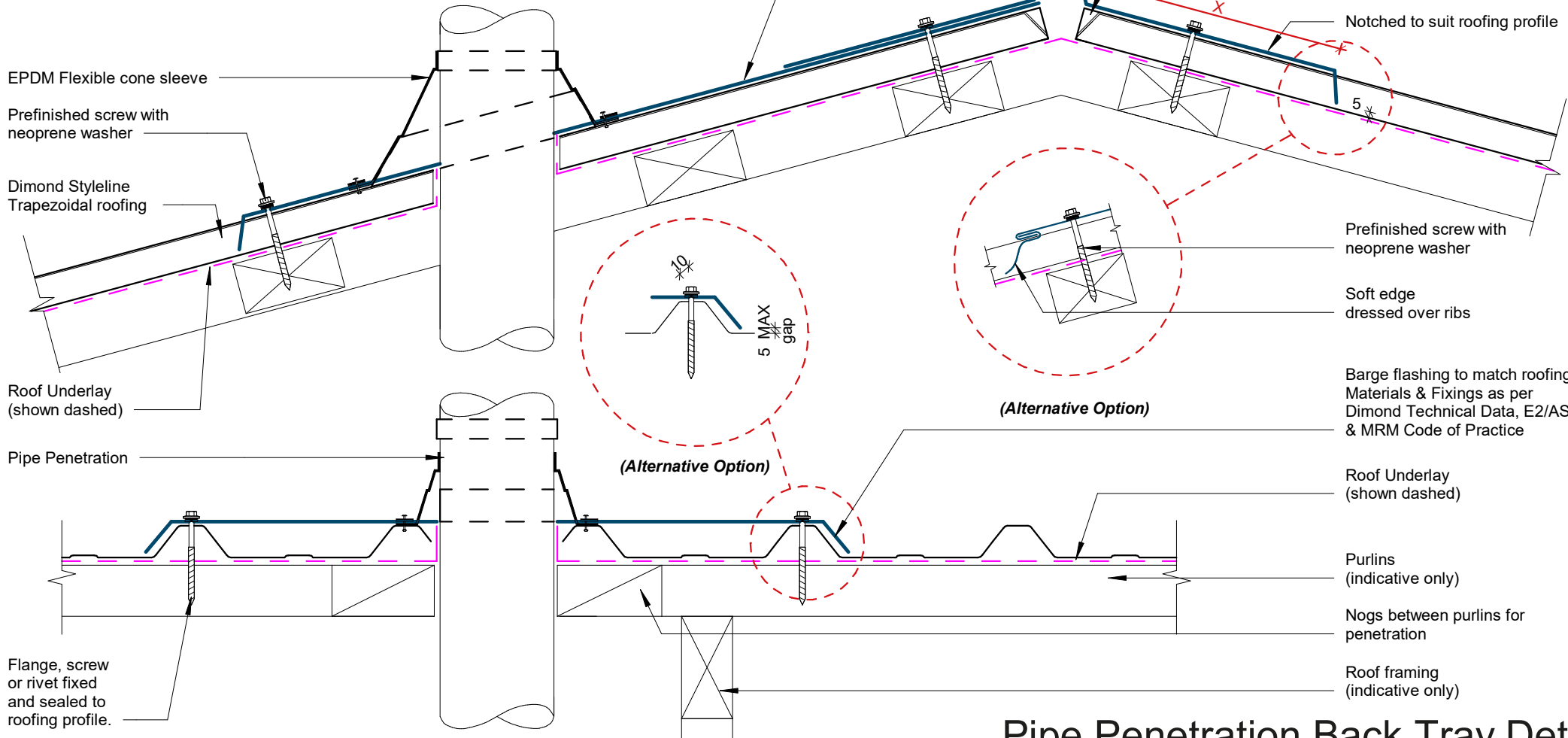

# Pipe Penetration Back Tray Detail