

# LT7

## RESIDENTIAL ROOFING

### DETAILS:

### REV: DATE:

LT7RR0	Cover Sheet	1	May 2025
LT7RR1	Ridge Flashing Detail	1	May 2025
LT7RR2	Barge Wall Detail	1	May 2025
LT7RR3	Barge Soffit Detail	1	May 2025
LT7RR4	Raking Barge Flashing Detail	1	May 2025
LT7RR5	Sawtooth Wall Detail	1	May 2025
LT7RR6	Sawtooth Soffit Detail	1	May 2025
LT7RR7	Parapet Apron Detail	1	May 2025
LT7RR8	Apron Parallel Detail	1	May 2025
LT7RR9	Apron Parallel Two Piece Detail	1	May 2025
LT7RR10	Apron Transverse Detail	1	May 2025
LT7RR11	Apron Transverse Two Piece Detail	1	May 2025
LT7RR12	Change of Pitch Detail	1	May 2025
LT7RR13	Mansard Detail	1	May 2025
LT7RR14	Valley Detail	1	May 2025
LT7RR15	Internal Gutter Detail	1	May 2025
LT7RR16	Parallel Hidden Gutter Detail	1	May 2025
LT7RR17	Parallel Hidden Gutter Two Piece Detail	1	May 2025
LT7RR18	Eave Detail	1	May 2025
LT7RR19	Pipe Penetration Direct Fix Detail	1	May 2025
LT7RR20	Pipe Penetration Back Tray Detail	1	May 2025

**COVER DIMENSIONS AS PER E2/AS1**

	<b>SITUATION 1</b>	<b>SITUATION 2</b>	<b>SITUATION 3</b>
	Low, Medium & High Wind Zones where roof pitch $\geq 10^\circ$ (Excludes any soft edge or turn-down)	All roof pitches in Very High zone. Low, Medium & High Wind Zones where roof pitch $\leq 10^\circ$ (Excludes any soft edge or turn-down)	All roof pitches in Extra High wind zone (Excludes any soft edge or turn-down)
<b>X</b>	130mm MIN	200mm MIN	200mm MIN
<b>Y</b>	Cover at least two crests (turned-up edge to full crest height constitutes a crest)		
<b>Z</b>	50mm MIN	70mm MIN	90mm MIN

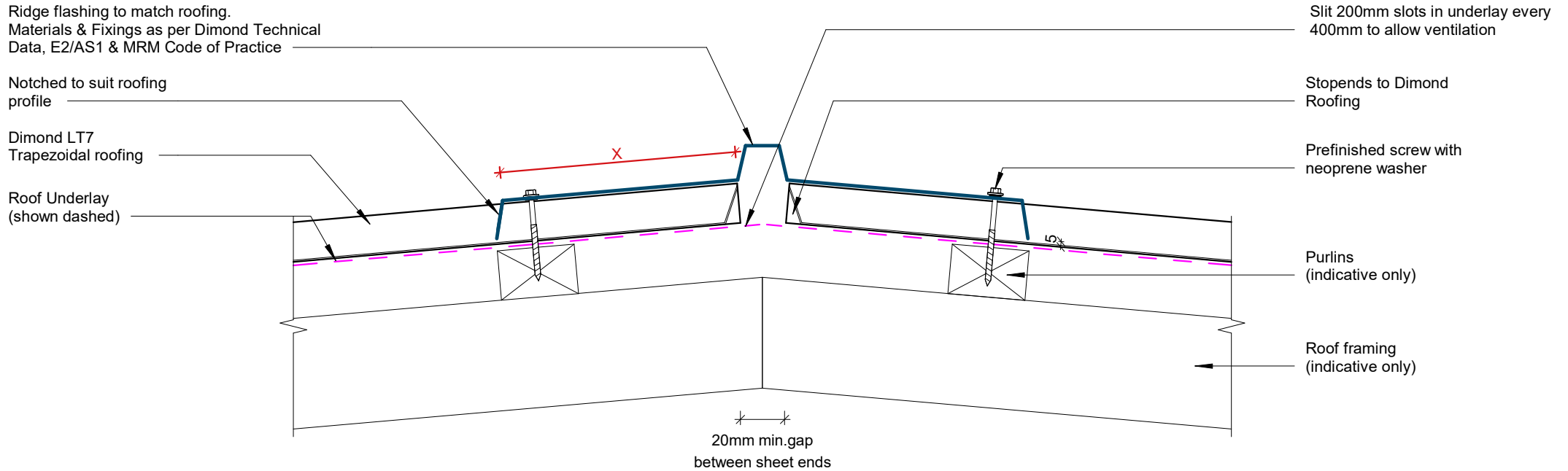

## Ridge Flashing Detail

COVER DIMENSIONS AS PER E2/AS1		
SITUATION 1	SITUATION 2	SITUATION 3
Low, Medium & High Wind Zones where roof pitch $\geq 10^\circ$ (Excludes any soft edge or turn-down)	All roof pitches in Very High zone. Low, Medium & High Wind Zones where roof pitch $\leq 10^\circ$ (Excludes any soft edge or turn-down)	All roof pitches in Extra High wind zone (Excludes any soft edge or turn-down)
<b>X</b> 130mm MIN	200mm MIN	200mm MIN
<b>Y</b> Cover at least two crests (turned-up edge to full crest height constitutes a crest)		
<b>Z</b> 50mm MIN	70mm MIN	90mm MIN

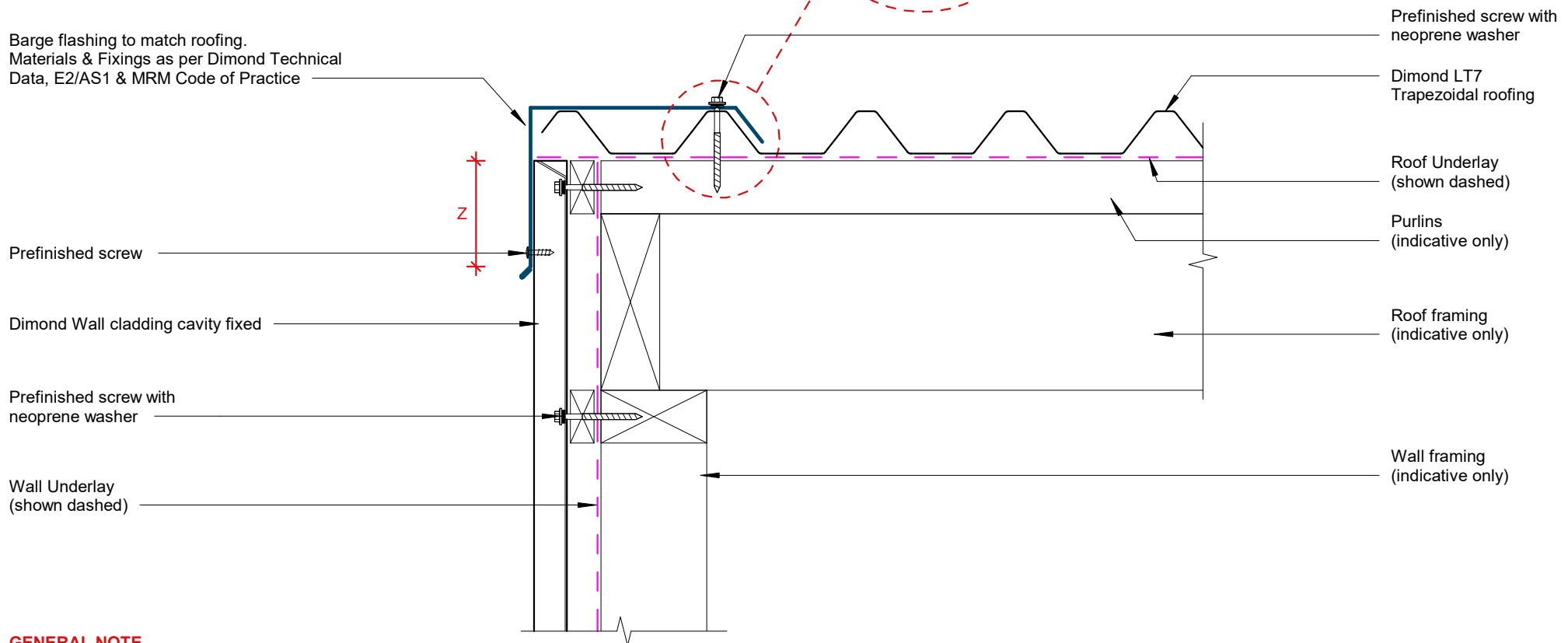
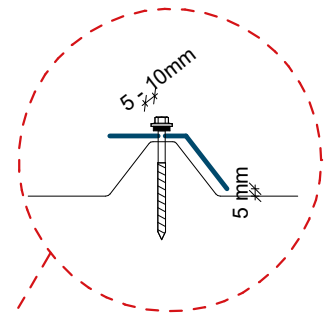

**GENERAL NOTE**  
Cavity battens or timber framing that contain copper must be separated from steel cladding by a strip of wall or roof underlay or DPC.

# Barge Wall Detail

**COVER DIMENSIONS AS PER E2/AS1**

	<b>SITUATION 1</b> Low, Medium & High Wind Zones where roof pitch $\geq 10^\circ$ (Excludes any soft edge or turn-down)	<b>SITUATION 2</b> All roof pitches in Very High zone. Low, Medium & High Wind Zones where roof pitch $\leq 10^\circ$ (Excludes any soft edge or turn-down)	<b>SITUATION 3</b> All roof pitches in Extra High wind zone (Excludes any soft edge or turn-down)
<b>X</b>	130mm MIN	200mm MIN	200mm MIN
<b>Y</b>	Cover at least two crests (turned-up edge to full crest height constitutes a crest)		
<b>Z</b>	50mm MIN	70mm MIN	90mm MIN

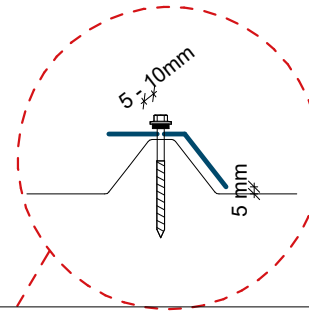

Barge flashing to match roofing.  
Materials & Fixings as per Dimond Technical Data, E2/AS1 & MRM Code of Practice

Prefinished screw

Fascia

Soffit lining

Flashing to match roofing.  
Materials & Fixings as per Dimond Technical Data, E2/AS1 & MRM Code of Practice

Dimond Wall cladding cavity fixed

Prefinished screw with neoprene washer

Dimond LT7 Trapezoidal roofing

Roof Underlay (shown dashed)

Purlins (indicative only)

Roof framing (indicative only)

Prefinished screw with neoprene washer

Prefinished screw

Wall Underlay (shown dashed)

Wall framing (indicative only)

**GENERAL NOTE**

Cavity battens or timber framing that contain copper must be separated from steel cladding by a strip of wall or roof underlay or DPC.

# Barge Soffit Detail

COVER DIMENSIONS AS PER E2/AS1		
SITUATION 1	SITUATION 2	SITUATION 3
Low, Medium & High Wind Zones where roof pitch $\geq 10^\circ$ (Excludes any soft edge or turn-down)	All roof pitches in Very High zone. Low, Medium & High Wind Zones where roof pitch $\leq 10^\circ$ (Excludes any soft edge or turn-down)	All roof pitches in Extra High wind zone (Excludes any soft edge or turn-down)
<b>X</b> 130mm MIN	200mm MIN	200mm MIN
<b>Y</b> Cover at least two crests (turned-up edge to full crest height constitutes a crest)		
<b>Z</b> 50mm MIN	70mm MIN	90mm MIN

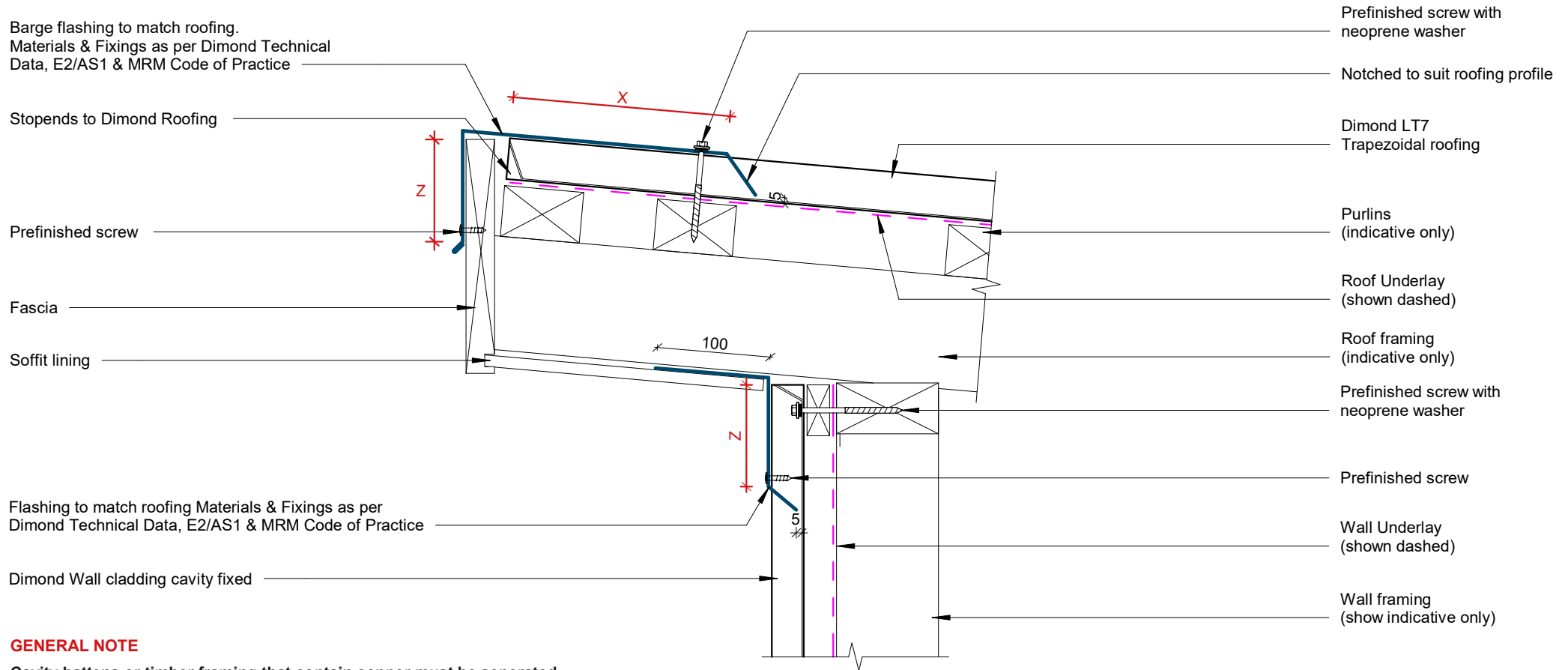

**GENERAL NOTE**

Cavity battens or timber framing that contain copper must be separated from steel cladding by a strip of wall or roof underlay or DPC.

# Raking Barge Flashing Detail

**COVER DIMENSIONS AS PER E2/AS1**

	<b>SITUATION 1</b>	<b>SITUATION 2</b>	<b>SITUATION 3</b>
	Low, Medium & High Wind Zones where roof pitch $\geq 10^\circ$ (Excludes any soft edge or turn-down)	All roof pitches in Very High zone. Low, Medium & High Wind Zones where roof pitch $\leq 10^\circ$ (Excludes any soft edge or turn-down)	All roof pitches in Extra High wind zone (Excludes any soft edge or turn-down)
<b>X</b>	130mm MIN	200mm MIN	200mm MIN
<b>Y</b>	Cover at least two crests (turned-up edge to full crest height constitutes a crest)		
<b>Z</b>	50mm MIN	70mm MIN	90mm MIN

Stopends to Dimond Roofing

Flashing to match roofing.  
Materials & Fixings as per Dimond Technical Data, E2/AS1 & MRM Code of Practice

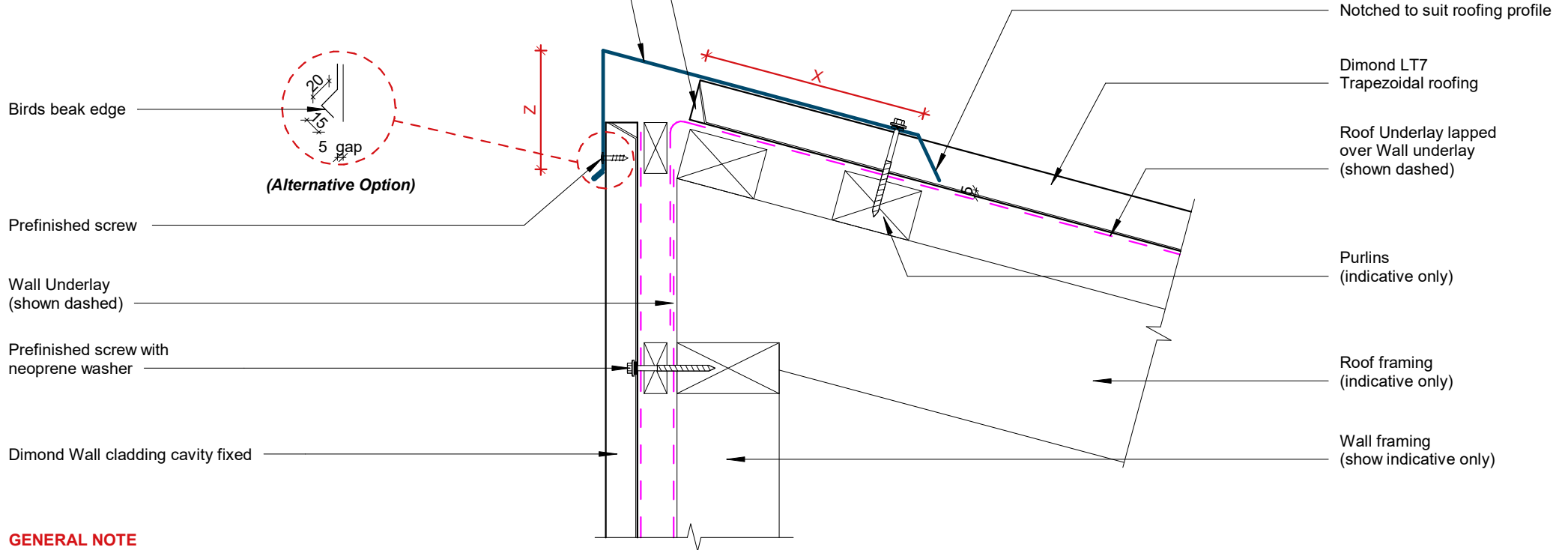

**GENERAL NOTE**

Cavity battens or timber framing that contain copper must be separated from steel cladding by a strip of wall or roof underlay or DPC.

# Sawtooth Wall Detail



**COVER DIMENSIONS AS PER E2/AS1**

	<b>SITUATION 1</b>	<b>SITUATION 2</b>	<b>SITUATION 3</b>
	Low, Medium & High Wind Zones where roof pitch $\geq 10^\circ$ (Excludes any soft edge or turn-down)	All roof pitches in Very High zone. Low, Medium & High Wind Zones where roof pitch $\leq 10^\circ$ (Excludes any soft edge or turn-down)	All roof pitches in Extra High wind zone (Excludes any soft edge or turn-down)
<b>X</b>	130mm MIN	200mm MIN	200mm MIN
<b>Y</b>	Cover at least two crests (turned-up edge to full crest height constitutes a crest)		
<b>Z</b>	50mm MIN	70mm MIN	90mm MIN

Parapet cap flashing to match roofing.  
Materials & Fixings as per Dimond Technical Data, E2/AS1 & MRM Code of Practice

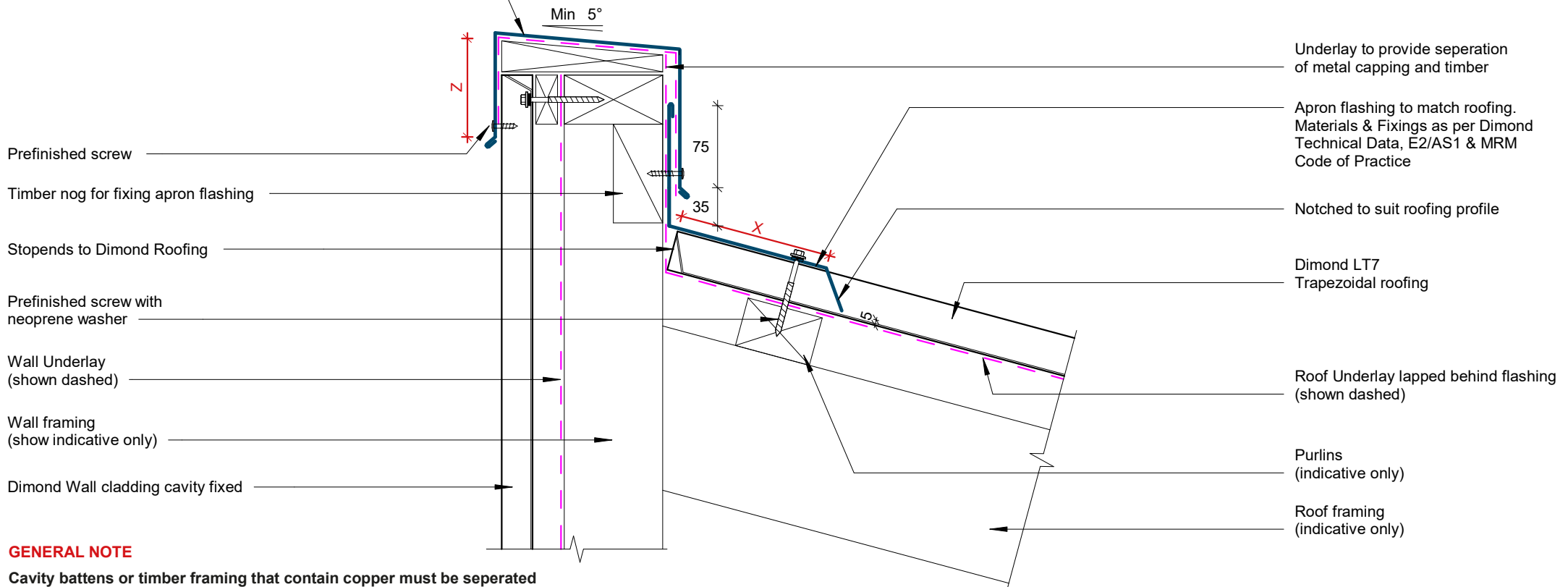

**GENERAL NOTE**

Cavity battens or timber framing that contain copper must be separated from steel cladding by a strip of wall or roof underlay or DPC.

# Parapet Apron Detail

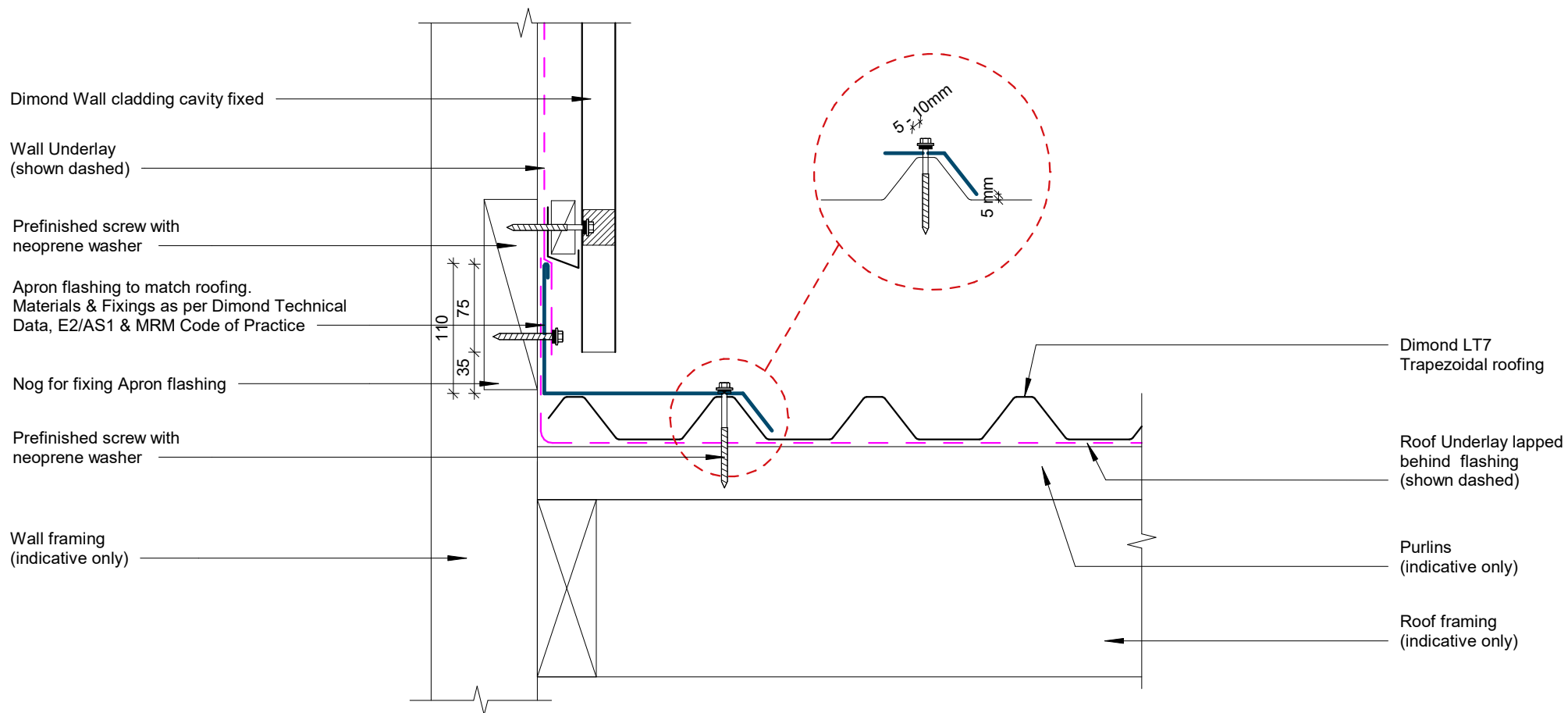

**GENERAL NOTE**

Cavity battens or timber framing that contain copper must be separated from steel cladding by a strip of wall or roof underlay or DPC.

# Apron Parallel Detail

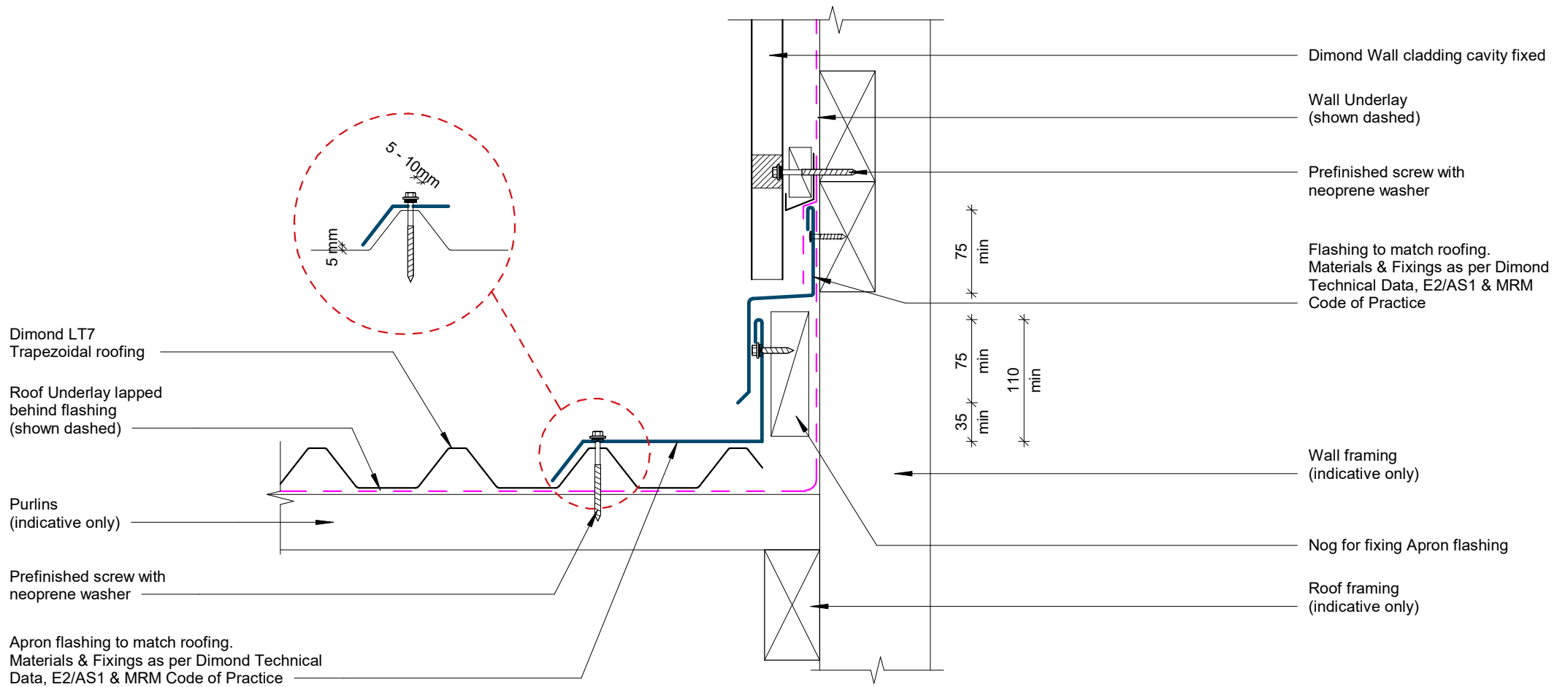

**GENERAL NOTE**

Cavity battens or timber framing that contain copper must be separated from steel cladding by a strip of wall or roof underlay or DPC.

# Apron Parallel Two Piece Detail



©Dimond 2023, all rights reserved. The information and specifications contained in this document are proprietary to Dimond and may not be used other than for the purpose of designing or building a roof or roofing system solely using products supplied or approved by Dimond ("Permitted Purpose"). You may copy this document solely for the Permitted Purpose, but may not otherwise copy, publish, distribute or modify this document without Dimond's prior written consent. Dimond will not be liable for any use of this document or information and specifications contained in this document, other than for the Permitted Purpose

Rev: 1

LT7 Residential Roofing

Date: May 2025 Scale: 1 : 5 Sheet: LT7RR9

COVER DIMENSIONS AS PER E2/AS1		
SITUATION 1	SITUATION 2	SITUATION 3
Low, Medium & High Wind Zones where roof pitch $\geq 10^\circ$ (Excludes any soft edge or turn-down)	All roof pitches in Very High zone. Low, Medium & High Wind Zones where roof pitch $\leq 10^\circ$ (Excludes any soft edge or turn-down)	All roof pitches in Extra High wind zone (Excludes any soft edge or turn-down)
<b>X</b> 130mm MIN	200mm MIN	200mm MIN
<b>Y</b> Cover at least two crests (turned-up edge to full crest height constitutes a crest)		
<b>Z</b> 50mm MIN	70mm MIN	90mm MIN

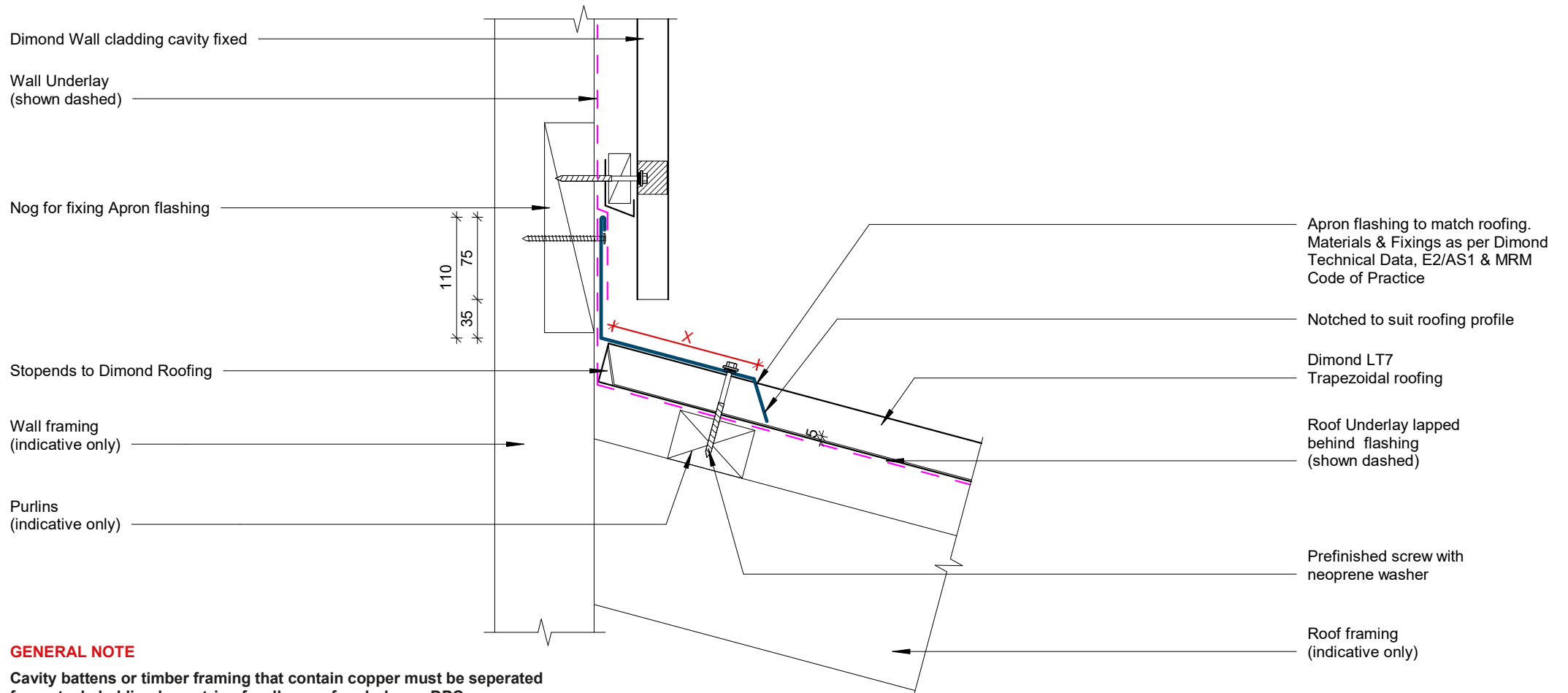

**GENERAL NOTE**

Cavity battens or timber framing that contain copper must be separated from steel cladding by a strip of wall or roof underlay or DPC.

## Apron Transverse Detail

**COVER DIMENSIONS AS PER E2/AS1**

	<b>SITUATION 1</b>	<b>SITUATION 2</b>	<b>SITUATION 3</b>
	Low, Medium & High Wind Zones where roof pitch $\geq 10^\circ$ (Excludes any soft edge or turn-down)	All roof pitches in Very High zone. Low, Medium & High Wind Zones where roof pitch $\leq 10^\circ$ (Excludes any soft edge or turn-down)	All roof pitches in Extra High wind zone (Excludes any soft edge or turn-down)
<b>X</b>	130mm MIN	200mm MIN	200mm MIN
<b>Y</b>	Cover at least two crests (turned-up edge to full crest height constitutes a crest)		
<b>Z</b>	50mm MIN	70mm MIN	90mm MIN

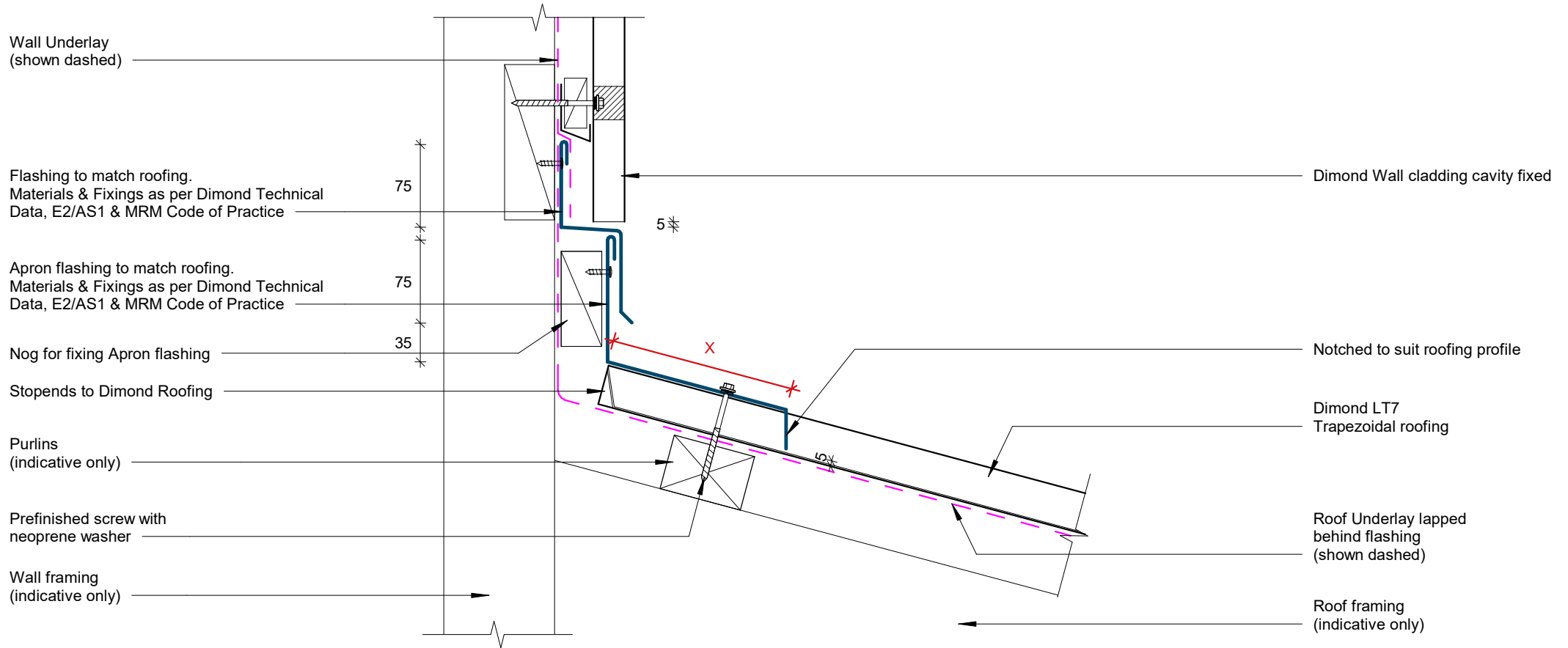

**GENERAL NOTE**

Cavity battens or timber framing that contain copper must be separated from steel cladding by a strip of wall or roof underlay or DPC.

## Apron Transverse Two Piece Detail

**COVER DIMENSIONS AS PER E2/AS1**

**SITUATION 1**

Low, Medium & High Wind Zones where roof pitch  $\geq 10^\circ$   
(Excludes any soft edge or turn-down)

**SITUATION 2**

All roof pitches in Very High zone.  
Low, Medium & High Wind Zones where roof pitch  $\leq 10^\circ$   
(Excludes any soft edge or turn-down)

<b>X</b>	130mm MIN	200mm MIN
<b>Y</b>	Cover at least two crests (turned-up edge to full crest height constitutes a crest)	
<b>Z</b>	50mm MIN	70mm MIN

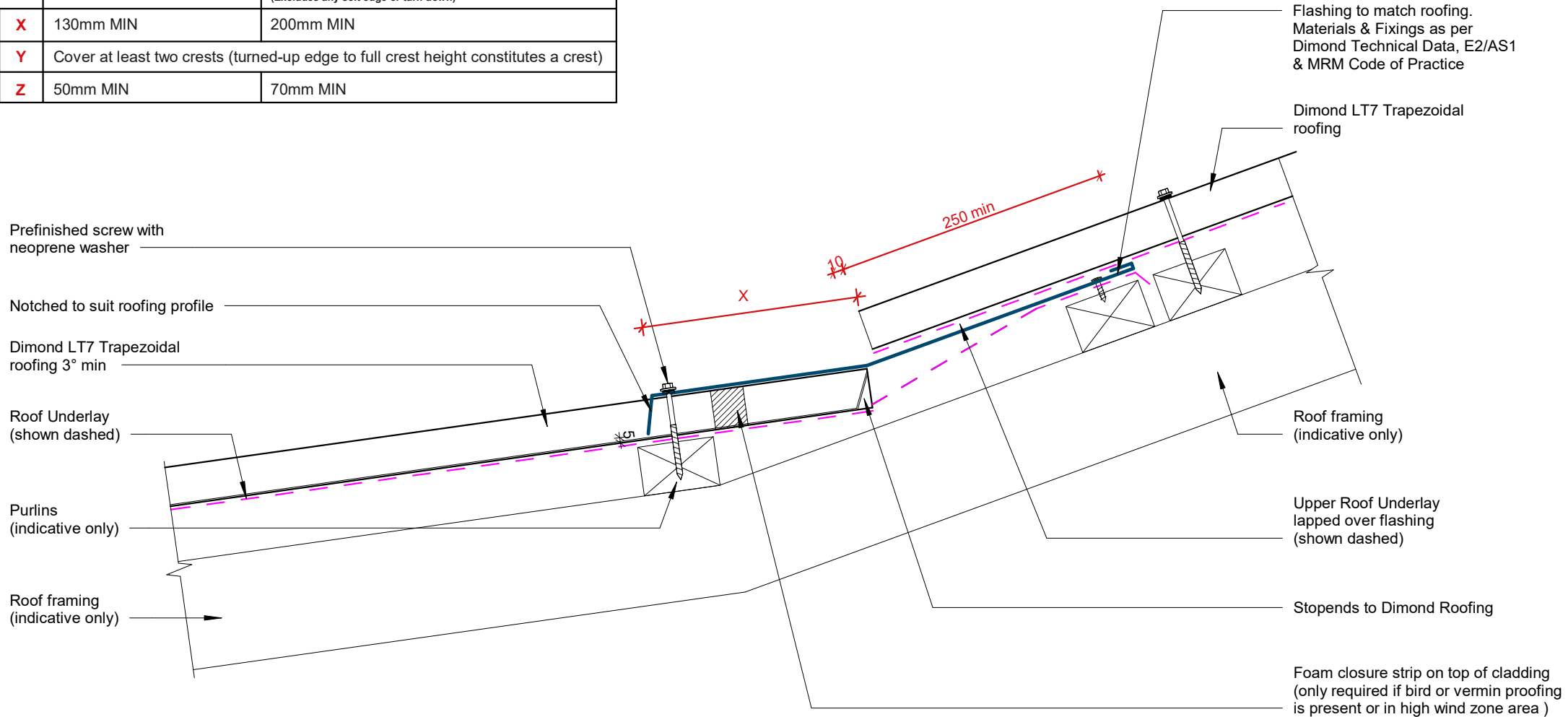

# Change of Pitch Detail



©Dimond 2023, all rights reserved. The information and specifications contained in this document are proprietary to Dimond and may not be used other than for the purpose of designing or building a roof or roofing system solely using products supplied or approved by Dimond ("Permitted Purpose"). You may copy this document solely for the Permitted Purpose, but may not otherwise copy, publish, distribute or modify this document without Dimond's prior written consent. Dimond will not be liable for any use of this document or information and specifications contained in this document, other than for the Permitted Purpose

Rev: 1

**LT7 Residential Roofing**

Date: May 2025 Scale: 1 : 5 Sheet: **LT7RR12**

**COVER DIMENSIONS AS PER E2/AS1**

	<b>SITUATION 1</b>	<b>SITUATION 2</b>	<b>SITUATION 3</b>
	Low, Medium & High Wind Zones where roof pitch $\geq 10^\circ$ (Excludes any soft edge or turn-down)	All roof pitches in Very High zone. Low, Medium & High Wind Zones where roof pitch $\leq 10^\circ$ (Excludes any soft edge or turn-down)	All roof pitches in Extra High wind zone (Excludes any soft edge or turn-down)
<b>X</b>	130mm MIN	200mm MIN	200mm MIN
<b>Y</b>	Cover at least two crests (turned-up edge to full crest height constitutes a crest)		
<b>Z</b>	50mm MIN	70mm MIN	90mm MIN

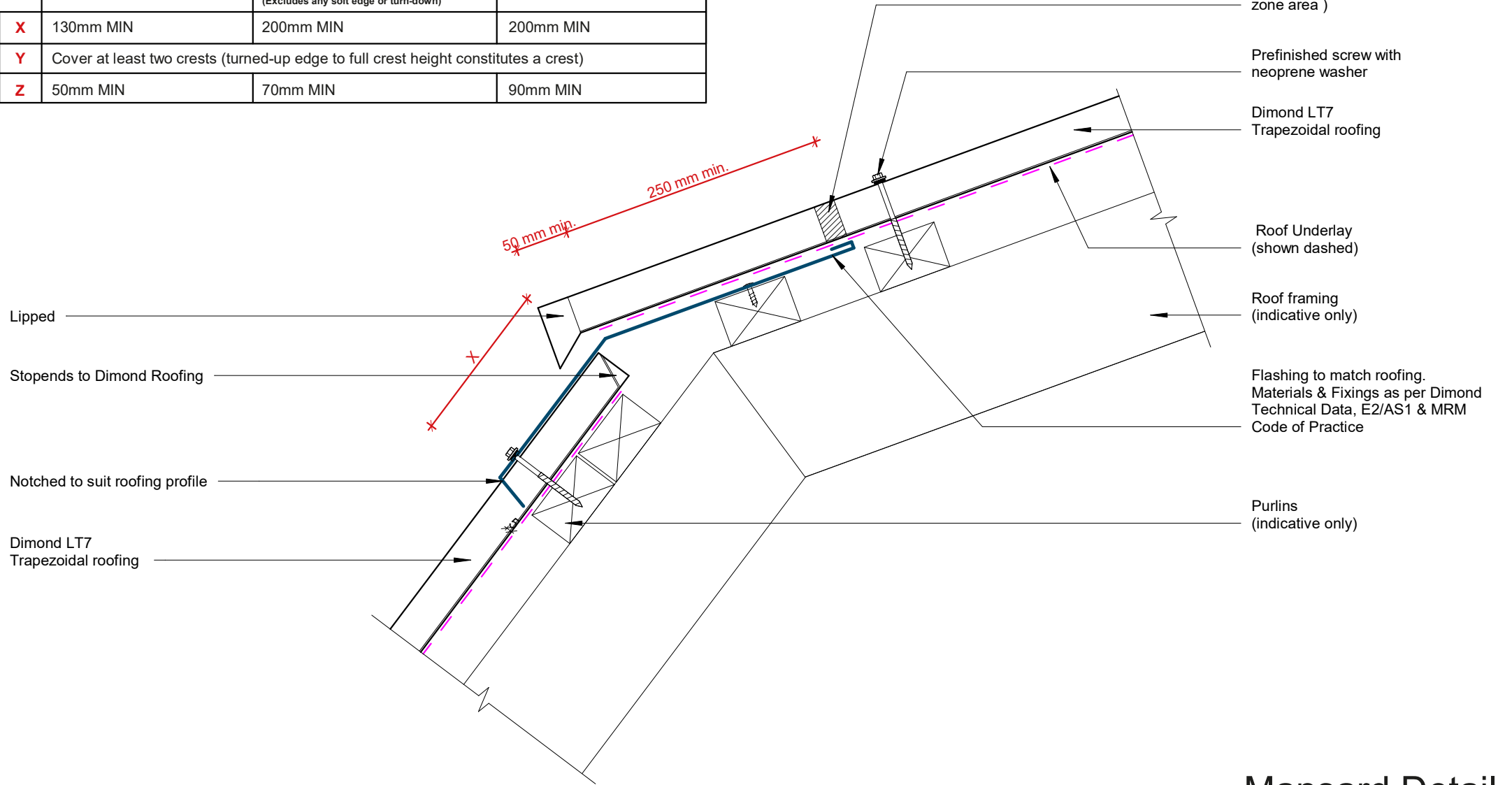

# Mansard Detail

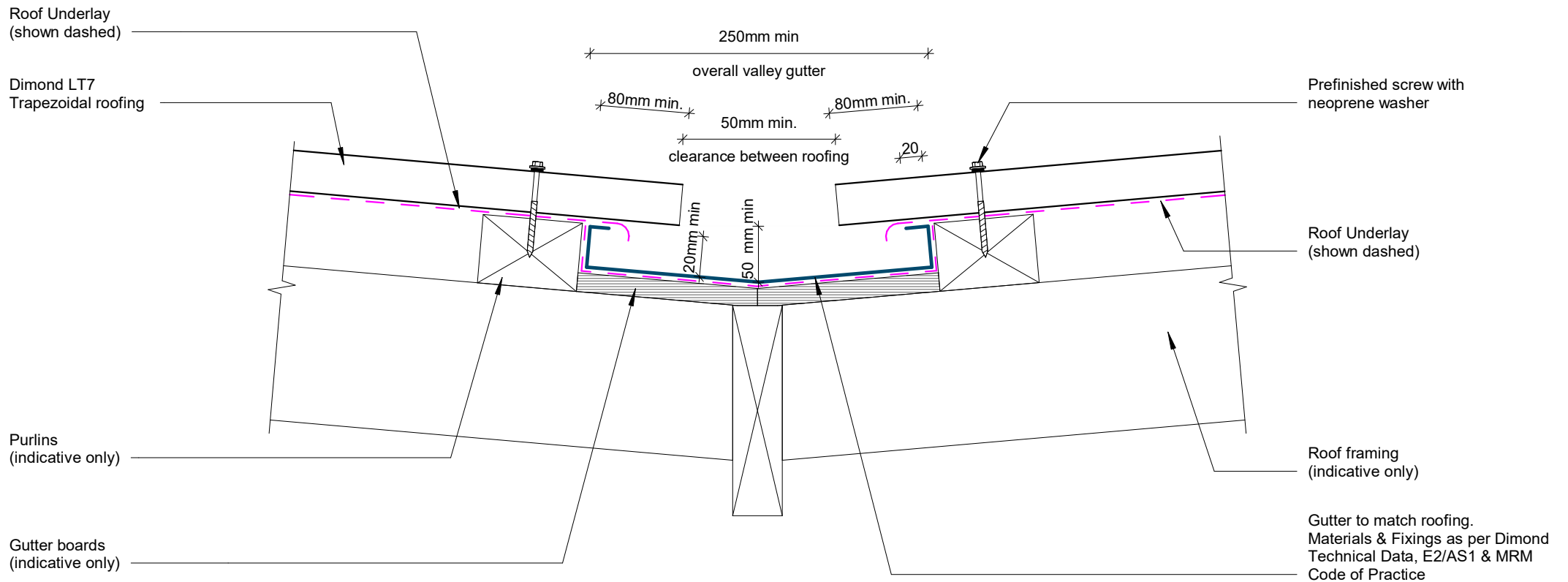

Refer to New Zealand metal roof manufacturers code of practice for design & minimum dimensions for valley gutter.

## Valley Detail

Gutter size to E2/AS1 or MRM Code of practice.  
Refer to New Zealand metal roof manufacturers code of practice for design & minimum dimensions.

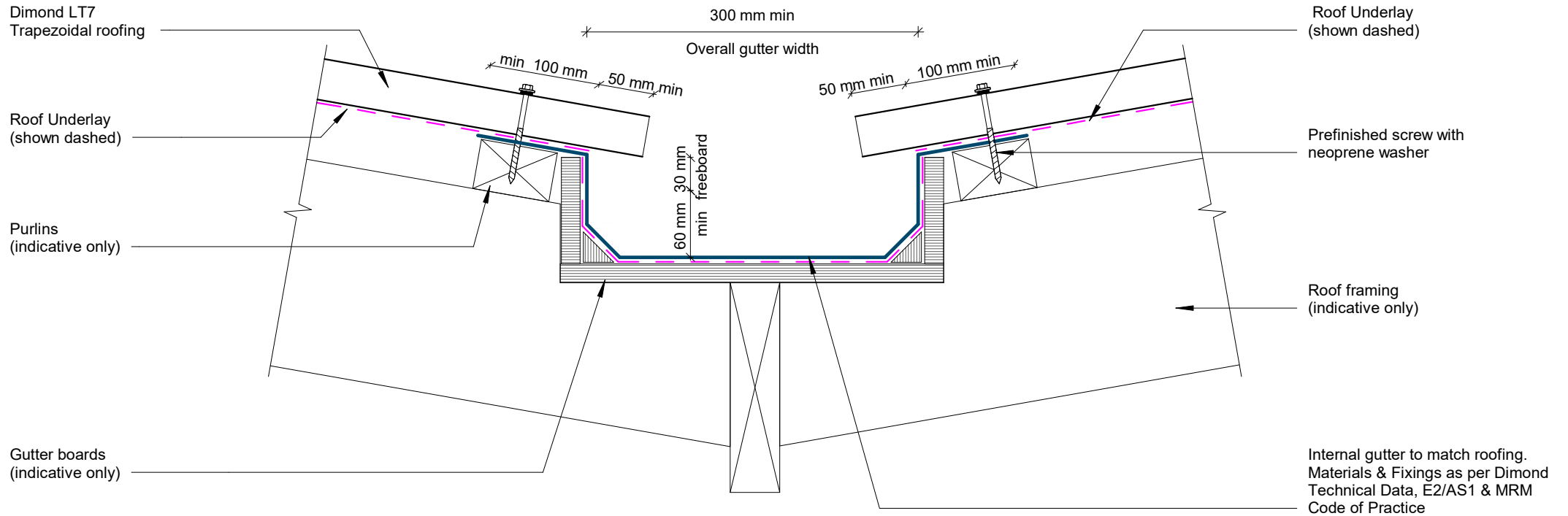

## Internal Gutter Detail

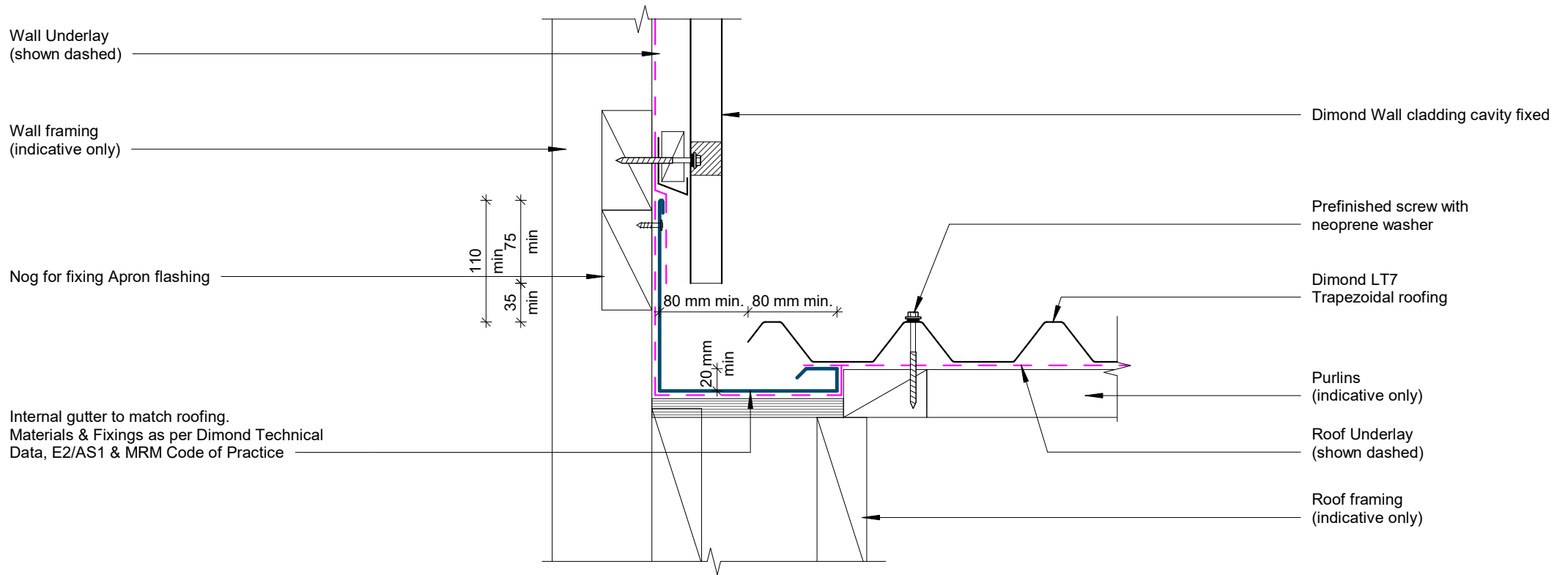

**GENERAL NOTE**

Cavity battens or timber framing that contain copper must be separated from steel cladding by a strip of wall or roof underlay or DPC.

# Parallel Hidden Gutter Detail

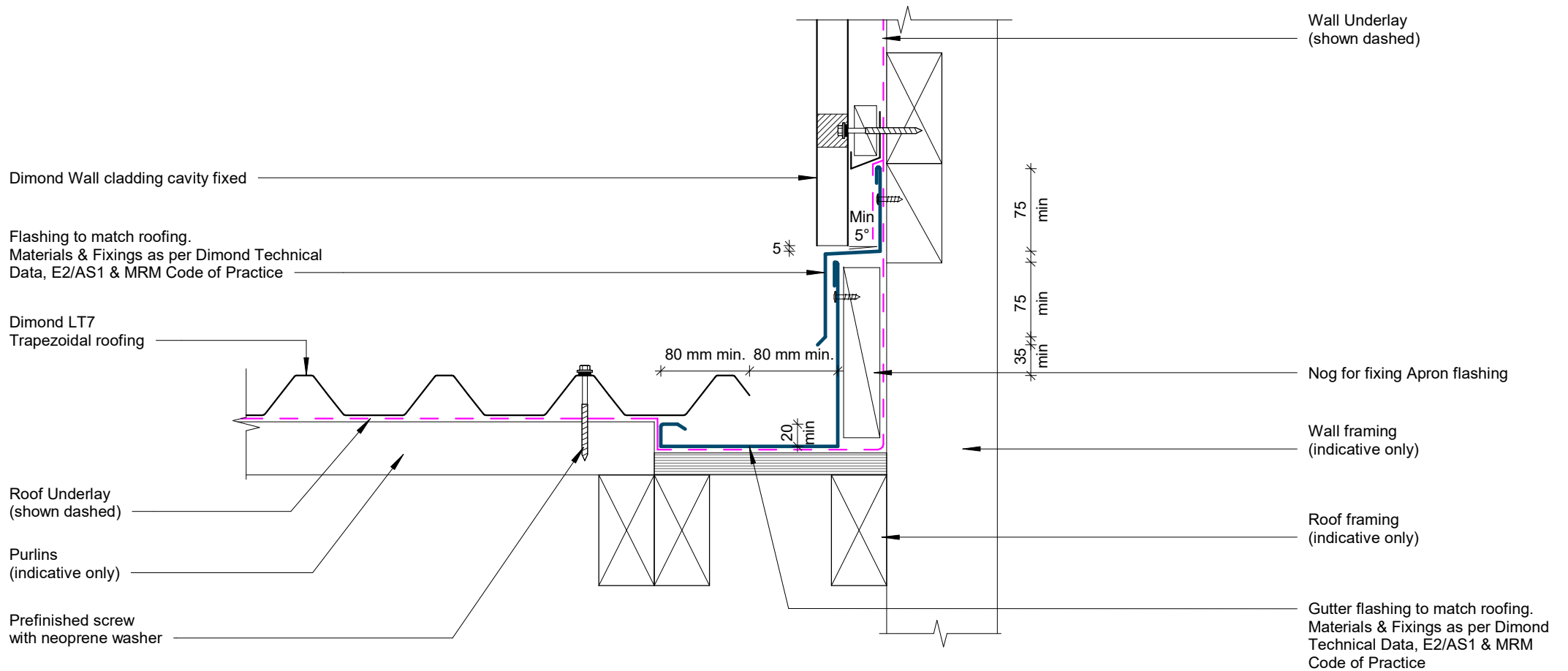

**GENERAL NOTE**

Cavity battens or timber framing that contain copper must be separated from steel cladding by a strip of wall or roof underlay or DPC.

# Parallel Hidden Gutter Two Piece Detail

**COVER DIMENSIONS AS PER E2/AS1**

	<b>SITUATION 1</b>	<b>SITUATION 2</b>	<b>SITUATION 3</b>
	Low, Medium & High Wind Zones where roof pitch $\geq 10^\circ$ (Excludes any soft edge or turn-down)	All roof pitches in Very High zone. Low, Medium & High Wind Zones where roof pitch $\leq 10^\circ$ (Excludes any soft edge or turn-down)	All roof pitches in Extra High wind zone (Excludes any soft edge or turn-down)
<b>X</b>	130mm MIN	200mm MIN	200mm MIN
<b>Y</b>	Cover at least two crests (turned-up edge to full crest height constitutes a crest)		
<b>Z</b>	50mm MIN	70mm MIN	90mm MIN

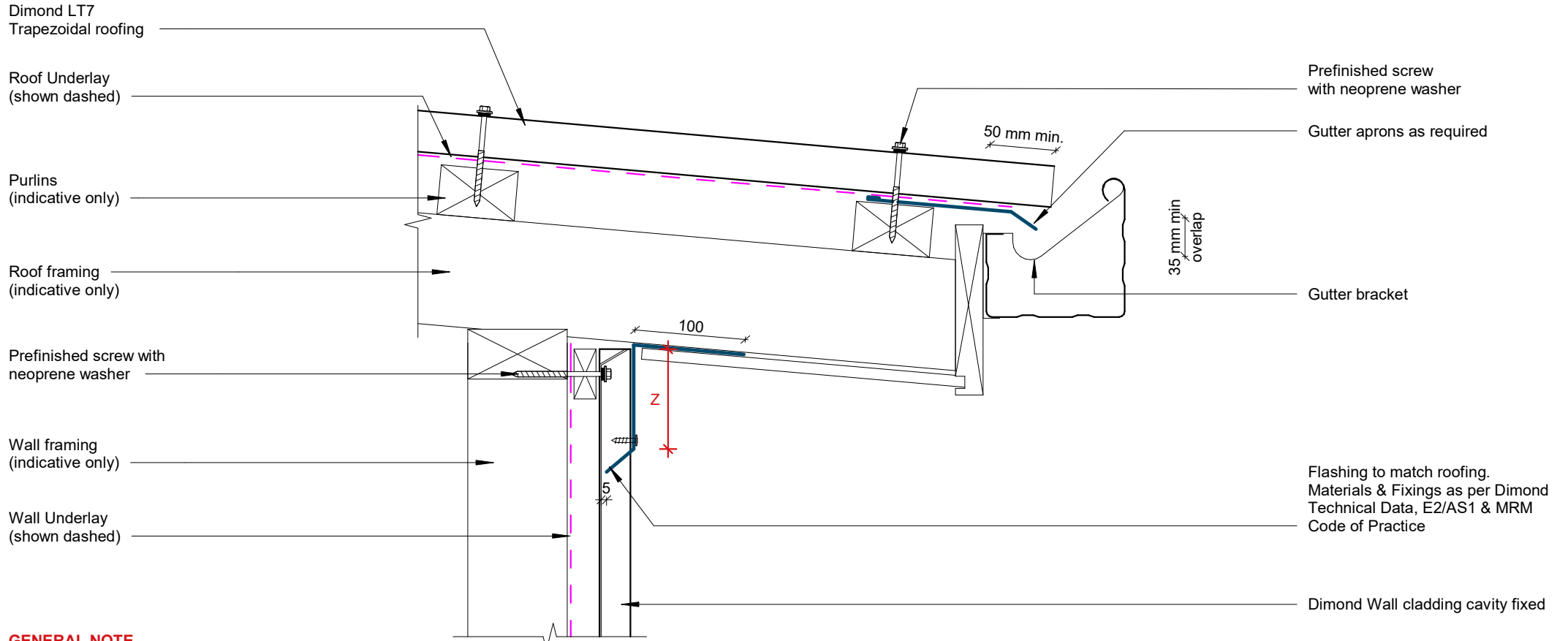

**GENERAL NOTE**

Cavity battens or timber framing that contain copper must be separated from steel cladding by a strip of wall or roof underlay or DPC.

# Eave Detail

**Note:**

Min 10° for pipe penetration direct fix boot flashing is applicable for when less than 50% blockage occurs.

When exceeding 50% blockage, refer to back tray boot flashing. Refer MRM code of practice.

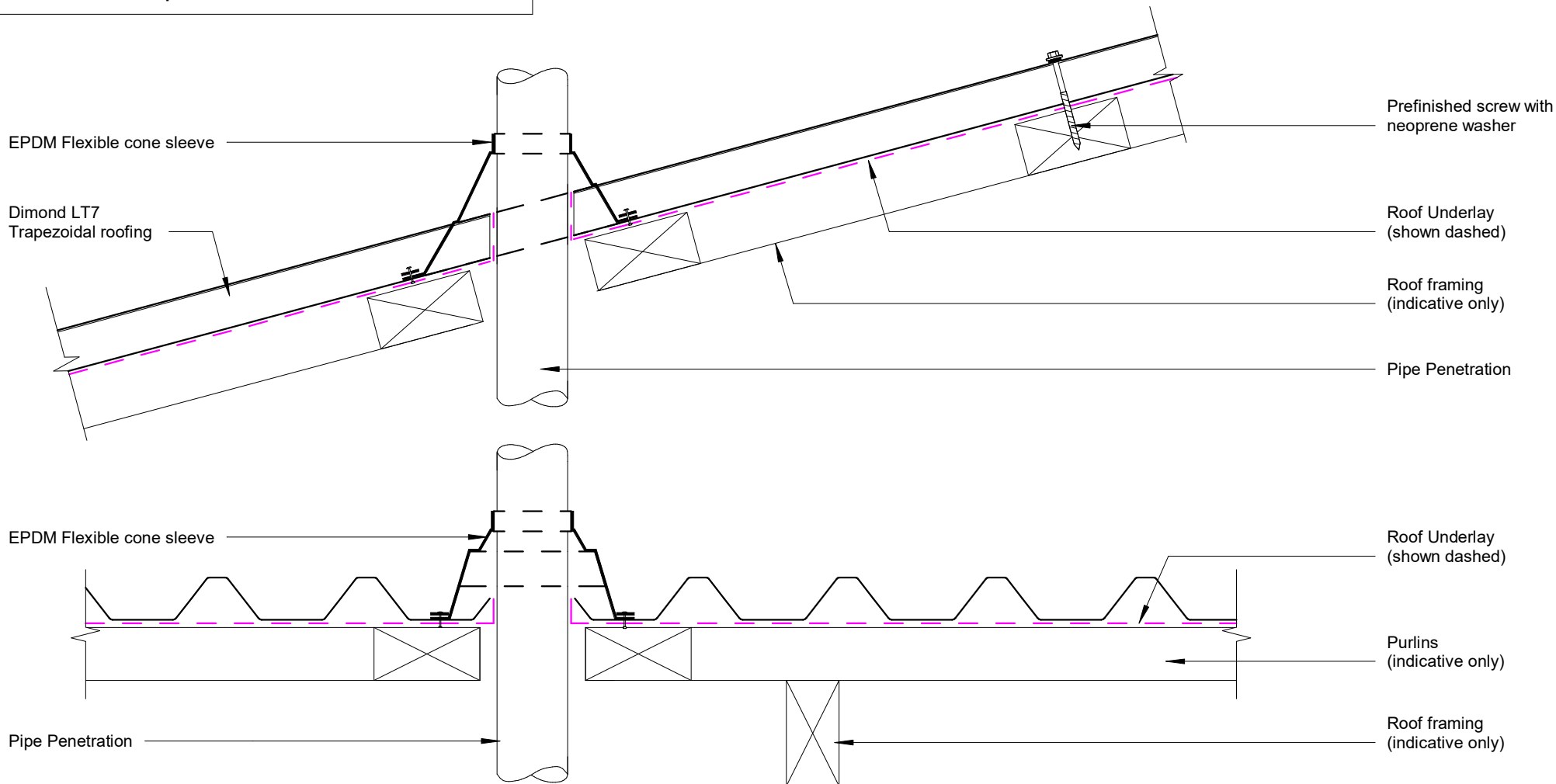

## Pipe Penetration Direct Fix Detail

**COVER DIMENSIONS AS PER E2/AS1**

	<b>SITUATION 1</b>	<b>SITUATION 2</b>	<b>SITUATION 3</b>
	Low, Medium & High Wind Zones where roof pitch $\geq 10^\circ$ (Excludes any soft edge or turn-down)	All roof pitches in Very High zone. Low, Medium & High Wind Zones where roof pitch $\leq 10^\circ$ (Excludes any soft edge or turn-down)	All roof pitches in Extra High wind zone (Excludes any soft edge or turn-down)
<b>X</b>	130mm MIN	200mm MIN	200mm MIN
<b>Y</b>	Cover at least two crests (turned-up edge to full crest height constitutes a crest)		
<b>Z</b>	50mm MIN	70mm MIN	90mm MIN

**Note:**  
Min 3° for pipe penetration with a boot flashing.  
Refer MRM code of practice

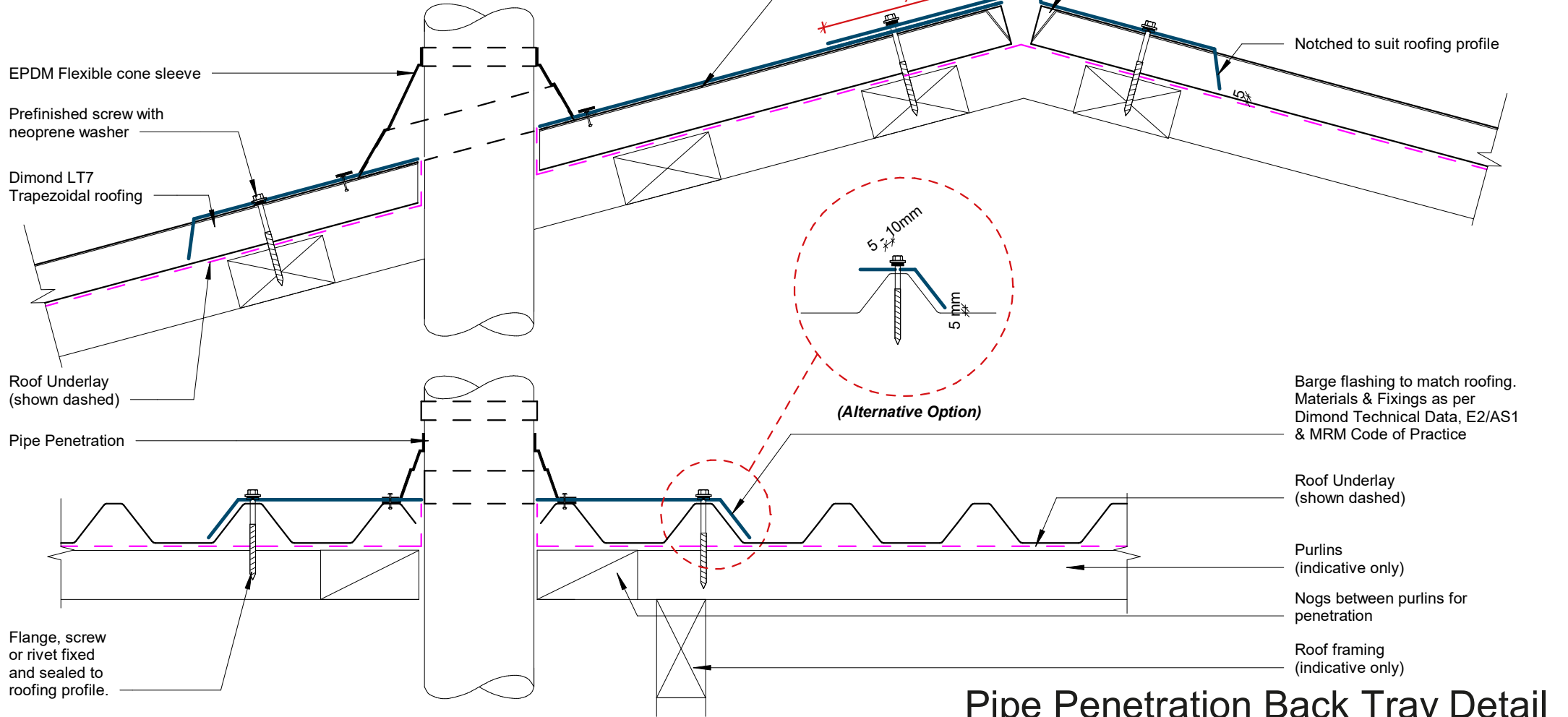

## Pipe Penetration Back Tray Detail