

CORRUGATE

RESIDENTIAL ROOFING

DETAILS:

REV:

DATE:

CRR00	Cover Sheet	1	May 2025
CRR01	Ridge Flashing Detail	1	May 2025
CRR02	Barge Wall Detail	1	May 2025
CRR03	Barge Soffit Detail	1	May 2025
CRR04	Raking Barge Flashing Detail	1	May 2025
CRR05	Sawtooth Wall Detail	1	May 2025
CRR06	Sawtooth Soffit Detail	1	May 2025
CRR07	Parapet Apron Detail	1	May 2025
CRR08	Apron Parallel Detail	1	May 2025
CRR09	Apron Parallel Two Piece Detail	1	May 2025
CRR10	Apron Transverse Detail	1	May 2025
CRR11	Apron Transverse Two Piece Detail	1	May 2025
CRR12	Change of Pitch Detail	1	May 2025
CRR13	Mansard Detail	1	May 2025
CRR14	Valley Detail	1	May 2025
CRR15	Internal Gutter Detail	1	May 2025
CRR16	Parallel Hidden Gutter Detail	1	May 2025
CRR17	Parallel Hidden Gutter Two Piece Detail	1	May 2025
CRR18	Eave Detail	1	May 2025
CRR19	Pipe Penetration Direct Fix Detail	1	May 2025
CRR20	Pipe Penetration Back Tray Detail	1	May 2025

COVER DIMENSIONS AS PER E2/AS1

	SITUATION 1	SITUATION 2	SITUATION 3
	Low, Medium & High Wind Zones where roof pitch $\geq 10^\circ$ (Excludes any soft edge or turn-down)	All roof pitches in Very High zone. Low, Medium & High Wind Zones where roof pitch $\leq 10^\circ$ (Excludes any soft edge or turn-down)	All roof pitches in Extra High wind zone (Excludes any soft edge or turn-down)
X	130 MIN	200 MIN	200 MIN
Y	Cover at least two crests (turned-up edge to full crest height constitutes a crest)		
Z	50 MIN	70 MIN	90 MIN

Ridge flashing to match roofing.
Materials & Fixings as per Dimond Technical Data, E2/AS1 & MRM Code of Practice

Soft edge dressed over roofing profile

Dimond Corrugate roofing profile

Roof Underlay (shown dashed)

Slit 200 slots in underlay every 400 to allow ventilation

Stopends to Dimond Roofing

Prefinished screw with neoprene washer

Purlins (indicative only)

Roof framing (indicative only)

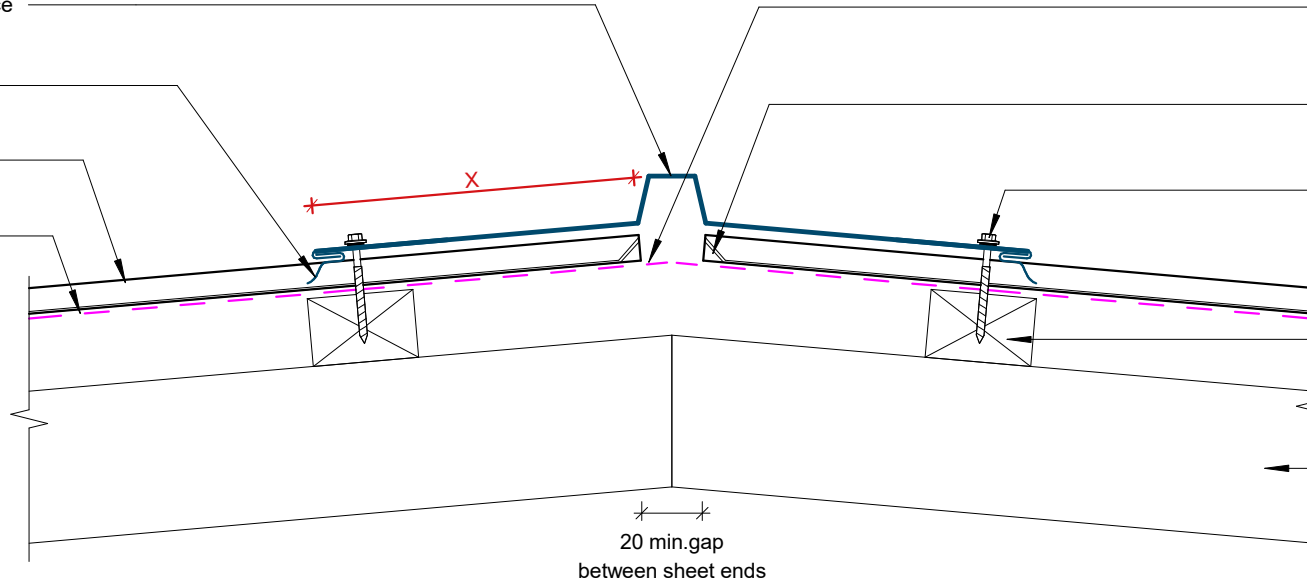

20 min. gap
between sheet ends

Ridge Flashing Detail

COVER DIMENSIONS AS PER E2/AS1		
SITUATION 1	SITUATION 2	SITUATION 3
Low, Medium & High Wind Zones where roof pitch $\geq 10^\circ$ (Excludes any soft edge or turn-down)	All roof pitches in Very High zone. Low, Medium & High Wind Zones where roof pitch $\leq 10^\circ$ (Excludes any soft edge or turn-down)	All roof pitches in Extra High wind zone (Excludes any soft edge or turn-down)
X 130 MIN	200 MIN	200 MIN
Y Cover at least two crests (turned-up edge to full crest height constitutes a crest)		
Z 50 MIN	70 MIN	90 MIN

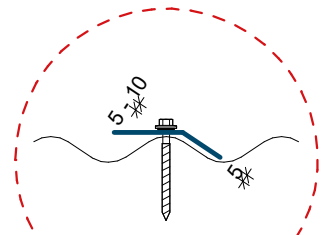

Barge flashing to match roofing.
Materials & Fixings as per Dimond Technical Data, E2/AS1 & MRM Code of Practice

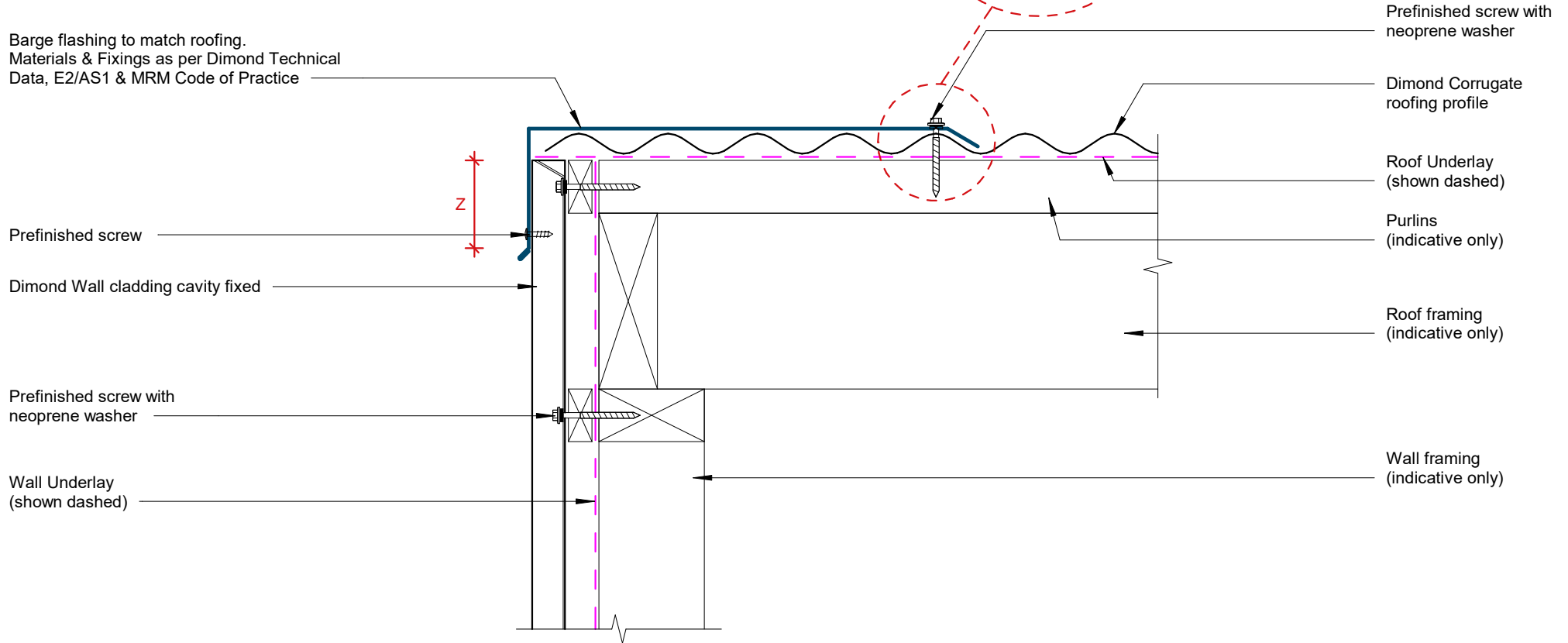

GENERAL NOTE

Cavity battens or timber framing that contain copper must be separated from steel cladding by a strip of wall or roof underlay or DPC.

Barge Wall Detail



©Dimond 2023, all rights reserved. The information and specifications contained in this document are proprietary to Dimond and may not be used other than for the purpose of designing or building a roof or roofing system solely using products supplied or approved by Dimond ("Permitted Purpose"). You may copy this document solely for the Permitted Purpose, but may not otherwise copy, publish, distribute or modify this document without Dimond's prior written consent. Dimond will not be liable for any use of this document or information and specifications contained in this document, other than for the Permitted Purpose

Rev: 1 **Corrugate Residential Roofing**

Date: May 2025 Scale: 1 : 5 Sheet: **CRR02**

COVER DIMENSIONS AS PER E2/AS1

	SITUATION 1 Low, Medium & High Wind Zones where roof pitch $\geq 10^\circ$ (Excludes any soft edge or turn-down)	SITUATION 2 All roof pitches in Very High zone. Low, Medium & High Wind Zones where roof pitch $\leq 10^\circ$ (Excludes any soft edge or turn-down)	SITUATION 3 All roof pitches in Extra High wind zone (Excludes any soft edge or turn-down)
X	130 MIN	200 MIN	200 MIN
Y	Cover at least two crests (turned-up edge to full crest height constitutes a crest)		
Z	50 MIN	70 MIN	90 MIN

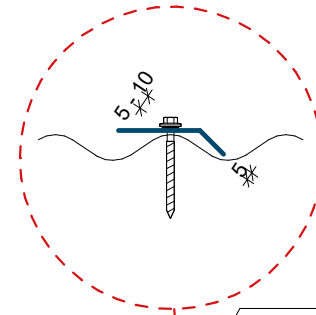

Barge flashing to match roofing.
Materials & Fixings as per Dimond Technical Data, E2/AS1 & MRM Code of Practice

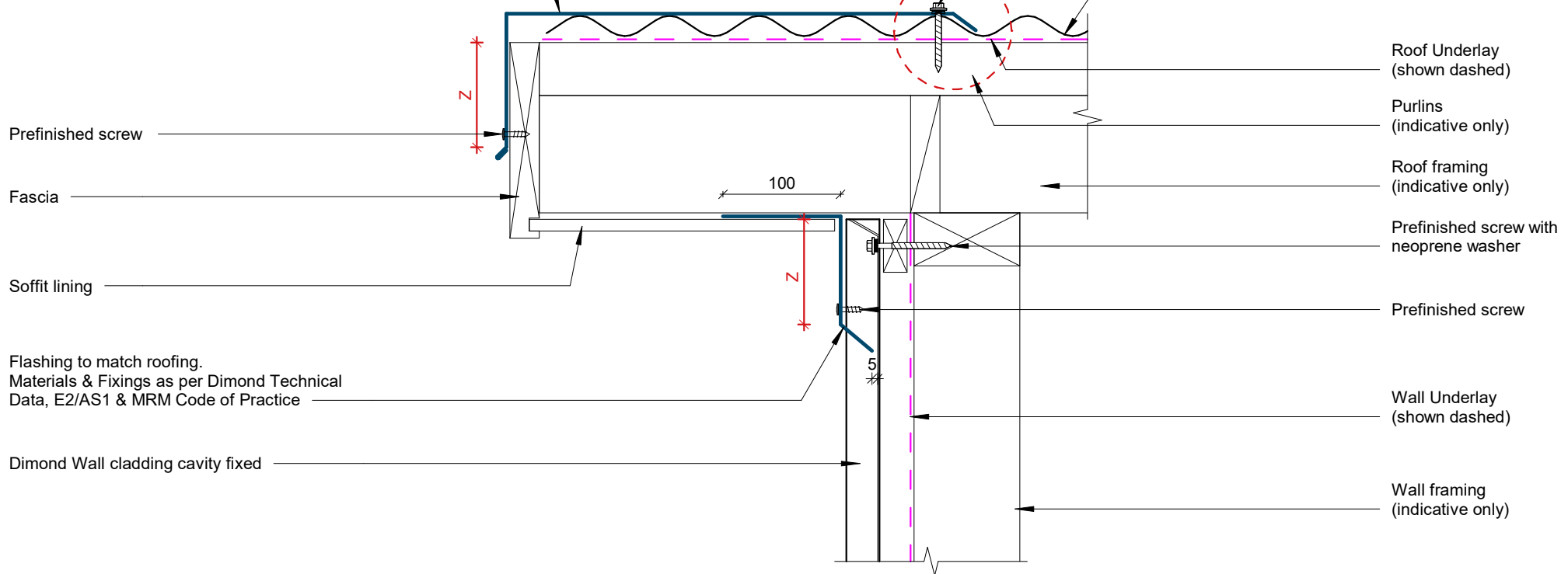

Prefinished screw

Fascia

Soffit lining

Flashing to match roofing.
Materials & Fixings as per Dimond Technical Data, E2/AS1 & MRM Code of Practice

Dimond Wall cladding cavity fixed

Prefinished screw with neoprene washer

Dimond Corrugate roofing profile

Roof Underlay (shown dashed)

Purlins (indicative only)

Roof framing (indicative only)

Prefinished screw with neoprene washer

Prefinished screw

Wall Underlay (shown dashed)

Wall framing (indicative only)

GENERAL NOTE

Cavity battens or timber framing that contain copper must be separated from steel cladding by a strip of wall or roof underlay or DPC.

Barge Soffit Detail



©Dimond 2023, all rights reserved. The information and specifications contained in this document are proprietary to Dimond and may not be used other than for the purpose of designing or building a roof or roofing system solely using products supplied or approved by Dimond ("Permitted Purpose"). You may copy this document solely for the Permitted Purpose, but may not otherwise copy, publish, distribute or modify this document without Dimond's prior written consent. Dimond will not be liable for any use of this document or information and specifications contained in this document, other than for the Permitted Purpose

Rev: 1 **Corrugate Residential Roofing**

Date: May 2025 Scale: 1 : 5 Sheet: **CRR03**

COVER DIMENSIONS AS PER E2/AS1

	SITUATION 1	SITUATION 2	SITUATION 3
	Low, Medium & High Wind Zones where roof pitch $\geq 10^\circ$ (Excludes any soft edge or turn-down)	All roof pitches in Very High zone. Low, Medium & High Wind Zones where roof pitch $\leq 10^\circ$ (Excludes any soft edge or turn-down)	All roof pitches in Extra High wind zone (Excludes any soft edge or turn-down)
X	130 MIN	200 MIN	200 MIN
Y	Cover at least two crests (turned-up edge to full crest height constitutes a crest)		
Z	50 MIN	70 MIN	90 MIN

Barge flashing to match roofing.
Materials & Fixings as per Dimond Technical Data, E2/AS1 & MRM Code of Practice

Stopsends to Dimond Roofing

Prefinished screw

Fascia

Soffit lining

Flashing to match roofing Materials & Fixings as per Dimond Technical Data, E2/AS1 & MRM Code of Practice

Dimond Wall cladding cavity fixed

Prefinished screw with neoprene washer

Soft edge dressed over roofing profile

Dimond Corrugate roofing profile

Purlins (indicative only)

Roof Underlay (shown dashed)

Roof framing (indicative only)

Prefinished screw with neoprene washer

Prefinished screw

Wall Underlay (shown dashed)

Wall framing (shown indicative only)

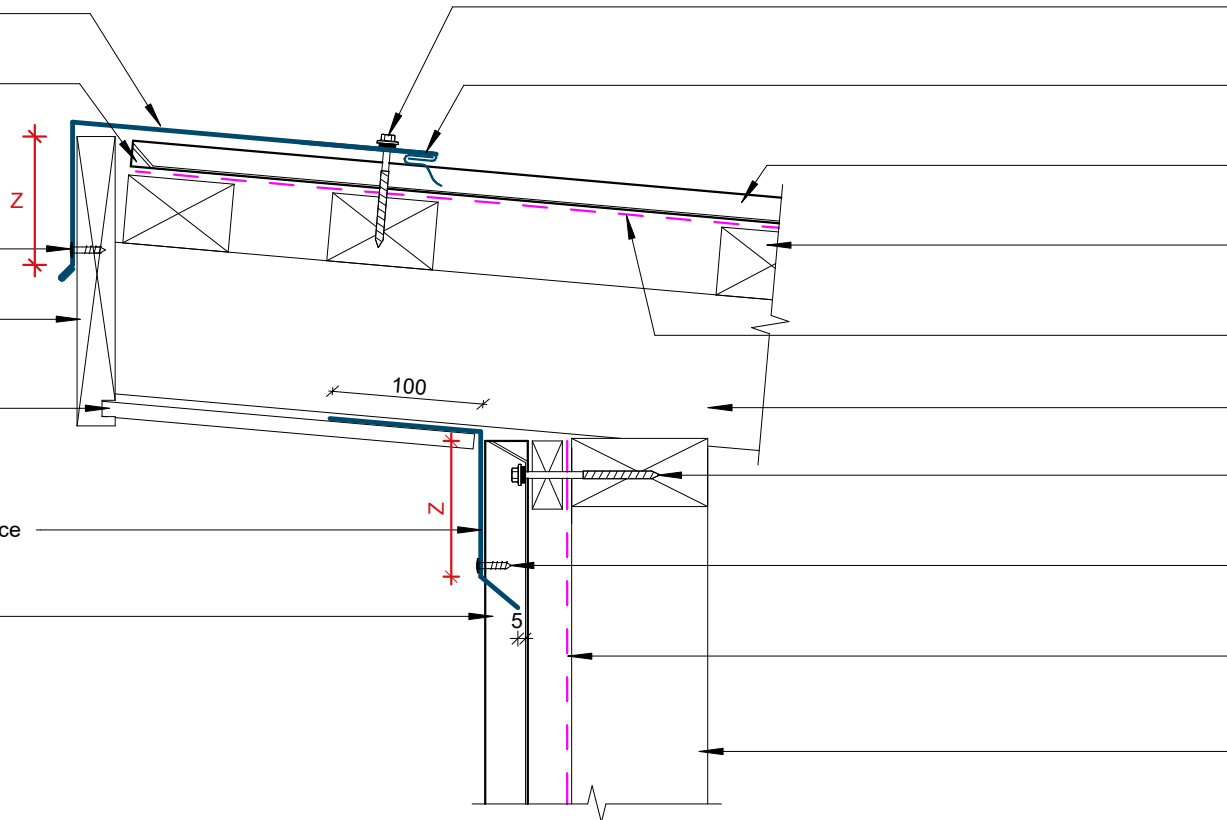

GENERAL NOTE

Cavity battens or timber framing that contain copper must be separated from steel cladding by a strip of wall or roof underlay or DPC.

Raking Barge Flashing Detail

COVER DIMENSIONS AS PER E2/AS1

	SITUATION 1	SITUATION 2	SITUATION 3
	Low, Medium & High Wind Zones where roof pitch $\geq 10^\circ$ (Excludes any soft edge or turn-down)	All roof pitches in Very High zone. Low, Medium & High Wind Zones where roof pitch $\leq 10^\circ$ (Excludes any soft edge or turn-down)	All roof pitches in Extra High wind zone (Excludes any soft edge or turn-down)
X	130 MIN	200 MIN	200 MIN
Y	Cover at least two crests (turned-up edge to full crest height constitutes a crest)		
Z	50 MIN	70 MIN	90 MIN

Stopends to Dimond Roofing

Flashing to match roofing.
Materials & Fixings as per Dimond Technical Data, E2/AS1 & MRM Code of Practice

Birds beak edge

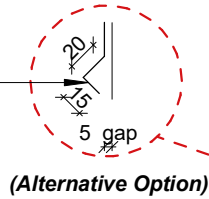

Prefinished screw

Dimond Wall cladding cavity fixed

Prefinished screw with neoprene washer

Wall Underlay (shown dashed)

Soft edge dressed over roofing profile

Dimond Corrugate roofing profile

Roof Underlay lapped over Wall underlay (shown dashed)

Purlins (indicative only)

Roof framing (indicative only)

Wall framing (shown indicative only)

GENERAL NOTE

Cavity battens or timber framing that contain copper must be separated from steel cladding by a strip of wall or roof underlay or DPC.

Sawtooth Wall Detail

Rev: 1 Corrugate Residential Roofing



©Dimond 2023, all rights reserved. The information and specifications contained in this document are proprietary to Dimond and may not be used other than for the purpose of designing or building a roof or roofing system solely using products supplied or approved by Dimond ("Permitted Purpose"). You may copy this document solely for the Permitted Purpose, but may not otherwise copy, publish, distribute or modify this document without Dimond's prior written consent. Dimond will not be liable for any use of this document or information and specifications contained in this document, other than for the Permitted Purpose

Date: May 2025 Scale: 1 : 5 Sheet: CRR05

COVER DIMENSIONS AS PER E2/AS1

	SITUATION 1	SITUATION 2	SITUATION 3
	Low, Medium & High Wind Zones where roof pitch $\geq 10^\circ$ (Excludes any soft edge or turn-down)	All roof pitches in Very High zone. Low, Medium & High Wind Zones where roof pitch $\leq 10^\circ$ (Excludes any soft edge or turn-down)	All roof pitches in Extra High wind zone (Excludes any soft edge or turn-down)
X	130 MIN	200 MIN	200 MIN
Y	Cover at least two crests (turned-up edge to full crest height constitutes a crest)		
Z	50 MIN	70 MIN	90 MIN

Flashing to match roofing.
Materials & Fixings as per Dimond Technical Data, E2/AS1 & MRM Code of Practice

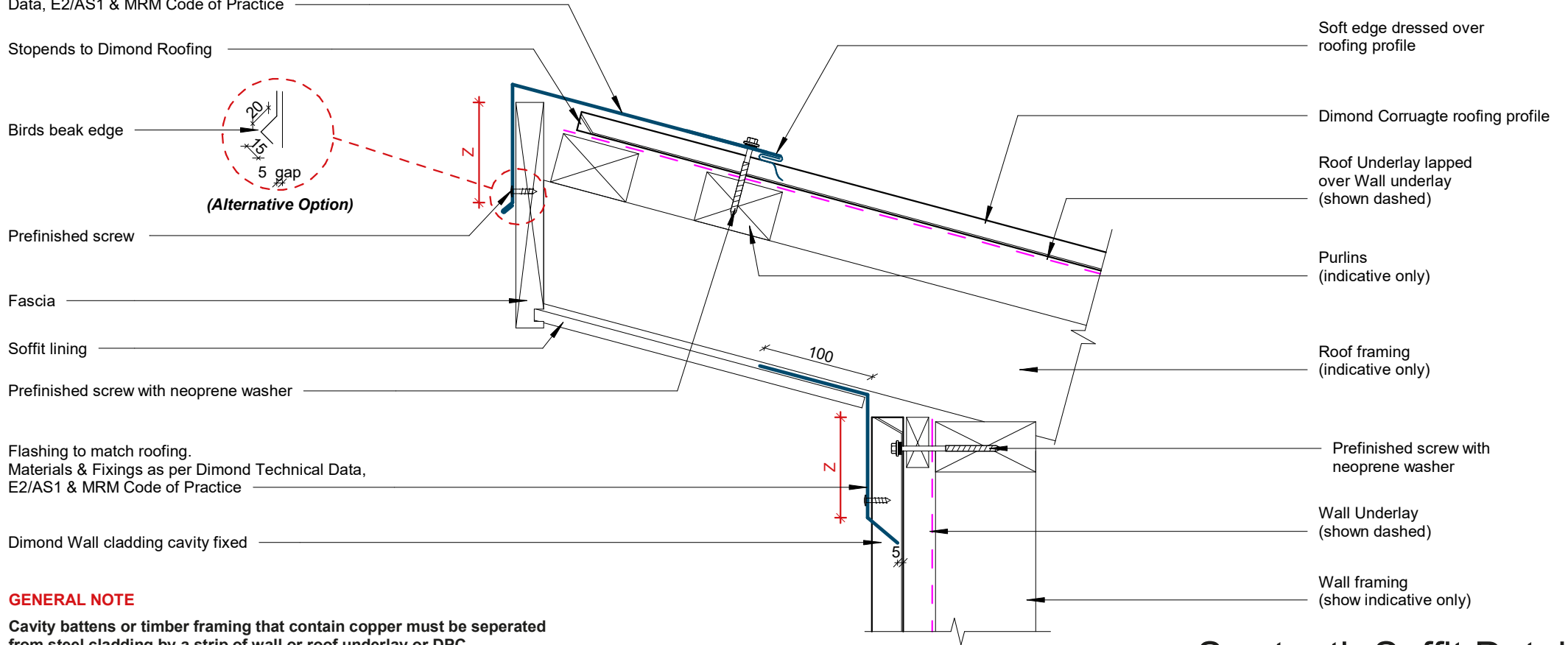

GENERAL NOTE

Cavity battens or timber framing that contain copper must be separated from steel cladding by a strip of wall or roof underlay or DPC.

Sawtooth Soffit Detail

Rev: 1 Corrugate Residential Roofing



©Dimond 2023, all rights reserved. The information and specifications contained in this document are proprietary to Dimond and may not be used other than for the purpose of designing or building a roof or roofing system solely using products supplied or approved by Dimond ("Permitted Purpose"). You may copy this document solely for the Permitted Purpose, but may not otherwise copy, publish, distribute or modify this document without Dimond's prior written consent. Dimond will not be liable for any use of this document or information and specifications contained in this document, other than for the Permitted Purpose

Date: May 2025 Scale: 1 : 5 Sheet: CRR06

COVER DIMENSIONS AS PER E2/AS1

	SITUATION 1	SITUATION 2	SITUATION 3
	Low, Medium & High Wind Zones where roof pitch $\geq 10^\circ$ (Excludes any soft edge or turn-down)	All roof pitches in Very High zone. Low, Medium & High Wind Zones where roof pitch $\leq 10^\circ$ (Excludes any soft edge or turn-down)	All roof pitches in Extra High wind zone (Excludes any soft edge or turn-down)
X	130 MIN	200 MIN	200 MIN
Y	Cover at least two crests (turned-up edge to full crest height constitutes a crest)		
Z	50 MIN	70 MIN	90 MIN

Parapet cap flashing to match roofing.
Materials & Fixings as per Dimond Technical Data, E2/AS1 & MRM Code of Practice

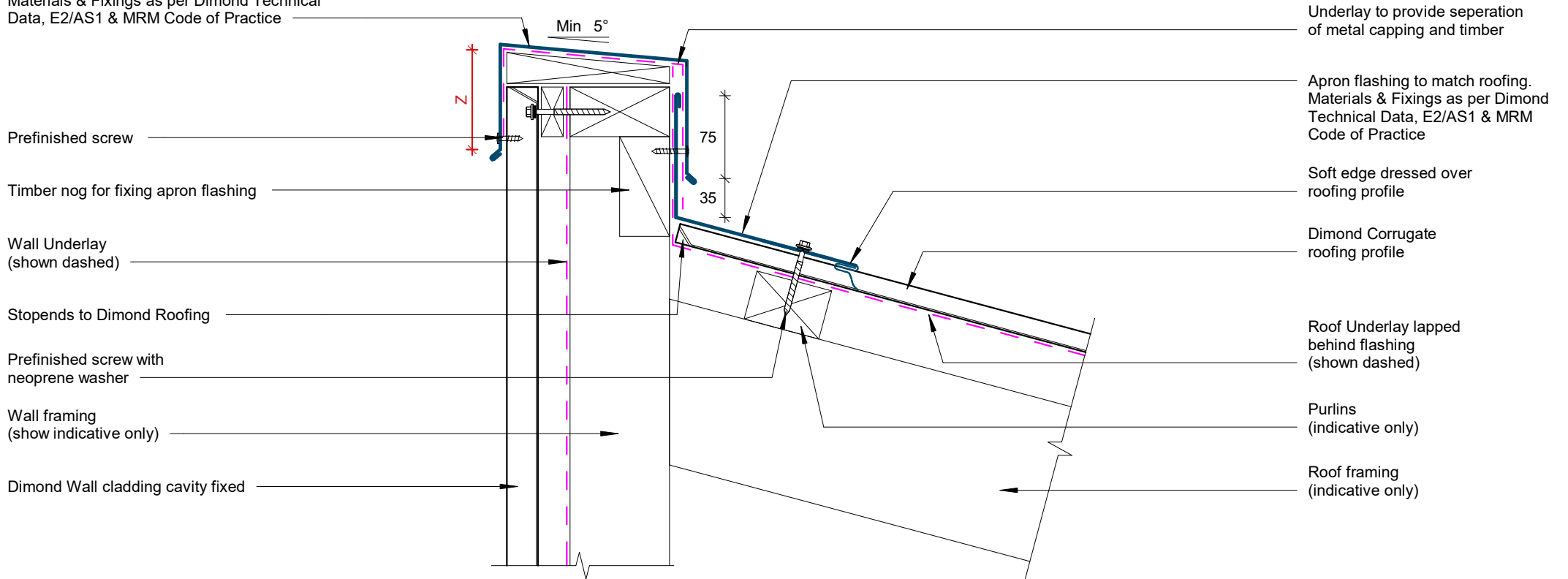

GENERAL NOTE

Cavity battens or timber framing that contain copper must be separated from steel cladding by a strip of wall or roof underlay or DPC.

Parapet Apron Detail

Rev: 1 **Corrugate Residential Roofing**



©Dimond 2023, all rights reserved. The information and specifications contained in this document are proprietary to Dimond and may not be used other than for the purpose of designing or building a roof or roofing system solely using products supplied or approved by Dimond ("Permitted Purpose"). You may copy this document solely for the Permitted Purpose, but may not otherwise copy, publish, distribute or modify this document without Dimond's prior written consent. Dimond will not be liable for any use of this document or information and specifications contained in this document, other than for the Permitted Purpose

Date: May 2025 Scale: 1 : 5 Sheet: **CRR07**

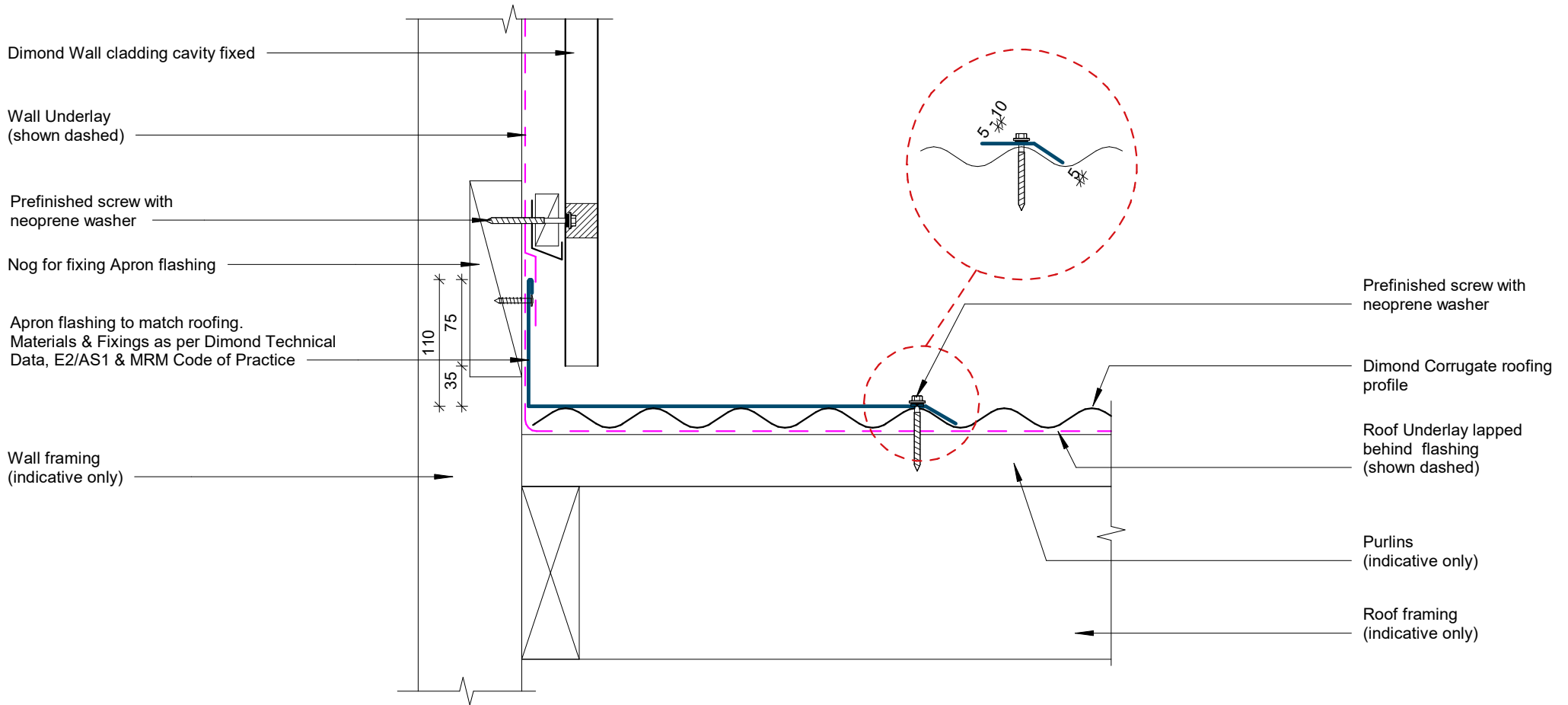

GENERAL NOTE

Cavity battens or timber framing that contain copper must be separated from steel cladding by a strip of wall or roof underlay or DPC.

Apron Parallel Detail

Rev: 1 Corrugate Residential Roofing



©Dimond 2023, all rights reserved. The information and specifications contained in this document are proprietary to Dimond and may not be used other than for the purpose of designing or building a roof or roofing system solely using products supplied or approved by Dimond ("Permitted Purpose"). You may copy this document solely for the Permitted Purpose, but may not otherwise copy, publish, distribute or modify this document without Dimond's prior written consent. Dimond will not be liable for any use of this document or information and specifications contained in this document, other than for the Permitted Purpose

Date: May 2025 Scale: 1 : 5 Sheet: CRR08

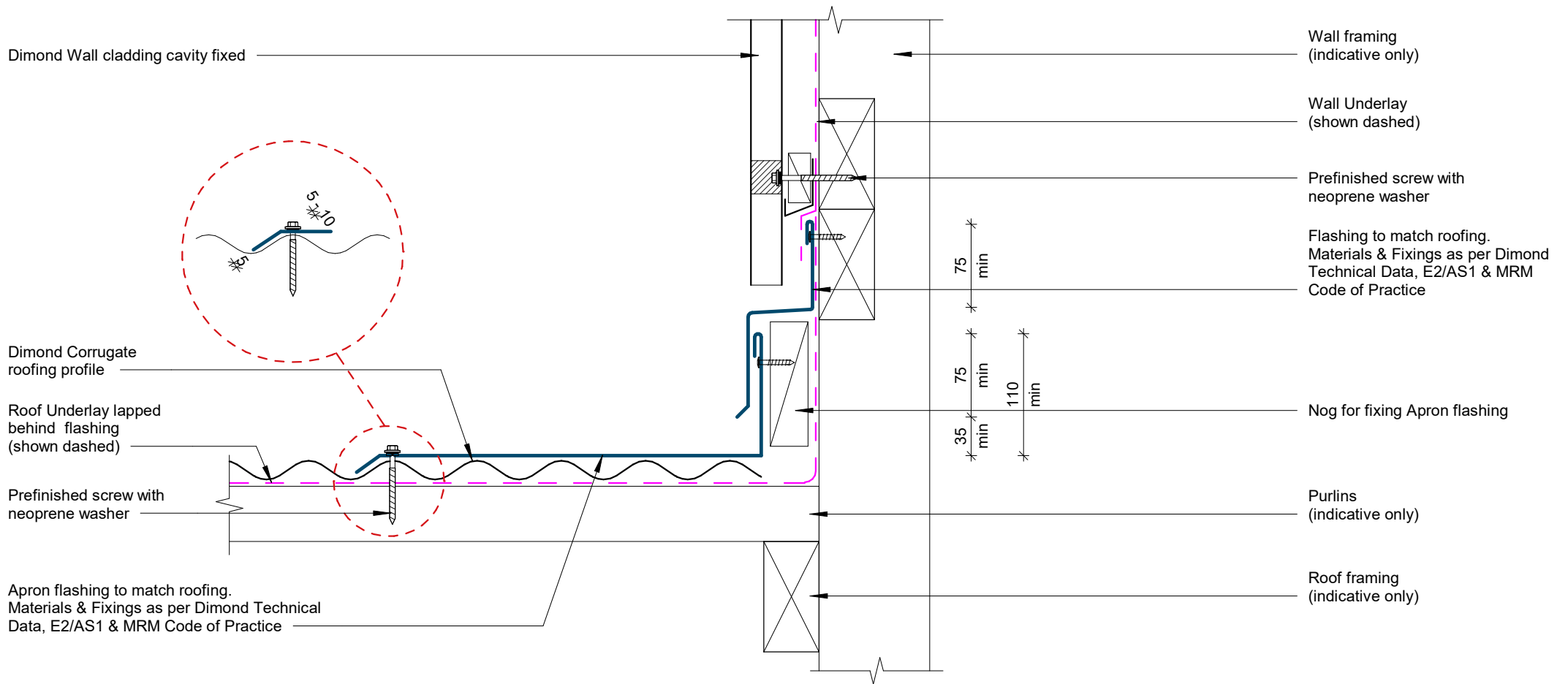

GENERAL NOTE

Cavity battens or timber framing that contain copper must be separated from steel cladding by a strip of wall or roof underlay or DPC.

Apron Parallel Two Piece Detail

COVER DIMENSIONS AS PER E2/AS1

	SITUATION 1 Low, Medium & High Wind Zones where roof pitch $\geq 10^\circ$ (Excludes any soft edge or turn-down)	SITUATION 2 All roof pitches in Very High zone. Low, Medium & High Wind Zones where roof pitch $\leq 10^\circ$ (Excludes any soft edge or turn-down)	SITUATION 3 All roof pitches in Extra High wind zone (Excludes any soft edge or turn-down)
X	130 MIN	200 MIN	200 MIN
Y	Cover at least two crests (turned-up edge to full crest height constitutes a crest)		
Z	50 MIN	70 MIN	90 MIN

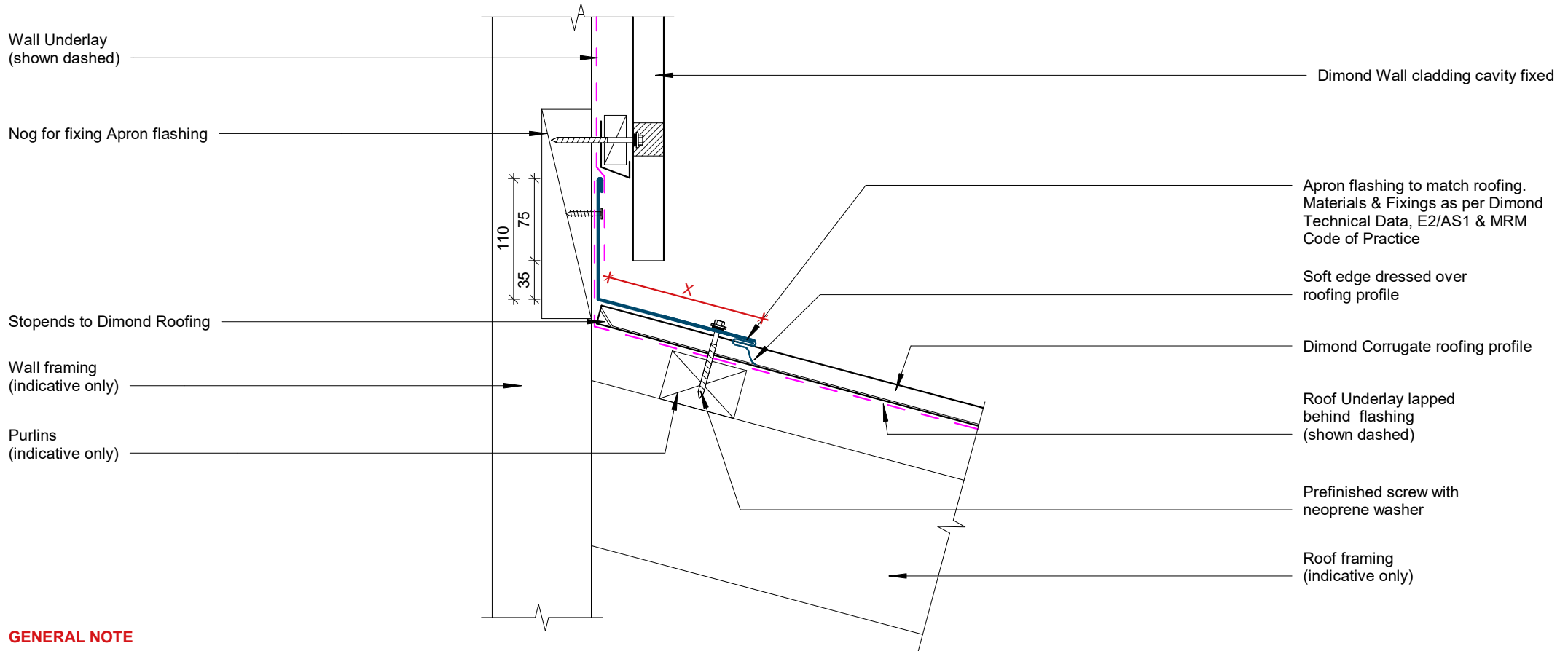

GENERAL NOTE

Cavity battens or timber framing that contain copper must be separated from steel cladding by a strip of wall or roof underlay or DPC.

Apron Transverse Detail

Rev: 1 **Corrugate Residential Roofing**



©Dimond 2023, all rights reserved. The information and specifications contained in this document are proprietary to Dimond and may not be used other than for the purpose of designing or building a roof or roofing system solely using products supplied or approved by Dimond ("Permitted Purpose"). You may copy this document solely for the Permitted Purpose, but may not otherwise copy, publish, distribute or modify this document without Dimond's prior written consent. Dimond will not be liable for any use of this document or information and specifications contained in this document, other than for the Permitted Purpose

Date: May 2025 Scale: 1 : 5 Sheet: **CRR10**

COVER DIMENSIONS AS PER E2/AS1		
SITUATION 1	SITUATION 2	SITUATION 3
Low, Medium & High Wind Zones where roof pitch $\geq 10^\circ$ (Excludes any soft edge or turn-down)	All roof pitches in Very High zone. Low, Medium & High Wind Zones where roof pitch $\leq 10^\circ$ (Excludes any soft edge or turn-down)	All roof pitches in Extra High wind zone (Excludes any soft edge or turn-down)
X 130 MIN	200 MIN	200 MIN
Y Cover at least two crests (turned-up edge to full crest height constitutes a crest)		
Z 50 MIN	70 MIN	90 MIN

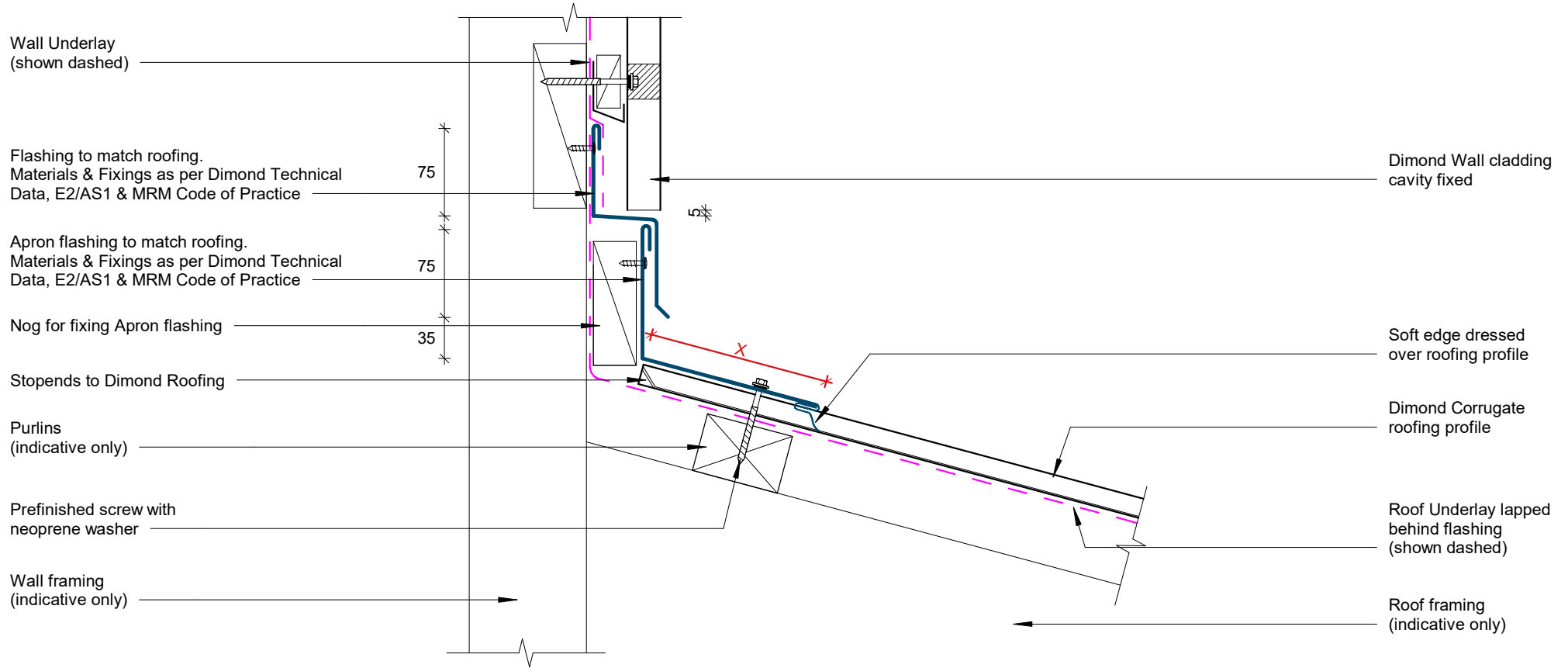

GENERAL NOTE

Cavity battens or timber framing that contain copper must be separated from steel cladding by a strip of wall or roof underlay or DPC.

Apron Transverse Two Piece Detail

COVER DIMENSIONS AS PER E2/AS1

SITUATION 1

Low, Medium & High Wind Zones where roof pitch $\geq 10^\circ$
(Excludes any soft edge or turn-down)

SITUATION 2

All roof pitches in Very High zone.
Low, Medium & High Wind Zones where roof pitch $\leq 10^\circ$
(Excludes any soft edge or turn-down)

X	130mm MIN	200mm MIN
Y	Cover at least two crests (turned-up edge to full crest height constitutes a crest)	
Z	50mm MIN	70mm MIN

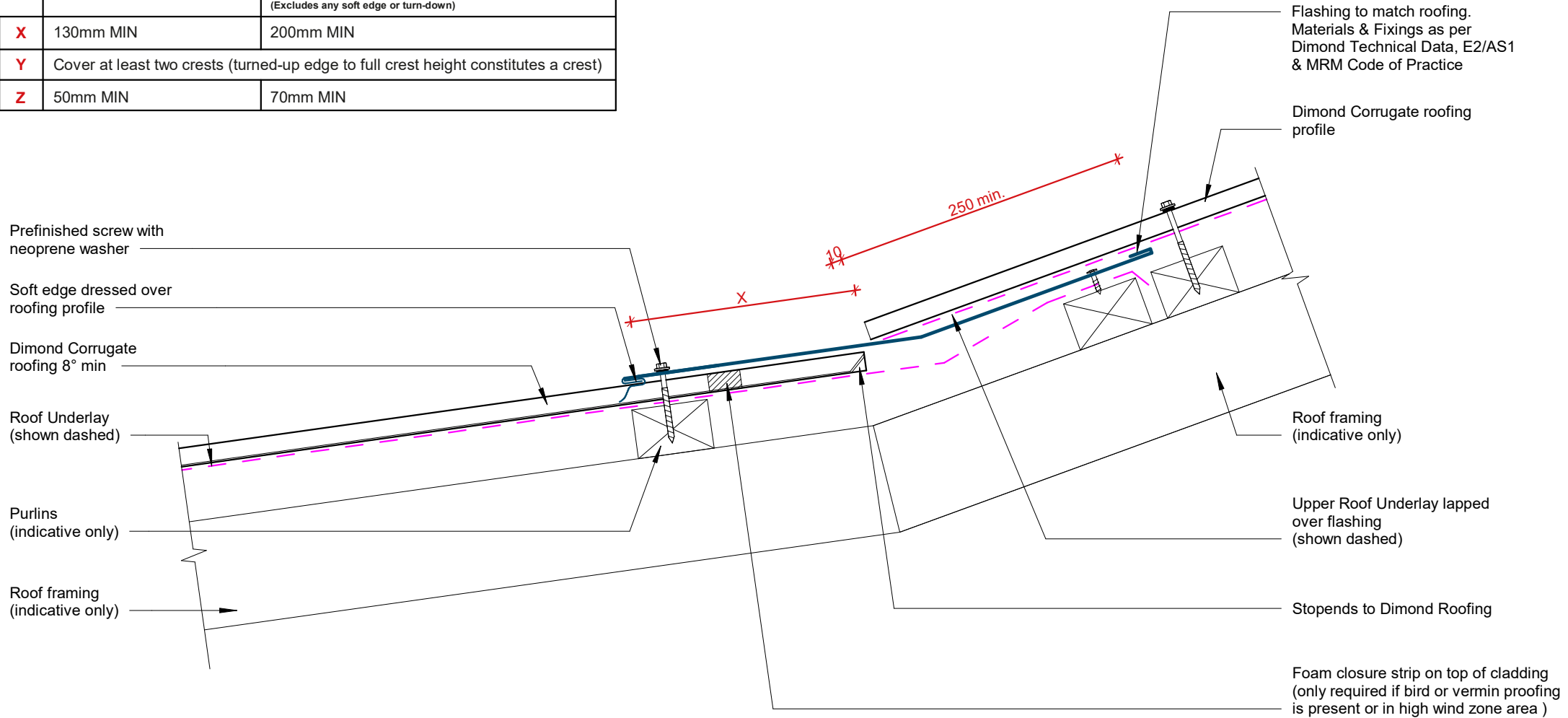

Change of Pitch Detail

Rev: 1 **Corrugate Residential Roofing**

COVER DIMENSIONS AS PER E2/AS1

	SITUATION 1	SITUATION 2	SITUATION 3
	Low, Medium & High Wind Zones where roof pitch $\geq 10^\circ$ (Excludes any soft edge or turn-down)	All roof pitches in Very High zone. Low, Medium & High Wind Zones where roof pitch $\leq 10^\circ$ (Excludes any soft edge or turn-down)	All roof pitches in Extra High wind zone (Excludes any soft edge or turn-down)
X	130 MIN	200 MIN	200 MIN
Y	Cover at least two crests (turned-up edge to full crest height constitutes a crest)		
Z	50 MIN	70 MIN	90 MIN

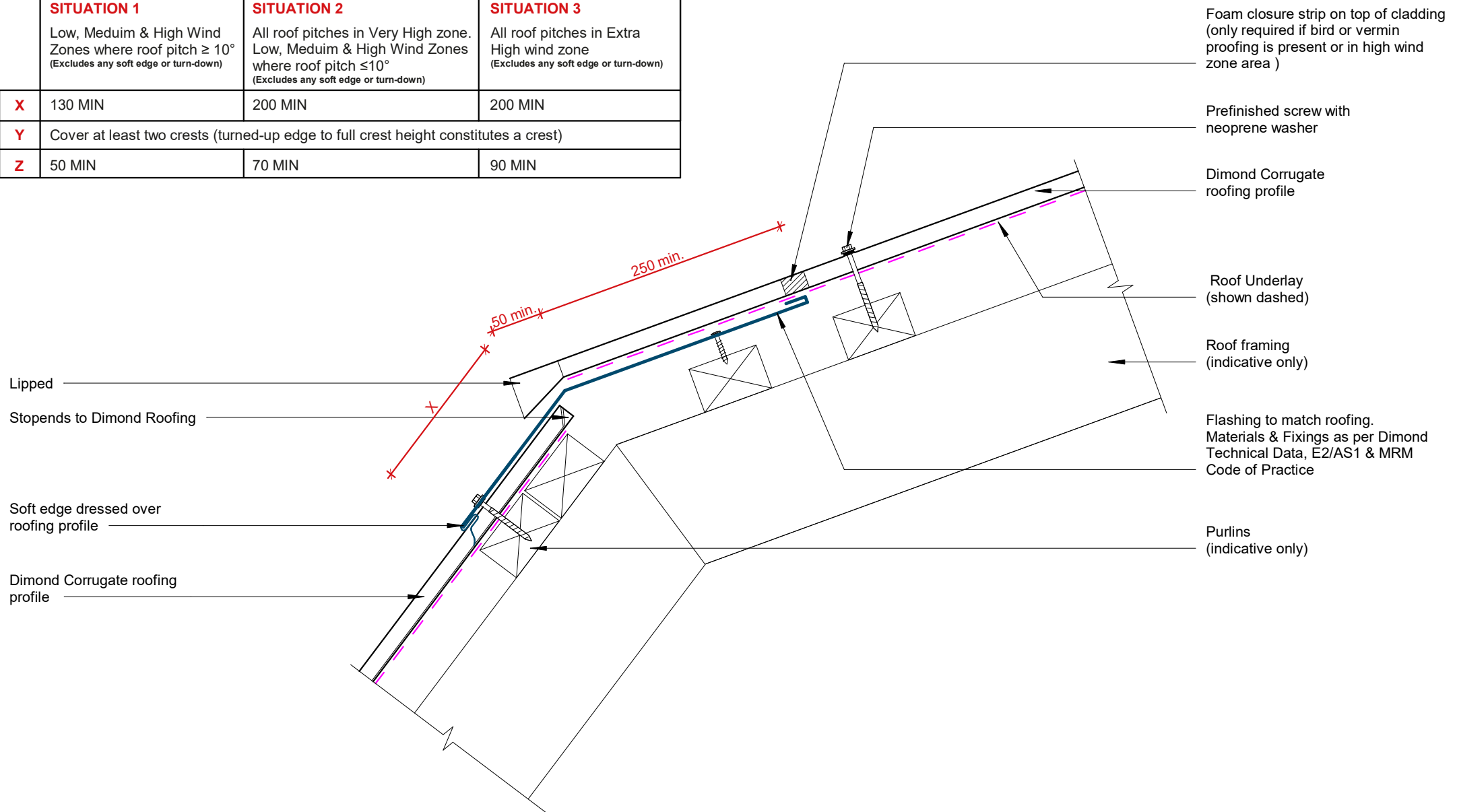

Mansard Detail



©Dimond 2023, all rights reserved. The information and specifications contained in this document are proprietary to Dimond and may not be used other than for the purpose of designing or building a roof or roofing system solely using products supplied or approved by Dimond ("Permitted Purpose"). You may copy this document solely for the Permitted Purpose, but may not otherwise copy, publish, distribute or modify this document without Dimond's prior written consent. Dimond will not be liable for any use of this document or information and specifications contained in this document, other than for the Permitted Purpose

Rev: 1 **Corrugate Residential Roofing**

Date: May 2025 Scale: 1 : 5 Sheet: **CRR13**

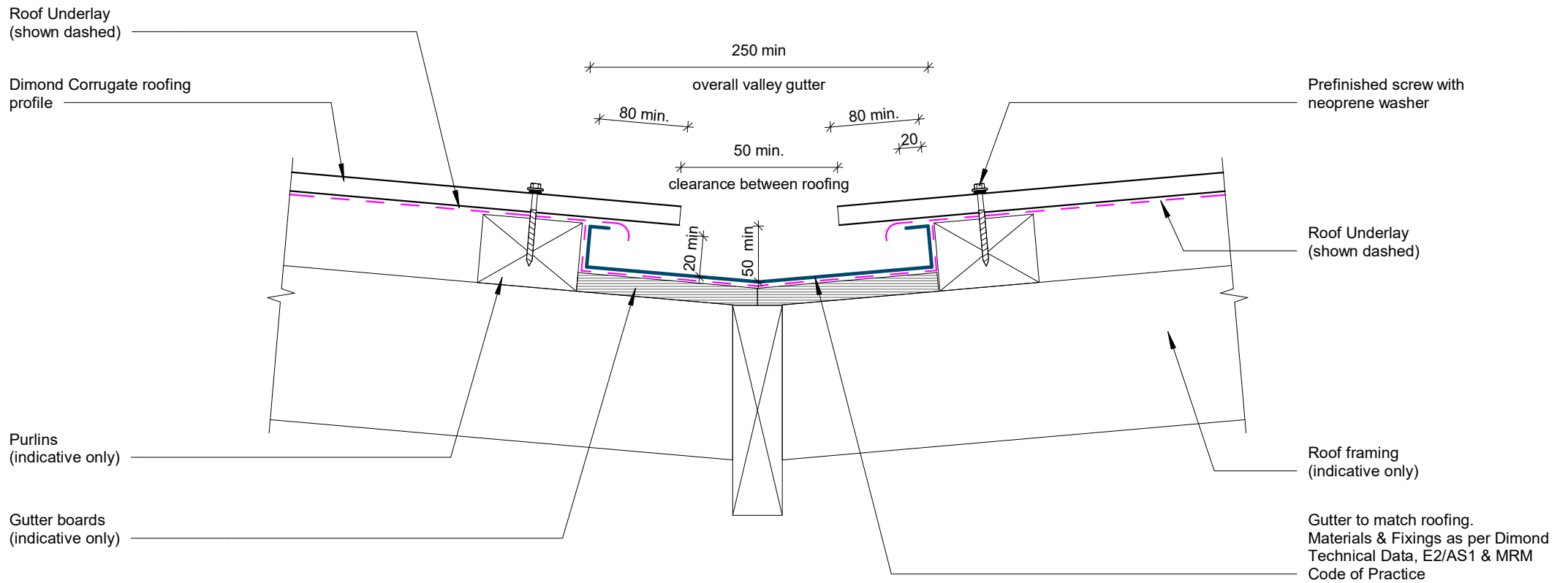

Refer to New Zealand metal roof manufacturers code of practice for design & minimum dimensions for valley gutter.

Valley Detail

Gutter size to E2/AS1 or MRM Code of practice.
Refer to New Zealand metal roof manufacturers code of practice for design & minimum dimensions.

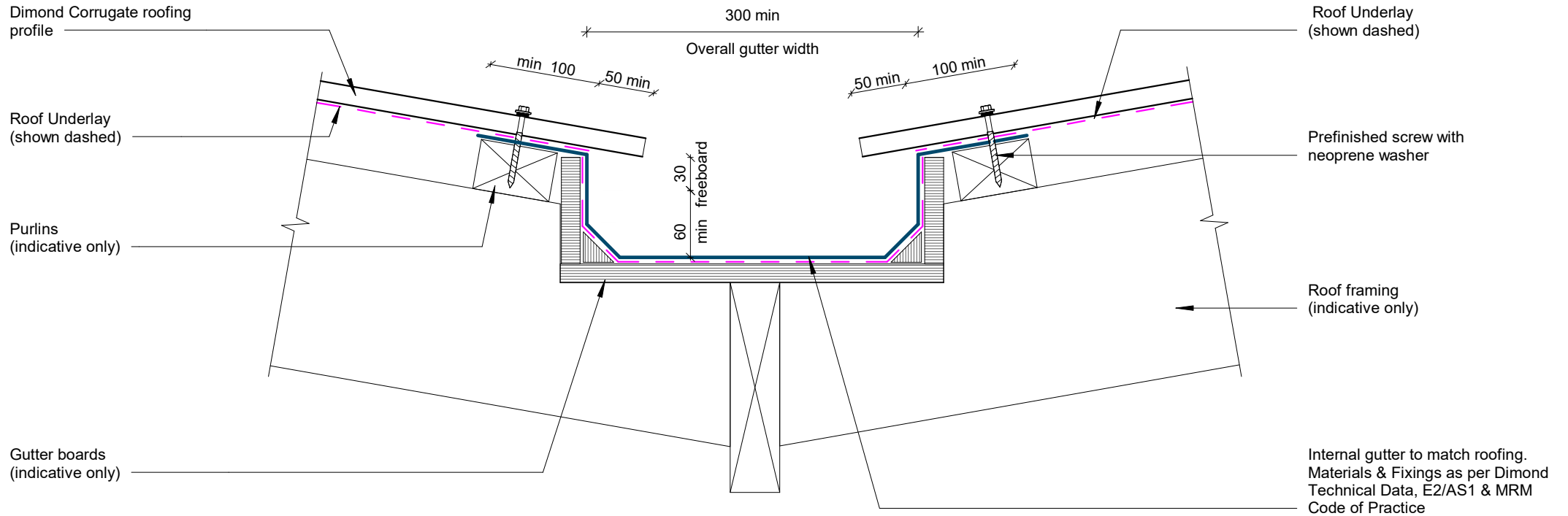

Internal Gutter Detail

Rev: 1 Corrugate Residential Roofing

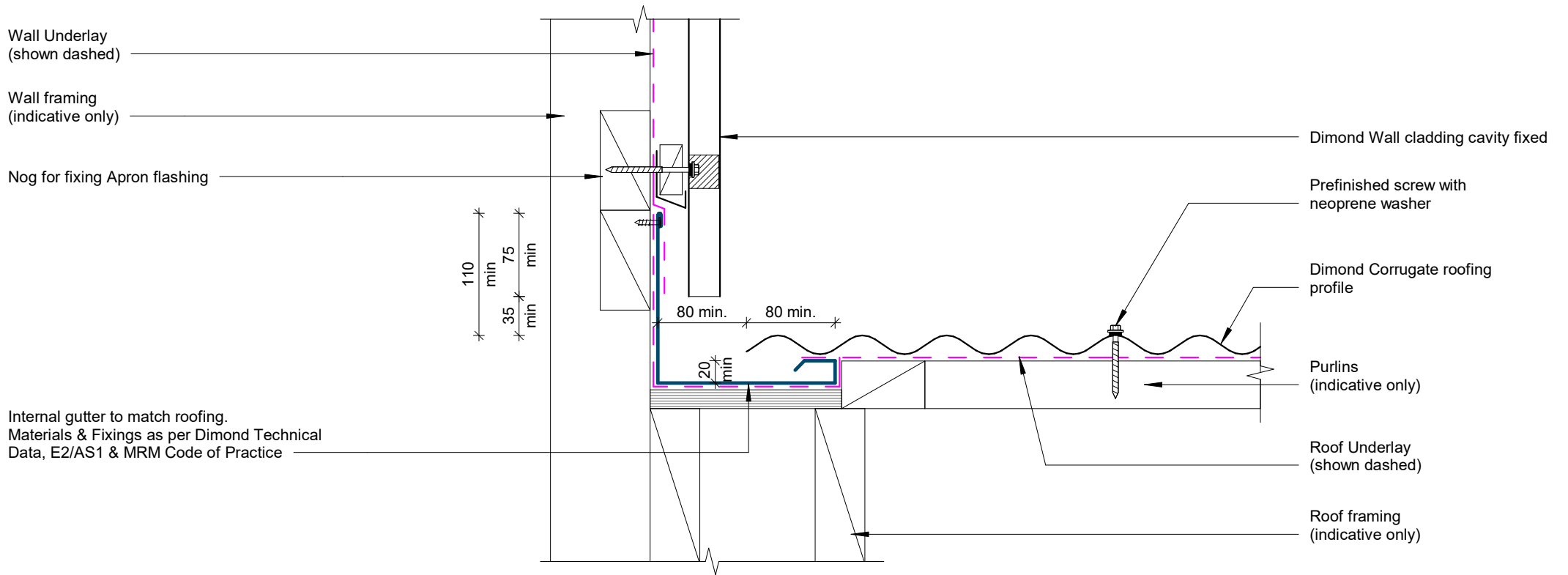

GENERAL NOTE

Cavity battens or timber framing that contain copper must be separated from steel cladding by a strip of wall or roof underlay or DPC.

Parallel Hidden Gutter Detail

Rev: 1 **Corrugate Residential Roofing**



©Dimond 2023, all rights reserved. The information and specifications contained in this document are proprietary to Dimond and may not be used other than for the purpose of designing or building a roof or roofing system solely using products supplied or approved by Dimond ("Permitted Purpose"). You may copy this document solely for the Permitted Purpose, but may not otherwise copy, publish, distribute or modify this document without Dimond's prior written consent. Dimond will not be liable for any use of this document or information and specifications contained in this document, other than for the Permitted Purpose

Date: May 2025 Scale: 1 : 5 Sheet: **CRR16**

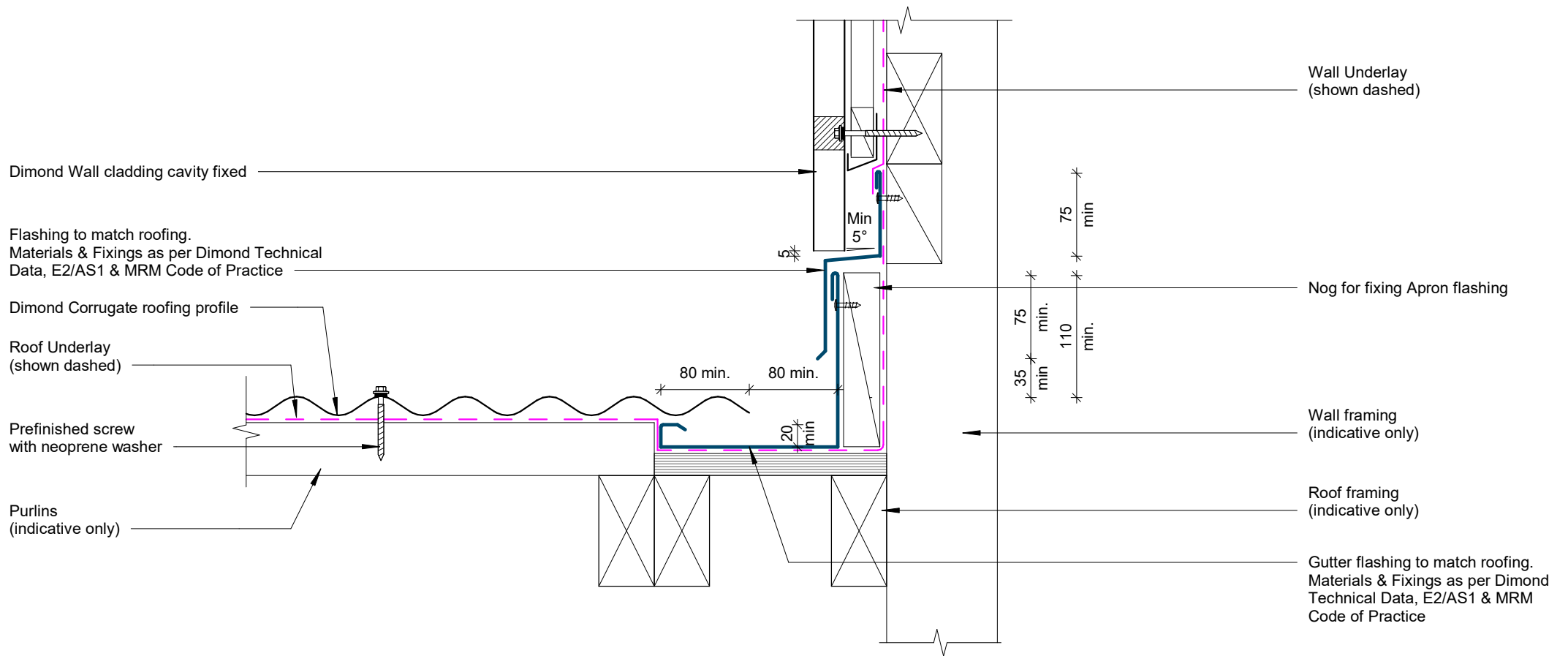

GENERAL NOTE

Cavity battens or timber framing that contain copper must be separated from steel cladding by a strip of wall or roof underlay or DPC.

Parallel Hidden Gutter Two Piece Detail

COVER DIMENSIONS AS PER E2/AS1

	SITUATION 1	SITUATION 2	SITUATION 3
	Low, Medium & High Wind Zones where roof pitch $\geq 10^\circ$ (Excludes any soft edge or turn-down)	All roof pitches in Very High zone. Low, Medium & High Wind Zones where roof pitch $\leq 10^\circ$ (Excludes any soft edge or turn-down)	All roof pitches in Extra High wind zone (Excludes any soft edge or turn-down)
X	130 MIN	200 MIN	200 MIN
Y	Cover at least two crests (turned-up edge to full crest height constitutes a crest)		
Z	50 MIN	70 MIN	90 MIN

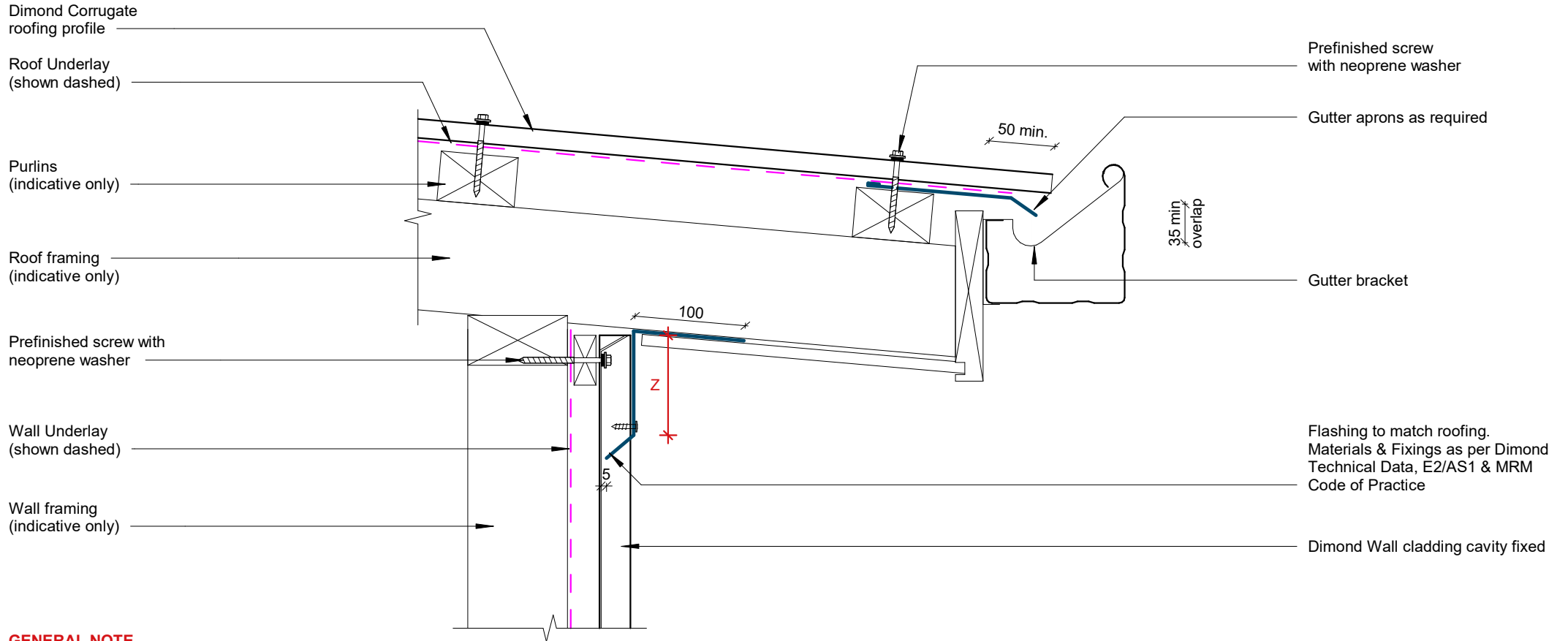

GENERAL NOTE

Cavity battens or timber framing that contain copper must be separated from steel cladding by a strip of wall or roof underlay or DPC.

Eave Detail

Note:

Min 10° for pipe penetration direct fix boot flashing is applicable for when less than 50% blockage occurs.

When exceeding 50% blockage, refer to back tray boot flashing. Refer MRM code of practice.

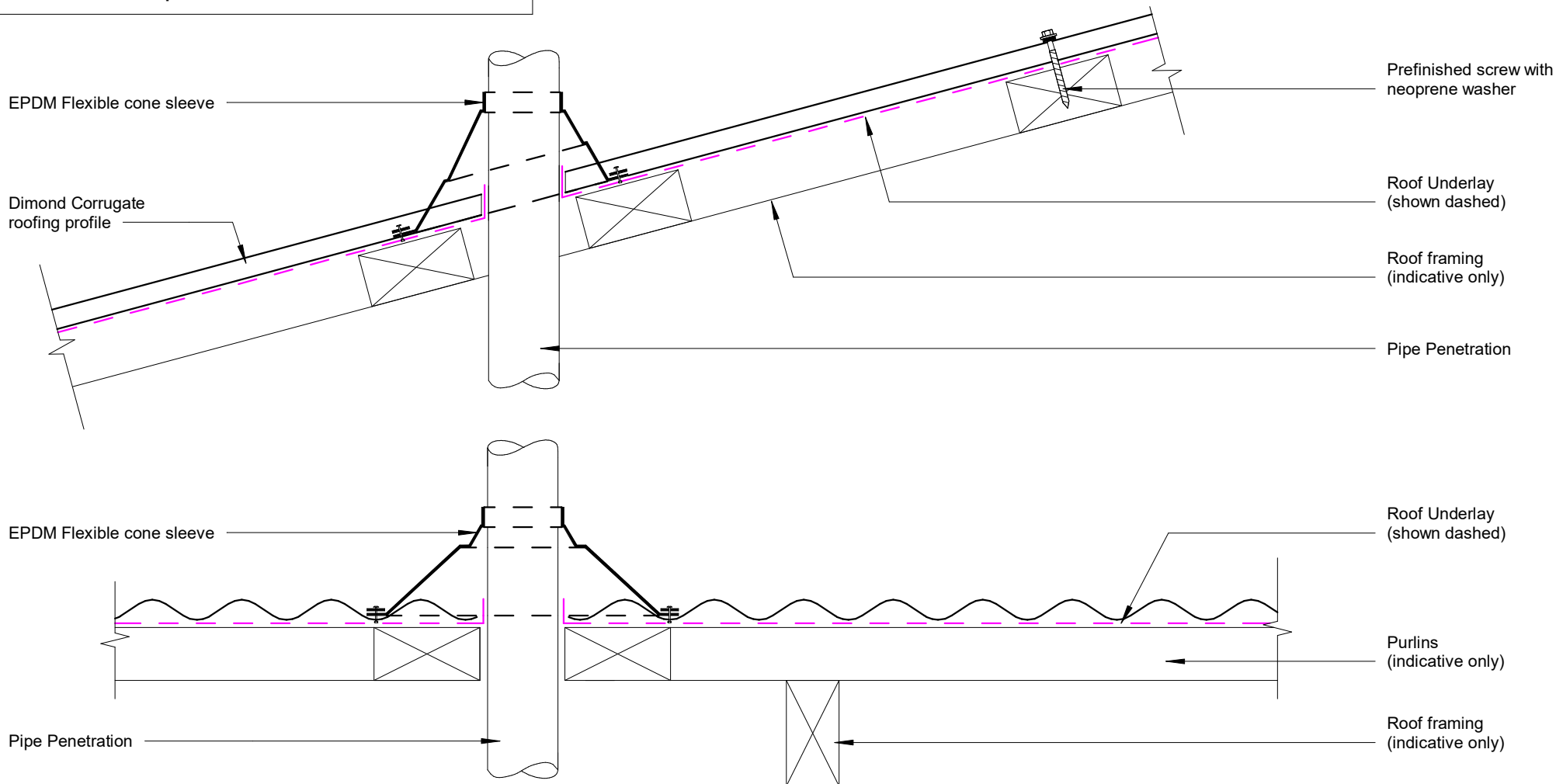

Pipe Penetration Direct Fix Detail

COVER DIMENSIONS AS PER E2/AS1

	SITUATION 1 Low, Medium & High Wind Zones where roof pitch $\geq 10^\circ$ (Excludes any soft edge or turn-down)	SITUATION 2 All roof pitches in Very High zone. Low, Medium & High Wind Zones where roof pitch $\leq 10^\circ$ (Excludes any soft edge or turn-down)	SITUATION 3 All roof pitches in Extra High wind zone (Excludes any soft edge or turn-down)
X	130 MIN	200 MIN	200 MIN
Y	Cover at least two crests (turned-up edge to full crest height constitutes a crest)		
Z	50 MIN	70 MIN	90 MIN

Note:
Min 8° for pipe penetration with a boot flashing.
Refer MRM code of practice

Back Tray to match roofing.
Materials & Fixings as per Dimond Technical Data, E2/AS1 & MRM Code of Practice

Ridge flashing to match roofing.
Materials & Fixings as per Dimond Technical Data, E2/AS1 & MRM Code of Practice

Stopends to Dimond Roofing

Soft edge dressed over profile

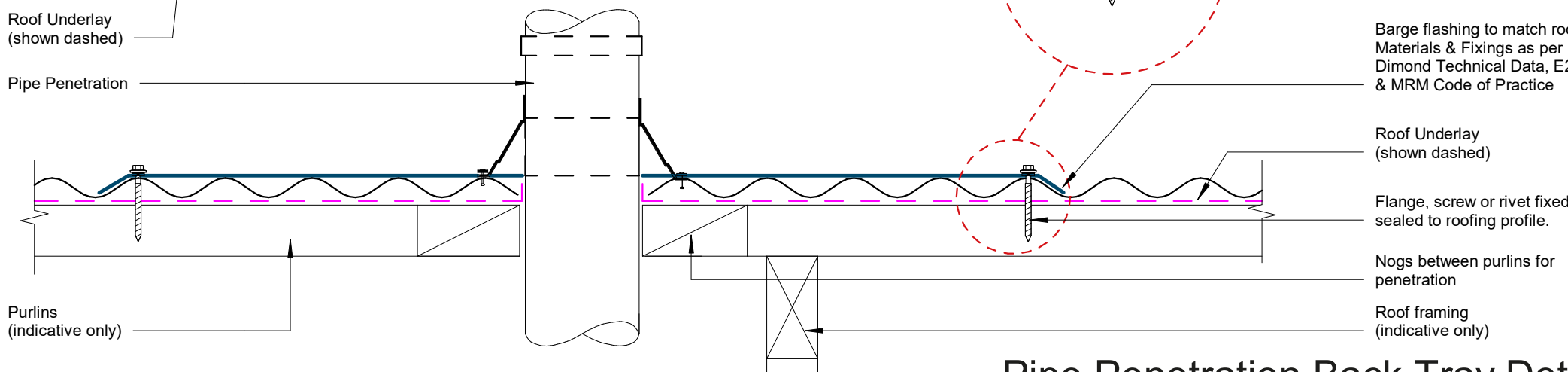
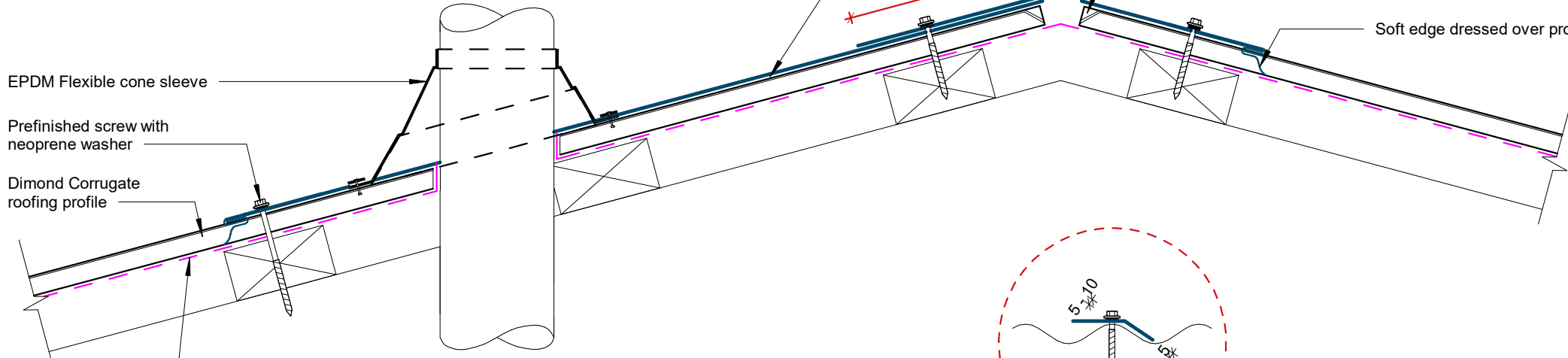

Barge flashing to match roofing.
Materials & Fixings as per Dimond Technical Data, E2/AS1 & MRM Code of Practice

Roof Underlay (shown dashed)

Flange, screw or rivet fixed and sealed to roofing profile.

Nogs between purlins for penetration

Roof framing (indicative only)

Pipe Penetration Back Tray Detail



©Dimond 2023, all rights reserved. The information and specifications contained in this document are proprietary to Dimond and may not be used other than for the purpose of designing or building a roof or roofing system solely using products supplied or approved by Dimond ("Permitted Purpose"). You may copy this document solely for the Permitted Purpose, but may not otherwise copy, publish, distribute or modify this document without Dimond's prior written consent. Dimond will not be liable for any use of this document or information and specifications contained in this document, other than for the Permitted Purpose

Rev: 1 **Corrugate Residential Roofing**

Date: May 2025 Scale: 1 : 5 Sheet: **CRR20**