

H3.1 timber capping support ex
50mm on dpc

Climaseal screw fixed @ 600 c/c
max. M6 x 25mm roofzip

Fix capping to concrete with
6.5mm x 20mm metal pin anchors
@ 1000mm centers

Notched flashing fixed to ribs with
12g x 65mm T17 every second rib

Roofing underlay and netting
shown dashed

Dimond V-Rib Cladding (specify
thickness and coating)

Foam closure strip on top of
roofing (see note below)

Dimond hi-span steel purlin
(specify size)

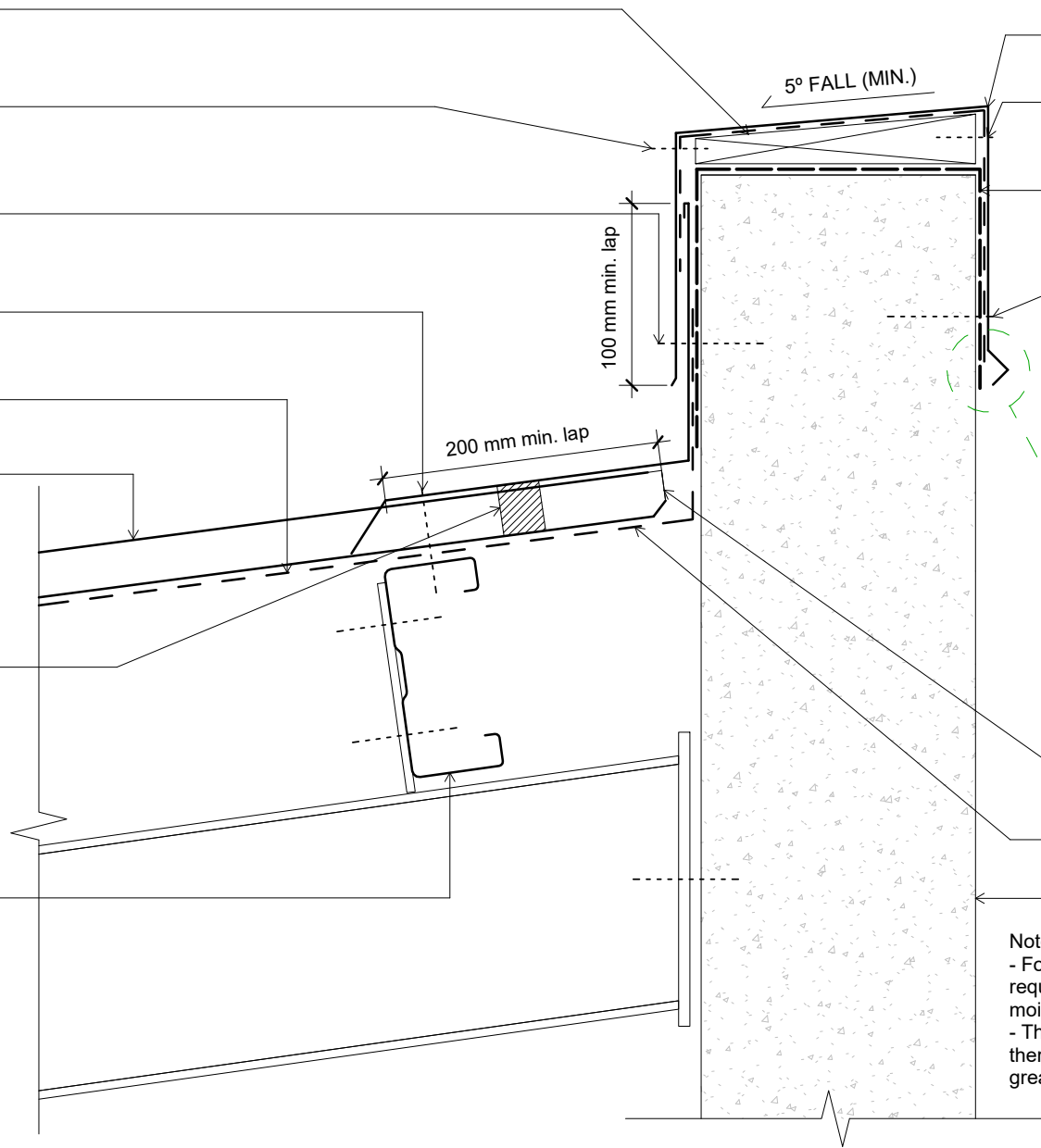

0.55mm parapet flashing (specify
coating)

Climaseal screw fixed @ 600 c/c
max. M6 x 25mm roofzip

Separation barrier with self
adhesive tape or similar around
concrete wall

Fix capping to concrete with
6.5mm x 20mm metal pin anchors
@ 1000mm centers

Cut edge must avoid contact with
concrete. Avoid overpainting
flashing to concrete joint.

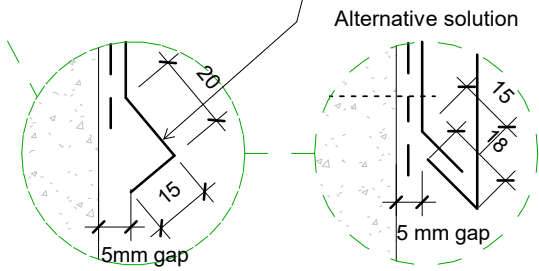

Dimond V-rib stop ended

Roofing underlay and netting
shown dashed

Concrete wall

Notes:

- Foam closure strip only required if bird or vermin proofing is required, or if in a high wind area, there is a risk of windblown moisture entering the building.
- These details are suitably fixed to allow for a theoretical thermal movement of up to 10mm. For thermal movement greater than this a clipping system should be considered.

Original Size A4



V-Rib
Roof
Parapet Detail

File:	
Issue:	01
Scale:	As indicated
Date:	28 November 2018
Reference:	dim_vri_1010