

Climaseal coated self drilling M6 x 50 Roofzip rib fixed

Additional flashing for high wind exposure notched over lower roof profile

Foam closure strip under roofing (see note below)

Fix with self drilling M6 x 25 Roofzip for high wind exposure

Dimond Veedek® roofing (specify thickness and coating)

Potential dirt build-up

Dimond hi-span cold rolled steel purlin (specify size)

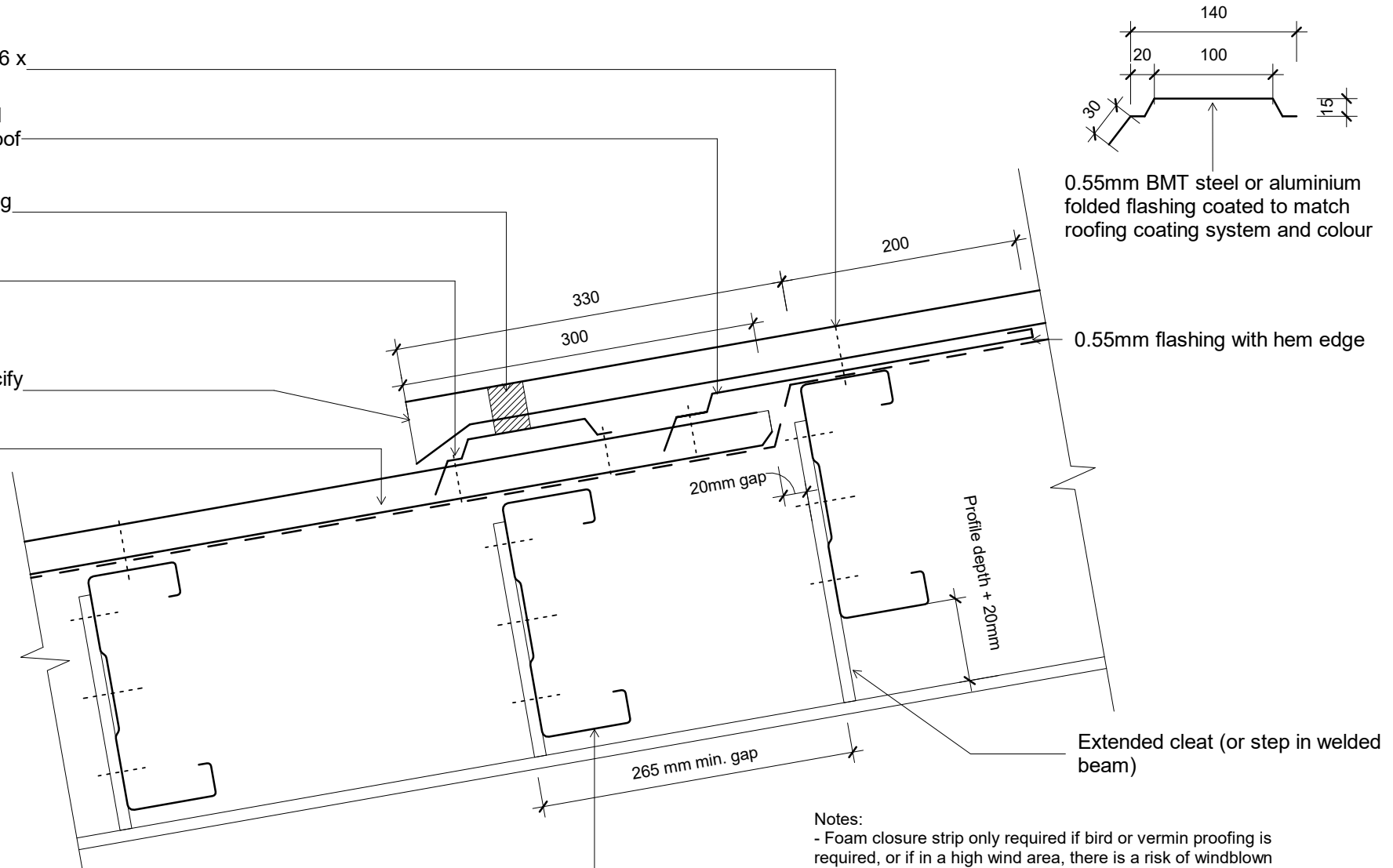

0.55mm BMT steel or aluminium folded flashing coated to match roofing coating system and colour

0.55mm flashing with hem edge

Extended cleat (or step in welded beam)

Notes:

- Foam closure strip only required if bird or vermin proofing is required, or if in a high wind area, there is a risk of windblown moisture entering the building.
- Leave foam out if ventilation is required.
- These details are suitably fixed to allow for a theoretical thermal movement of up to 10mm. For thermal movement greater than this a clipping system should be considered.

Original Size A4



**Veedek**  
Roof  
Step in Roofing

File:	
Issue: 01	Reference
Scale: 1 : 5	dim_vde_1070
Date: 28 November 2018	