

Climaseal coated self drilling 14g x 95mm tek screw every rib

Additional flashing for high wind exposure notched over lower roof profile

Foam closure strip under roofing (see note below)

Fix with self drilling 12g x 25mm T17 for high wind exposure

Dimond Topspan® roofing (specify thickness and coating)

Potential dirt build-up

Climaseal coated self drilling 14g x 95mm tek screw rib fixed

Dimond hi-span cold rolled steel purlin (specify size)

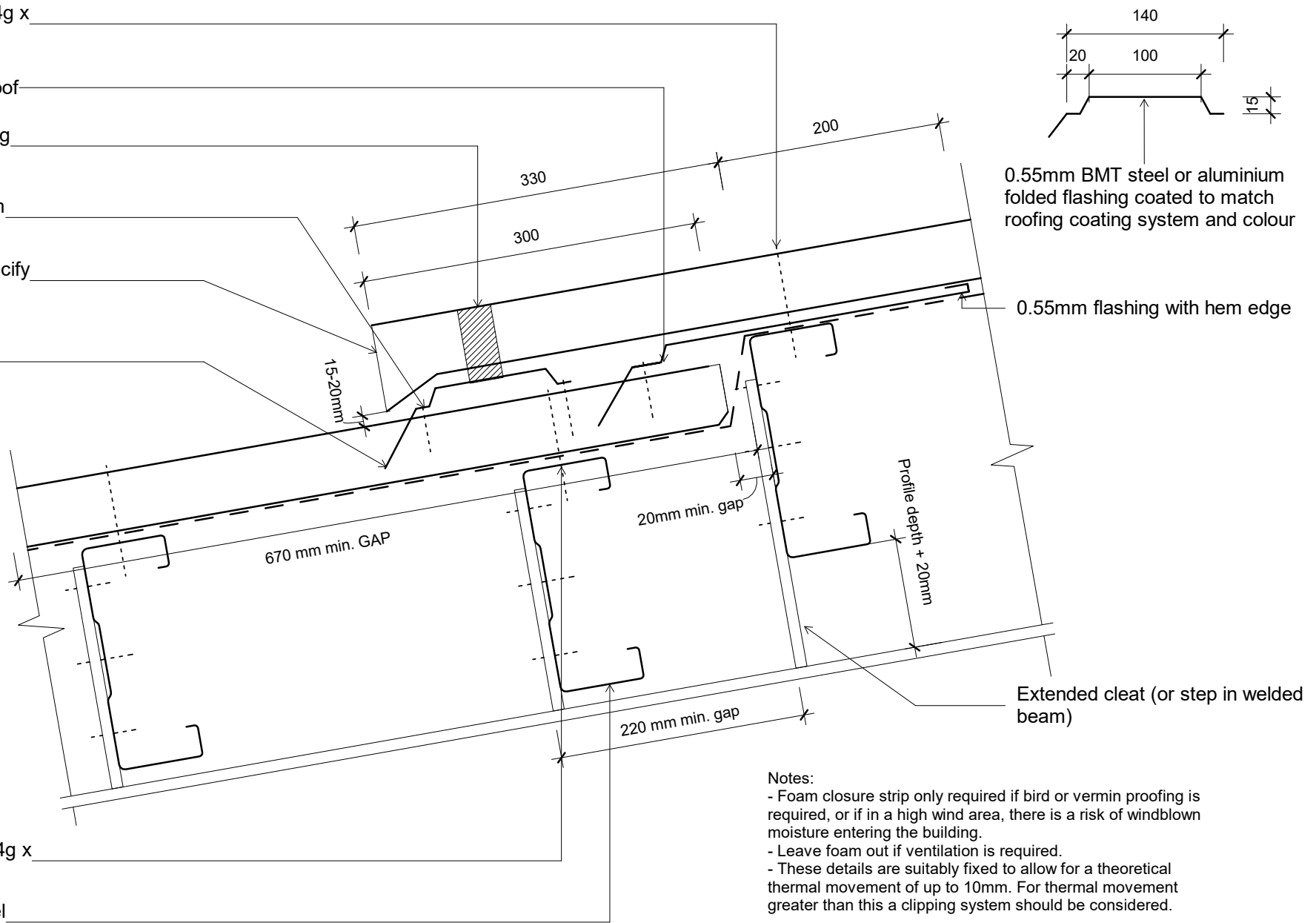

Notes:

- Foam closure strip only required if bird or vermin proofing is required, or if in a high wind area, there is a risk of windblown moisture entering the building.
- Leave foam out if ventilation is required.
- These details are suitably fixed to allow for a theoretical thermal movement of up to 10mm. For thermal movement greater than this a clipping system should be considered.

Original Size A4



**Topspan**  
Roof  
Step in Roofing

dim_tps_1070 Step in Roofing	
Issue: 01	Reference
Scale: 1 : 5	
Date: 20 December 2018	
<b>dim_tps_1070</b>	