

Notched flashing fixed with 12g x 25mm type 17 or 4.8mmØ aluminium rivets every rib

Climaseal coated self drilling 14g x 95mm tek screw rib fixed

Dimond Topspan® roofing (specify thickness and coating)

Roofing underlay and netting shown dashed

DHS girt

Line of structure

Notes:

- Foam closure strip only required if bird or vermin proofing is required, or if in a high wind area, there is a risk of windblown moisture entering the building.
- Leave foam out if ventilation is required.
- These details are suitably fixed to allow for a theoretical thermal movement of up to 10mm. For thermal movement greater than this a clipping system should be considered.

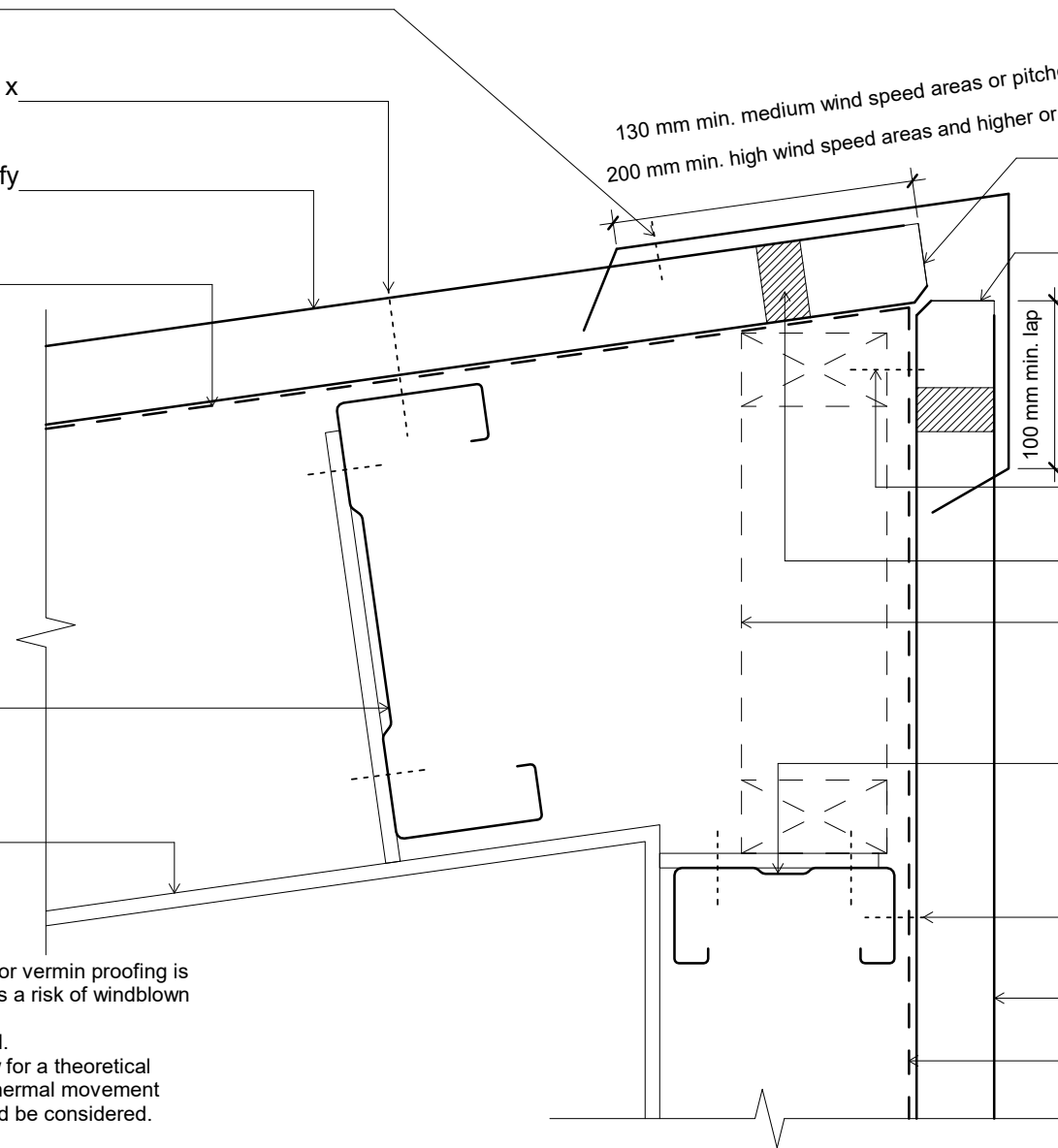

130 mm min. medium wind speed areas or pitches greater than 10°
 200 mm min. high wind speed areas and higher or pitches less than 10°

Dimond Topspan® roof cladding stop ended

Dimond Topspan® cladding stop ended

100 mm min. lap

Climaseal coated self drilling 12g x 25mm T17 screw pan fixed

Foam closure strip on top of roofing (see note below)

Framing shown dashed for clarity

Dimond hi-span steel wall girt

Climaseal coated self drilling 12g x 20mm tek screw pan fixed

Dimond Topspan® wall cladding (specify thickness and coating)

Building wrap shown dashed

Original Size A4



Topspan
Roof
 Roof - Wall Apex

dim_tps_1060 Roof - Wall Apex	
Issue: 01	Reference dim_tps_1060
Scale: 1 : 5	
Date: 20 December 2018	