

Notched flashing fixed with 12g x 25mm type 17 or 4.8mmØ aluminium rivets at 1000mm centers

Climaseal coated self drilling 12g x 65mm tek screw

Dimond Six Rib (specify thickness and coating)

Roofing underlay and netting shown dashed

DHS girt

Line of structure

Notes:

- Foam closure strip only required if bird or vermin proofing is required, or if in a high wind area, there is a risk of windblown moisture entering the building.
- Leave foam out if ventilation is required.
- These details are suitably fixed to allow for a theoretical thermal movement of up to 10mm. For thermal movement greater than this a clipping system should be considered.
- Where CCA or ACQ treated cavity battens are installed a barrier between the batten and the cladding is required.

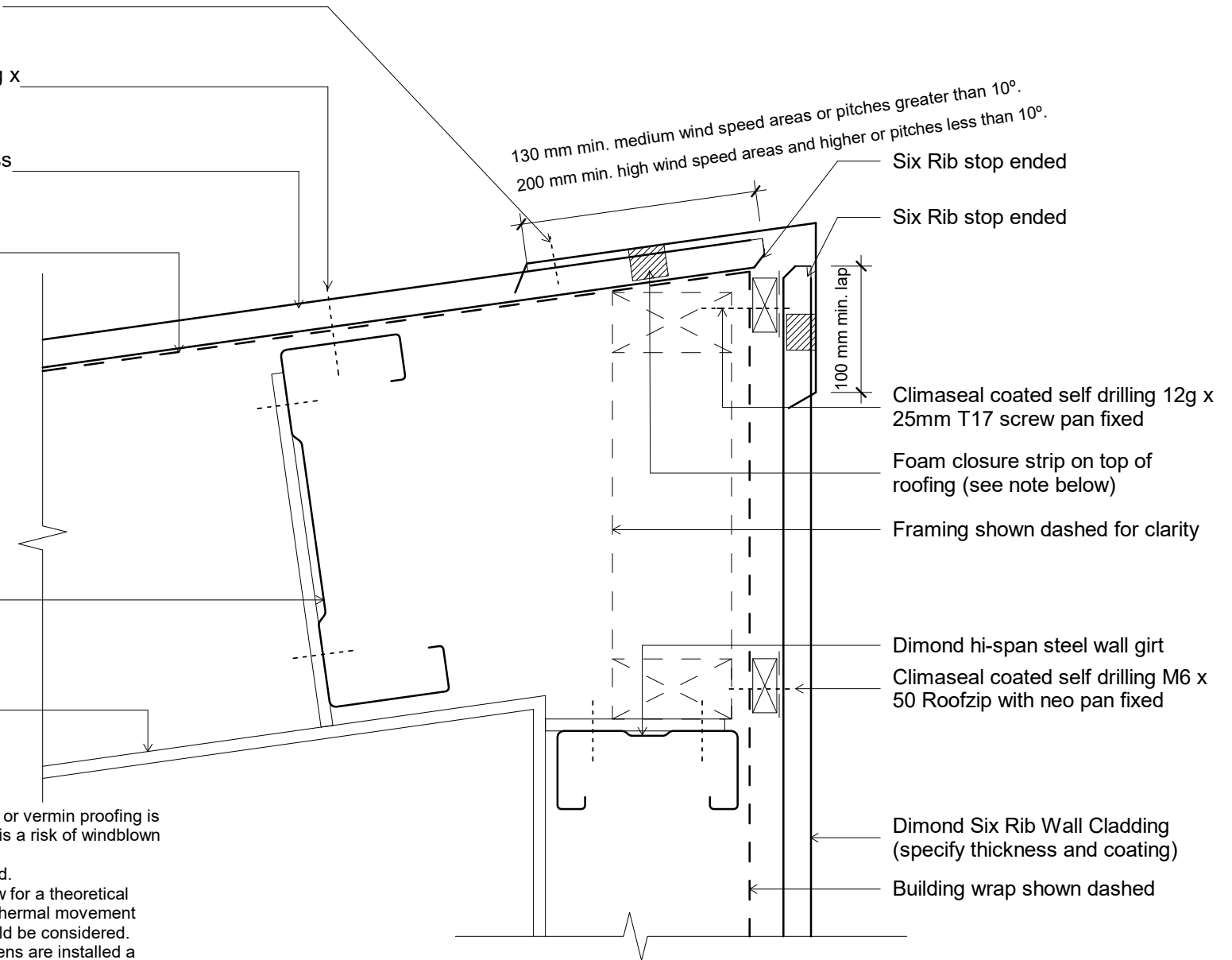

130 mm min. medium wind speed areas or pitches greater than 10°.
200 mm min. high wind speed areas and higher or pitches less than 10°.

Six Rib stop ended

Six Rib stop ended

100 mm min. lap

Climaseal coated self drilling 12g x 25mm T17 screw pan fixed

Foam closure strip on top of roofing (see note below)

Framing shown dashed for clarity

Dimond hi-span steel wall girt

Climaseal coated self drilling M6 x 50 Roofzip with neo pan fixed

Dimond Six Rib Wall Cladding (specify thickness and coating)

Building wrap shown dashed

Original Size A4



Six Rib Roof

Roof - Wall Apex

dim_sxr_1060 Roof - Wall Apex	
Issue: 01	Reference dim_sxr_1060
Scale: 1 : 5	
Date: 20 December 2018	