

Climaseal coated self drilling M6 x 50 Roofzip rib fixed

Additional flashing for high wind exposure notched over lower roof profile

Foam closure strip under roofing (see note below)

Fix with self drilling M6 x 25 Roofzip for high wind exposure

Dimond Styleline roofing (specify thickness and coating)

Potential dirt build-up

Dimond hi-span cold rolled steel purlin (specify size)

Plot Date: 22 Nov 2018

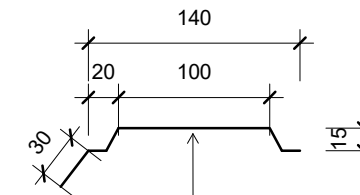

0.55mm BMT steel or aluminium folded flashing coated to match roofing coating system and colour

0.55mm flashing with hem edge

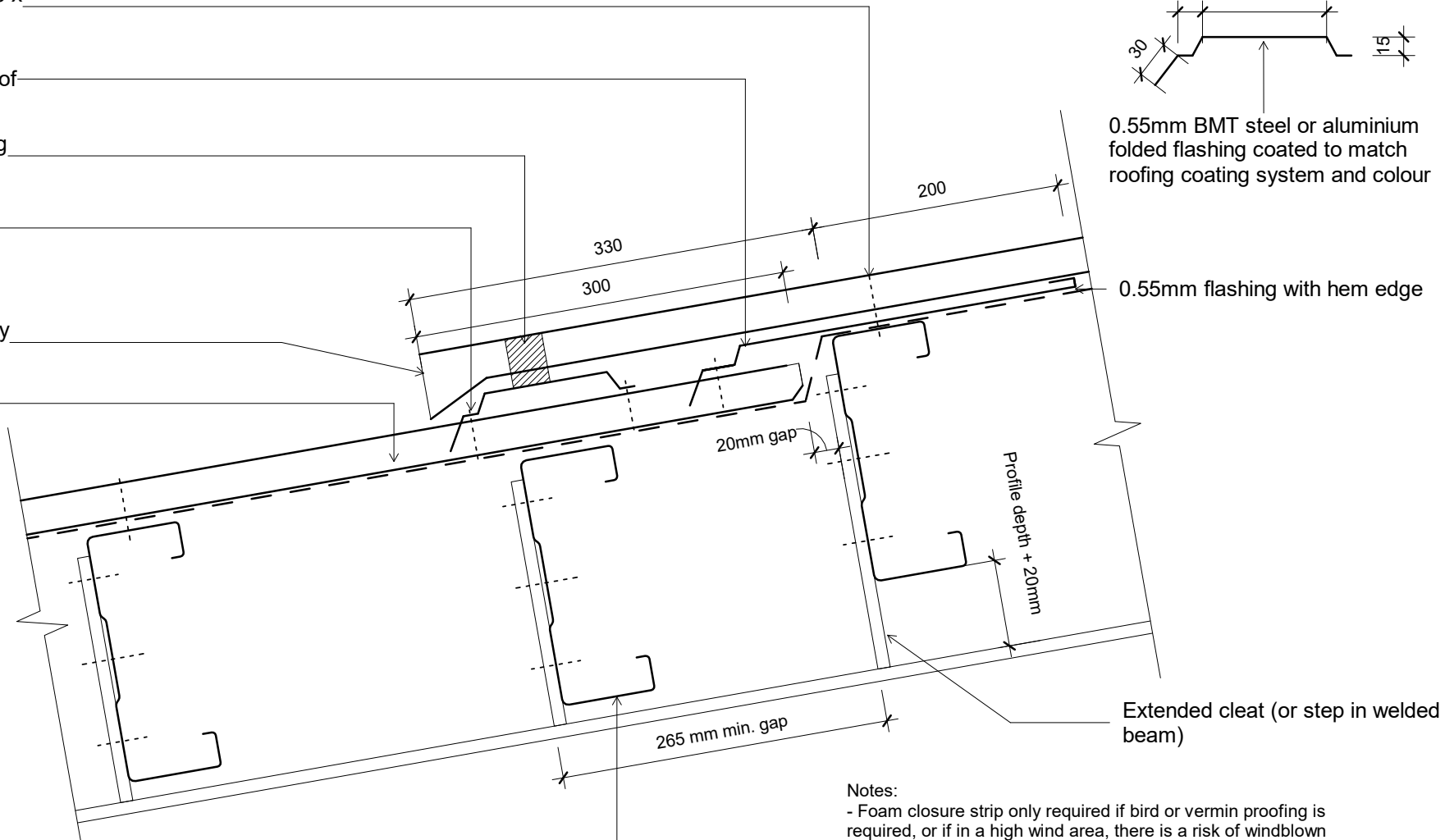

- Notes:
- Foam closure strip only required if bird or vermin proofing is required, or if in a high wind area, there is a risk of windblown moisture entering the building.
 - Leave foam out if ventilation is required.
 - These details are suitably fixed to allow for a theoretical thermal movement of up to 10mm. For thermal movement greater than this a clipping system should be considered.

Original Size A4



Styleline Roof

Step in Roofing

File:	
Issue:	draft
Scale:	1 : 5
Date:	14 November 2018
Reference	dim_snv_1070