

- 20mm thick cavity battens
- Dimond LT5 wall cladding (specify thickness and coating)
- Climaseal coated self drilling M6 x 65 Roofzip
- Continuous cavity drainage closure strip
- Climaseal coated self drilling 14g x 75mm T17 screw every purlin
- Apron flashing fixed to cladding with 4.8Ø aluminium rivets at 1000mm centers between purlins
- Roofing underlay and netting shown dashed
- Dimond LT5 roof cladding (specify thickness and coating)
- Purpose made apron flashing
- Purlin

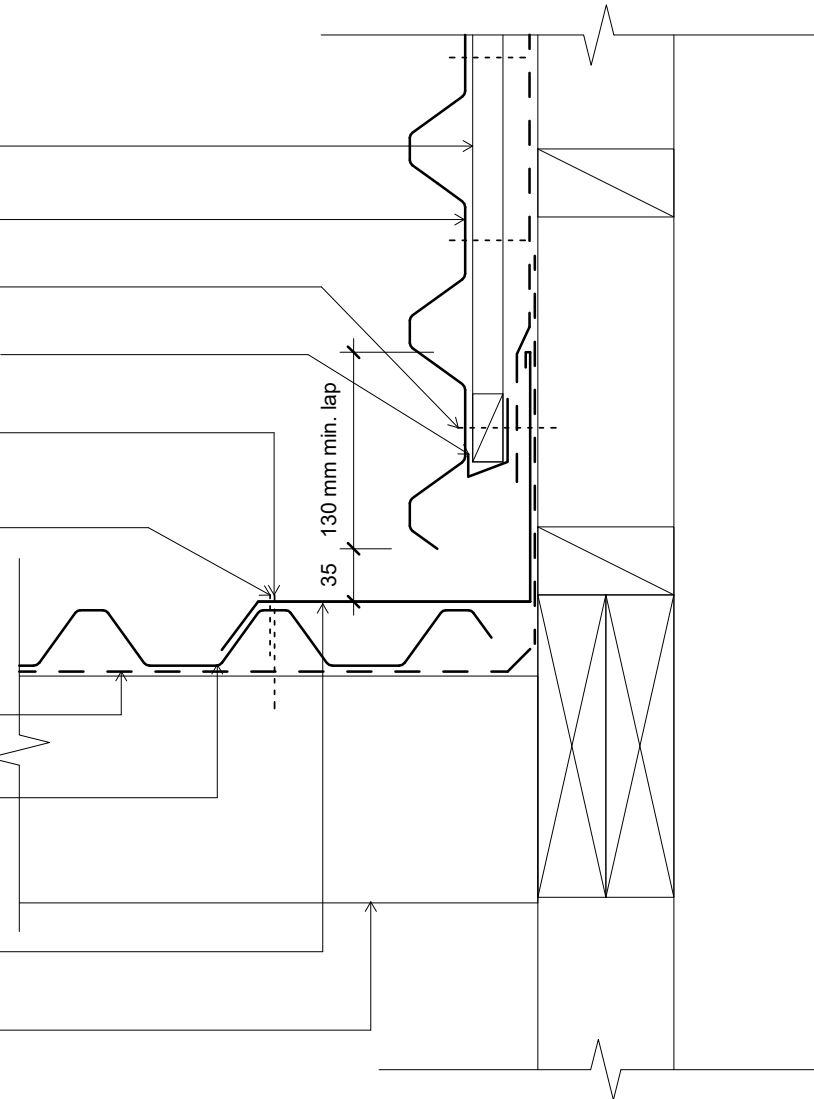

- Notes:
- These details are suitably fixed to allow for a theoretical thermal movement of up to 10mm. For thermal movement greater than this a clipping system should be considered.
  - Leave foam out if ventilation is required.

Original Size A4



## LT5 Wall

Horizontal Cavity Cladding - Roof Junction (90 deg)

dim_lt5_2170 Horizontal Cavity Cladding - Roof Junction (90 deg)	
Issue: 01	Reference  <b>dim_lt5_2170</b>
Scale: 1 : 5	
Date: 20 December 2018	