

Dimond Hi Five roofing (specify thickness and coating)

Climaseal coated self drilling M6 x 65 Roofzip at every stud

Notched flashing folded and fixed to ribs with tek screw at every rib

Roofing underlay and netting shown dashed

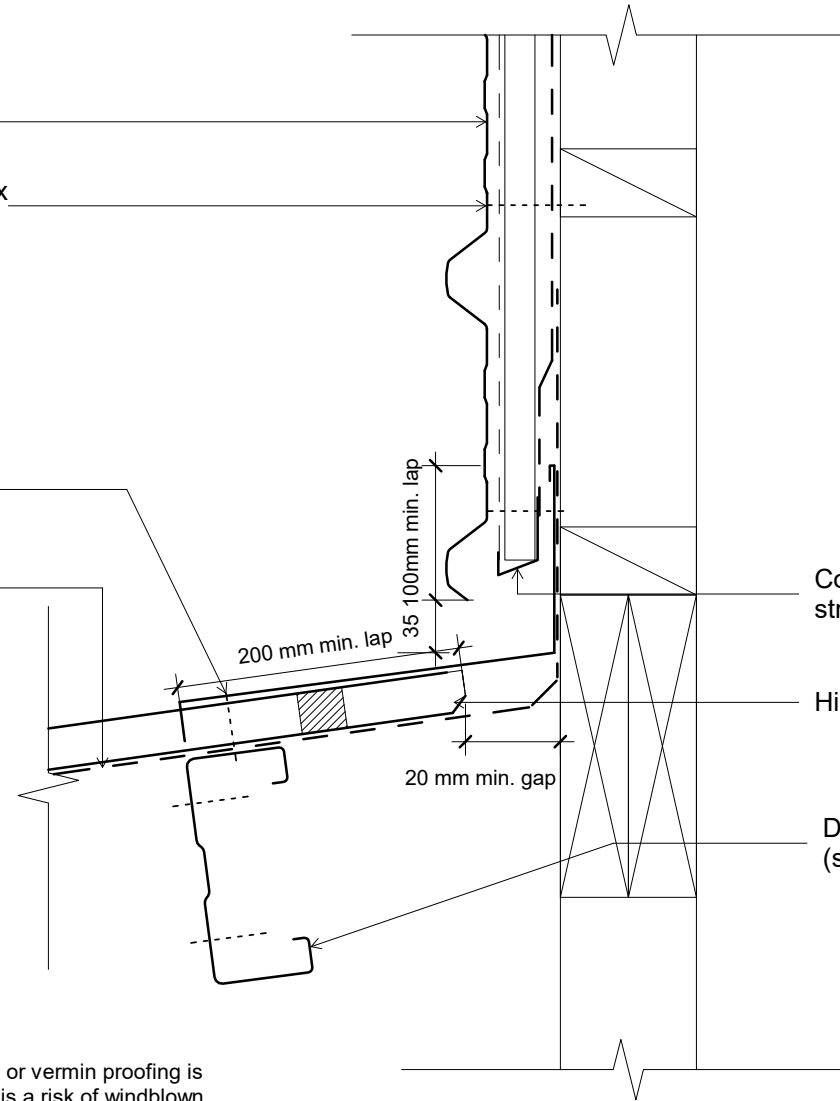

Continuous cavity drainage closure strip

Hi Five stop ended

Dimond hi-span steel purlin (specify size)

Notes:

- Foam closure strip only required if bird or vermin proofing is required, or if in a high wind area, there is a risk of windblown moisture entering the building.
- Leave foam out if ventilation is required.
- These details are suitably fixed to allow for a theoretical thermal movement of up to 10mm. For thermal movement greater than this a clipping system should be considered.
- Where CCA or ACQ treated cavity battens are installed a barrier between the batten and the cladding is required.

Original Size A4



# Hi Five Wall

Horizontal Cavity Cladding - Wall/Roof Junction

dim_hif_2180 Horizontal Cavity Cladding - Wall/Roof Junction	
Issue: 01	Reference  <b>dim_hif_2180</b>
Scale: 1 : 5	
Date: 20 December 2018	