

Dimond Eurotray® Roll Seam cladding to roof (thickness & coating to be specified)

H3 CD Plywood substrate

Ventilation holes through plywood substrate.
30 dia holes @ 300 centres continuous

Vented roof underlay

Building underlay separation barrier

Gutter bracket

Box 125

Eave flashing (thickness & coating to be specified)

Fascia lining

Soffit lining

Apron flashing (thickness & coating to be specified)

Eurotray clip fixed with Type 17 12g x 65mm Screw

Vented wall underlay

H3 CD Plywood substrate or RAB board

Dimond Eurotray® Roll Seam cladding to wall (thickness & coating to be specified)

Eurotray clip fixed with Type 17 12g x 65mm Screw

Vented cavity battens

General Notes:

1. Indicative structure shown for purposes of illustration only.
2. Confirmation of thickness & coating to cladding/flashings required.
3. Refer to installation information for fixing requirements.
4. Eave flashing required for all roofs under 10° pitch and where fascia is 100mm or less from cladding.

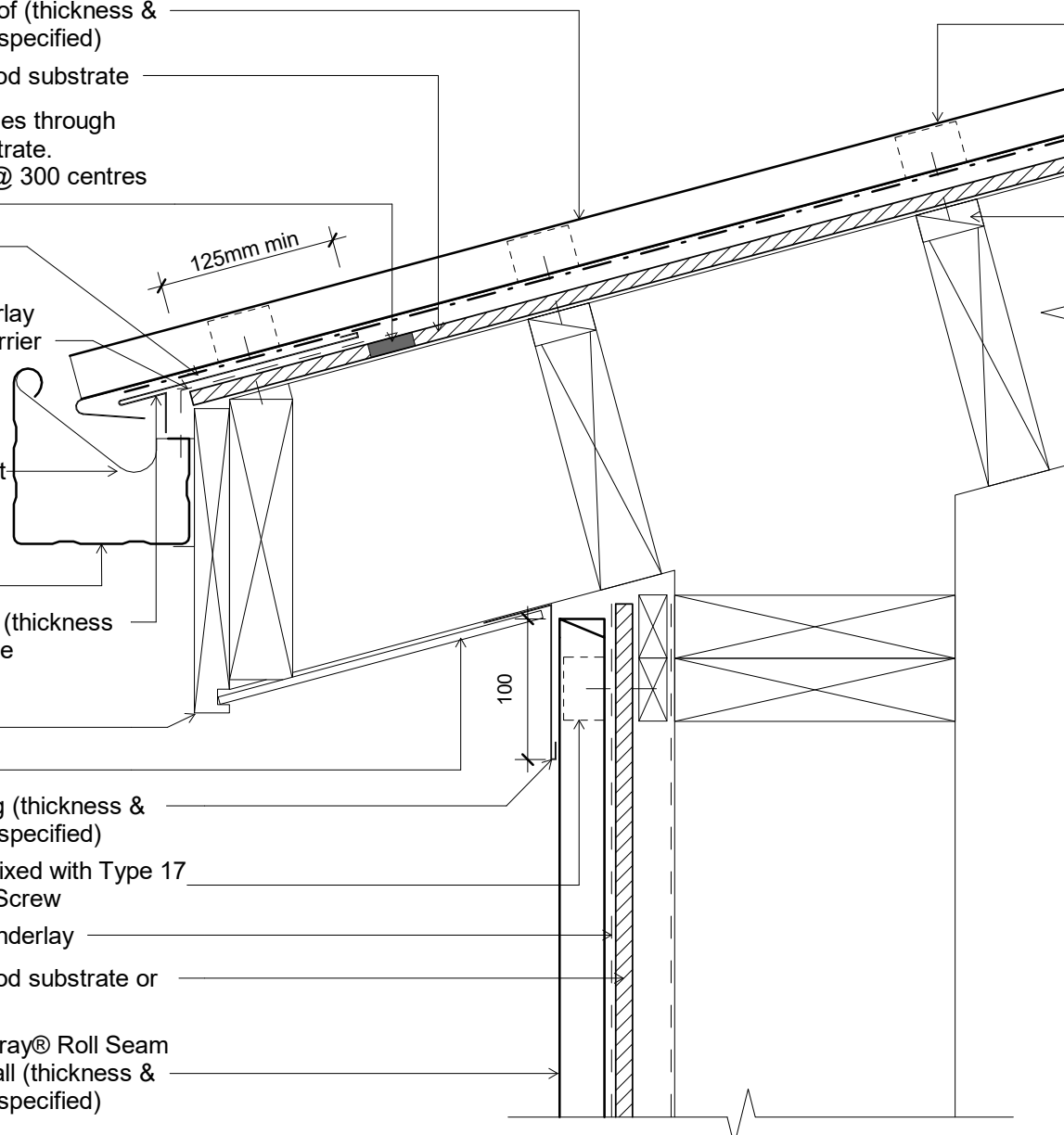

Original Size A4



Eurotray® Roll Seam Roof

Residential Gutter/Wall Detail with Soffit

dim_ets_4130 Residential Gutter/Wall Detail with Soffit	
Issue: 01	Reference dim_ets_4130
Scale: 1 : 5	
Date: 5 February 2019	