

Eurotray clip fixed with Type 17
12g x 65mm Screw

Dimond Eurotray® Roll Cap
cladding to roof (thickness &
coating to be specified)

H3 CD Plywood substrate

20mm vented cavity battens

Leave a 10mm gap in plywood,
vented roof underlay and flashing
to allow ventilation exit

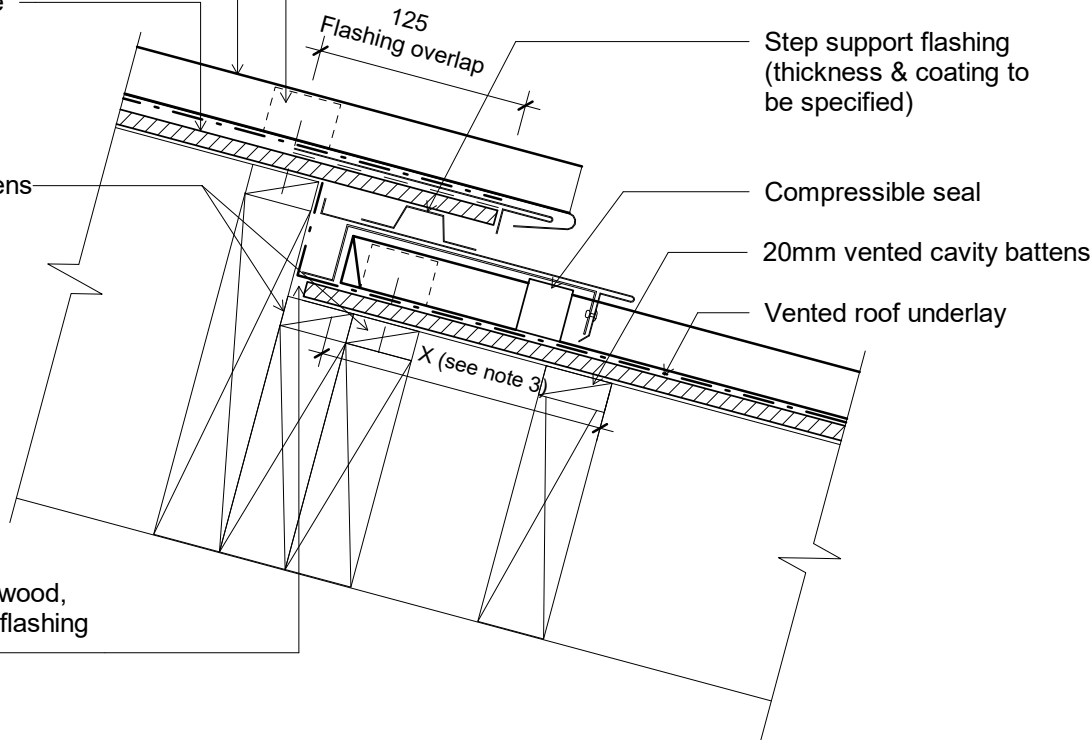

Step support flashing
(thickness & coating to
be specified)

Compressible seal

20mm vented cavity battens

Vented roof underlay

X (see note 3)

General Notes:

1. Indicative structure shown for purposes of illustration only.
2. Confirmation of thickness & coating to cladding/flashings required.
3. For "X" 130mm min. medium wind speed areas or pitches greater than 10 degrees, 200mm min. high wind speed areas and higher or pitches less than 10 degrees.
4. Refer to installation information for fixing requirements.
5. Compressible seal to be installed when roof pitch is equal or less than 10° degrees.

Original Size A4



Eurotray® Roll Cap
Wall
Step in Roofing

dim_etc_1070 Step in Roofing	
Issue: 01	Reference dim_etc_1070
Scale: 1 : 5	
Date: 5 February 2019	