

Notched flashing fixed with
4.8mmø aluminium rivets every rib

Climaseal coated self drilling 14g x
75mm tek screw at every rib

Dimond DP955® roof cladding
(specify thickness and coating)

Roofing underlay and netting
shown dashed

DHS girt

Line of structure

Notes:

- Foam closure strip only required if bird or vermin proofing is required, or if in a high wind area, there is a risk of windblown moisture entering the building.
- Leave foam out if ventilation is required.
- These details are suitably fixed to allow for a theoretical thermal movement of up to 10mm. For thermal movement greater than this a clipping system should be considered.

130 mm min. medium wind speed areas or pitches greater than 10°.
200mm min. high wind speed areas and higher or pitches less than 10°.

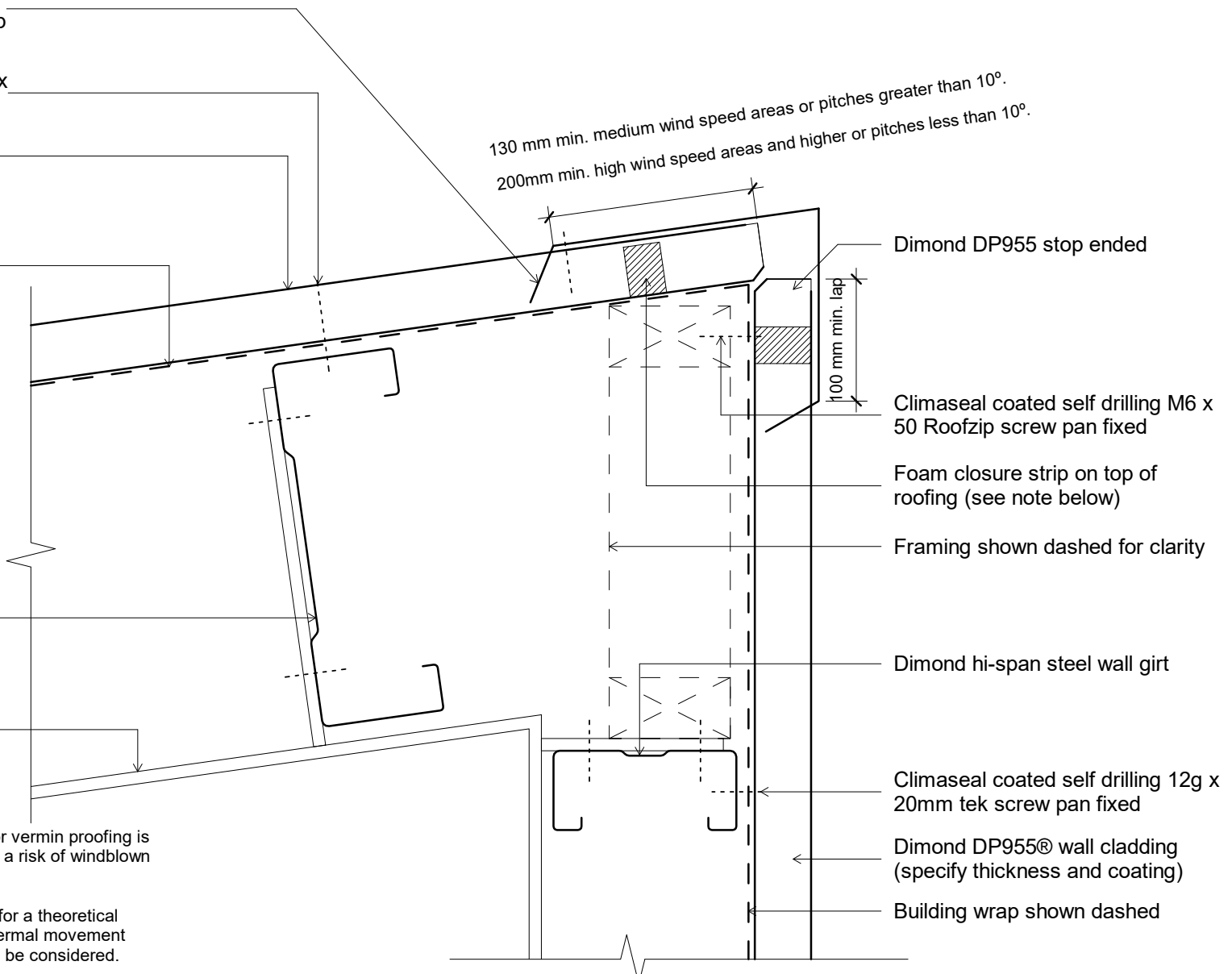

Dimond DP955 stop ended

Climaseal coated self drilling M6 x
50 Roofzip screw pan fixed

Foam closure strip on top of
roofing (see note below)

Framing shown dashed for clarity

Dimond hi-span steel wall girt

Climaseal coated self drilling 12g x
20mm tek screw pan fixed

Dimond DP955® wall cladding
(specify thickness and coating)

Building wrap shown dashed

Original Size A4



DP955
Roof

Roof - Wall Apex

File:	
Issue: 01	Reference
Scale: 1 : 5	dim_dp9_1060
Date: 28 November 2018	