

Continuous clip fixed with M6 x 25 Roofzip

Additional flashing for high wind exposure notched over lower roof profile

Foam closure strip under roofing (see note below)

Climaseal coated self drilling 12g x 35mm tek screw with washers and seals @ every rib on sheet ends

Dimondek® 630 roofing (specify thickness and coating)

Potential dirt build-up

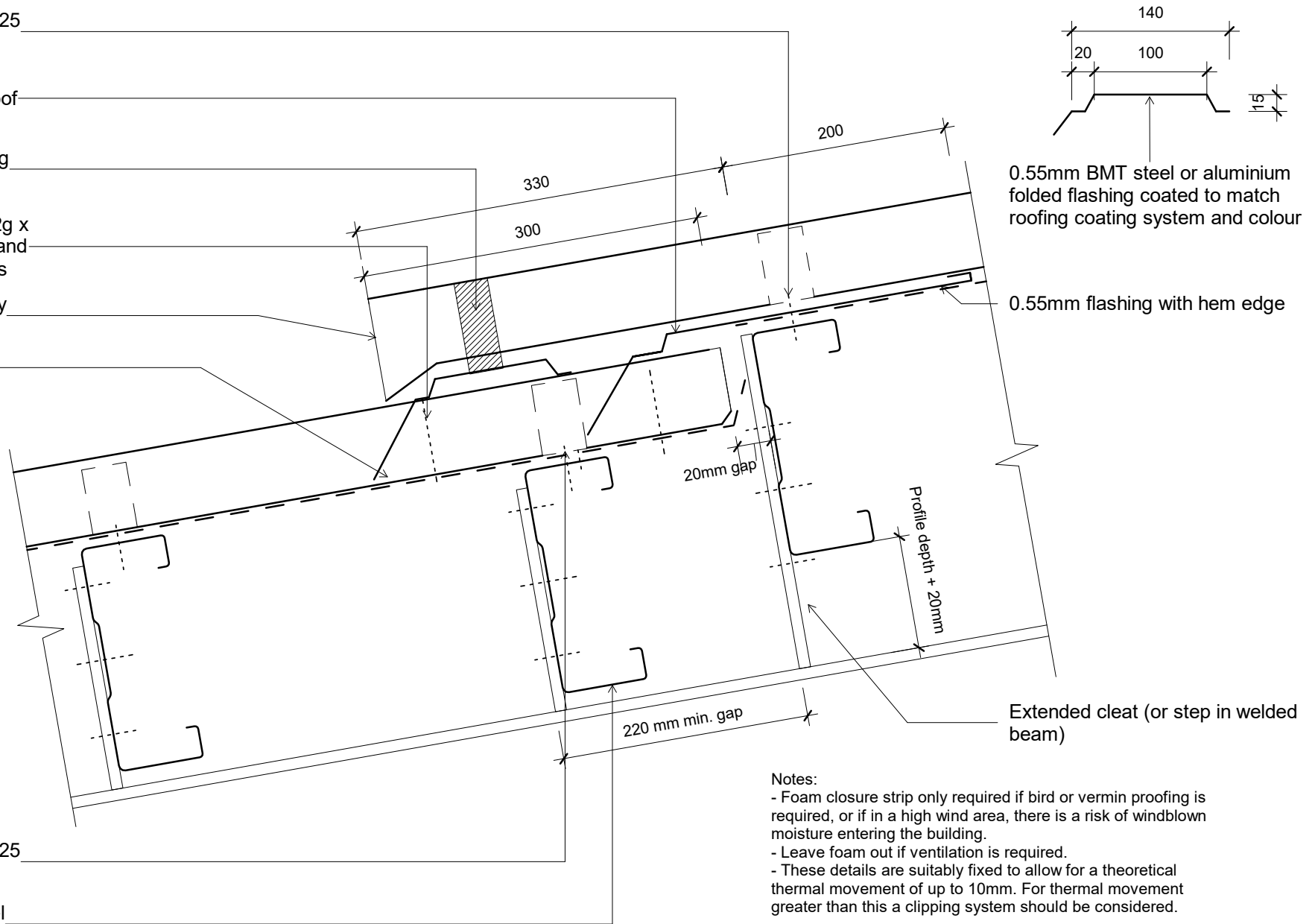

Continuous clip fixed with M6 x 25 Roofzip

Dimond hi-span cold rolled steel purlin (specify size)

- Notes:
- Foam closure strip only required if bird or vermin proofing is required, or if in a high wind area, there is a risk of windblown moisture entering the building.
 - Leave foam out if ventilation is required.
 - These details are suitably fixed to allow for a theoretical thermal movement of up to 10mm. For thermal movement greater than this a clipping system should be considered.

Original Size A4



Dimondek 630

Roof

Step in Roofing

File:	dim_dd6_1070 Step in Roofing	
Issue:	01	Reference
Scale:	1 : 5	
Date:	28 November 2018	
		dim_dd6_1070