

H3.1 timber capping support ex
50mm on dpc

Climaseal screw fixed @ 600 c/c
max. M6 x 25mm roofzip

Fix capping to concrete with
6.5mm x 20mm metal pin anchors
@ 1000mm centers
Notched flashing fixed to ribs with
4.8Ø aluminium rivets fixed every
2nd rib

Roofing underlay and netting
shown dashed
Dimondek® 400 roofing (specify
thickness and coating)

Dimondek 400 clip fixed with 10g x
16mm wafer head tek screw

Dimond hi-span steel purlin
(specify size)

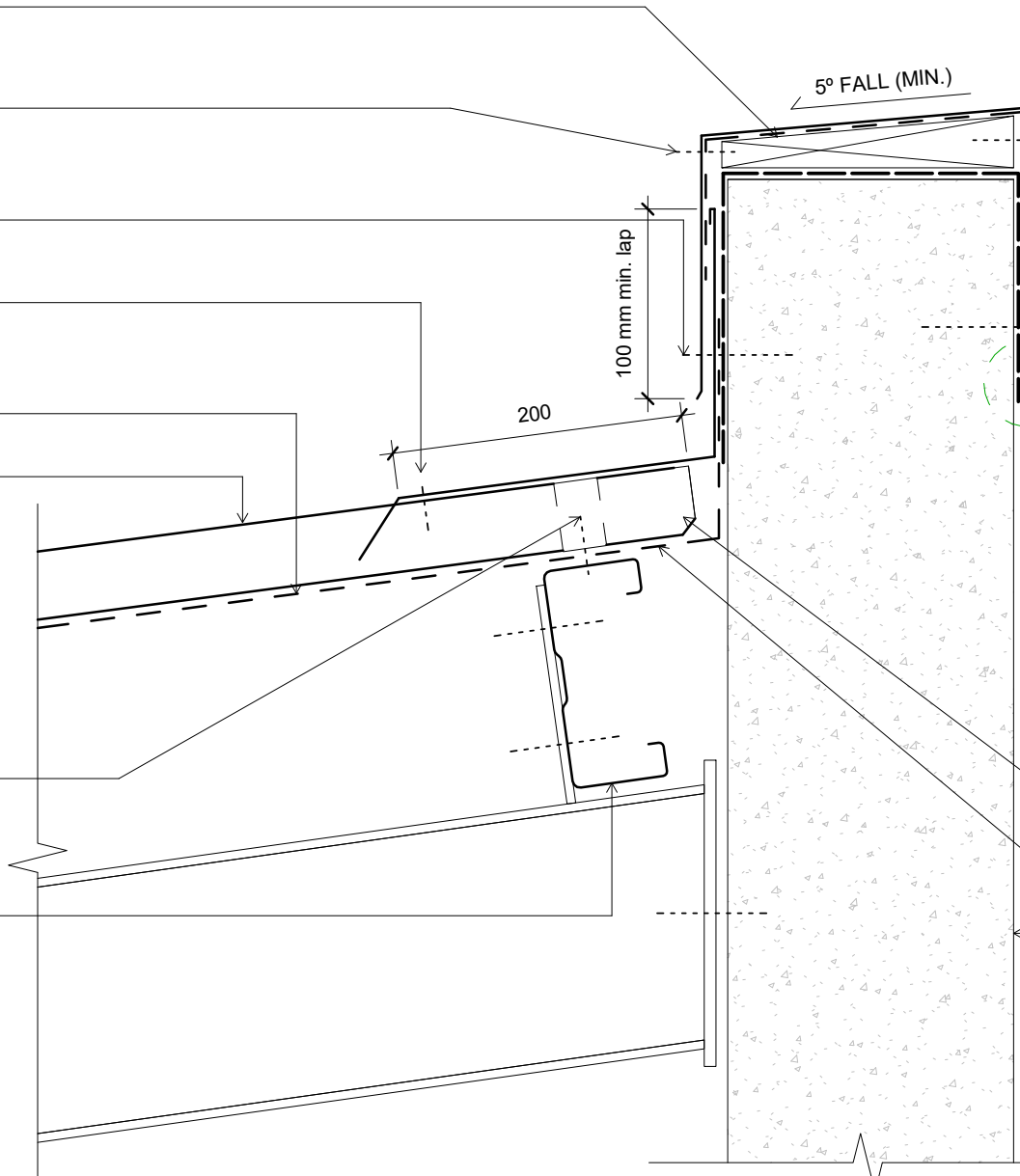

0.55mm parapet flashing (specify
coating)

Climaseal screw fixed @ 600 c/c
max. M6 x 25mm roofzip

Separation barrier with self
adhesive tape or similar around
concrete wall

Fix capping to concrete with
6.5mm x 20mm metal pin anchors
@ 1000mm centers

Cut edge must avoid contact with
concrete. Avoid overpainting
flashing to concrete joint.

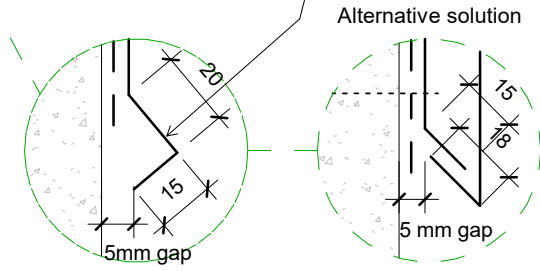

Dimondek 400 stop ended

Roofing underlay and netting
shown dashed

Concrete wall

Notes:
- Foam closure strip only required if bird or vermin proofing is
required, or if in a high wind area, there is a risk of windblown
moisture entering the building.
- These details are suitably fixed to allow for a theoretical
thermal movement of up to 10mm. For thermal movement
greater than this a clipping system should be considered.

Original Size A4



Dimondek 400
Roof
Parapet Detail

File:	
Issue: 01	Reference
Scale: As indicated	
Date: 28 November 2018	dim_dd4_1010