

Dimond roofing (specify profile, thickness and coating) fixed to Dimond roof rail with 12g hex head tek screw (Length to suit profile)

Cavibat cavity closure stuck down using 25mm wide Nuralite double sided tape in 20mm long strips at 500 centres

Membrane fully bonded down onto flashing

Membrane gutter to Nuralite specification

Nuraply 3PM two layer system

Nuralite 20mm Bitumen Fillet

Nuraply ALU vapour barrier

H3 Plywood support H3.2 CCA treated. CD grade with the sanded face up

Flashing and fire stop to Fire Engineer's design to meet fire engineering requirements.

Enertherm ALU Rigid Insulation around gutter fixed with IKOfix washer/fastener system to Nuralite specification

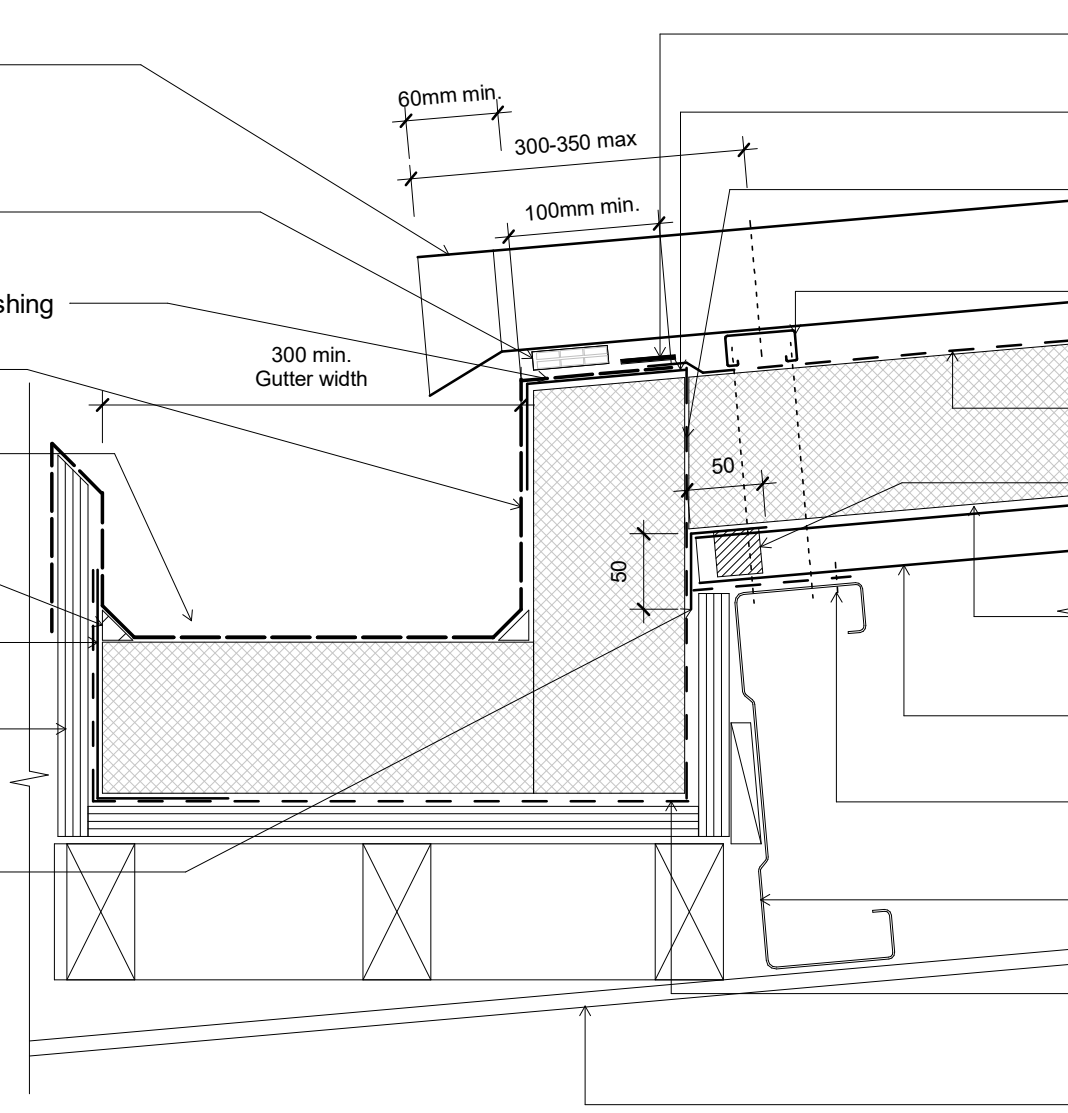

Seal Solitex Mento 1000 to flashing with Pro Clima Duplex

0.55mm folded flashing to edge of PIR

Nuraply ALU vapour barrier

Dimond Galvanised Roof Rail laid and fixed over every purlin

Solitex Mento 1000 connect underlay laid vertically over PIR

Narrow tipped foam on top of NPM 900

Enertherm ALU Rigid Insulation. Depth as specified

NPM 900 x 0.55mm metal tray fixed with 12g x 20 tek screw every pan (side laps stitch fastened at 600mm centres)
12g x 20mm tek screw pan fixed every pan

Dimond Hi-Span steel purlin (specify size) , For timber purlins use minimum 70mm wide purlins

Nuraply ALU vapour barrier

Line of Structure

Original Size A4