

BROWNBUILT 900

COMMERCIAL HORIZONTAL WALL CLADDING

DETAILS:

REV:

DATE:

BBCHC00	Cover Sheet	1	Oct 2025
BBCHC01	Profile Summary	1	Oct 2025
BBCHC02	Typical Flashing Detail	1	Oct 2025
BBCHC03	Barge Detail	1	Oct 2025
BBCHC04	Wall to Roof Transverse Detail	1	Oct 2025
BBCHC05	Wall to Roof Detail	1	Oct 2025
BBCHC06	Box Gutter Detail	1	Oct 2025
BBCHC07	Wall to Roof Apex Detail	1	Oct 2025
BBCHC08	External Corner Detail	1	Oct 2025
BBCHC09	Internal Corner Detail	1	Oct 2025
BBCHC10	Base Detail	1	Oct 2025
BBCHC11	Window / Door Head Detail	1	Oct 2025
BBCHC12	Window / Door Jamb Detail	1	Oct 2025
BBCHC13	Window Sill Detail	1	Oct 2025

PROFILE OVERVIEW	
RIB TYPE	High
RIBS PER SHEET	7 Ribs per sheet
WIDTH	900mm Cover, 960mm Sheet

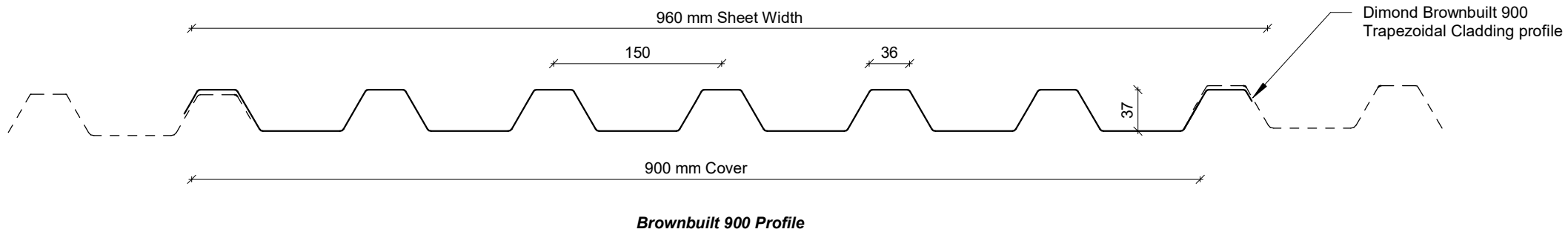

Profile Summary

Rev: 1 **Brownbuilt 900 Commercial Horizontal Cladding**

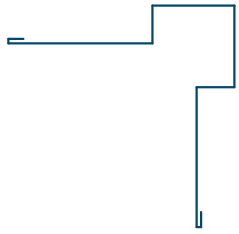

External Corner Flashing

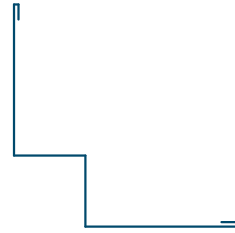

Internal Corner Flashing



Base Flashing



Window Sill Flashing



Window Head Flashing



Window Jamb Flashing



Eaves Flashing

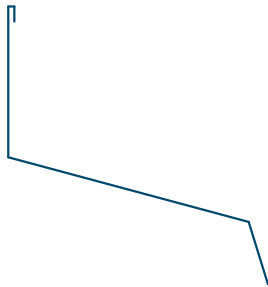

Wall to Roof Flashing 1



Wall to Roof Flashing 2

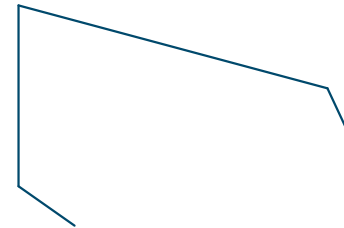

Wall Roof to Wall Apex Flashing

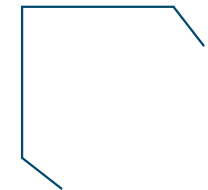

Barge Flashing

Typical Flashing Detail

Rev: 1Brownbuilt 900 Commercial Horizontal Cladding

Barge flashing to match roofing.
Materials & Fixings as per Dimond
Technical Data & MRM Code of Practice

Wall Underlay
(shown dashed)

Prefinished screw with
neoprene washer

Dimond Brownbuilt 900
Trapezoidal cladding

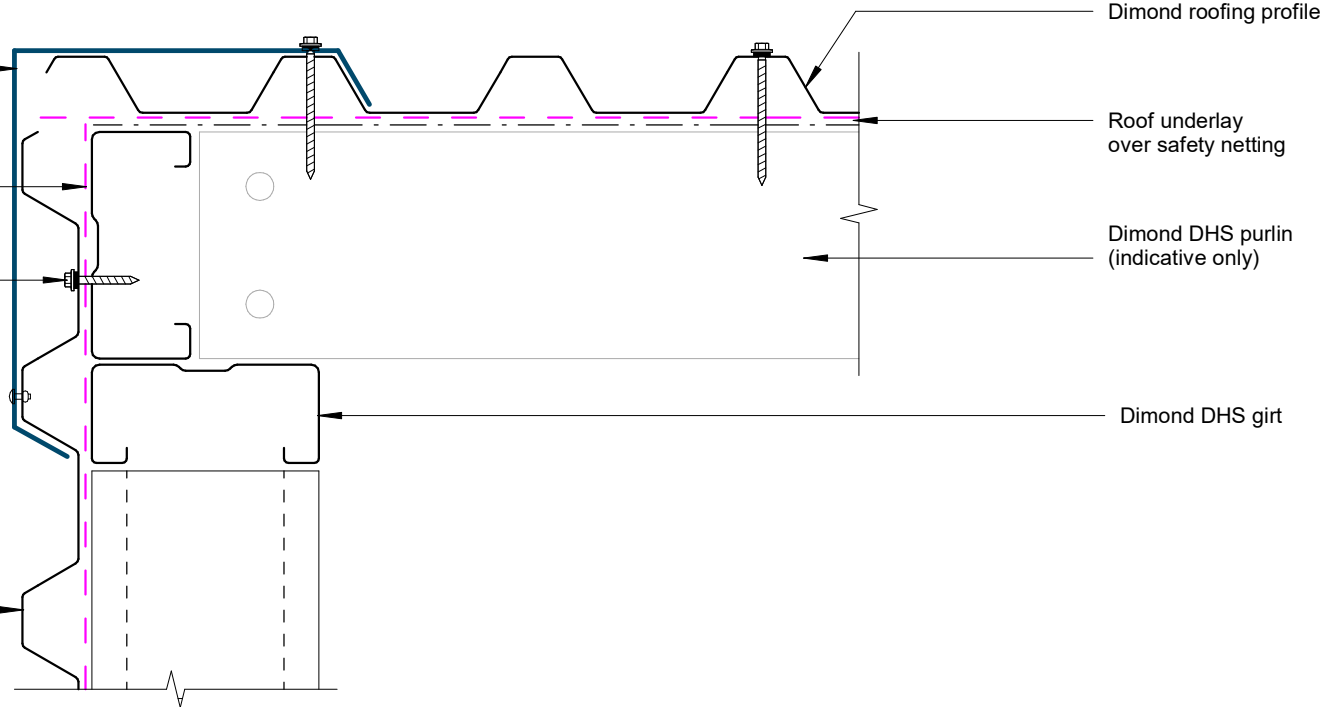

Dimond roofing profile

Roof underlay
over safety netting

Dimond DHS purlin
(indicative only)

Dimond DHS girt

Barge Detail

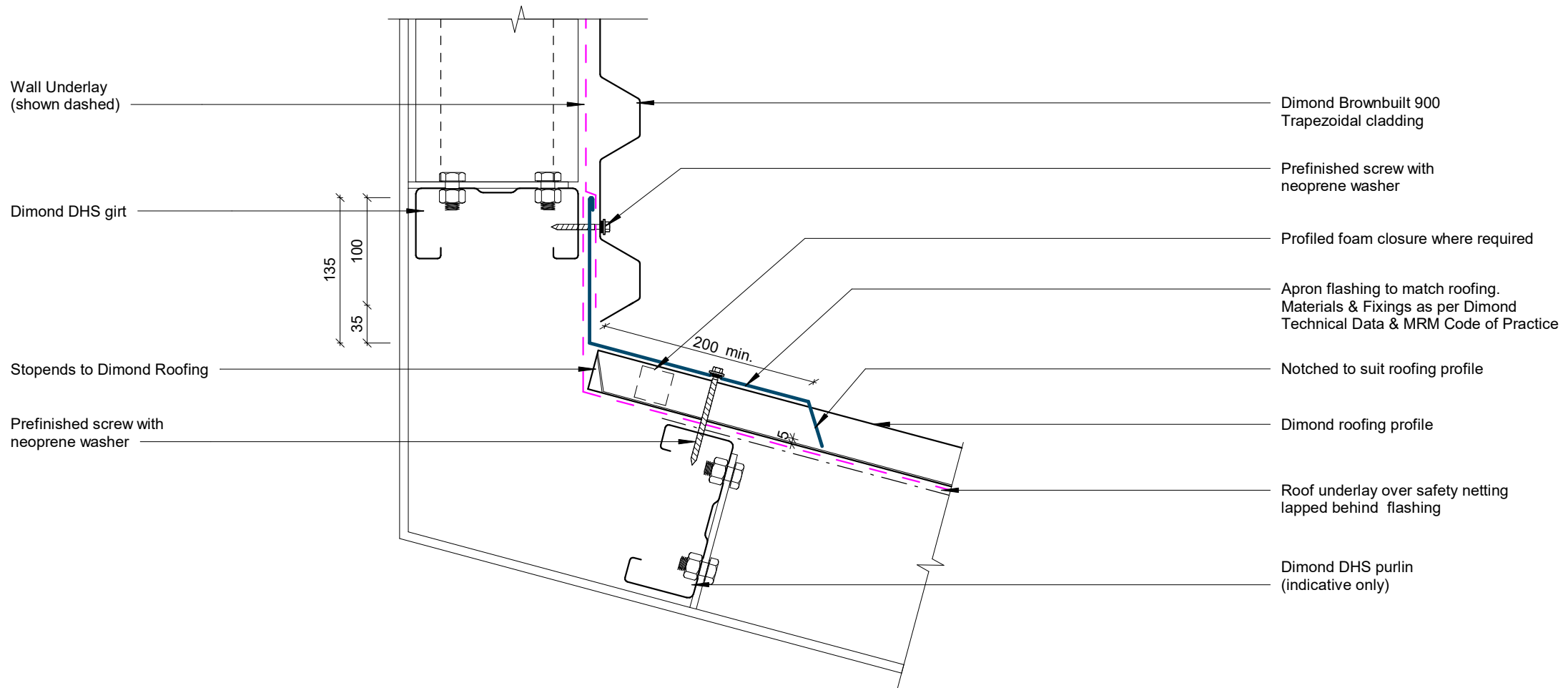

Wall to Roof Transverse Detail

Rev: 1 **Brownbuilt 900 Commercial Horizontal Cladding**

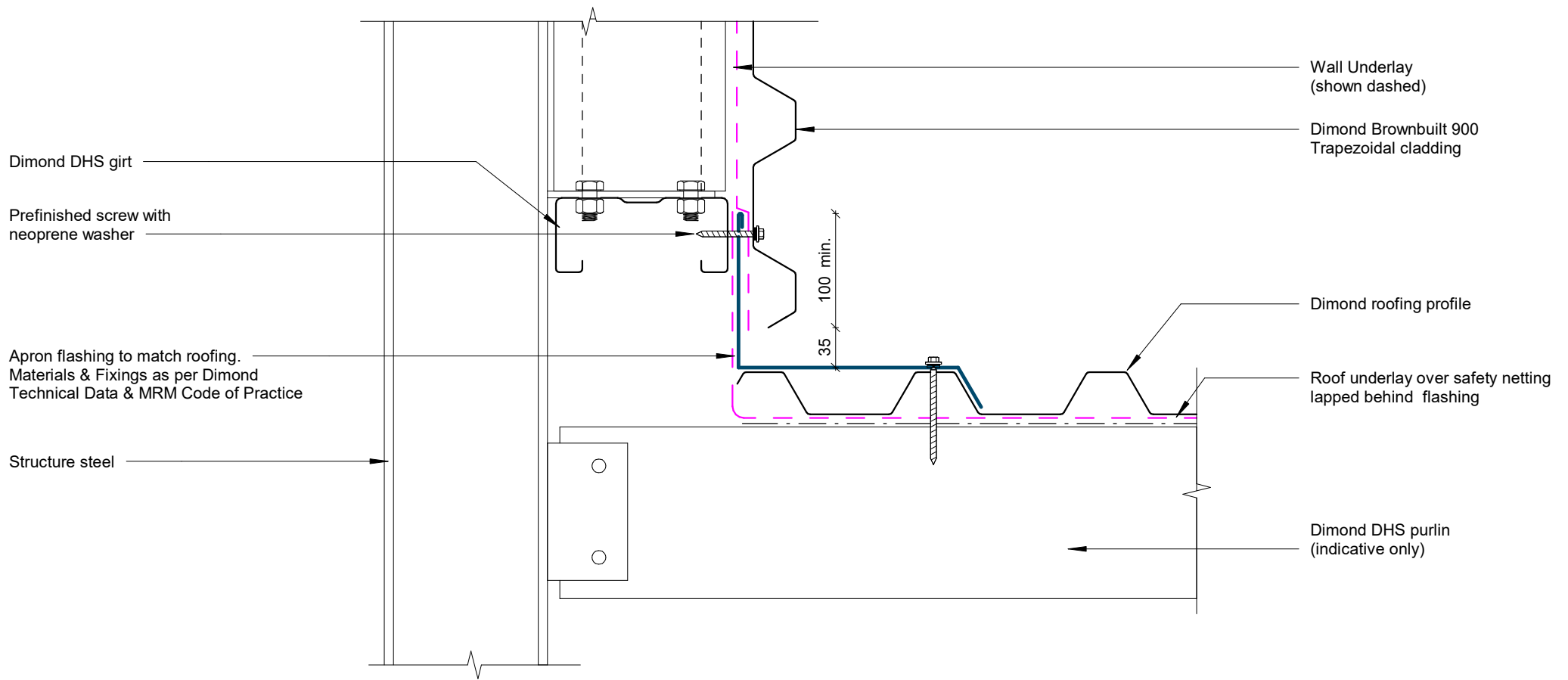

Wall to Roof Detail

Rev: 1 **Brownbuilt 900 Commercial Horizontal Cladding**

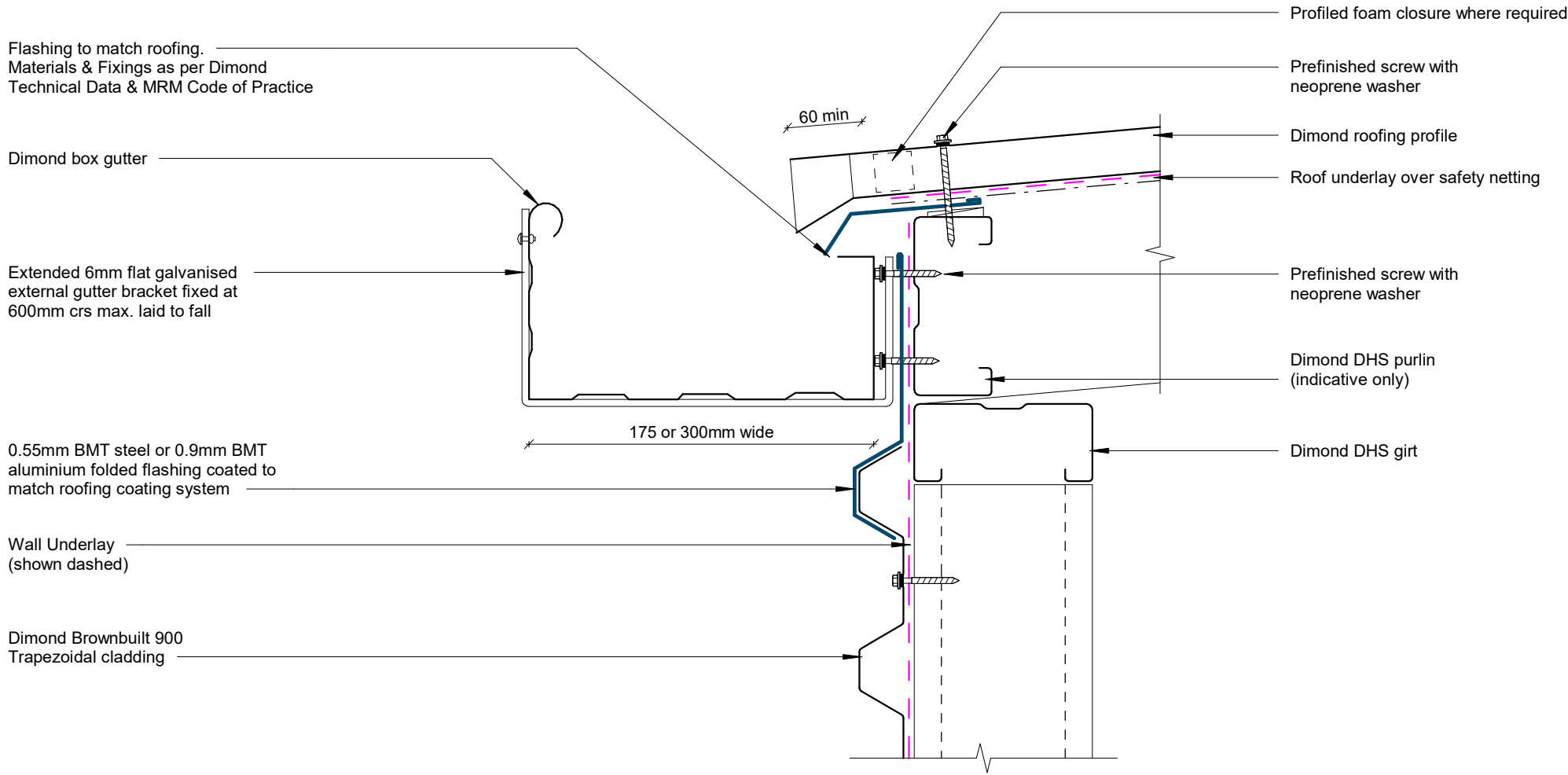

Box Gutter Detail

Rev: 1 **Brownbuilt 900 Commercial Horizontal Cladding**

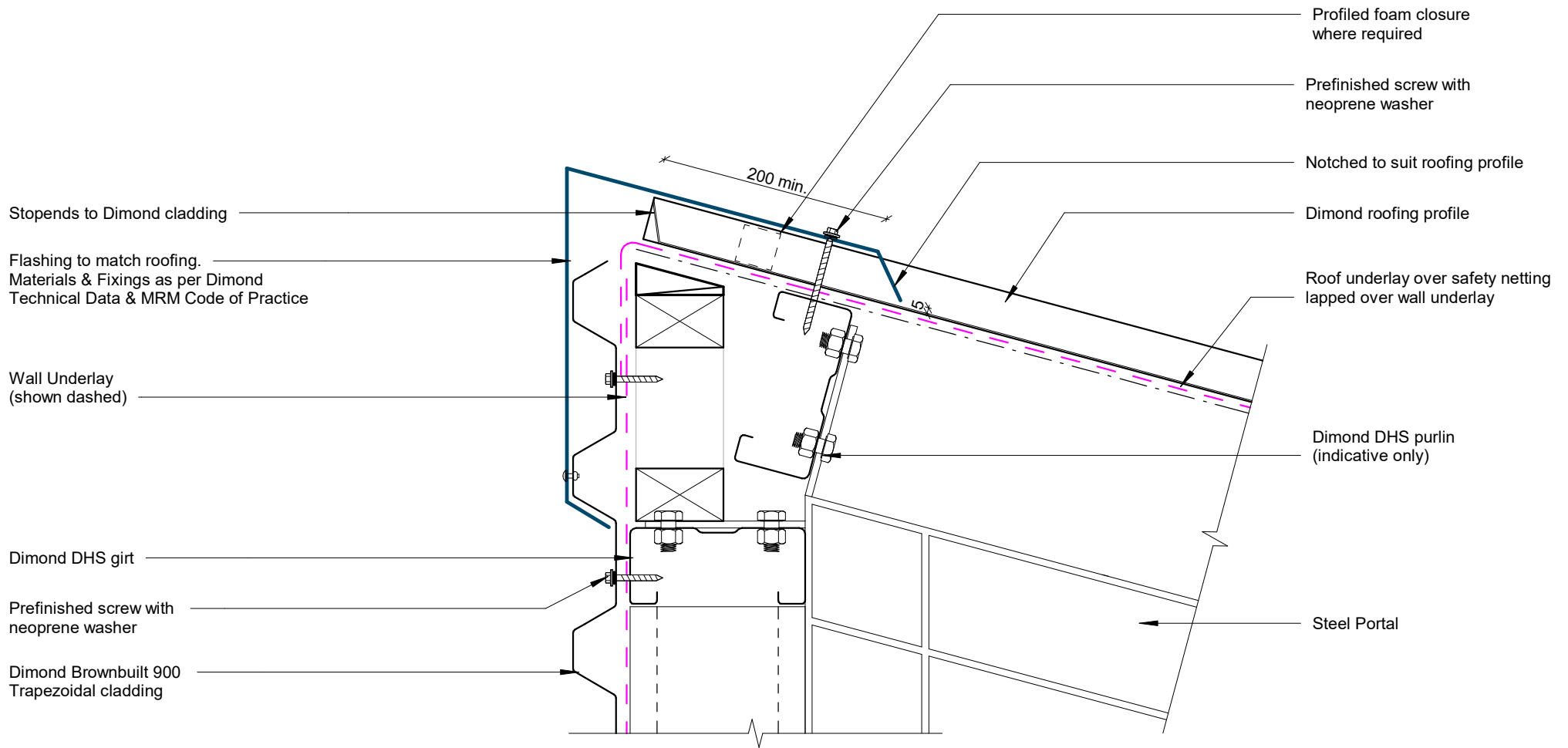

Wall to Roof Apex Detail

Rev: 1 **Brownbuilt 900 Commercial Horizontal Cladding**

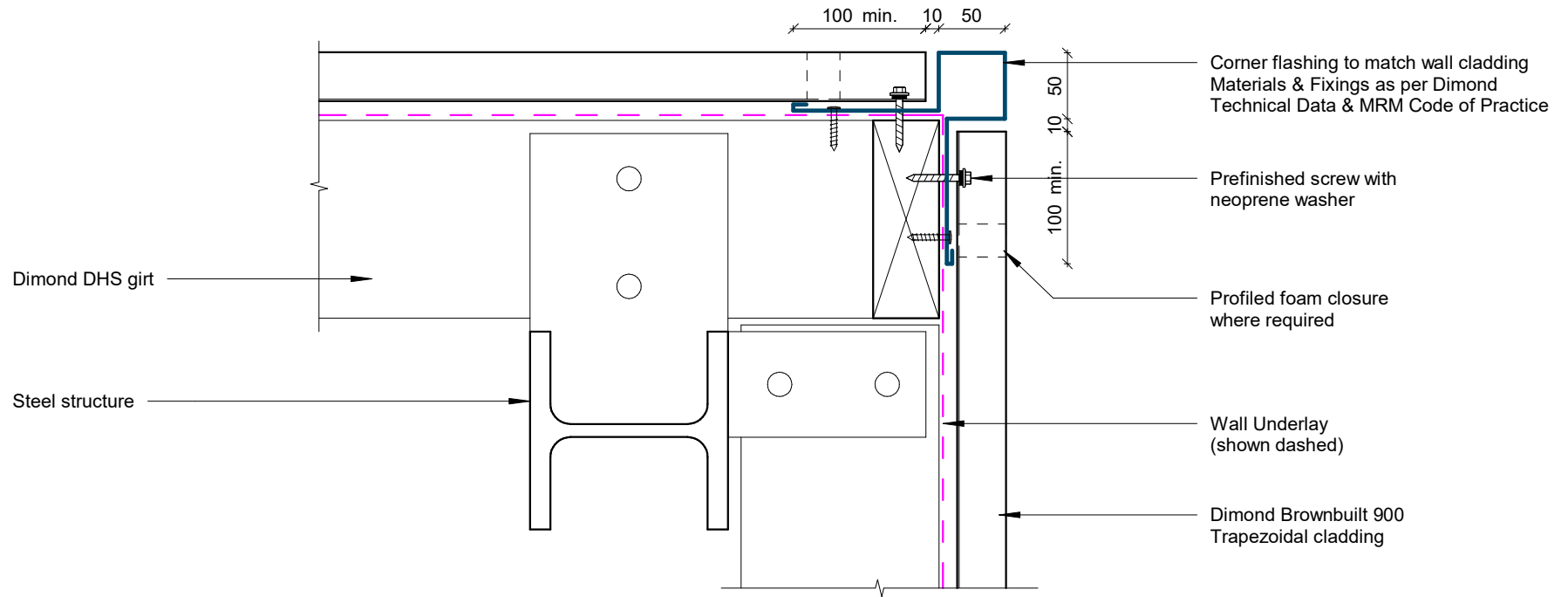

External Corner Detail

Rev: 1 **Brownbuilt 900 Commercial Horizontal Cladding**

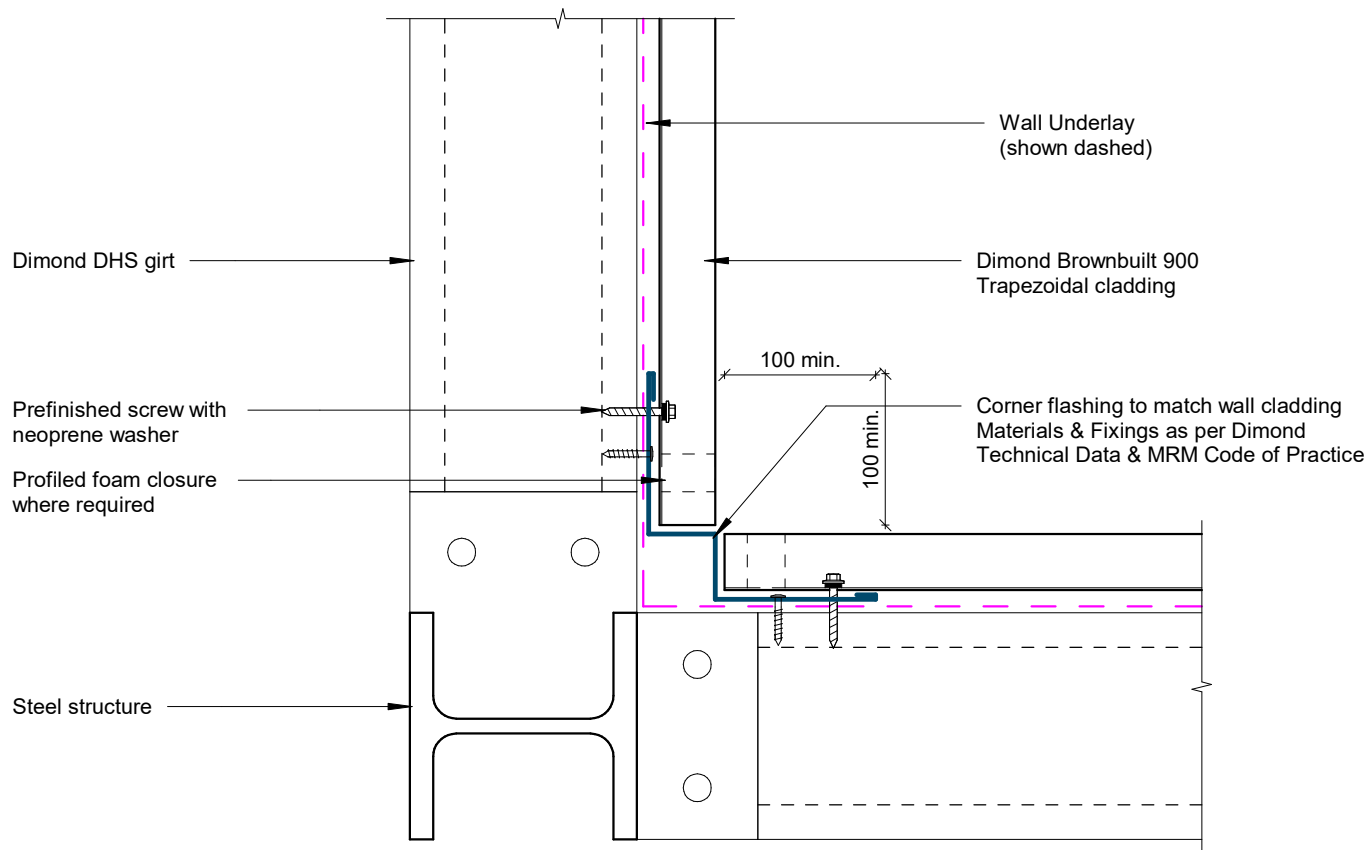

Internal Corner Detail

Rev: 1 **Brownbuilt 900 Commercial Horizontal Cladding**

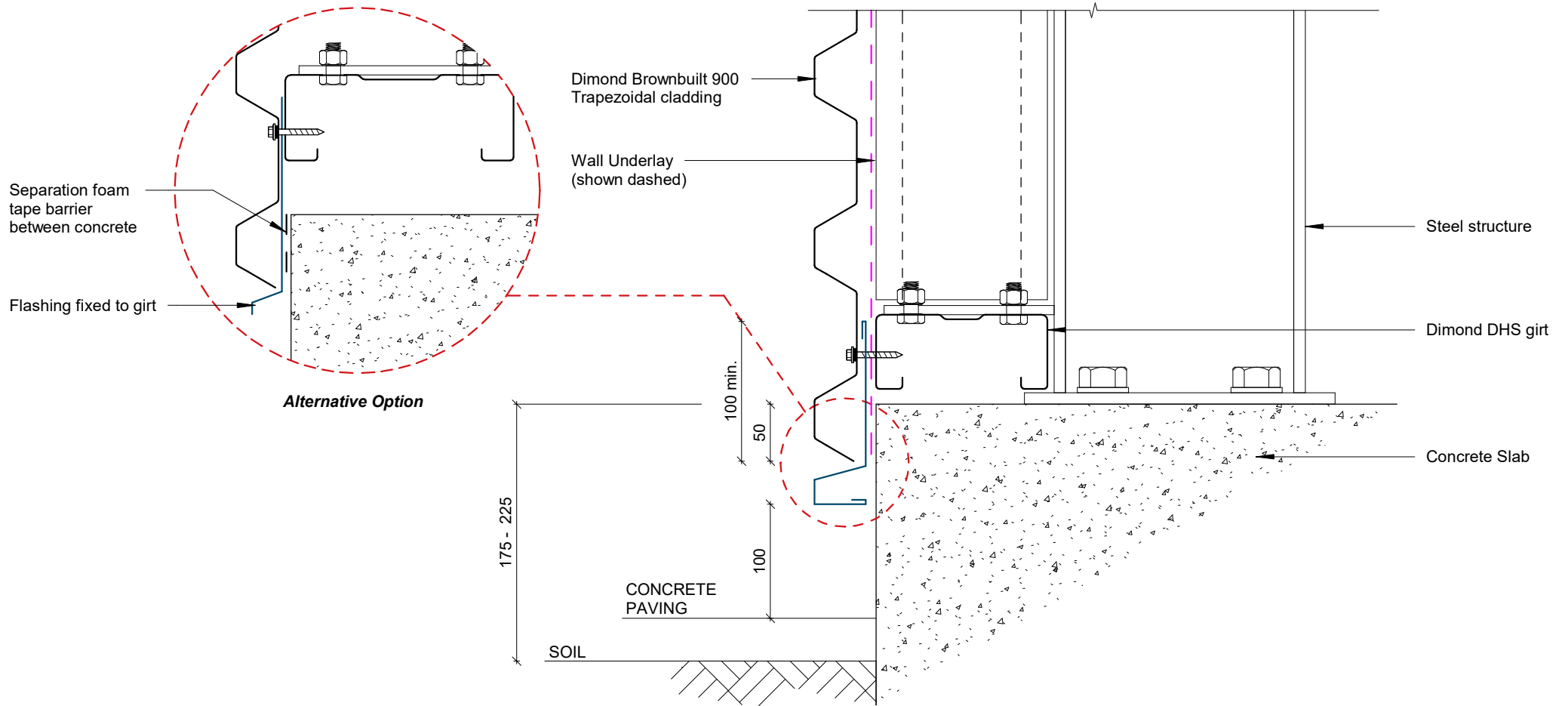

Base Detail

Rev: 1 **Brownbuilt 900 Commercial Horizontal Cladding**

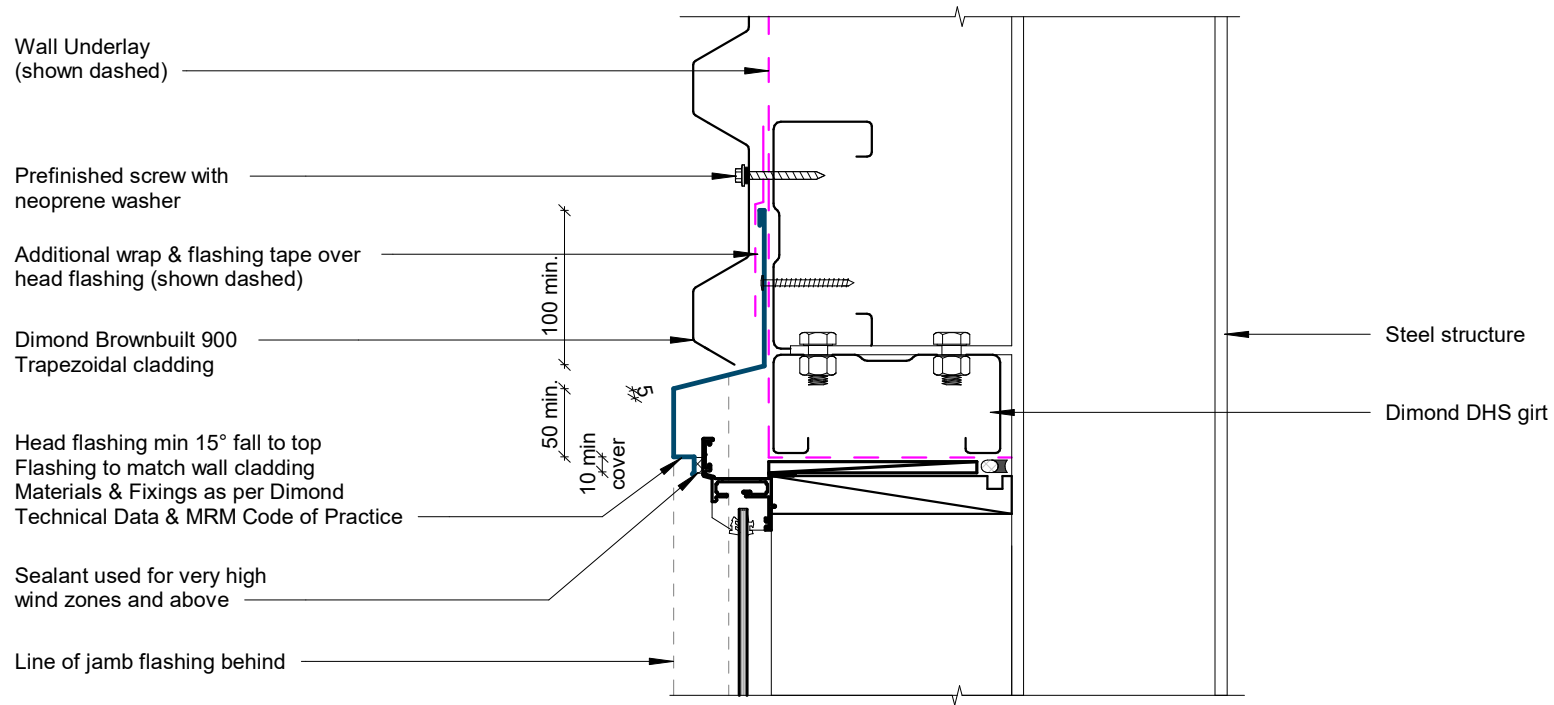

Window / Door Head Detail

Rev: 1 **Brownbuilt 900 Commercial Horizontal Cladding**

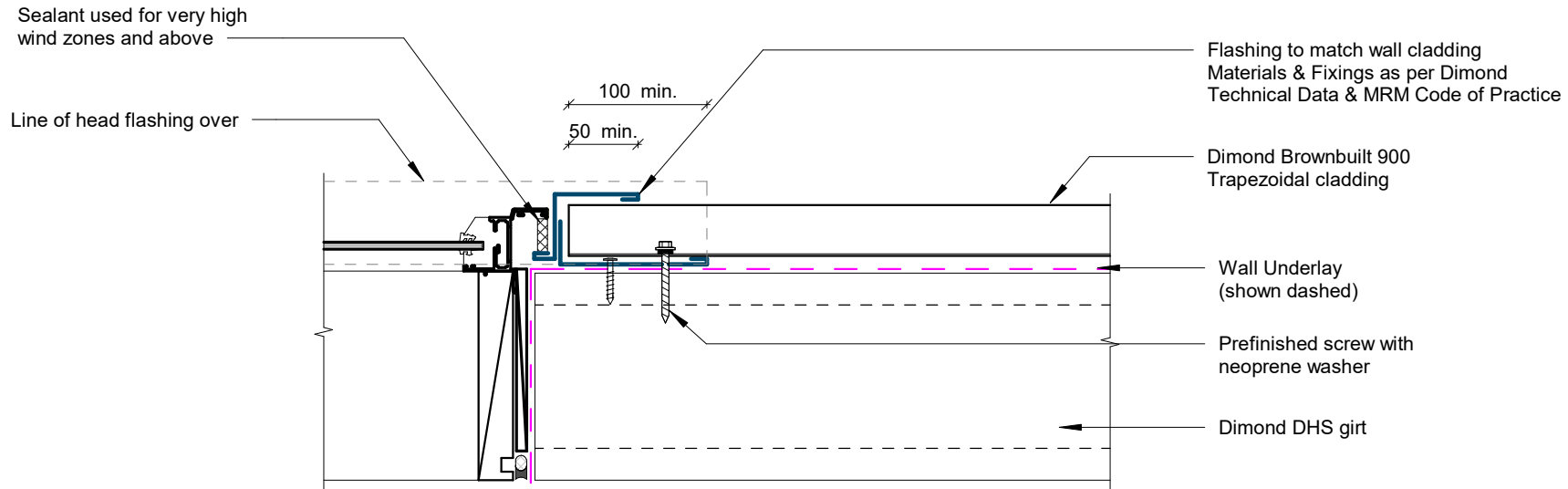

Window / Door Jamb Detail

Rev: 1 **Brownbuilt 900 Commercial Horizontal Cladding**

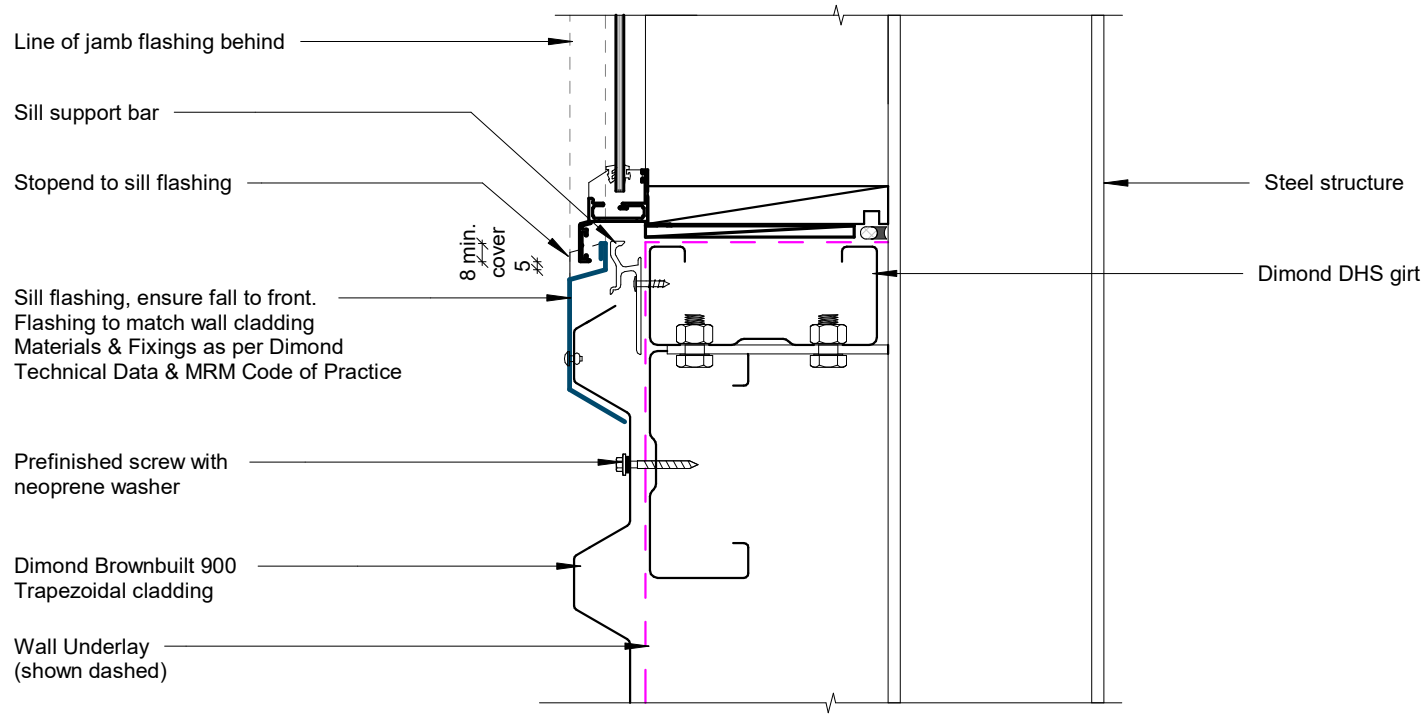

Window Sill Detail

Rev: 1 **Brownbuilt 900 Commercial Horizontal Cladding**



©Dimond 2023, all rights reserved. The information and specifications contained in this document are proprietary to Dimond and may not be used other than for the purpose of designing or building a roof or roofing system solely using products supplied or approved by Dimond ("Permitted Purpose"). You may copy this document solely for the Permitted Purpose, but may not otherwise copy, publish, distribute or modify this document without Dimond's prior written consent. Dimond will not be liable for any use of this document or information and specifications contained in this document, other than for the Permitted Purpose

Date: Oct 2025 Scale: 1 : 5 Sheet: **BBCHC13**