

Dimond roofing (specify profile, thickness and coating) fixed to Dimond roof rail with 12g hex head tek screw (Length to suit profile)

Cavibat cavity closure stuck down using 25mm wide Nuralite double sided butly tape in 20mm long strips at 500 centres

Membrane stuck down onto flashing

Membrane gutter to Nuralite specification

Nuraply 3pm Gaf Evaguard TPO membrane system

Nuraply ALU vapour barrier

H3 Plywood support

Flashing and fire stop to Fire Engineers design. For group number 2 or 3. For group 1s or 2s contact Dimond Roofing.

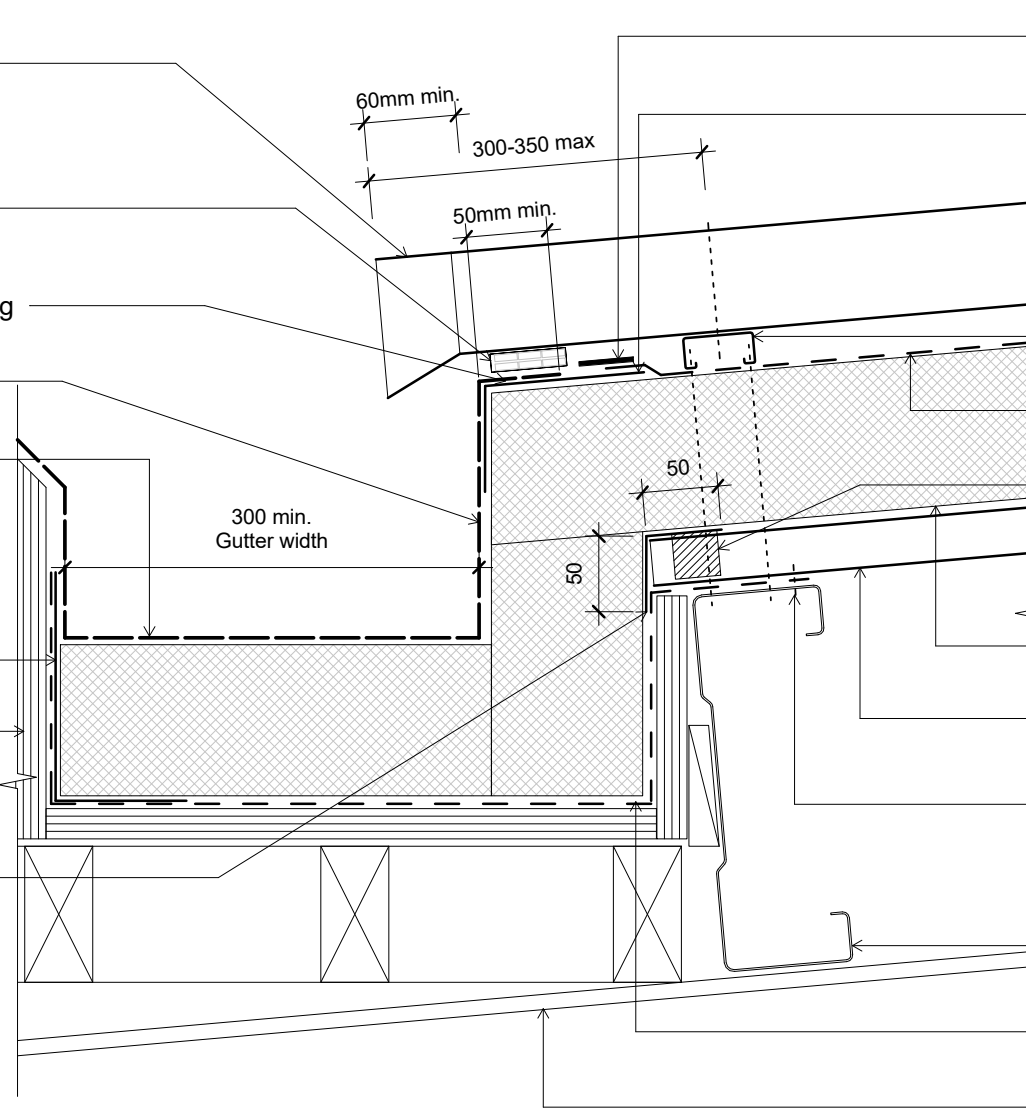

Seal Solitex Mento 1000 to flashing with Pro Clima Duplex

0.55mm folded flashing to edge of PIR

Dimond Galvanised Roof Rail laid and fixed over every purlin

Solitex Mento 1000 connect underlay laid vertically over PIR

Narrow tipped foam on top of NPM 900

Enertherm ALU Rigid Insulation. Depth as specified

NPM 900 metal tray

12g x 20mm tek screw pan fixed every pan

Dimond Hi-span cold rolled steel purlin (specify size)

Roofing underlay and netting shown dashed

Line of Structure

Original Size A4

Issue: 03	Reference  dim_tri_1060
Scale: 1 : 5	
Date: 31 November 2019	