

Dimond roofing (specify profile, thickness and coating) fixed to Dimond roof rail with 12g hex head tek screw (Length to suit profile)

Eaves flashing. Isolated from contact with timber

175x175x125 or 175x300x125 Dimond fascia gutter

6mm diameter 20mm long g.m.s. gutter bolt

Extended 6mm flat galvanised external gutter bracket fixed at 600mm c/c max. laid to fall. Isolated between bracket & timber

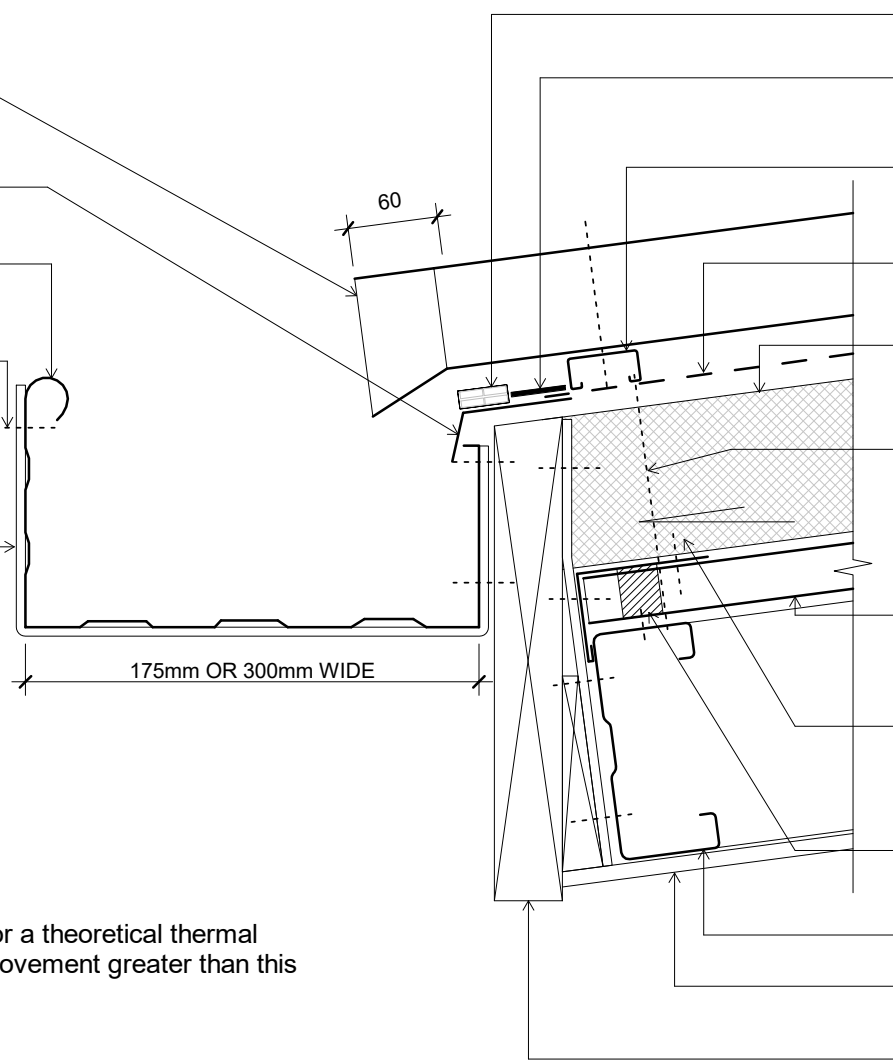

Cavibat cavity closure

Seal Solitex Mento 1000 to flashing with Pro Clima Duplex

Dimond Galvanised Roof Rail laid and fixed over every purlin

Solitex Mento 1000 connect underlay laid vertically over PIR

Enertherm ALU Rigid Insulation. Depth as specified

Hex head 14g - 10x Length (Depending on Enertherm thickness specified) @ 150 centres

NPM 900 metal tray fixed with 12g x 20 tek screw every pan

Flashing and fire stop to Fire Engineers design. For group number 2 or 3. For group 1s or 2s contact Dimond Roofing.

Wide tipped profiled foam under & narrow tipped foam on top of NPM 900

Structure

Soffit

Timber barge sized to suit span. Min. thickness 40mm and fixed to Engineer design

Notes:

- These details are suitably fixed to allow for a theoretical thermal movement of up to 10mm. For thermal movement greater than this a clipping system should be considered.

Original Size A4



Tricore  
Roof

Eaves Box Gutter with Soffit

Issue: 03	Reference  dim_tri_1044
Scale: 1 : 5	
Date: 31 November 2019	