

Dimond roofing (specify profile, thickness and coating) fixed to Dimond roof rail with 12g hex head tek screw (Length to suit profile)

175x175x125 or 175x300x125 Dimond fascia gutter

6mm diameter 20mm long g.m.s. gutter bolt

Extended 6mm flat galvanised external gutter bracket fixed at 600mm c/c max. laid to fall

Dimond wall cladding (specify thickness and coating)

Notes:

- Foam closure strip only required if bird or vermin proofing is required, or if in a high wind area, there is a risk of windblown moisture entering the building.
- These details are suitably fixed to allow for a theoretical thermal movement of up to 10mm. For thermal movement greater than this a clipping system should be considered.
- Non Insulated wall shown. If a Insulated wall is required the Insulation must run up to the top of the Enertherm ALU.

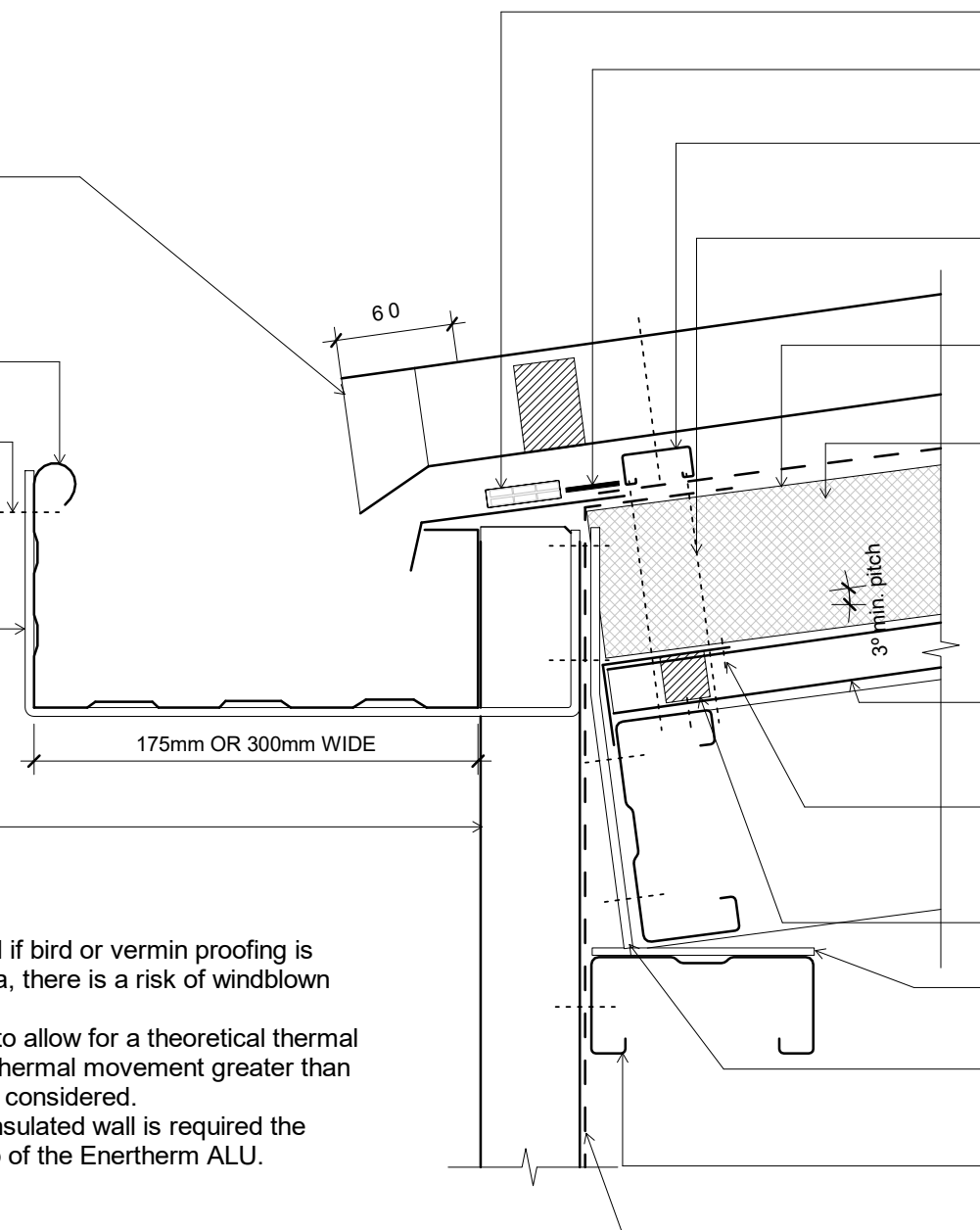

Cavibat cavity closure

Seal Solitex Mento 1000 to flashing with Pro Clima Duplex

Dimond Galvanised Roof Rail laid and fixed over every purlin

Hex head 14g - 10x Length (Depending on Enertherm thickness specified) @ 150 centres

Solitex Mento 1000 connect underlay laid vertically over PIR

Enertherm ALU Rigid Insulation. Depth as specified

NPM 900 metal tray fixed with 12g x 20 tek screw every pan

Flashing and fire stop to Fire Engineers design. For group number 2 or 3. For group 1s or 2s contact Dimond Roofing.

Wide tipped profiled foam under & narrow tipped foam on top of NPM 900

Structure

6mm Thick galvanized bracket @ 600mm centres for gutter fixing, to Engineers design fixed to eaves purlin

Dimond HI-Span steel purlin (specify size)

Wall underlay shown dashed (If required)

Original Size A4

Issue: 03	Reference dim_tri_1040
Scale: 1 : 5	
Date: 31 November 2019	