

Climaseal coated self drilling 14g x 90mm tek screw rib fixed with 36mm EPDM washer and load spreading washer

Additional flashing for high wind exposure notched over lower roof profile

Foam closure strip under roofing (see note below)

Fix with self drilling 12g x 25mm T17 for high wind exposure

Potential dirt build-up

Dimond Solar-Rib® Roofing (specify thickness and coating)

Climaseal coated self drilling 20mm tek screw pan fixed

Dimond hi-span cold rolled steel purlin (specify size)

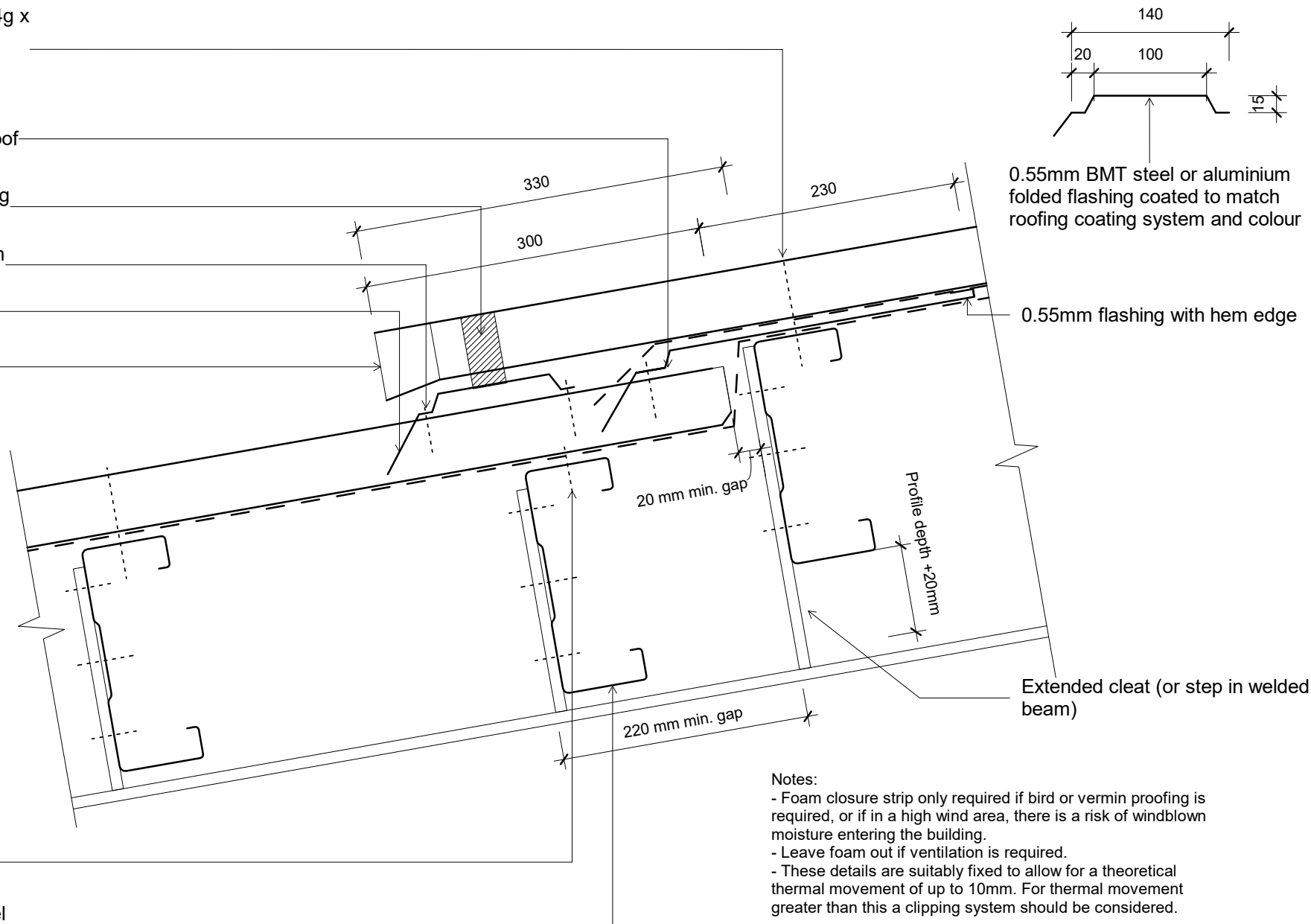

- Notes:
- Foam closure strip only required if bird or vermin proofing is required, or if in a high wind area, there is a risk of windblown moisture entering the building.
 - Leave foam out if ventilation is required.
 - These details are suitably fixed to allow for a theoretical thermal movement of up to 10mm. For thermal movement greater than this a clipping system should be considered.

Original Size A4



Solar Rib Roof Step in Roofing

dim_sor_1070 Step in Roofing	
Issue: 01	Reference
Scale: 1 : 5	
Date: 20 December 2018	
dim_sor_1070	