

Climaseal coated self drilling 12g x 65mm tek screw

Additional flashing for high wind exposure notched over lower roof profile

Foam closure strip under roofing (see note below)

Fix with self drilling 12g x 25mm T17 for high wind exposure

Potential dirt build-up

Dimond Brownbuilt 900 roof cladding (specify thickness and coating)
Sheet lipped

Dimond Brownbuilt 900 roof cladding (specify thickness and coating)

Climaseal coated self drilling 12g x 65mm tek screw

Dimond hi-span cold rolled steel purlin (specify size)

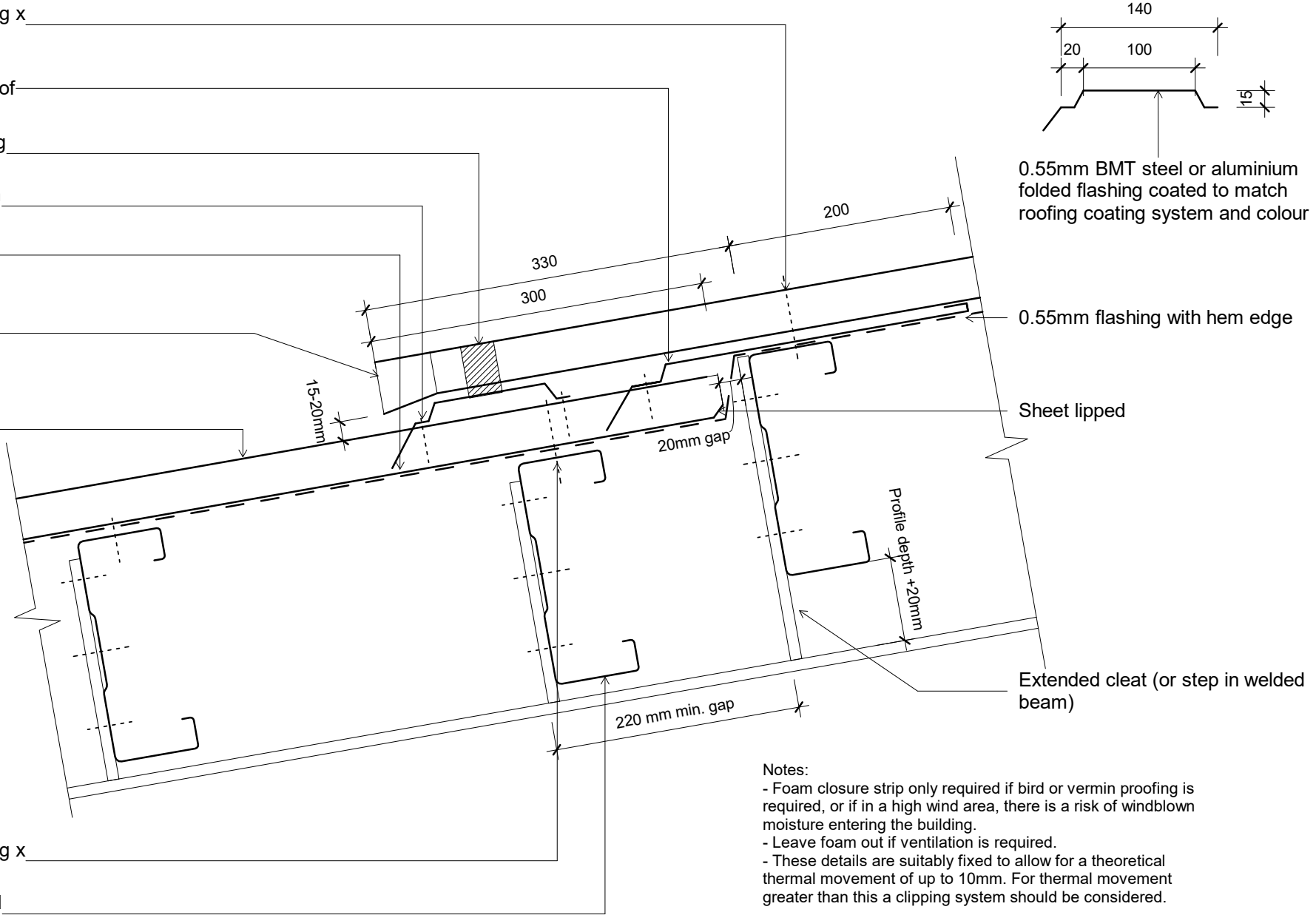

Notes:

- Foam closure strip only required if bird or vermin proofing is required, or if in a high wind area, there is a risk of windblown moisture entering the building.
- Leave foam out if ventilation is required.
- These details are suitably fixed to allow for a theoretical thermal movement of up to 10mm. For thermal movement greater than this a clipping system should be considered.

Original Size A4



Brownbuilt 900 Roof

Step in Roofing

File:	
Issue:	04
Scale:	1 : 5
Date:	05 October 2018
Reference	dim_bb9_1070